

IC-36FI



FEATURES

- Ready to be fitted with custom panels and handles to blend with cabinetry
- Smart-touch controls for streamlined access to more settings
- Uniform 84" height
- All-freezer storage solves capacity problems
- Water-filtration system reduces contaminants, chlorine taste and odor
- Soft-on LED lights for varying degrees of brightness
- Magnetic door seal system locks in cold air
- Automatic ice maker with "max ice" feature
- Rigorously tested in our U.S. manufacturing facilities to ensure decades of use
- Exceptional 24/7 support from Madison, WI-based Customer Care team

ACCESSORIES

- Dual Installation Kit Handle to Hinge
- Dual Installation Kit Hinge to Handle
- Dual Installation Kit Hinge to Hinge
- Stainless Steel Tubular Handles
- Stainless Steel Pro Handles
- Stainless steel front panels with tubular or pro handles
- Stainless steel kickplate
- Stainless steel side enclosure
- Stainless steel top enclosure
- Reduced toe kick divider for toe kicks from 2" to 3.875"
- Replacement water filter

Accessories are available through an authorized Sub-Zero dealer.
For local dealer information, visit subzero-wolf.com/locator.



HANDLE ACCESSORIES

PRO



TUBULAR



PRODUCT SPECIFICATIONS

Model	IC-36FI
Dimensions	36"W x 84"H x 24"D
Door Clearance	34 1/2"
Weight	460 lbs
Freezer Capacity	20 cu. ft.
Electrical Supply	115 VAC, 60 Hz
Electrical Service	15 amp dedicated circuit
Receptacle	3-prong grounding-type

ELECTRICAL

PLUMBING

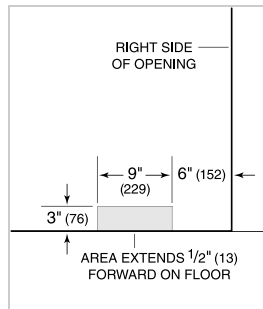
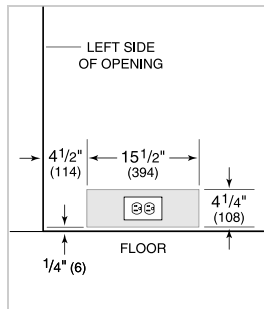

INTERIOR VIEW

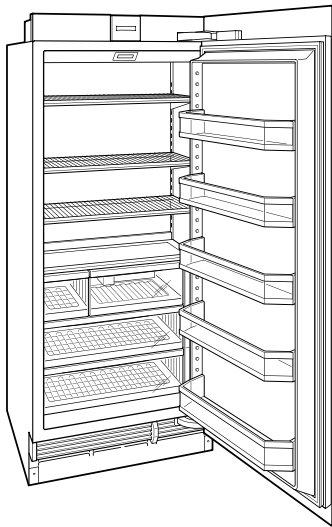

This illustration is intended for interior reference only and may not represent the exterior of the model being specified.

DIMENSIONS

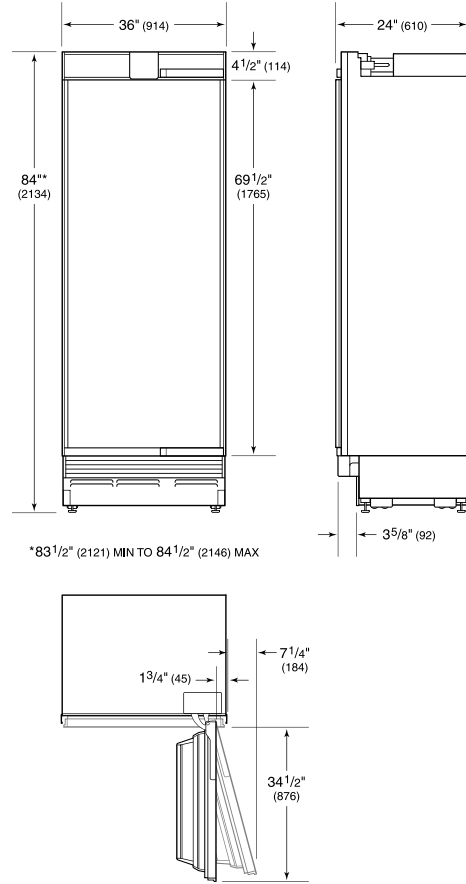

STANDARD INSTALLATION

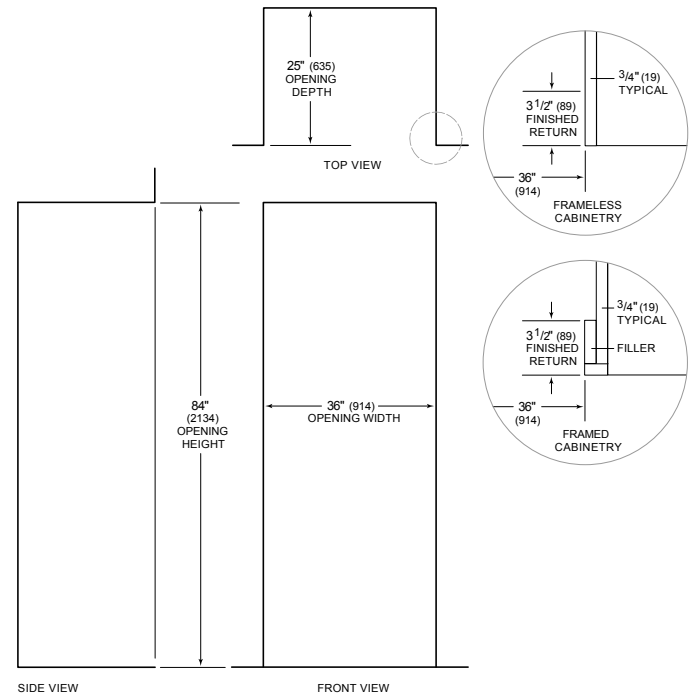

NOTE: 3 1/2" (89) finished returns will be visible and should be finished to match cabinetry