

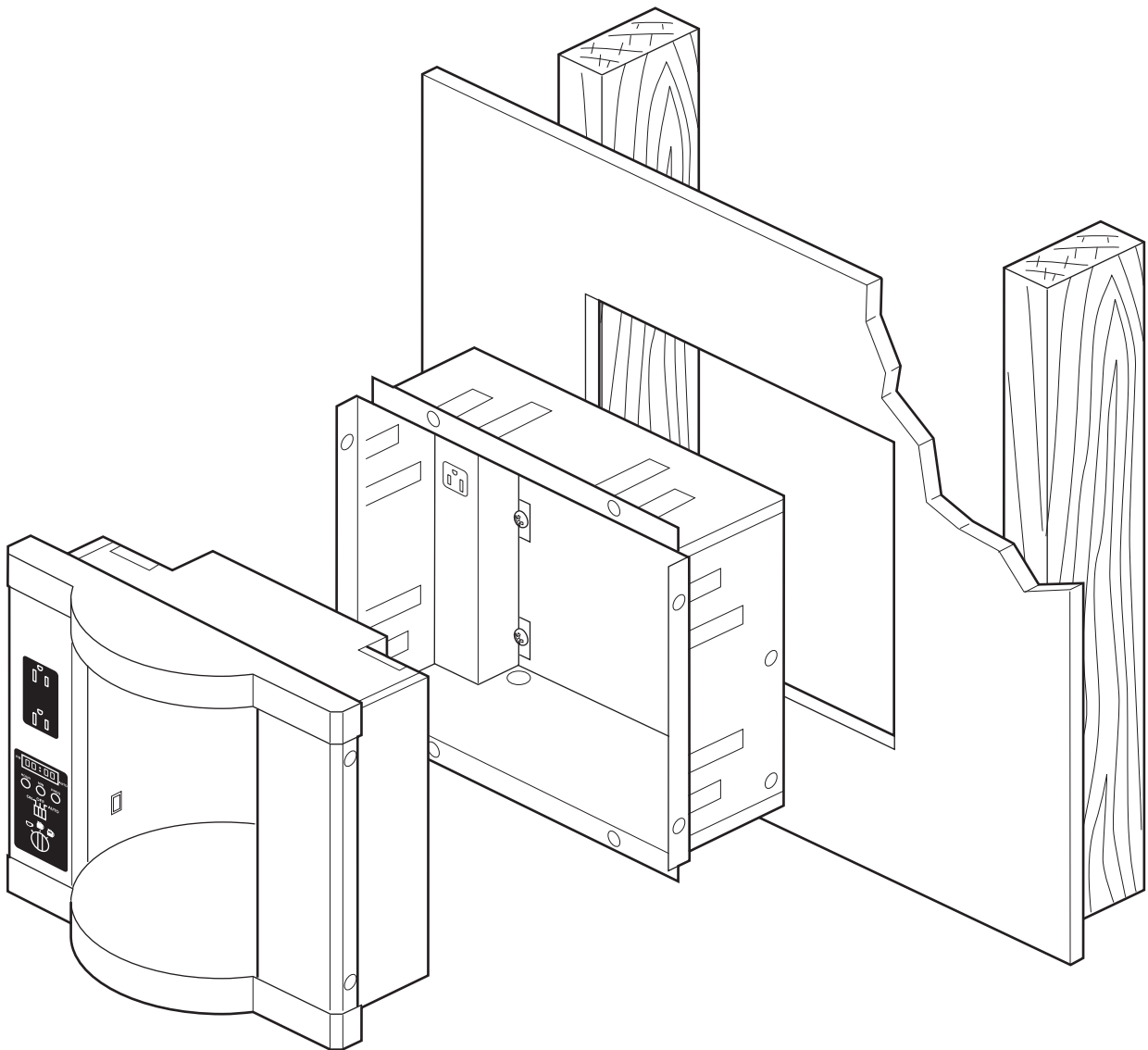

BREW EXPRESS™ INSTALLATION GUIDE

MODEL BE112



Contents

1. Safety	1
2. Hardware/Tools	2
3. Specification Requirements	3
4. Location (area of Installation)	4
5. Water Installation	5
6. Power Installation	6
7. Installation	7-9
10. Testing	10
11. Troubleshooting	11

Safety

IMPORTANT:

Read and follow instructions carefully before installing your BREW EXPRESS™ in-the-wall COFFEE SYSTEM. For best results its advised that you hire a qualified professional.

WARNING

Always turn off all power at main electrical panel before attempting to install BREW EXPRESS™. Improper electrical wiring could cause a fire hazard. All wiring **MUST** be performed in accordance with local electrical codes. It is strongly advised you contact a qualified electrician.

WARNING

Always turn off water supply at source when installing BREW EXPRESS™. Improper installation of water supply could cause poor performance or leaks witch may lead to dry rot and cause structure damage to building. Be certain water supply is leak free. Hire a qualified plumber if necessary.

WARNING

The BREW EXPRESS™ dispenses extremely hot water. Hot liquids may cause severe burns if it contacts skin. Use extreme caution when handling hot liquids dispensed by the BREW EXPRESS™. **KEEP HANDS AWAY FROM SPRAY HEAD, BREW BASKET, CARAFE OR MUG DURING BREW CYCLE.** This product is intended for brewing hot water for beverages only, and may not be used in any other way.

WARNING

Check distance between wall cavity studs to ensure BREW EXPRESS™ will fit in desired location. Normal cavity is 14.5" wide and 4" deep. Hire a qualified professional if necessary.

Hardware/Tools

Hardware

BREW EXPRESS™ comes supplied with the following items to ensure a successful installation. Check to be certain all items have been included with your brewer.

- (1) Brewer (with short water line attached to connect with incoming water line)
- (1) Rough-in-Box
- (1) Carafe
- (2) Brew Baskets
- (6) Coffee Filters
- (1) Installation Guide
- (1) Operation Guide
- (1) Template (for cutting hole for Rough-in-Box)
- (1) Hardware Kit
 - (6) Sheet rock screws
 - (3) Wire nuts
 - (1) Male Quick Connector (for connection between Coffee System Unit and Rough-in-Box).
 - (4) Mounting screws

Tools and parts required (not supplied)

The following tools will be useful for installation

- Tape Measure
- Utility Knife
- Philips Screw Driver
- Pencil
- Wire Stripper
- Stud Finder
- Level
- Strain relief for electrical wire
- 1/4" Poly or copper line (refrigerator ice maker kit)
- 2-12 wire (per local code)
- Electric drill and (7/16" drill bit)
- Valve Connection (optional)
- Refrigerator ice maker filter (optional)

Specifications and Requirements

IMPORTANT:

Read and follow instructions carefully before installing your BREW EXPRESS™ in-the-wall COFFEE SYSTEM. For best results its advised that you hire a qualified professional.

Specification Requirements

1. **Overall dimensions** (Finished Unit with Rough-in Box) approximately 12.5" x 12.5".
2. **Dimensions for Rough-in-Box** (Mounting Structure) approximately 11.5" x 11.5" x 4".
3. **Power** requirements 120VAC, 60HZ. Unit requires 12.9 amps for 1400W.
4. **Water** requirements 1/4" water supply line (copper or poly) minimum 30 psi to a maximum of 120 psi. Potable **COLD** water is required.

If water is not available, an alternate water dispenser jug (5 gallons) can be used with the optional pump accessory (not supplied). Contact dealer or Lance Larkin™

Please Note: A filter and shut off valve at water source is highly recommended.

The filter such as an ice maker type filter, can easily be installed at the source.

If water lines are not purged or clear of debris or a filter is NOT installed, foreign particles (debris) in water may clog brewer system causing failure, and may void all warranties.

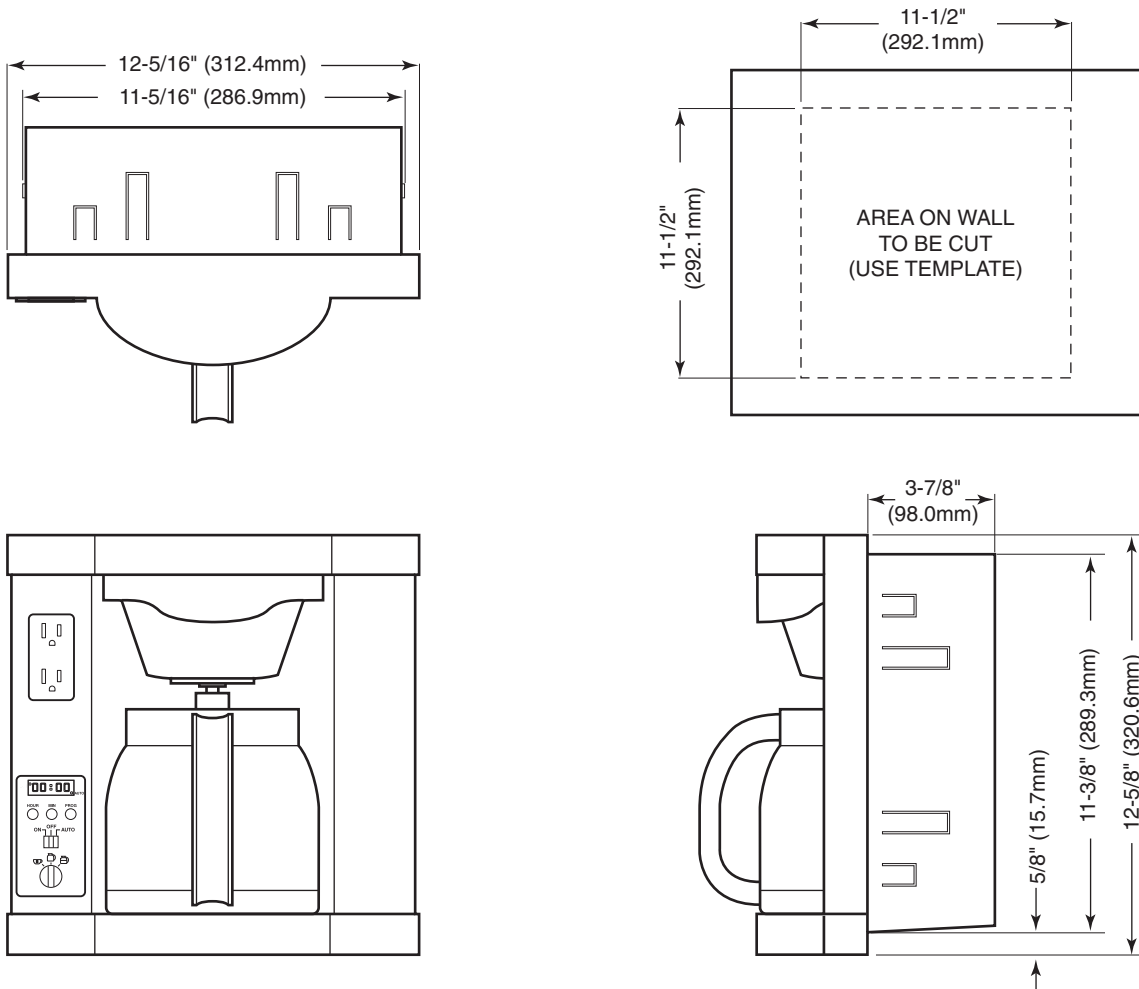

Location *(Area of Installation)*

The BREW EXPRESS™ can be installed in most places where power and water are supplied. The most common locations are the kitchen and master bathroom. Typically it is installed over a counter, but it can be installed in a wall where there is no counter.

NOTE: It is important to check stud width and location for proper fit. Minimum width and depth requirements for rough-in-box are 11.5" x 11.5" x 4". Please use template provided for proper fit for your location.

IDEAL LOCATION AREAS

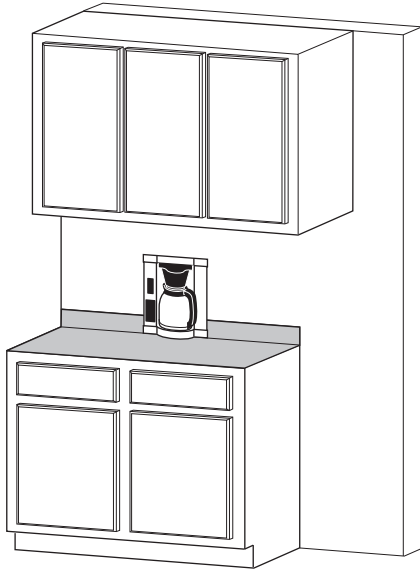

A. On Counter

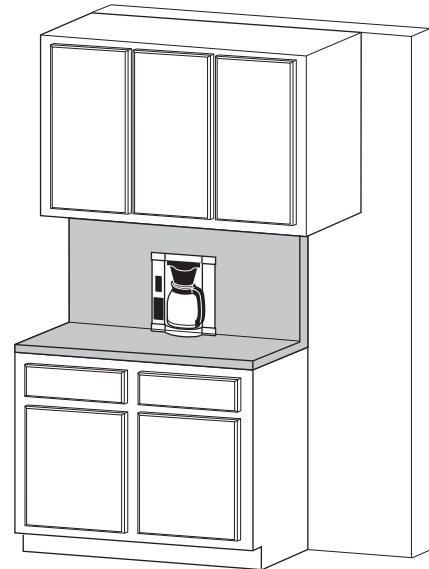

B. Full Height Back Splash

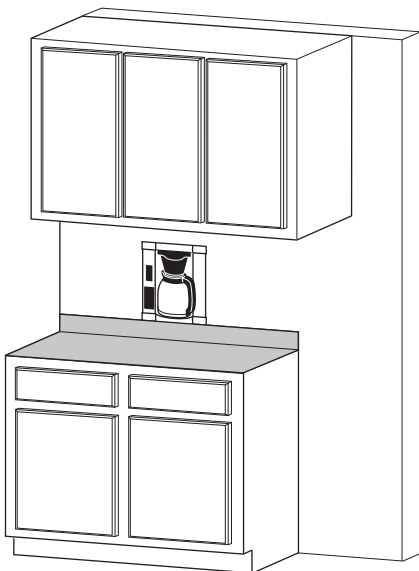

C. Above Back Splash

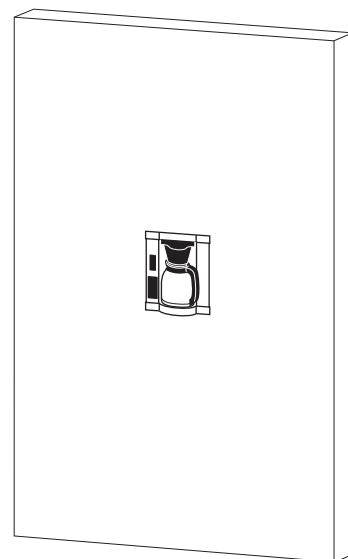

D. In Wall

Water Installation



WARNING

Always turn off water supply at source. It is strongly advised you consult a qualified professional plumber when attempting to install BREW EXPRESS™ in-the-wall COFFEE SYSTEM.



WARNING

It is important to make sure there are no conflicts or obstructions in the wall cavity such as plumbing or electrical wires. If in doubt Contact a qualified professional. DO NOT ATTEMPT INSTALLATION.

IMPORTANT:

It is highly recommended a water filter and shut off valve be installed at source under sink or refrigerator area.

EXISTING HOME

- A. Determine closest location on wall where BREW EXPRESS™ is to be installed where water can be plumbed by teeing off **water line** from sink, refrigerator, ice maker or by simply using the alternate water jug (not supplied). Drill a **hole** (7/16" dia) at the lowest point in the cabinets and route **water line** through **hole** behind cabinets and up wall cavity to the cut opening in wall. Leave approximately 18" of excess **water line** at wall opening for rough-in-box installation. Continue **water line to source**. Splicing/coupling is not recommended. A continuous line will be best to ensure no leaks.

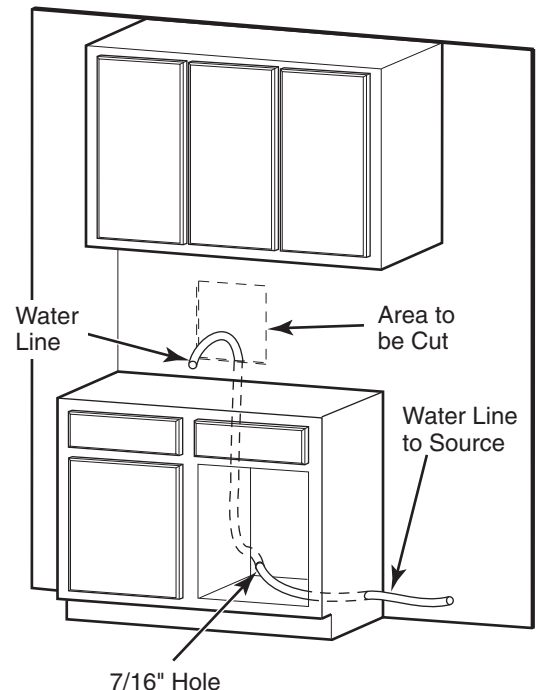

NEW HOME CONSTRUCTION

- B. Determine closest location on wall where BREW EXPRESS™ is to be installed where **water line** can be plumbed by teeing off **water line** from source sink, refrigerator or ice maker. Route water line through studs and up wall cavity to area where wall opening will be cut prior to sheet rock installation. Allow an additional length of 18" at area where wall opening will be cut. Using template provided mark the area to be cut AFTER sheet rock is installed.

IMPORTANT:

If installing Unit PRIOR to cabinets, it is strongly advised to consult with cabinet maker and building contractor for exact height of counter top due to the various thicknesses of counter tops (tile laminate, granite, etc). For best results cut hole and install unit AFTER cabinets are installed.

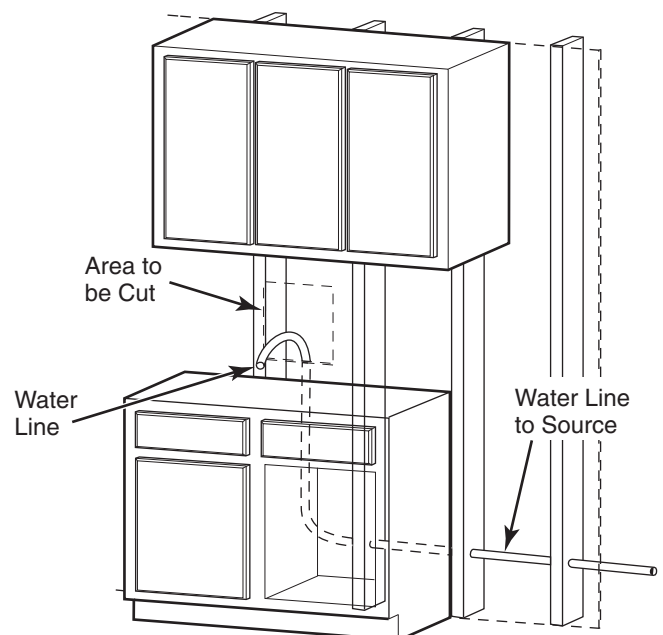

Power Installation

WARNING

Always turn off power supply at main electrical panel before attempting any electrical installation. Local electrical codes vary. All electrical installation must be done in accordance with local codes. It is strongly advised you consult a qualified professional electrician when attempting to install BREW EXPRESS™ in-the-wall COFFEE SYSTEM.

The BREW EXPRESS™ can be installed in most places where power and water are supplied. See diagrams below for the application best suited for your needs.

OPTION A. (New Construction)

Power can be brought to **rough-in-box** by adding a new line from from main **breaker panel**. Contact a qualified electrician for this application.

NOTE: When routing electrical power to desired location it is recommended that you allow an additional 18" length of wire at the rough-in-box location.

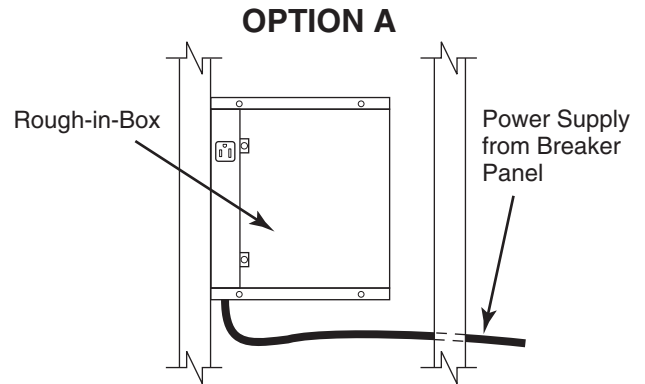

OPTION B. (New or Existing Construction)

Power to **rough-in-box** can be tapped from an existing **adjacent electrical outlet**.

NOTE: When routing electrical power to desired location it is recommended that you allow an additional 18" length of wire at the rough-in-box location.

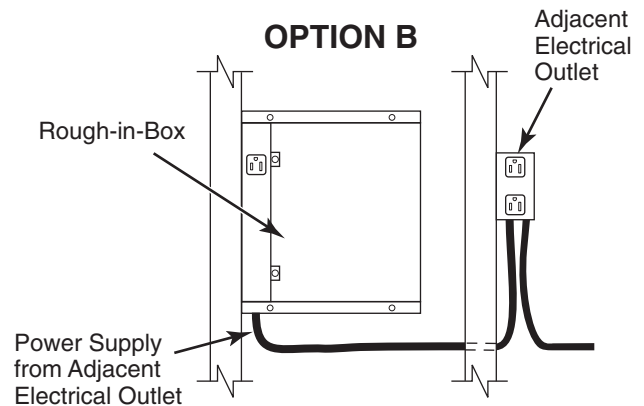

OPTION C. (Existing Construction)

Electrical outlet can be removed and replaced with the **rough-in-box**.

NOTE: When routing electrical power to desired location it is recommended that you allow an additional 18" length of wire at the rough-in-box location.

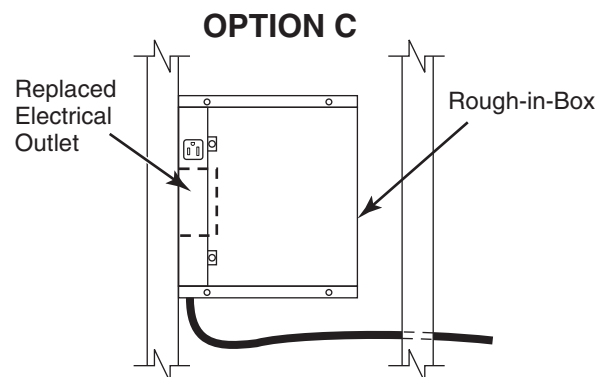

Installation

IMPORTANT:

If installing Unit **PRIOR** to cabinets, it is strongly advised to consult with cabinet maker and building contractor for exact height of counter top due to the various thicknesses of counter tops (tile laminate, granite, etc). For best results cut hole and install unit **AFTER** cabinets are installed.

A. Installing BREW EXPRESS™ on Counter

It is best to install the unit so the bottom edge is just off the counter top. In an existing home, this may require part of the back splash to be removed. Use template provided to determine the location to be cut out for rough-in-box.

B. Installing BREW EXPRESS™ with Full Back Splash

Use **template** provided to determine the location to be cut out for rough-in-box. Ensure fit is correct by first placing rough-in-box in cut out hole. Remove rough-in-box. Finish full height back splash to cut opening. If full height back splash is granite or tile, it is recommended to cut opening and install rough-in-box after surface is complete.

IMPORTANT: DO NOT COMPLETE INSTALLATION OF ROUGH-IN-BOX BEFORE BACK SPLASH.

C. Installing BREW EXPRESS™ above Back Splash

If you prefer a continuous back splash, the unit can be installed above the back splash. Use **template** provided to find best fit.

IMPORTANT: WHEN INSTALLING THE UNIT ABOVE BACK SPLASH, BE CERTAIN THERE IS SUFFICIENT ROOM BELOW THE CABINETS.

D. Installing BREW EXPRESS™ on Wall without cabinets

Place **template** on **wall** in desired location. It is recommended the bottom of **template** marked at 36" above **finished floor**, but unit can be installed at any height desired. Use a pencil to mark all areas top and bottom.

See **Figure 2**.

1. Locate **wall studs** within the desired location of **wall**. Using the **template** provided, Place **template** on **wall** as shown. **Slots** in **template** should be flush with left or right side of **wall stud** edge. The **slots** in the **template** designate the area to be cut. The bottom of **template** reflects the bottom of the unit. See **Figure 1**.
2. Use a utility knife to carefully cut inside the penciled outline area. Start with the stud side and work outward. **DO NOT USE A SAW**. Remove sheet rock piece exposing **wall cavity**. Bring **water** and **power supply** lines from source to this location. See **Figure 3**.

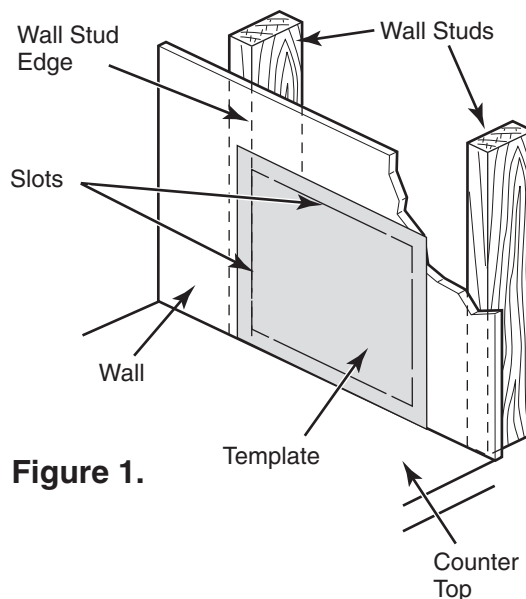

Figure 1.

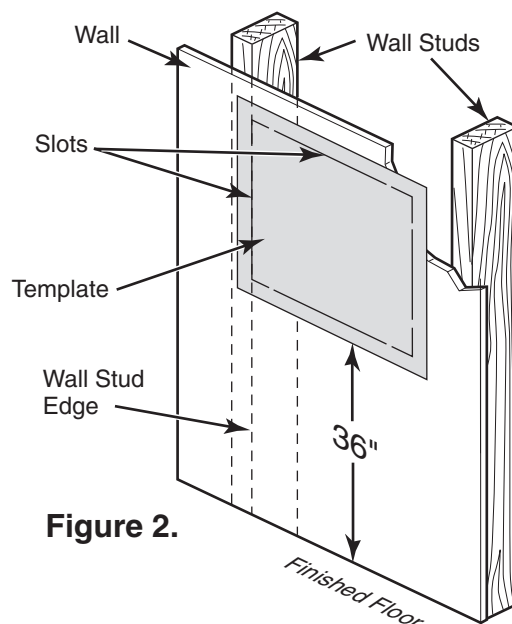

Figure 2.

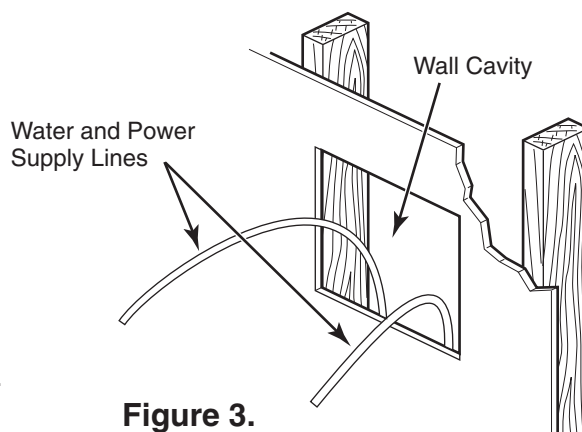

Figure 3.

Installation

3. If installing over a counter, place **rough-in-box** on a towel or cardboard to protect counter surface. Bring **power supply wire** from source (see page 6) to cut opening as previously shown in **Figure 3**, page 7. Minimum 12-2 (15 amp) wire required. Be sure to have an additional length of approximately 18" recommended at **rough-in-box** opening for installation of box. Remove **power panel cover**. Install **strain relief** (not supplied) in hole. Run **power supply wire** through **strain relief** and secure **power supply wire** (See **Supply Detail**). Connect **power supply wires** to **power panel supply wires** and secure with **wire nuts** (See **Wiring Detail**). Connect **green** wire to **green** wire, **black** to **black** and **white** to **white**. Carefully reinstall **power panel cover**. Be certain not to damage wires or insulation. See **Figure 4**.

WARNING

All electrical wires and connections **MUST** be tucked neatly and completely inside **POWER PANEL COVER** without any exposed wiring inside **rough-in box**. It is advised you contact a qualified electrician.

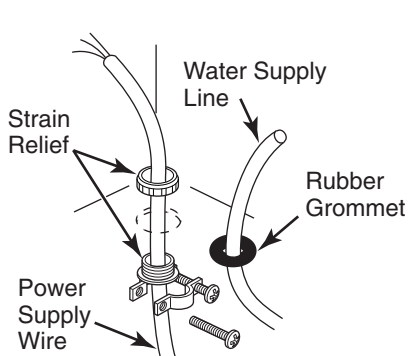

Supply Detail

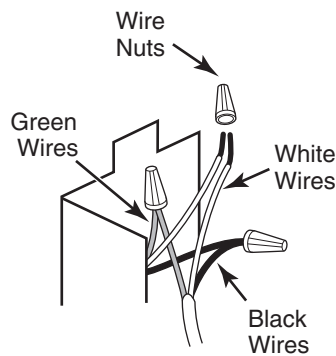

Wiring Detail

4. Bring 1/4" **water supply line** from source (see page 5) to **cut opening** as shown in **Figure 3**, page 7. Bring water line through **grommet** in **rough-in-box** (See **Supply Detail**). Carefully slide **rough-in-box** as shown into **cut opening** while gently pulling **water supply line** through **grommet** hole in **rough-in-box** pulling through excess (approx 18"). Secure **rough-in-box** to wall stud with **sheet rock screws**. PURGE WATER LINE by running water through line to clean any possible debris. Cut water line to length (approx 3") inside **rough-in-box** and attach **male quick connector**. (See **Male Connector Detail**) and **Figure 5**.

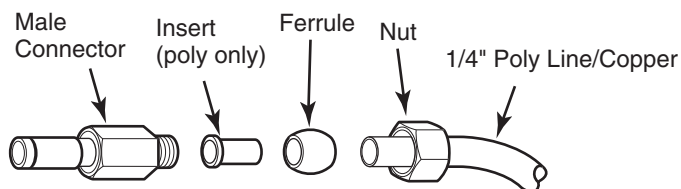

Male Connector Detail

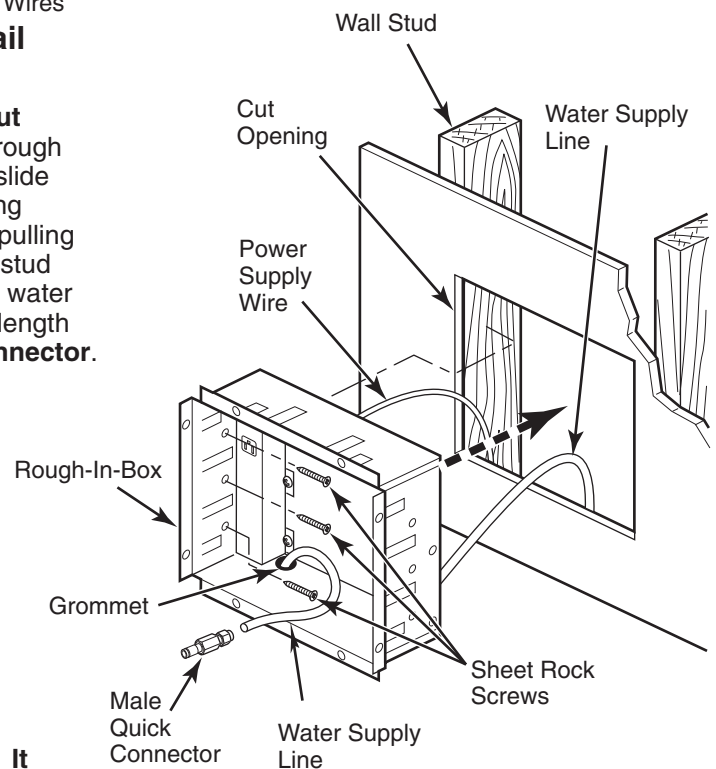

Figure 5.

IMPORTANT:
If new construction, ALL lines in home should be flushed. It is recommended to install a filter. Should debris clog brewer system. ALL WARRANTIES VOID.

Installation

5. After **sheet rock screws** are in place, gently bend appropriate **tabs** (long or short depending on wall thickness such as tile or granite) as shown on all other areas to finish securing **rough-in box** to wall. Gently slide excess water line back through grommet into wall cavity leaving approximately 1" exposed in rough-in box. See **Figure 6.** and **Figure 7.**

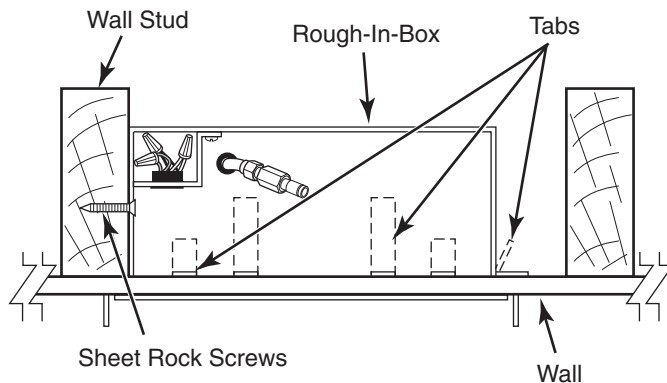

Figure 6.

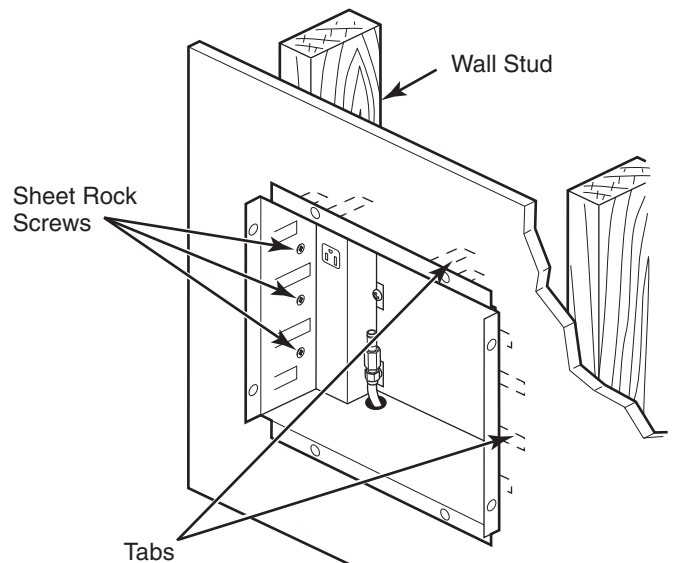
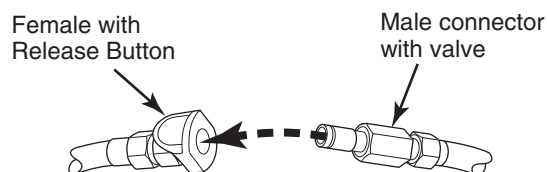

Figure 7.

6. Quick connector is valved at rough-in-box so water can be turned on prior to connection to coffee maker. If installing over a counter place unit on a towel or cardboard to protect counter surface. Place **BREW EXPRESS™** directly in front of **rough-in box**. Use **quick connector** to connect **water supply line** from **BREW EXPRESS™** to **water supply line** from **rough-in-box** (See **Quick Connect Detail**). Turn on water, snap in firmly. Check for leaks prior to final installation of **BREW EXPRESS™**. If leaking, turn off water, tighten connections or reinstall **quick connector**. Turn water on and check again. See **Figure 8.**



Quick Connect Detail

7. Gently slide the **BREW EXPRESS™** into the **rough-in-box**. Be careful not to damage **water supply lines**. A firm fit will connect power from **rough-in-box** to the **BREW EXPRESS™**. Use four **mounting screws** to secure **BREW EXPRESS™** inside **rough-in-box**. Be careful not to damage counter top. NOTE: Refer to OPERATION GUIDE for further instructions before using **BREW EXPRESS™**.

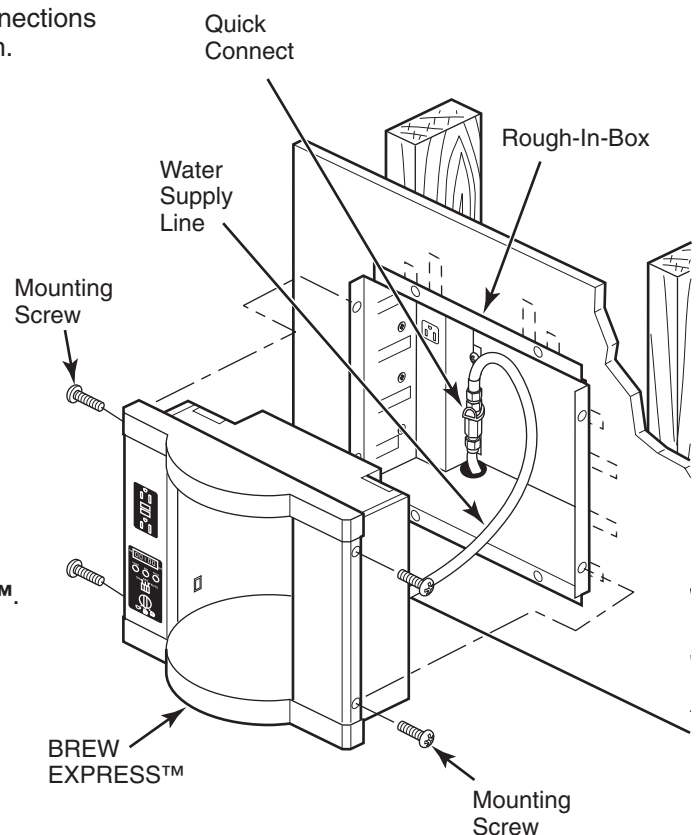

Figure 8.

Testing

Testing

Once BREW EXPRESS™ has been installed into the rough-in-box it must be tested to ensure proper operation.

1. Turn on electrical power. Check to see if display panel is illuminated, The display panel is lit when electrical supply has been properly connected. If the display panel is not lit, refer to the troubleshooting section of this manual.
2. Turn on water supply to BREW EXPRESS™. There should be no leaks in the water connections. If water is leaking pull the brewer from the wall, check connections and refer to the troubleshooting section of this manual to make appropriate corrections. If water is leaking from inside the brewer, disconnect from the rough-in-box and call for service.

Test the Brewer

1. Place empty brew basket under spray head.
2. Place the empty carafe under brew basket.
3. Set the adjustable cup selector to full carafe.
4. Move the slide switch from OFF to ON.
5. After 30 seconds water will begin flowing and remain on for approximately 7 minutes on full pot selection.
6. A Beeper will sound 40 seconds after water stops flowing.

If the operation does not occur, see the troubleshooting guide in the next section of this manual. For more detailed information regarding operation, see the OPERATION GUIDE.

Troubleshooting

A.Display is not lit

1. Ensure the power to the rough-in box is turned on (check circuit breaker).
2. Ensure brewer is fully pressed into the rough-in box.
3. Ensure the outlet inside the rough-in box is properly wired. Remove the brewer and check outlet with volt meter. If power is on and no voltage is detected at the outlet, wiring is incorrect. Turn off power. Remove power panel cover (two screws) and check wire source connection.
4. Check wire connection at source.

B.Water does not flow from spray head

1. If the BREW EXPRESS™ has not been used for 30 minutes or longer, it will PREHEAT the water for 30 seconds. You may be waiting for the preheat cycle to end.
2. Ensure water has been turned on to the BREW EXPRESS™ (check valve at source).
3. Ensure the carafe or mug is centered under the brew basket. BREW EXPRESS™ will not start if the detection sensor does not see a carafe or mug. Operation light should blink. The detection sensor may not see a flat black surface. If mug or carafe is flat black, then try a different color.
4. Ensure the water line is properly connected inside the rough-in box. Remove The four mounting screws on the side and pull out brewer. Check for pinched or kinks in the water supply line. The quick connector from the brewer must be pressed securely into quick connector from from water source.
5. Ensure the water pressure is adequate. The BREW EXPRESS™ will not operate if water pressure is under 30 PSI. LED display will flash EEEE if water pressure is too low.
6. If problem persists as EEEE indicates, and no water filter is installed (at source) coffee system maybe clogged by water debris. Contact dealer or Lance Larkin™ for service. 1(866)268-5953
7. Check the water filter at the supply. If filter is clogged replace filter.

