

# JFI2089WTS Panel Dimension Guide

## 3/4" Overlay Panel Dimensions

updated 11/14/11

**IMPORTANT: PLEASE READ ENTIRE DOCUMENT BEFORE BEGINNING WORK.**

These dimensions are for the overlay panels. Dimensions are in inches.

DESCR	HEIGHT	WIDTH	THICKNESS
P1	16	17 7/8	3/4
P2	15 13/16	1 5/8	1/4*
P3	15 13/16	5 1/2	1/4*
P4	12 5/8	17 7/8	3/4
P5	44 7/16	17 7/8	3/4
P6	21 7/8	36	3/4
Dispenser	15 13/16	10 3/4	1/4 3/4

\*Hardwood filler panels P2 and P3 can be reduced from 3/4" thick to between 3/16" to 1/4" thick to better match and accent the 1/4" edge thickness of the ice and water dispenser trim piece.

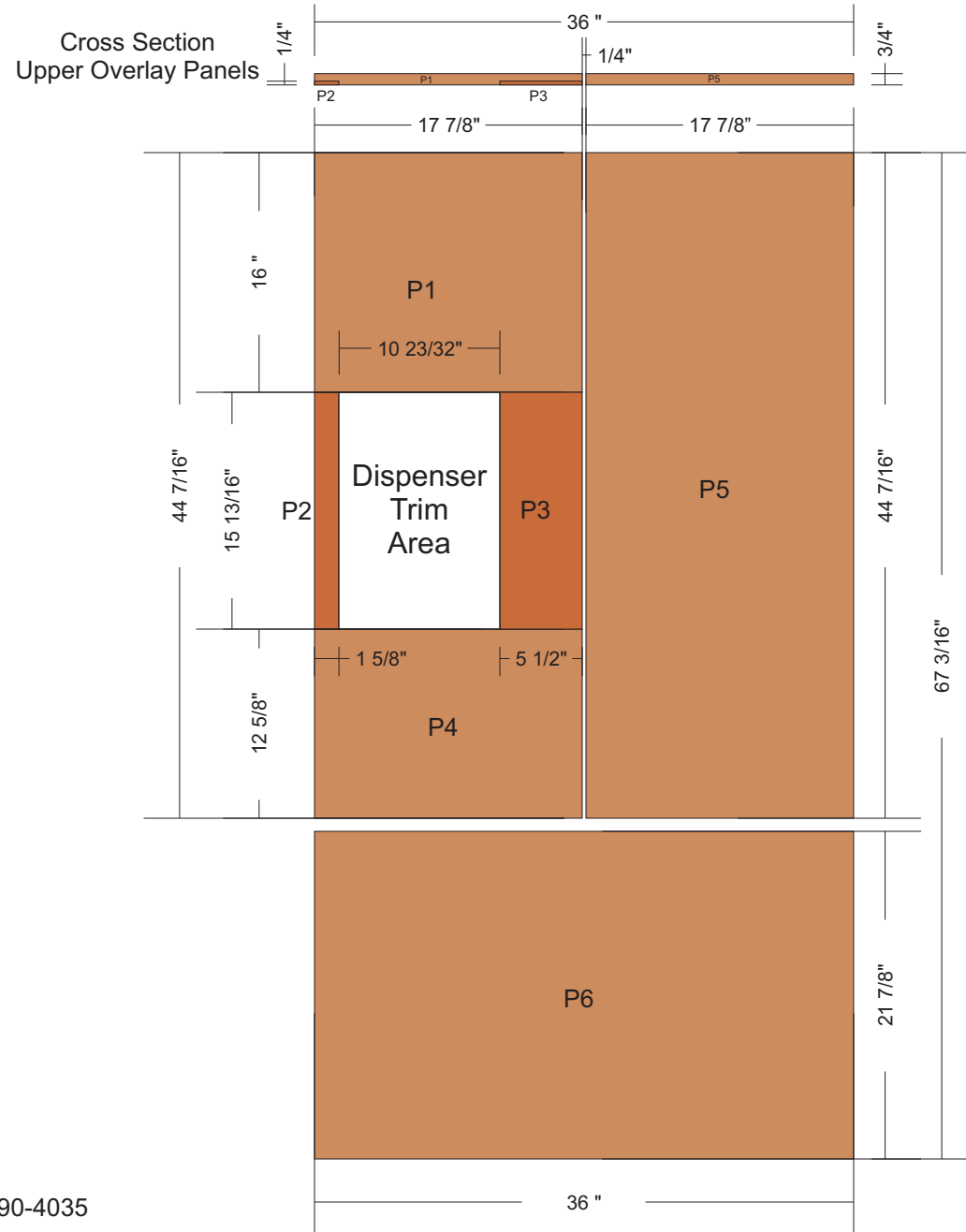

# JFI2089WTS Panel Dimension Guide

## Euro-Style Handle Dimensions and Handle Stud Locations

updated 11/14/11

**IMPORTANT: PLEASE READ ENTIRE DOCUMENT BEFORE BEGINNING WORK.**

**NOTE:** The unit will arrive with Euro-Style handles attached.

### LOCATION OF EURO-STYEL HANDLE STUDS:

These dimensions show the location of the factory installed Euro-style handles. Handles are removed from the handle studs using a 1/8" Allen wrench. Handle studs are removed from the appliance door with a Torx T20 bit. Stud screws provided with the unit 1-1/2" long. Longer screws will be needed to reattach the handle studs. Use 2" # 8 flat head screws to connect the handle studs through the pilot holes to the appliance door.

**NOTE:** Drill 3/16" pilot holes at the handle stud pilot locations indicated.

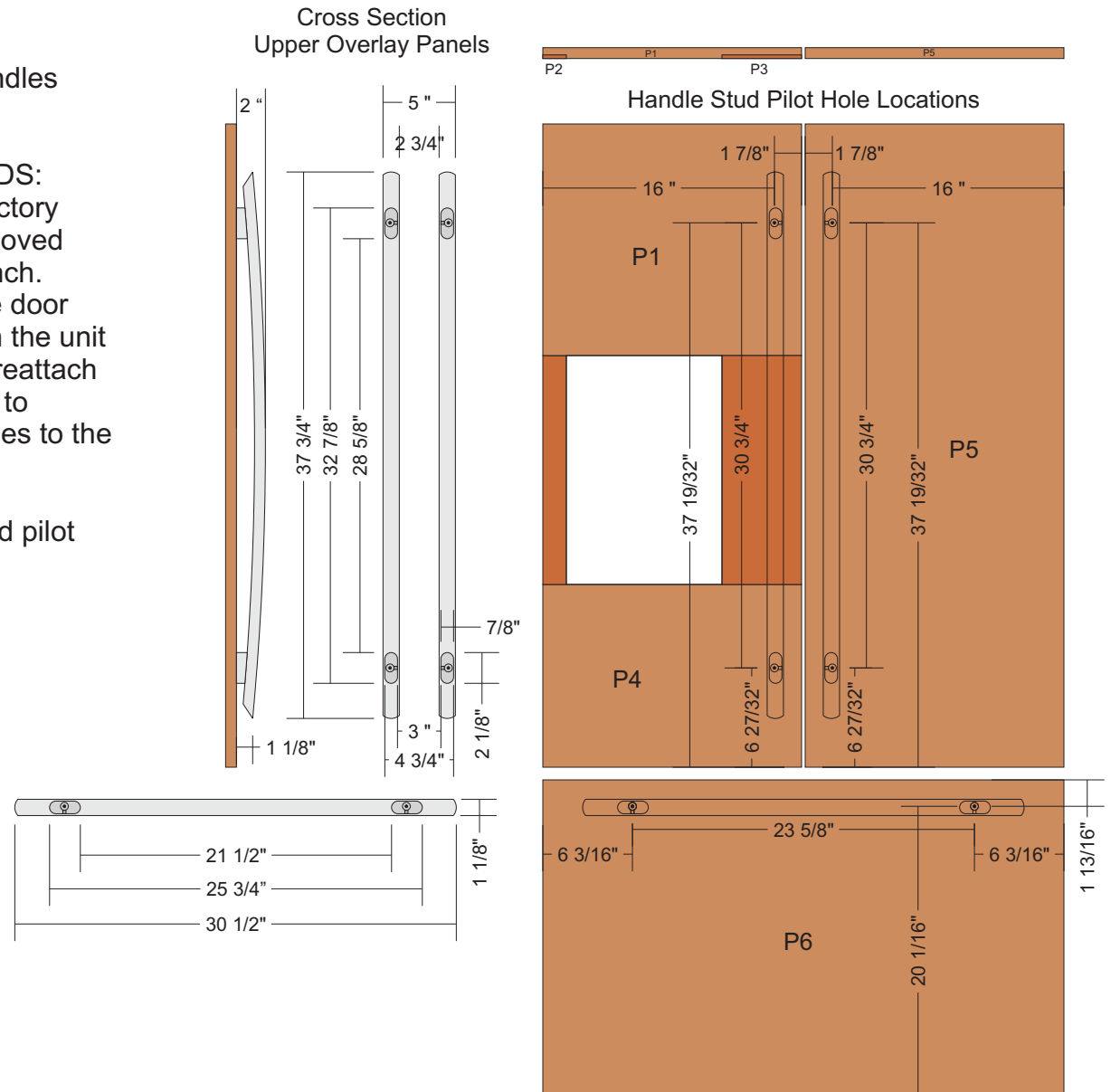

# JFI2089WTS Panel Dimension Guide

## Custom Handle Considerations

updated 11/14/11

**IMPORTANT: PLEASE READ ENTIRE DOCUMENT BEFORE BEGINNING WORK.**

**NOTE:** The unit will arrive with Euro-Style handles attached.

### SECURING UPPER PANELS WITH CUSTOM HANDLES:

**NOTE:** Without trim on the handle side of the upper door or handle studs acting as mechanical fasteners, consider using an appropriate adhesive between the backer panel and the appliance door. The adhesive will help transfer the handle pulling load to the appliance door.

**NOTE:** Counter sink the handle mounting hardware into backer. Consider using thread locking compound on the handle hardware.

**FOR HANDLES ATTACHING TO P3R:** Part of the P3 filler panel assembly should be  $\frac{3}{4}$ " thick to keep handle in the same plane as handles attached to P5 and P6.

Dimensions are in inches.

DESCR	HEIGHT	WIDTH	THICKNESS
P2	15 $\frac{13}{16}$	1 $\frac{5}{8}$	$\frac{1}{4}$
P3L	15 $\frac{13}{16}$	2	$\frac{1}{4}$
P3R*	15 $\frac{13}{16}$	5 $\frac{1}{2}$	$\frac{3}{4}$

\*The  $\frac{1}{4}$ " x  $\frac{1}{2}$ " deep rabbet cut in P3R allows for minor adjustments between P3L and P3R. The P3 assembly may also be milled as a single piece.

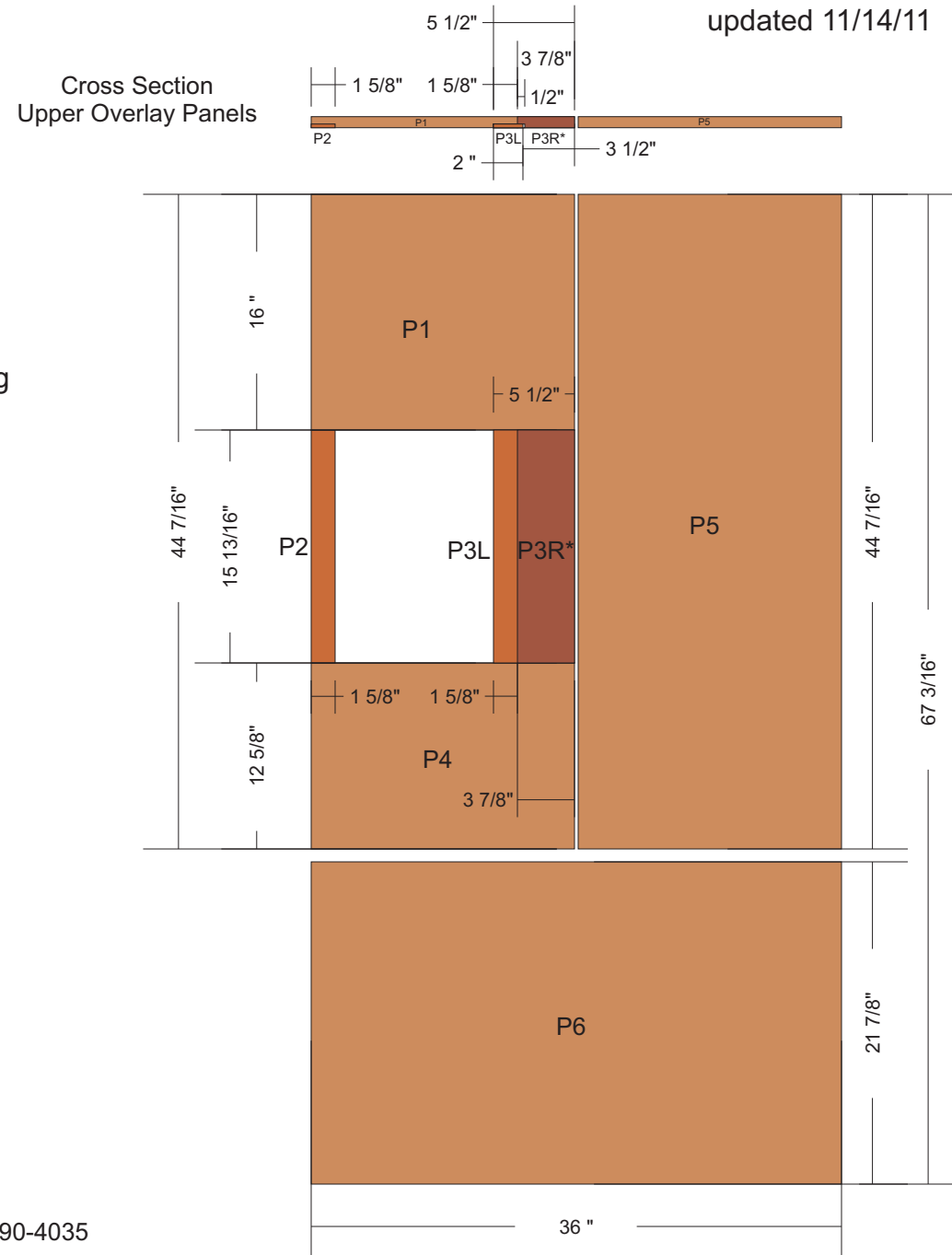

# JFI2089WTS Panel Dimension Guide

## 3/8" Backer Panel Dimensions

updated 11/14/11

**IMPORTANT: PLEASE READ ENTIRE DOCUMENT BEFORE BEGINNING WORK.**

**IMPORTANT:** This appliance has NO TRIM on the handle side of both upper doors. The backer material will be exposed along the entire height of both upper panels and will require a cosmetic finish. The exposed backer edges can be capped with a strip of matching hardwood glued to the edge, or an edge banding of wood veneer or melamine stained or painted to match either the panel set or refrigerator color.

3/8" backers are recessed 1/4" from the edge of the panel along the handle side. The edge of the backer will not be visible when the doors are closed.

### PANEL WEIGHT LIMITS

Refrigerator panel assemblies: 15 lbs. each

Freezer panel assembly: 15 lbs.

**NOTE:** If it becomes necessary to reduce panel assembly weight, you may remove a portion of the backer material. Cut non essential material from the center of the backer panels, leaving a minimum 4" perimeter. Suggested areas to remove are shaded on the illustration.

### BENEFITS OF A 3/8" BACKER OVER A 1/4" BACKER:

- Stronger final assembly with backer and spacer in one.
- Easier capping and finishing of a 3/8" edge.
- All three backers can be cut from a single sheet of 5'x5'x3/8" of baltic birch plywood.

**NOTE:** Omitting panels P2 and P3 in favor of a 1/4" veneered backer panel and 1/8" spacer panels behind overlay panels will result in trim being visible along the face, specifically on the hinge side edge of P2.

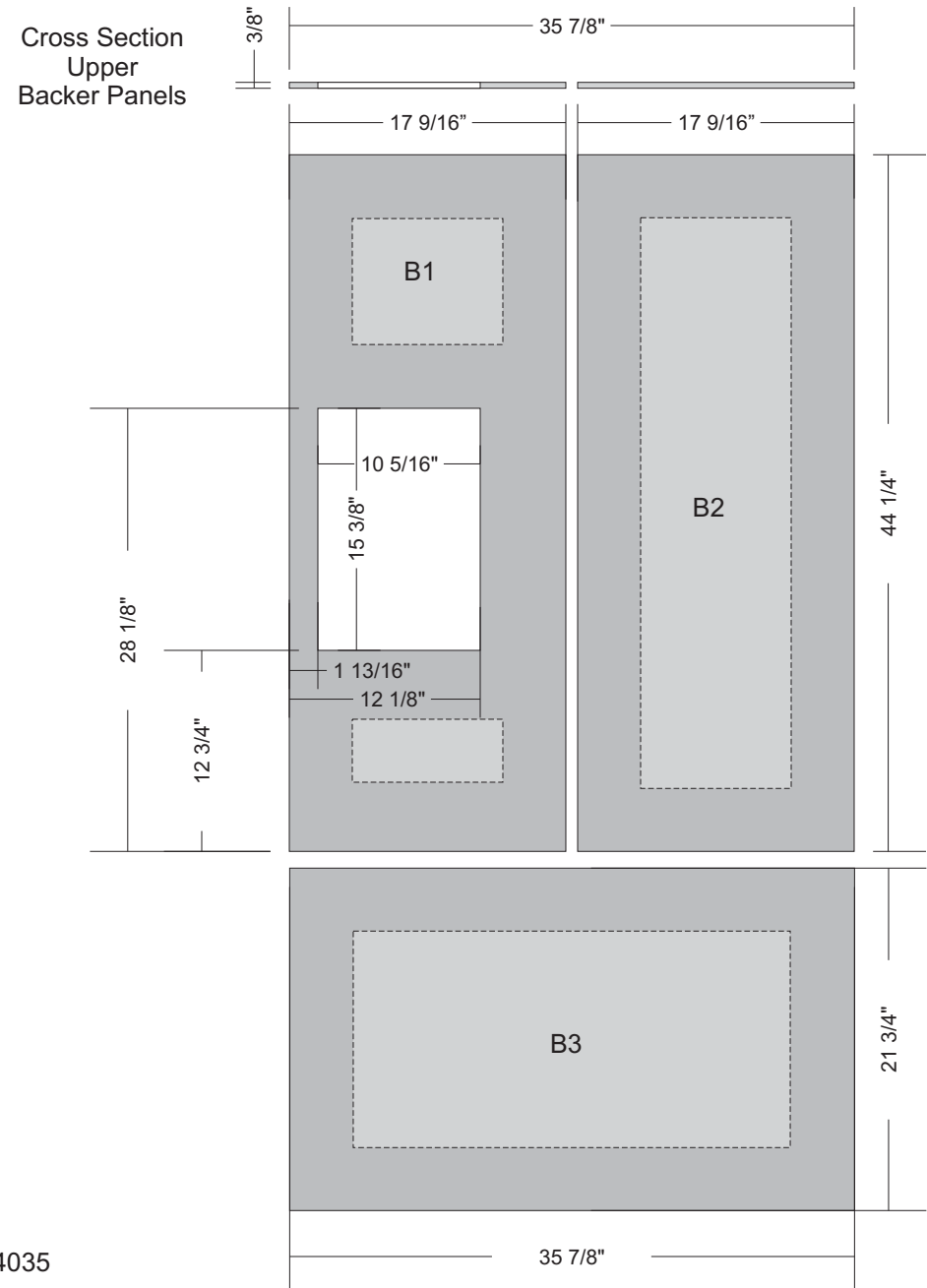

# JFI2089WTS Panel Dimension Guide

## 3/8" Backer Panel Cutting Detail

updated 11/14/11

**IMPORTANT: PLEASE READ ENTIRE DOCUMENT BEFORE BEGINNING WORK.**

**APPLIANCE TRIM:** Trim is designed to retain 1/4" material. A router with 3/8" rabbeting bit set 1/8" deep produces a 3/8" x 1/4" tab which fits behind the appliance trim. The fit of the tab can be snug. Installation can be aided greatly by a light sanding of the tab or additional light router pass to produce a tab with a 'skinny 1/4"' measurement. The tab is represented by lighter gray area in illustration. **DO NOT** cut a tab in the handle side of the two upper door backers.

**IMPORTANT:** The panel side of the 3/8" x 1/4" tab also needs to be routered with a 1/8" roundover bit. This allows the backer panel tab to slide in easier. More importantly, the edge of the backer will match the radius of the trim, so that the backer panels seat at full depth firmly behind the trim. The lower panel needs to be routered with a 1/8" roundover bit on all four sides.

**DISPENSER TRIM:** The dispenser trim is also designed to cover and retain a 1/4" backer material. A rabbet cut around the ice and water dispenser is necessary. The same 3/8" rabbeting bit used to produce the 3/8" x 1/4" tab in the backer edges can be used. Clean out of the corners with a chisel is necessary.

**ADDITIONAL DETAILS:** Notch off the corners of backer across the tabs. These notches allow room for the lapped miters of the appliance trim. A simple 45 degree cut off of the tab material at the corner avoids binding and difficult seating of the panel backer behind the trim.

Notches are shown in white on the illustration. **DO NOT** cut notches in the handle side of the two upper door backers.

Cross Section  
Upper  
Backer Panels

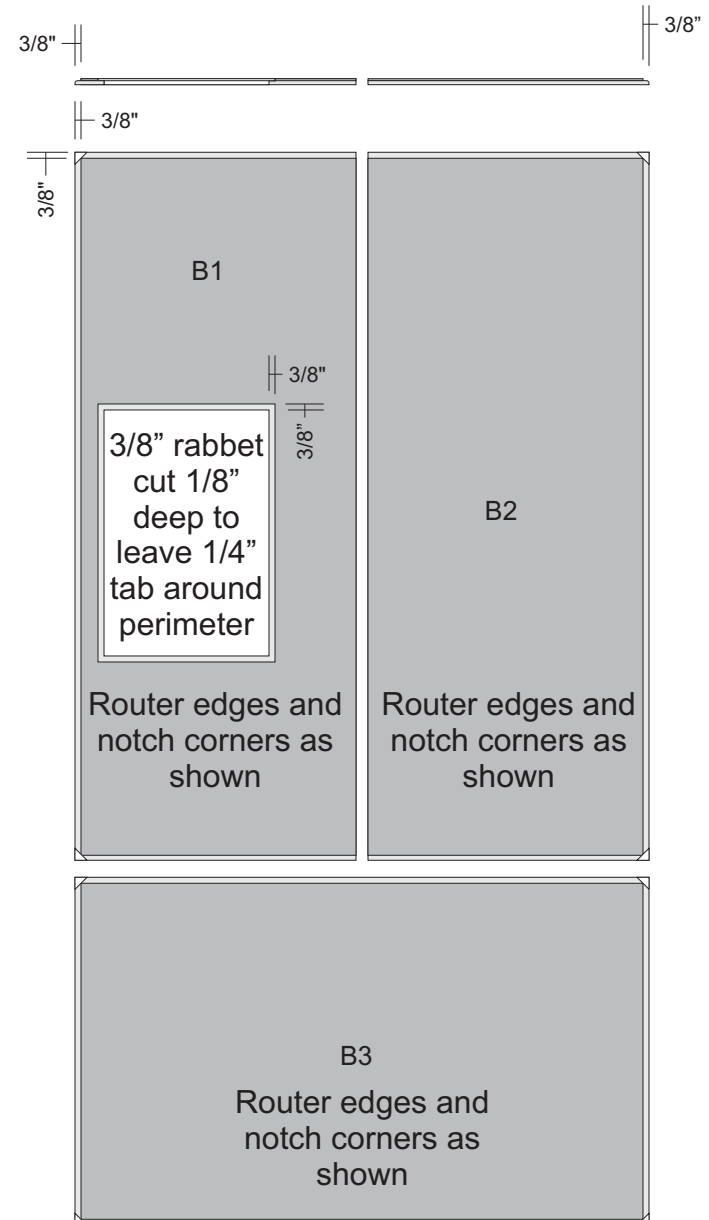

# JFI2089WTS Panel Dimension Guide

## Backer Panel Positions behind Overlay Panels

updated 11/14/11

IMPORTANT: PLEASE READ ENTIRE DOCUMENT BEFORE  
BEGINNING WORK.

Offsets are as shown.

Cross Section  
Upper Overlay and  
Backer Panels

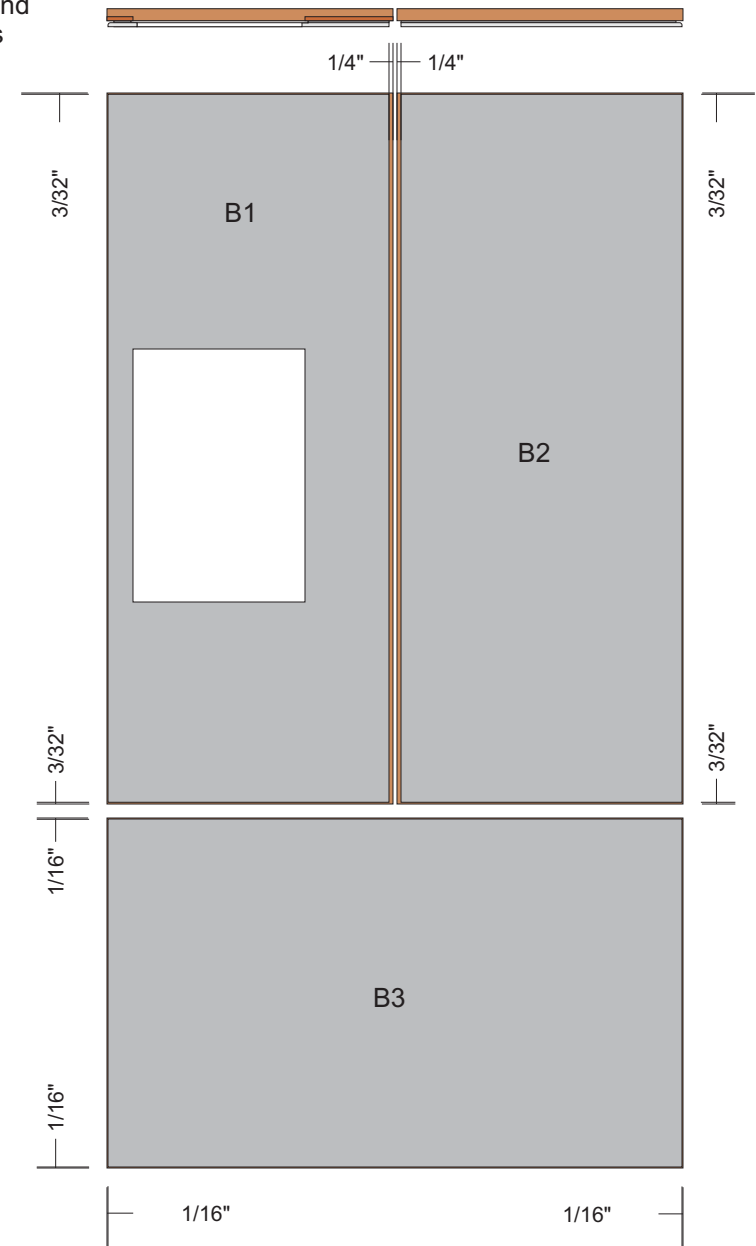

# JFI2089WTS Panel Dimension Guide

## 1/4" Decorator Panel Dimensions & Euro-Style Handle Stud Locations

updated 11/14/11

**IMPORTANT: PLEASE READ ENTIRE DOCUMENT BEFORE BEGINNING WORK.**

### THIS IS A SEPARATE ALTERNATIVE TO 3/4" OVERLAY PANELS

These dimensions are for 1/4" decorator panels. This is a separate alternative to overlay panels. Dimensions are in inches.

DESCR	HEIGHT	WIDTH	THICKNESS
P1	44 1/4"	17 3/4"	1/4"
P2	44 1/4"	17 3/4"	1/4"
P3	21 3/4"	35 7/8"	1/4"

**IMPORTANT:** This appliance has NO TRIM on the handle side of both upper doors. The cut edge of the decorator panel material will be exposed along the entire height of both upper panels and will require a cosmetic finish. The exposed edges can be capped with a strip of matching hardwood glued to the edge, edge banded with a wood veneer or stained or painted to match the panel finish.

**IMPORTANT:** The face side edges of the upper panels need to be routed with a 1/8" roundover bit on the top, bottom and hinge sides. This allows the panel to slide into the trim easier. More importantly, the edge profile of the panel will match the radius of the trim, so that the panels seat at full depth firmly behind the trim. DO NOT router the handle side edge. The face side edges of the lower panel need to be routed with a 1/8" roundover bit on all four sides.

**ADDITIONAL DETAILS:** Notching a small amount off corners of the panel is necessary. These notches allows room for the lapped miters of the appliance trim. A 3/8" x 3/8" 45 degree cut off of the corner avoids binding and difficult seating of the panel behind the trim. DO NOT cut notches in the handle side of the two upper panels. Notches are shown in white on the illustration.

Cross Section  
Upper Panels

