



**INSTBMRC-01**

**INSTBMRC-01**

**INSTBMRC-01**



### **KNOWLEDGE IS POWER**

Enhance your installation and fabrication skills by enrolling in the most recognized and respected mobile electronics school in our industry. Log onto [www.installerinstitute.com](http://www.installerinstitute.com) or call 800-354-6782 for more information and take steps toward a better tomorrow.



**Metra recommends using MECP certified technicians.**

## **INSTALLATION INSTRUCTIONS**

**READ IMPORTANT WARNING ON PAGE 1 BEFORE ATTEMPTING ANY INSTALLATION**

The BMRC-01 is designed to be used in non-amplified vehicles or in vehicles that the OEM amplifier is bypassed. The BMRC-01 retains all the factory warning chimes that would be lost when the OEM radio is removed. It will also provide a 10 amp 12 volt switched accessory wire for proper radio operation, and the R.A.P. feature (Retained Accessory Power) will be retained. The BMRC-01 also provides navigation outputs to help ease the installation process.

## **APPLICATIONS**

### **BMW**

1 Series 2008-up

### **Mini**

Cooper 2008-up

REV. 6/3/10

**METRA. THE WORLD'S BEST KITS.™**



**1-800-221-0932**



**[metraonline.com](http://metraonline.com)**

© COPYRIGHT 2004-2010 METRA ELECTRONICS CORPORATION

**METRA. THE WORLD'S BEST KITS.™**



**1-800-221-0932**



**[metraonline.com](http://metraonline.com)**

© COPYRIGHT 2004-2010 METRA ELECTRONICS CORPORATION



## INSTBMRC-01

### INTERFACE COMPONENTS

- A. BMRC-01
- B. 10 Pin To 16 Pin Harness

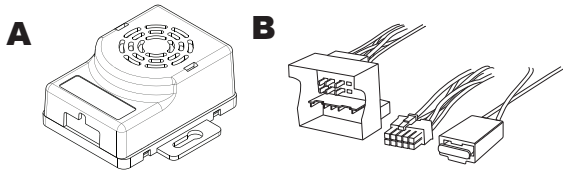

### REQUIRED TOOLS

- A. Cutting Tool
- B. Tape
- C. Crimping Tool
- D. Connectors (ie: butt-connectors, bell caps, ect...)

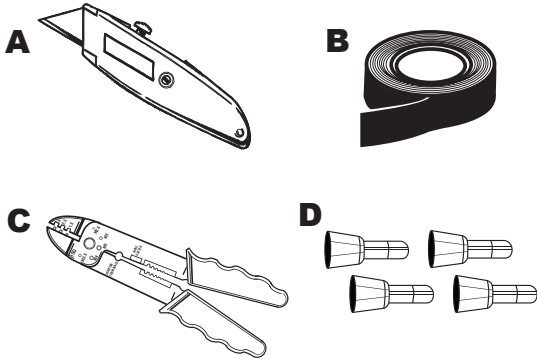

### WIRING UP THE BMRC-01

\* Important: Before beginning any of the following, disconnect the negative battery terminal to prevent an accidental short circuit.

#### CONNECTIONS TO BE MADE ON THE 10 PIN HARNESS:

1. Connect the Yellow wire to the radio's constant/memory wire along with the supplied 48" yellow wire to the battery. (bare end)
2. Connect the ring terminal of the supplied 48" yellow wire to the battery.
3. Connect the Red wire to the aftermarket radio's 12 volt accessory/switched wire.
4. Connect the Orange/White wire to the aftermarket radio's Illumination wire. If there is no Illumination wire on the aftermarket radio, just tape the Orange wire to prevent the wire from shorting out.
5. Connect the Black wire to the radio's radio ground wire
6. Connect the Blue/Pink wire to the aftermarket radio's VSS wire. If there is no VSS wire on the aftermarket radio, just tape the Blue/Pink wire to prevent the wire from shorting out.
7. Connect the Green/Purple wire to the aftermarket radio's Reverse wire. If there is no Reverse wire on the aftermarket radio, just tape the Green/Purple wire to prevent the wire from shorting out.
8. Connect the Light Green wire to the aftermarket radio's parking brake wire. If there is no parking brake wire on the aftermarket radio, just tape the Light Green wire to prevent the wire from shorting out.

#### CONNECTIONS TO BE MADE ON THE 16 PIN HARNESS:

1. Connect the Blue wire to the radio's radio antenna turn on wire.
2. Connect the White wire to the radio's left front (+) speaker wire.
3. Connect the White/Black wire to the radio's left front (-) speaker wire.
4. Connect the Gray wire to the radio's right front (+) speaker wire.
5. Connect the Gray/Black wire to the radio's right front (-) speaker wire.
6. Connect the Green wire to the radio's left rear (+) speaker wire.
7. Connect the Green/Black wire to the radio's left rear (-) speaker wire.
8. Connect the Purple wire to the radio's right rear (+) speaker wire.
9. Connect the Purple/Black wire to the radio's right rear (-) speaker wire.

#### INSTALLING THE BMRC-01

1. With all connections completed reconnect the negative battery terminal.
2. Plug the BMRC-01 into the vehicle and into the radio.
3. Cycle the key by turning the ignition on then back off, then on again.

#### TESTING THE BMRC-01

1. Turn the radio on and test for proper fading and balance controls.
2. Shut all the doors then turn the key off. The radio should stay on until the driver's door is opened.