

## FEATURES

- Built-in or freestanding option for design versatility.
- Built-in trim kits available to match Wolf ovens.
- Convection fan circulates air for even heat distribution.
- Touch control panel with interactive visual display and 10 preset power levels.
- Sensor cooking to monitor and adjust settings.
- Popcorn, beverage, baked potato, frozen entree or vegetables, bacon reheat, keep warm, soften, Gourmet and defrost settings.
- Auto start, multiple sequence and combination cooking features.
- Turntable is removable for easy cleaning.
- Microwave tray for popcorn and meat.
- Removable low rack for broiling and high rack for multiple-rack baking.
- Interior light and window in door.
- One-touch door open pad.
- Control panel lock.



## MODEL

Convection

MC24

## ACCESSORIES

- Trim kits to match Wolf ovens.

Accessories available through an authorized Wolf dealer. For local dealer information, visit the find a showroom section of our website, [wolfappliance.com](http://wolfappliance.com).

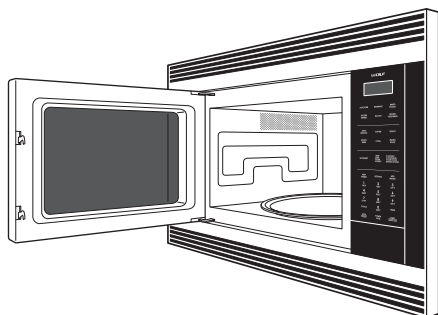

Model MC24 with E series stainless steel trim.

## SPECIFICATIONS

### PRODUCT

Freestanding	24 <sup>3</sup> / <sub>4</sub> "W x 14 <sup>7</sup> / <sub>8</sub> "H x 19"D
Trim Height	19 <sup>7</sup> / <sub>8</sub> "
27" Trim Width (E series only)	26 <sup>7</sup> / <sub>8</sub> "
30" Trim Width	29 <sup>7</sup> / <sub>8</sub> "
36" Trim Width (L series only)	35 <sup>5</sup> / <sub>8</sub> "
Weight	68 lb

### OVEN INTERIOR

Capacity	1.5 cu ft
Dimensions	16 <sup>1</sup> / <sub>8</sub> "W x 9 <sup>5</sup> / <sub>8</sub> "H x 16 <sup>1</sup> / <sub>8</sub> "D

### ELECTRICAL

Supply	120 VAC, 60 Hz
Service	15 amp circuit
Power Cord	4'

### POWER RATING

Microwave	900 W
Element	1450 W

Specifications are subject to change without notice. Visit [wolfappliance.com/specs](http://wolfappliance.com/specs) for the most up-to-date information.

Dimensions may vary  $\pm 1/8$ " (3). Dimensions in parentheses are millimeters unless otherwise specified.

## DIMENSIONS

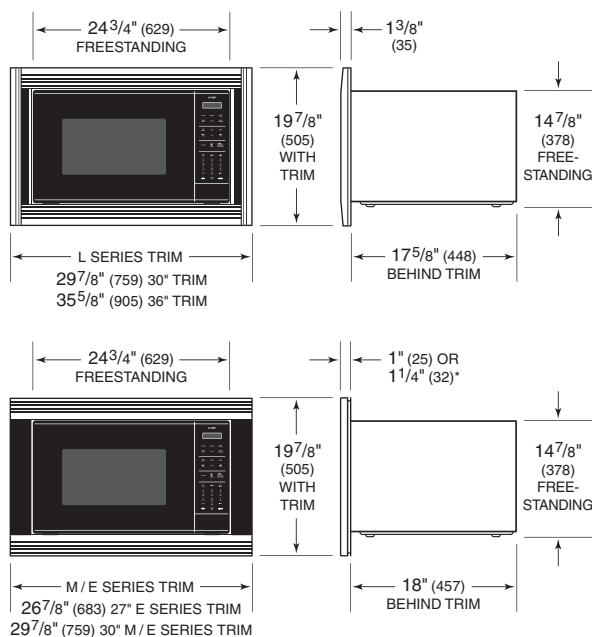

\*1<sup>1</sup>/<sub>4</sub>" (32) for contemporary E series trim only.

## STANDARD INSTALLATION

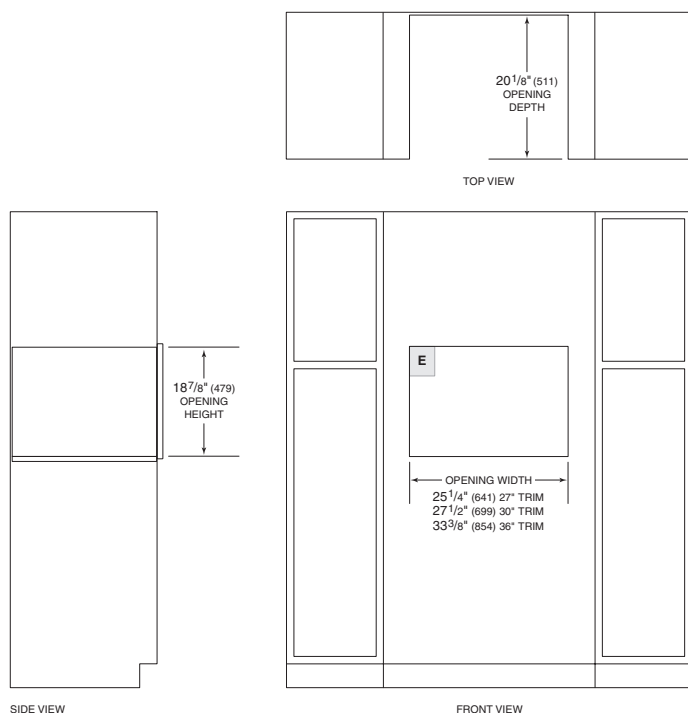

## FLUSH INSET INSTALLATION

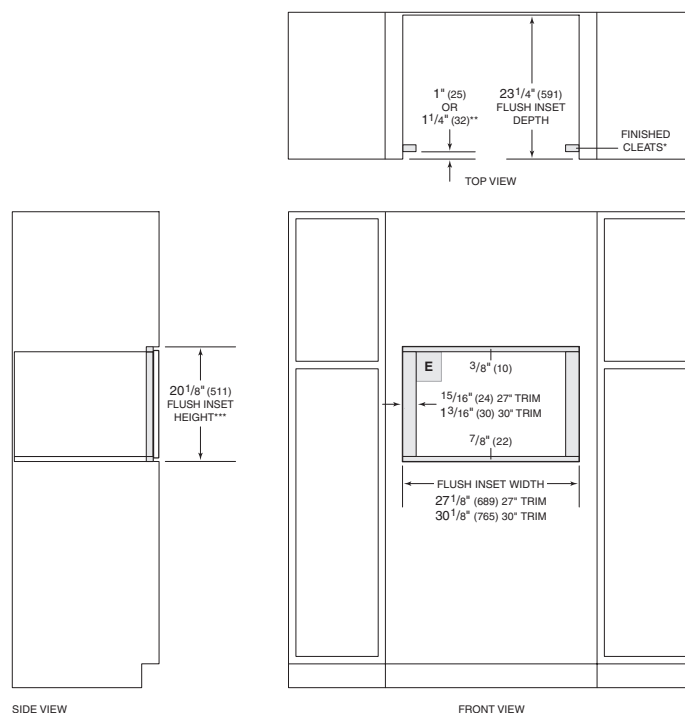

\*Will be visible and should be finished to match cabinetry.  
 \*\*1<sup>1</sup>/<sub>4</sub>" (32) for contemporary E series trim only.  
 \*\*\*Dimension provides minimum reveals.