

## FEATURES

- Custom front panel and hardware offer infinite design options.
- Integrated design allows for dual installation with integrated model.
- Protective features guard against the enemies of wine: heat, light, humidity and vibration.
- Full-view, UV-resistant glass door—high altitude glass available.
- Two independent storage zones with individual temperature range of 40°F to 65°F, maintain ideal storing and serving temperatures for all wines.
- Illuminated touch control panel.
- Discreet interior lighting with illuminated display rack for prized bottles of wine.
- Cherrywood-faced, roller-glide wine racks with full extension for easy access.
- Wine racks accommodate 750 ml bottles, half-bottles and magnums.
- Inventory tile system helps organize wine collection.
- Home security system connection.

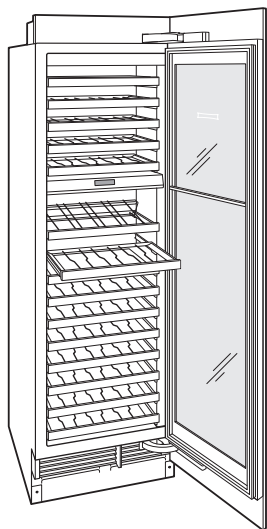

Model IW-24



### MODEL

Wine Storage	IW-24
--------------	-------

*Specify RH or LH door.*

### ENEMIES OF WINE

**Heat.** Two independent wine storage zones with temperature range of 40°F to 65°F.

**Light.** UV-resistant, bronze-tinted glass and dark rear wall protect against light exposure.

**Humidity.** Dual evaporators, one for each storage zone, maintain constant, moderate humidity.

**Vibration.** Wine racks glide smoothly, providing access without agitating the wine.

### ACCESSORIES

- Stainless steel front panel with tubular or pro handle.
- Stainless steel top and side enclosure panels.
- Stainless steel tubular and pro handles.
- Bulk storage drawer for wine in non-traditional containers.
- Dessert wine rack for storage of smaller bottles.
- Inventory tiles.
- Solid overlay door.
- Stainless steel kickplate.
- Air deflector for reduced toe kick.
- Dual installation kit for installation with another wine or integrated model.
- Door lock.

Accessories available through an authorized Sub-Zero dealer. For local dealer information, visit the find a showroom section of our website, [subzero.com](http://subzero.com).

**SPECIFICATIONS**

**PRODUCT**

Dimensions	24"W x 84"H x 24"D
Door Clearance	22 1/2"
Weight	410 lb

**CAPACITY**

Wine Storage	102 bottles (750 ml)
--------------	----------------------

**ELECTRICAL**

Supply	115 VAC, 60 Hz
Service	15 amp circuit

Product dimensions do not include panel or handle and will vary with panel thickness. Allow for panel thickness when planning the finished opening depth.

Specifications are subject to change without notice. Visit [subzero.com/specs](http://subzero.com/specs) for the most up-to-date information.

Dimensions may vary ±1/8" (3). Dimensions in parentheses are millimeters unless otherwise specified.

**DIMENSIONS**

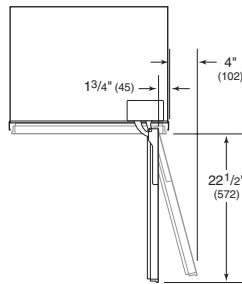
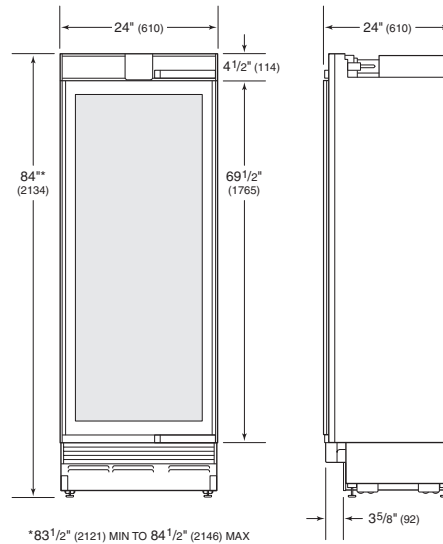

**ELECTRICAL**

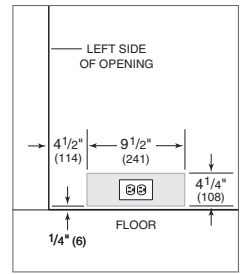

**INSTALLATION**

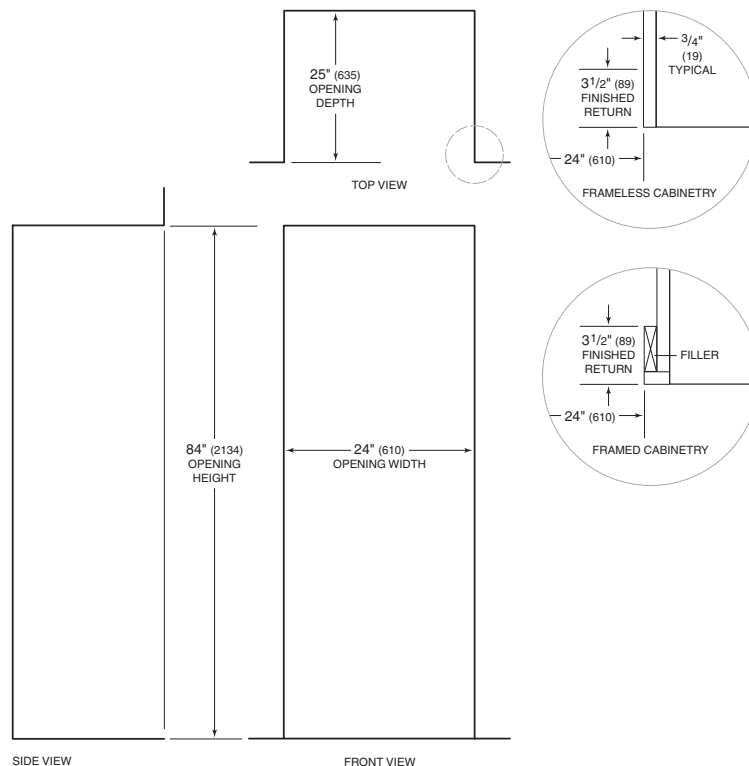

NOTE: 3 1/2" (89) finished returns will be visible and should be finished to match cabinetry.