

SHINOLA

WATCH OPERATION MANUAL
& WARRANTY BOOK



SHINOLA

DETROIT

CERTIFICATE OF WARRANTY

Model Number: | Numero del modelo:
Modèle: | 型号:
Modellnummer: | モデル番号:

Sold To: | Vendido a:
Vendu à: | 售予:
Verkauft an: | 販売先:

Country/Date: | Pais/Fecha:
Pays/Date: | 国家/日期:
Land/Datum: | 国/日付:

Sold By: | Vendido por:
Vendu par: | 出售方:
Verkauft durch: | 販売店:

Retailer Stamp: | Sello del vendedor:
Cachet du revendeur: | 零售商印章:
Stempel des Händlers: | 小売店のスタンプ:



INDEX

English..... Pg 04

Français..... Page 24

Deutsch.....S. 44

Español..... Pág. 64

中文..... 第 84

日本語.....ページ 104

DETROIT, U.S.A



Where American is made.[™]

As makers of handcrafted watches, bicycles, leather goods & journals,
we believe that products should be built to last, and they should be built
right here in America. Shinola stands for skill at scale, the preservation
of craft, the beauty of industry.

SCREW-DOWN CROWNS

CROWN FUNCTIONALITY

The components of your Shinola watch are made of the finest materials and have been rigorously inspected to meet our strict criteria. Some Shinola watches feature a screw-down crown, which adds an extra level of water-tightness. To safeguard your investment, it is important to understand how this type of crown works:

- 1 To make the crown operational, unscrew it from the case by turning it counterclockwise until it releases.
- Once released, follow the instructions for setting the time/date as described in the next sections.
- 2 To reseal the crown, press it in against the case until the threads engage, and turn clockwise until tight.



WATCH MODELS WITH DATE INDICATOR

PLEASE NOTE:

- If your watch features a date indicator, the date window might be in a different position from the one depicted in this manual.
- When performing a quick date setting (as described further under the sections **SETTING THE DATE**), the time indicated by your watch should not be between 9:30 p.m. and 3:00 a.m. This is because as the hands approach midnight on the watch during its normal operation, gears begin to engage with the date wheel and lock into place. Manually setting the date during that particular period of time could possibly result in damage to the small teeth on the gears.

SINGLE TIME MODELS

SETTING THE TIME

- 1 Pull out the crown to position II.
(The watch stops.)
- 2 Turn the crown until you reach the correct time.
- 3 Push the crown back to position I.



SINGLE TIME WITH DATE MODELS

SETTING THE TIME

- 1 Pull out the crown to position III.
(The watch stops.)
- 2 Turn the crown until you reach the correct time.
- 3 Push the crown back into position I.

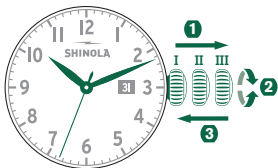

SETTING THE DATE

- 1 Pull out the crown to position II.
(The watch continues to run.)
- 2 Turn the crown until the correct date appears.
- 3 Push the crown back to position I.

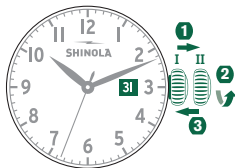

CHRONOGRAPH MODEL 5021.D

DESCRIPTION OF THE DISPLAY AND CONTROL BUTTONS

Please note:

Before using the chronograph functions, please ensure that:

- the crown is in position **I** (= normal position).
- the two chronograph hands are precisely at zero position following activation of push-button **B**. If the hands are not precisely at zero, their positions must be adjusted. (See the chapter *Adjusting the Chronograph Hands to Zero.*)

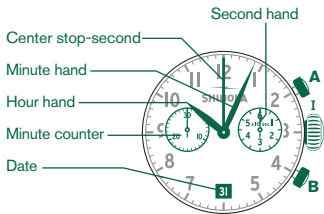

SETTING THE TIME

- 1 Pull out the crown to position **III**. (The watch stops.)
- 2 Turn the crown until you reach the correct time.
- 3 Push the crown back to position **I**.

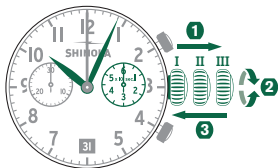

SETTING THE DATE

- 1 Pull out the crown to position **II**. (The watch continues to run.)
- 2 Turn the crown until the correct date appears.
- 3 Push the crown back to position **I**.

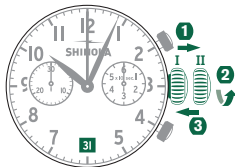

ADJUSTING THE CHRONOGRAPH HANDS TO ZERO

- 1 Pull crown out to position **III**.
(All two chronograph hands are in their correct or incorrect zero position.)
- 2 Keep push-buttons **A** and **B** depressed **simultaneously** for at least 2 seconds.
(The center stop-second rotates by 360° - corrective mode is activated.)
- 3 Press push-button **A** to single step the **center stop-second hand**. Press and hold push-button **A** to advance the center stop-second hand quickly. **3b** Press push-button **B** to advance to the next hand.
- 4 Press push-button **A** to single step the **minute counter hand**. Press and hold push-button **A** to advance the minute counter hand quickly.
- 5 Return the crown to position **I**.

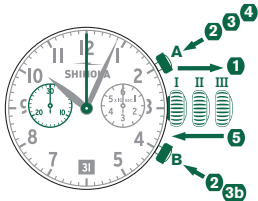

BASIC FUNCTION (START / STOP / RESET)

Example

- 1 **Start:** press push-button **A**.
- 2 **Stop:** to stop the timing, press push-button **A** once more and read the two chronograph counters: 20min / 10sec.
- 3 **Zero positioning:** Press push-button **B**.
(The two chronograph hands will be reset to their zero positions.)

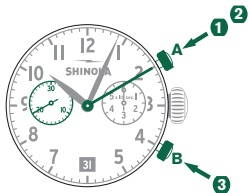

ACCUMULATED TIMING

Example

- 1 Start:** start timing
- 2 Stop:** e.g., 15 min. 5 sec. following **1**.
- 3 Restart:** timing is resumed
- 4 *Stop:** e.g., 13 min. 5 sec. following **3**.
The accumulated time = 28 min. 10 sec.
- 5 Reset:** the three chronograph hands are returned to their zero positions.

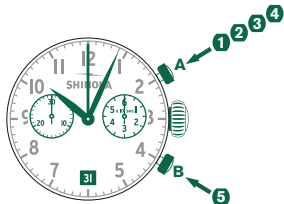

Please note:

- * Following **4**, the accumulation of the timing can be continued by pressing push-button **A** (Restart/Stop, Restart/Stop,...)

INTERMEDIATE OR INTERVAL TIMING

Example

- 1 Start:** start timing.
- 2 Display interval:**
e.g., 10 min. 10 sec. following **1**.
Timing continues in the background.
- 3 Making up the measured time:**
the two chronograph hands are quickly advanced to the ongoing measured time.
- 4 Stop:** e.g., 28 min. 10 sec. following **1**.
- 5 Reset:** the three chronograph hands are returned to their zero positions.

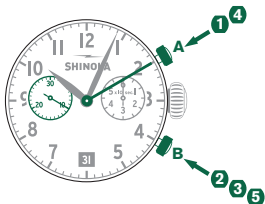

Please note:

- * Following **3**, further intervals or intermediates can be displayed by pressing **B** (display interval / make up measured time, ...)

CHRONOGRAPH MODEL 5030.D

DESCRIPTION OF THE DISPLAY AND CONTROL BUTTONS

Please note:

Before using the chronograph functions, please ensure that:

- the crown is in position **I** (= normal position).
- the three chronograph hands are precisely at zero position following activation of push-button **B**. If the hands are not precisely at zero, their positions must be adjusted. (See the chapter *Adjusting the Chronograph Hands to Zero.*)

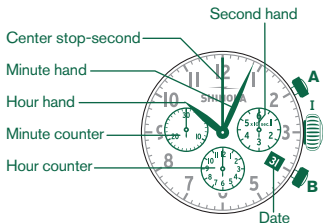

SETTING THE TIME

- 1 Pull out the crown to position **III**. (The watch stops.)
- 2 Turn the crown until you reach the correct time.
- 3 Push the crown back to position **I**.

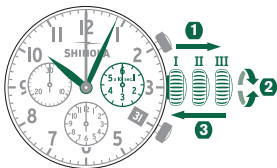

SETTING THE DATE

- 1 Pull out the crown to position **II**. (The watch continues to run.)
- 2 Turn the crown until the correct date appears.
- 3 Push the crown back to position **I**.

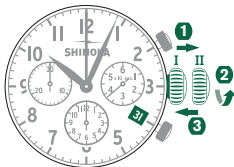

ADJUSTING THE CHRONOGRAPH HANDS TO ZERO

- 1 Pull crown out to position **III**.
(All three chronograph hands are in their correct or incorrect zero position.)
- 2 Keep push-buttons **A** and **B** depressed **simultaneously** for at least 2 seconds.
(The center stop-second hand rotates by 360° - corrective mode is activated.)
- 3 Press push-button **A** to single step the **center stop-second hand**. Press and hold push-button **A** to advance the center stop-second hand quickly. **3b** Press push-button **B** to advance to the next hand.
- 4 Press push-button **A** to single step the **hour counter hand**. Press and hold push-button **A** to advance the hour counter hand quickly. **4b** Press push-button **B** to advance to the next hand.
- 5 Press push-button **A** to single step the **minute counter hand**. Press and hold push-button **A** to advance the minute counter hand quickly.
- 6 Return the crown to position **I**.

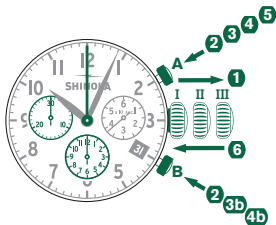

BASIC FUNCTION (START / STOP / RESET)

Example

- 1 **Start:** press push-button **A**.
- 2 **Stop:** to stop the timing, press push-button **A** once more and read the three chronograph counters: 1h / 20min / 10sec.
- 3 **Zero positioning:** Press push-button **B**.
(The three chronograph hands will be reset to their zero positions.)

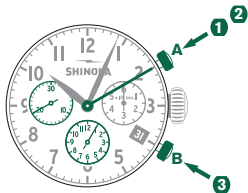

ACCUMULATED TIMING

Example

- ➊ **Start:** start timing
- ➋ **Stop:** e.g., 15 min. 5 sec. following ➊.
- ➌ **Restart:** timing is resumed
- ➍ ***Stop:** e.g., 13 min. 5 sec. following ➌.
The accumulated time = 28 min. 10 sec.
- ➎ **Reset:** the three chronograph hands are returned to their zero positions.

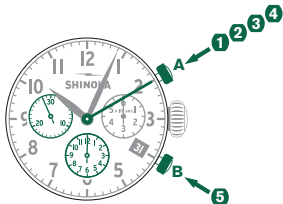

Please note:

- * Following ➍, the accumulation of the timing can be continued by pressing push-button **A** (Restart/Stop, Restart/Stop,...)

INTERMEDIATE OR INTERVAL TIMING

Example

- ➊ **Start:** start timing.
- ➋ **Display interval:**
e.g., 10 min. 10 sec. following ➊.
Timing continues in the background.
- ➌ **Making up the measured time:**
the three chronograph hands are quickly advanced to the ongoing measured time.
- ➍ **Stop:** e.g., 28 min. 10 sec. following ➌.
- ➎ **Reset:** the three chronograph hands are returned to their zero positions.

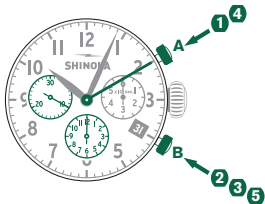

Please note:

- * Following ➌, further intervals or intermediates can be displayed by pressing **B** (display interval / make up measured time, ...)

CHRONOGRAPH MODEL 5050.B

DESCRIPTION OF THE DISPLAY AND CONTROL BUTTONS

Please note:

Before using the chronograph functions, please ensure that:

- the crown is in position **I** (= normal position).
- the four chronograph hands are precisely at zero position following activation of push-button **B**. If the hands are not precisely at zero, their positions must be adjusted. (See the chapter *Adjusting the Chronograph Hands to Zero*.)

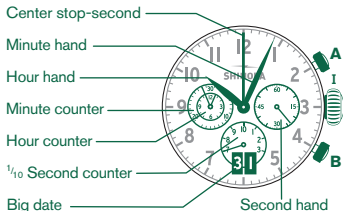

SETTING THE TIME

- 1 Pull out the crown to position **III**. (The watch stops.)
- 2 Turn the crown until you reach the correct time.
- 3 Push the crown back to position **I**.

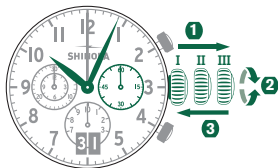

SETTING THE DATE

- 1 Pull out the crown to position **II**. (The watch continues to run.)
- 2 Turn the crown until the correct date appears.
- 3 Push the crown back to position **I**.

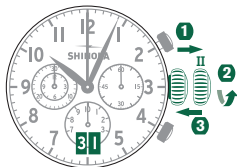

ADJUSTING THE CHRONOGRAPH HANDS TO ZERO

- 1 Pull crown out to position **III**.
(All four chronograph hands are in their correct or incorrect zero position.)
- 2 Keep push-buttons **A** and **B** depressed **simultaneously** for at least 2 seconds.
(The center stop-second rotates by 360° - corrective mode is activated.)
- 3 Press push-button **A** to single step the **center stop-second hand**. Press and hold push-button **A** to advance the center stop-second hand quickly. **3b** Press push-button **B** to advance to the next hand.
- 4 Press push-button **A** to single step the **1/10 second counter hand**. Press and hold push-button **A** to advance the **1/10 second hand** quickly. **4b** Press push-button **B** to advance to the next hand.
- 5 Press push-button **A** to single step the **minute** and the **hour counter hands**. Press and hold push-button **A** to advance the **minute** and **hour counter** hands quickly. **4b** Press push-button **B** to advance to the next hand.
- 6 Return the crown to position **I**.

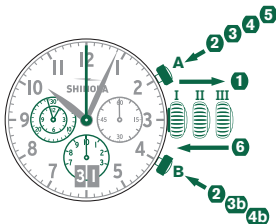

BASIC FUNCTION (START / STOP / RESET)

Example

- 1 **Start:** Press push-button **A**.
- 2 **Stop:** to stop the timing, press push-button **A**. once more and read the four chronograph counters: 4 hr. / 20 min. / 5 sec. / 7/10 sec.
- 3 **Zero positioning:** Press push-button **B**.
(The four chronograph hands will be reset to their zero positions.)

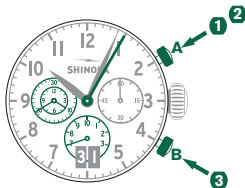

ACCUMULATED TIMING

Example

- 1 Start:** start timing.
- 2 Stop:** e.g., 15 min. 5 sec. following **1**.
- 3 Restart:** timing is resumed.
- 4 *Stop:** e.g., 10 min. 5 sec. following **3**.
The accumulated time = 25 min. 10 sec.
- 5 Reset:** The four chronograph hands are returned to their zero positions.

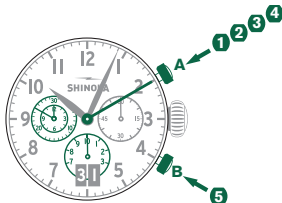

Please note:

* Following **4**, the accumulation of the timing can be continued by pressing push-button **A** (Restart/Stop, Restart/Stop,...)

INTERMEDIATE OR INTERVAL TIMING

Example

- 1 Start:** start timing.
- 2 Display interval:**
e.g., 10 min. 10 sec. following **1**.
Timing continues in the background.
- 3 Making up the measured time:**
the four chronograph hands are quickly advanced to the ongoing measured time.
- 4 Stop:** (Final time is displayed).
- 5 Reset:** The four chronograph hands are returned to their zero positions.

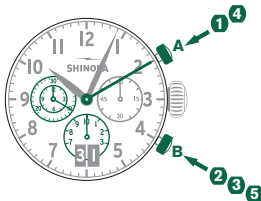

Please note:

* Following **3**, further intervals or intermediates can be displayed by pressing **B** (display interval / make up measured time, ...)

CHRONOGRAPH MODEL 3540.D

DESCRIPTION OF THE DISPLAY AND CONTROL BUTTONS

Please note:

Before using the chronograph functions, please ensure that:

- the crown is in position **I** (= normal position).
- the three chronograph hands are precisely at zero position following activation of push-button **B**. If the hands are not precisely at zero, their positions must be adjusted. (See the chapter *Adjusting the Chronograph Hands to Zero*.)

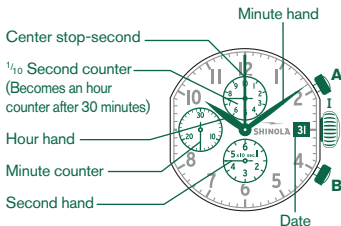

SETTING THE TIME

- 1 Pull out the crown to position **III**. (The watch stops.)
- 2 Turn the crown until you reach the correct time.
- 3 Push the crown back into position **I**.

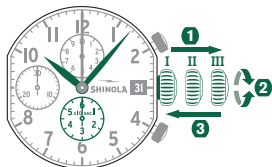

SETTING THE DATE

- 1 Pull out the crown to position **II**. (The watch continues to run.)
- 2 Turn the crown anticlockwise until the correct date appears.
- 3 Push the crown back into position **I**.

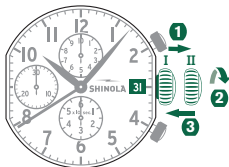

ADJUSTING THE CHRONOGRAPH HANDS TO ZERO

- 1 Pull crown out to position **III**.
(All three chronograph hands are in their correct or incorrect zero position.)
- 2 Keep push-buttons **A** and **B** depressed **simultaneously** for at least 2 seconds.
(The center stop-second rotates by 360° - corrective mode is activated.)
- 3 Press push-button **A** to single step the **center stop-second** hand. Press and hold push-button **A** to advance the center stop-second hand quickly. **3b** Press push-button **B** to advance to the next hand.
- 4 Press push-button **A** to single step the **hour counter** hand. Press and hold push-button **A** to advance the hour counter hand quickly. **4b** Press push-button **B** to advance to the next hand.
- 5 Press push-button **A** to single step the **minute counter** hand. Press and hold push-button **A** to advance the minute counter hand quickly.
- 6 Return the crown to position **I**.

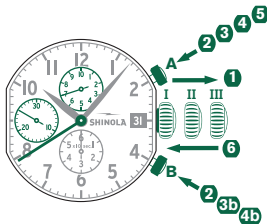

BASIC FUNCTION (START / STOP / RESET)

Example

- 1 **Start:** Press push-button **A**.
- 2 **Stop:** to stop the timing, press push-button **A** once more and read the three chronograph counters: 4 min. / 38 sec. / 7/10 sec.
- 3 **Zero positioning:** Press push-button **B**.
(The three chronograph hands will be reset to their zero positions.)

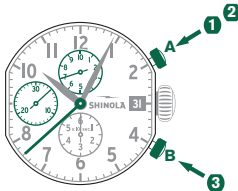

ACCUMULATED TIMING

Example

- 1 Start:** start timing.
- 2 Stop:** e.g., 15 min. 5 sec. following **1**.
- 3 Restart:** timing is resumed.
- 4 *Stop:** e.g., 13 min. 5 sec. following **3**.
The accumulated time = 28 min. 10 sec.
- 5 Reset:** The three chronograph hands are returned to their zero positions.

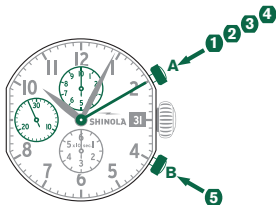

Please note:

* Following **4**, the accumulation of the timing can be continued by pressing push-button **A** (Restart/Stop, Restart/Stop,...)

INTERMEDIATE OR INTERVAL TIMING

Example

- 1 Start:** start timing.
- 2 Display interval:**
e.g., 10 min. 10 sec. following **1**.
Timing continues in the background.
- 3 Making up the measured time:**
the three chronograph hands are quickly advanced to the ongoing measured time.
- 4 Stop:** e.g., 28 min. 10 sec. following **1**.
- 5 Reset:** The three chronograph hands are returned to their zero positions.

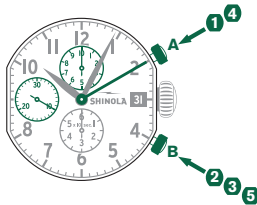

Please note:

* Following **3**, further intervals or intermediates can be displayed by pressing **B** (display interval / make up measured time, ...)

WATER RESISTANCE

All the Shinola timepieces are designed with a minimum water-resistance rating of 3ATM (100ft / 30m).

The water-resistance of a timepiece protects the movement from dust, moisture, and risk of damage to the movement should it be immersed in water. Please see chart for guidelines for recommended exposure of various water ratings.

It is important not to attempt to adjust the position of the crown while the timepiece is in contact with water. Water can enter the case causing damage to the movement. For timepieces with screw-down crowns, it is important to ensure the crown is in the proper position and completely locked before contact with water. For timepieces with chronograph functions, do not engage the chronograph under water, as water may leak into the case and cause damage to the movement.

INDICATION		WATER-RELATED USE			
	Water-Resistance Characteristics	Light Spray, Perspiration, Light Rain, etc.	Bathing, etc.	Swimming, etc.	Skin Diving (Diving without oxygen cylinder)
1	3 ATM	OK	NO	NO	NO
2	5 ATM	OK	OK	NO	NO
3	10 ATM	OK	OK	OK	NO
4	20 ATM	OK	OK	OK	OK
5	30 ATM	OK	OK	OK	OK

ALWAYS SET THE CROWN IN THE NORMAL POSITION AND TIGHTEN SCREW LOCK CROWN COMPLETELY.

CARE AND PRECAUTION

Each Shinola timepiece is designed and manufactured to the highest of standards. Unlike most other mechanical objects, a watch operates non-stop. In order to ensure optimal performance and longevity from your Shinola timepiece, please review the simple guidelines for care and precautions.

CARE

- Clean your watch with a soft cloth and water only. Do not submerge your watch under water unless it is water rated.
- After saltwater use, rinse watch under tap water and wipe dry with a soft cloth.
- Metal bracelets should be cleaned periodically. Clean with a soft brush dipped in mild soapy water and dry thoroughly with a soft cloth.
- We advise having your timepiece serviced every 18 – 24 months to ensure long use and trouble free operation.

PRECAUTIONS

Your timepiece is a complex integration of parts and components brought together by skilled craftsmen. There are certain actions or environmental situations that may damage or impede your timepiece's ability to perform optimally.

It is important to avoid the following conditions: extreme heat or cold, as well as prolonged periods of exposure to direct sunlight, exposure to wet conditions that exceed your timepiece's water rating. (See caseback and chart).

Your timepiece should not be affected by magnetic fields generated by household items such as televisions and stereos, but avoidance of other strong electric fields or static electricity, which may interrupt mechanism, is suggested. It is also important to avoid extreme shock or impact.

POWER SAVING MECHANISM

In order to extend the battery life of your watch when it's not in use, gently pull the movement stem/crown out until you feel it click. This will reduce battery power consumption

by 70%. Please note that this is the same stem/crown position that is used to perform a quick TIME SETTING. If your watch features a screw-down crown, follow the instructions at the beginning of this manual to release the crown before pulling it out all the way.

END OF BATTERY LIFE (EOL)

Your watch is equipped with a feature to indicate when the battery level is low. When the battery gets to that stage, the second hand will jump 4 steps at a time, every 4 seconds. This behavior lowers the power consumption while still displaying the time accurately and letting you know that it is time to change the battery.

LEATHER CONDITIONING BALM

Unique formula cleans, polishes and protects, leaving a soft satiny finish that retards water spotting and cracking. Enhances the life and natural lustre of your leather watch strap. May be used safely on all colors of Shinola leather watch strap (**please note that use of this product may darken the color of your watch strap**). Do not use on suede or nubuck.

Directions: Apply a small amount with soft cloth, let dry and buff lightly.

Ingredients: Paraffin wax, Tallow, and Mink Oil.

Caution: Do not take internally. KEEP OUT OF REACH OF CHILDREN

LIMITED LIFETIME WARRANTY

Your SHINOLA watch is warranted by Shinola for the lifetime of the watch under the terms and conditions of this warranty. The Shinola warranty covers faulty workmanship under normal use for the lifetime of the product. In case of defects covered by the warranty, all components (excluding battery, leather strap and buckle) will be repaired or the watch will be replaced free of charge. In the case of a replacement, Shinola cannot guarantee that you will receive the same watch model. If your model is not available a watch of equal value and similar style will be provided. A copy of the receipt and/or your completed Certificate of Warranty is required as proof of purchase. A check or money order payable to Shinola/Detroit, LLC in the amount of \$25.00 as service and handling fee must be included for all warranty and repair services. The fee is subject to change.

THIS WARRANTY DOES NOT COVER

- Leather strap, battery or buckle
- Damage resulting from improper handling, lack of care, accidents or normal wear and tear
- Water damage unless marked water-resistant
- This warranty is void if the watch has been damaged by accident, negligence of persons other than authorized Shinola sales or services agents, unauthorized service, or other factors not due to defects in materials or workmanship.
- The following warranties and remedies are exclusive and in lieu of all other warranties, terms or conditions, express, implied or statutory, as to any matter whatsoever, including, without limitation, warranties of merchantability, fitness for a particular purpose, accuracy, satisfactory quality, title, and non-infringement, all of which are expressly disclaimed by Shinola. Shinola shall not be liable for incidental, consequential, indirect, special or punitive damages or liabilities of any kind arising out of or in connection with the sale or use of this product, whether based in contract, tort (including negligence), strict product liability or any other theory, even if Shinola has been advised of the possibility of such damages and even if any limited remedy specified herein is deemed to have failed of its essential purpose. Shinola's entire liability shall be limited to replacement or repair at Shinola's sole option. However some countries, states, or provinces do not allow the exclusion or

limitation of implied warranties or the limitation of incidental consequential damages so the above limitations and exclusions may be limited in their application to you. When implied warranties may not be excluded in their entirety, they will be limited to the duration of the applicable written warranty. This warranty gives you specific legal rights; you may have other rights that may vary depending on local law. Your statutory rights are not affected.

▪ If you have your watch battery replaced by any service provider other than a Shinola authorized service center, such replacement will not void your warranty, so long as such replacement (i) is performed by an experienced and legitimate service center, (ii) is not performed in a negligent manner, and (iii) is reassembled properly, including without limitation, replacement of gasket if necessary to achieve suitable water-tightness. Shinola has the right to determine, in its sole and absolute discretion, if any such third party battery replacement voids your warranty.

REQUESTING WARRANTY AND OTHER WATCH REPAIR

Should you require work under warranty, please send in your watch, a copy of your sales receipt and/or the Certificate of Warranty, and a completed watch repair form, which can be found on the Shinola website (www.shinola.com), to the authorized international watch service center listed below. Do not send original packaging, as it will not be returned. Shinola highly recommends you insure your parcel and adequately protect the watch during shipment. Shinola is not responsible for product lost or damaged during shipment.

For service work that is not covered under this warranty, the service center may perform the services you request for a charge dependent on watch style and type of work requested. Such charges will be notified and agreed by you prior to performing the services.

In addition to repair charges, if required, a service and handling fee of \$25.00 will be charged for all repairs and warranty services. Such fee must be prepaid by check or money order payable to Shinola/Detroit, LLC at the time of delivery of the watch to the repair center. This fee is subject to change.

INTERNATIONAL WARRANTY & REPAIRS

SHINOLA / DETROIT, LLC

485 W. Milwaukee St. Suite 501
Detroit, MI 48202

1-888-304-2534

www.shinola.com

