

# **LIEBHERR**

**Design Guide 2012**  
**Fully Integrated Models 30" and 36"**

**Liebherr's engineering excellence in Germany provides the largest selection of freezers, refrigerators and wine refrigerators worldwide.**

Liebherr-appliances specializes in the manufacturing of high quality freezers and refrigerators. With more than 300 basic models, we have the widest selection in the world. Liebherr appliances feature premium quality, numerous innovative product ideas and advanced design. Liebherr freezers and refrigerators are manufactured at three modern production plants:

Liebherr Marica in Bulgaria, Liebherr-Hausgeräte Ochsenhausen GmbH in Germany and the Liebherr-Hausgeräte Lienz GmbH in Austria.

The appliances for the North American market are produced in Austria and in Germany.

Liebherr is committed to the protection of the environment and recognizes it as a critical priority. To guarantee an optimum and consistent implementation, all ecological aspects were observed and integrated into the quality control of Liebherr in compliance with DIN EN ISO 9001.

**Liebherr's Commitment to the Environment**

The components of Liebherr products can be recycled when the necessary resources are available. A concern for the environment and a desire to protect resources has led to increased levels of recycling year after year. When Liebherr manufactures products, it is essential that the recyclable recovery rate of the materials we use constantly increases.

Recycling is a common goal among all manufacturers, municipalities and recycling companies to protect our environment. Protecting the environment and producing products which have a low impact on the environment, is one of Liebherr's core values. When the time comes, please attempt to dispose of your old appliances in an environmentally safe and friendly manner.

# Introduction

---

## LIEBHERR WARRANTY PLAN

**FULL TWO YEAR WARRANTY** - For two years from the date of original purchase, your Liebherr Warranty covers all parts and labor to repair or replace any part of the product which proves to be defective in materials or workmanship.

**FULL FIVE YEAR WARRANTY** - For five years from the date of original purchase, your Liebherr Warranty covers all parts and labor to repair or replace any components that prove to be defective in materials or workmanship in the sealed system. The "Sealed System" means only the compressor, condenser, evaporator, drier and all connecting tubing.

**LIMITED 6TH THROUGH 12TH YEAR WARRANTY** - From the 6th through 12th year from the date of original purchase, your Liebherr Warranty covers all parts that prove to be defective in materials or workmanship in the sealed system (parts only).

### For Service and Parts in the U.S.:

#### Liebherr Service Center

15545 N. 77th Street  
Scottsdale, AZ 85260

Phone: (480) 998-0141  
Fax: (480) 998-7877  
Toll Free: **1-866-LIEBHERR or**  
**1-866-543-2437**

**[www.liebherr.us/HG](http://www.liebherr.us/HG)**

### For Service and Parts in Canada:

#### Euro Parts

579 Campbell Street,  
P.O. Box 759,  
Lucknow, Ontario, N0G 2H0

Phone: (519)528-5005  
Fax: (519)528-5001  
Toll Free: **1-888-Liebherr or**  
**1-888-543-2437**

**[www.euro-parts.ca](http://www.euro-parts.ca)**

**or**

**[www.liebherr.ca/HG](http://www.liebherr.ca/HG)**

# Fully Integrated

## Unit Dimensions

Overall height can be increased on HC 20 and HCB 20 units by 1-1/2" (40 mm) by adjusting the roller base.

Please allow for door swing clearance at locations next to a wall.

The illustrated measurement is without mounted front panels. Be sure to add your panel thickness and handle depth to this measurement in order to avoid interferences.

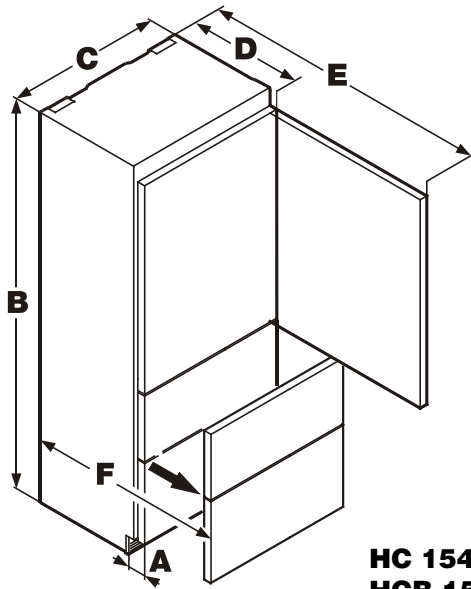

### HC 1540, HC 1541 HCB 1560, HCB 1561

- A. 3" (76 mm)
- B. 79-13/16" (2027 mm)
- C. 29-7/8" (757 mm)
- D. 24" (610 mm)
- E. 55-1/4" (1403 mm)
- F. 37-1/8" (943 mm)

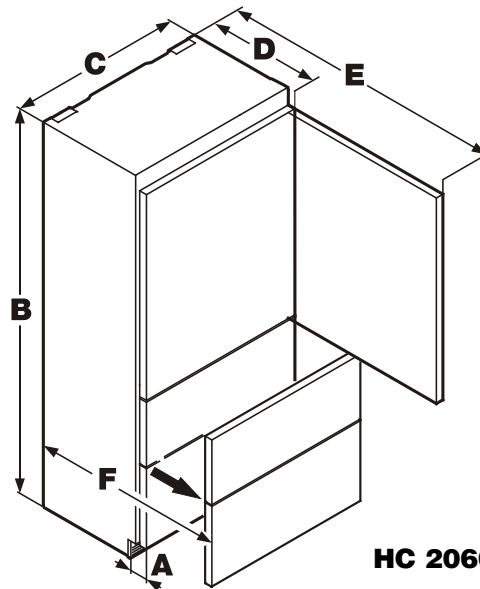

### HC 2060, HC 2061

- A. 3" (76 mm)
- B. 79-13/16" (2027 mm)
- C. 35-13/16" (910 mm)
- D. 24" (610 mm)
- E. 61-1/4" (1556 mm)
- F. 37-1/8" (943 mm)

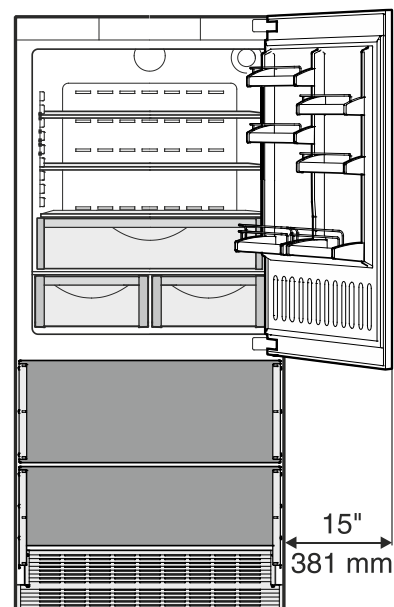
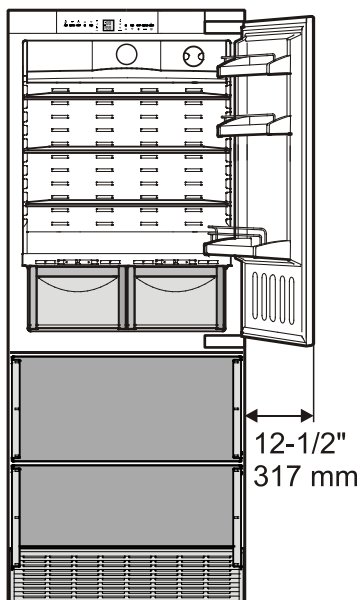

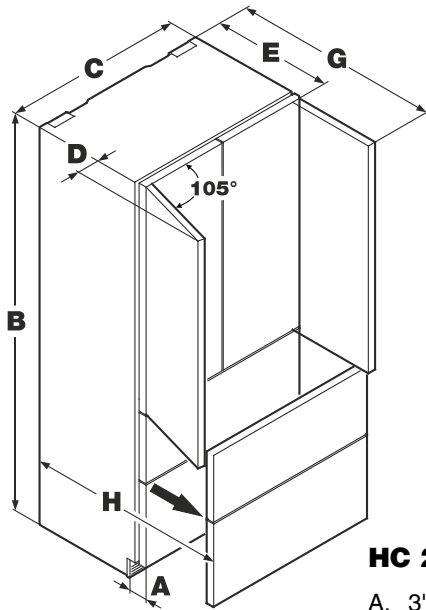

### **HC 2062, HCB 2062**

- A. 3" (76 mm)
- B. 79-13/16" (2027 mm)
- C. 35-13/16" (910 mm)
- D. 3" (76 mm)
- E. 24" (610 mm)
- G. 42-7/16" (1078 mm)
- H. 37-1/8" (943 mm)

Front Clearance

↑ This type of dimension line indicates the height measured from the floor.

HC 1540, HC 1541  
HC 1560, HC 1561

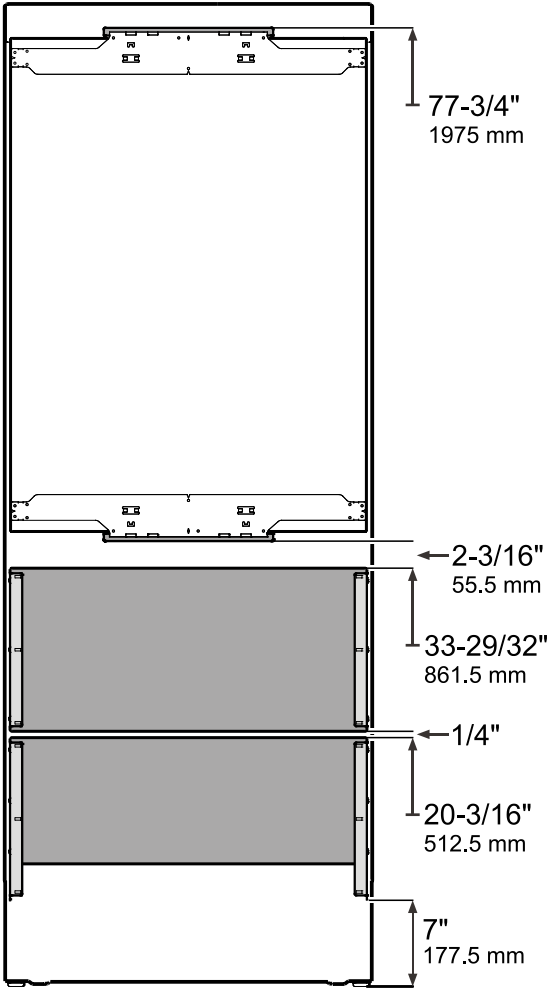

HC 2060  
HC 2061

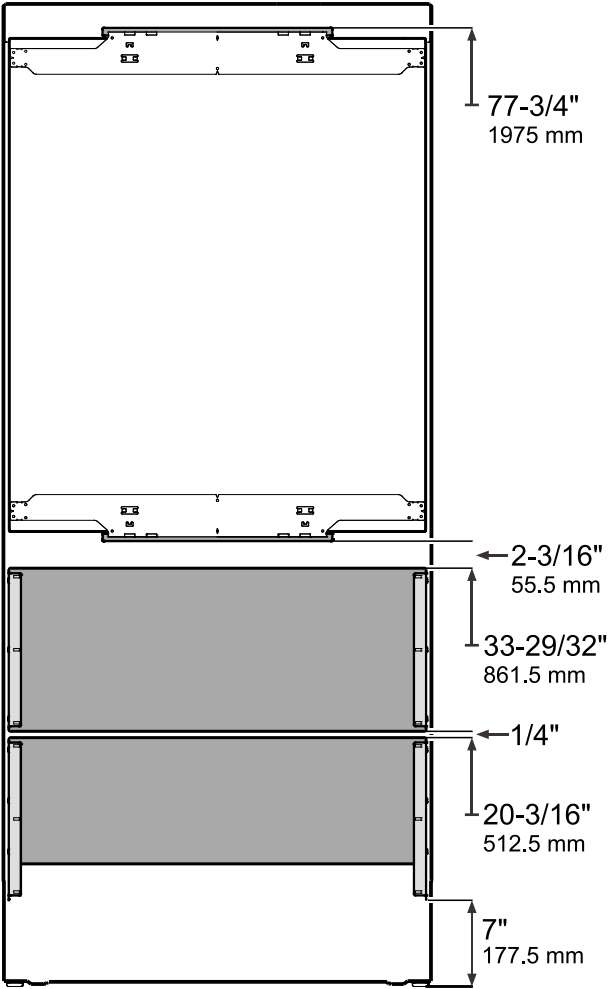

### Ventilation Requirements

HC and HCB appliances do not require ventilation considerations in the cabinetry. The required airflow is directed through the plinth area.

**HC 2062  
HCB 2062**

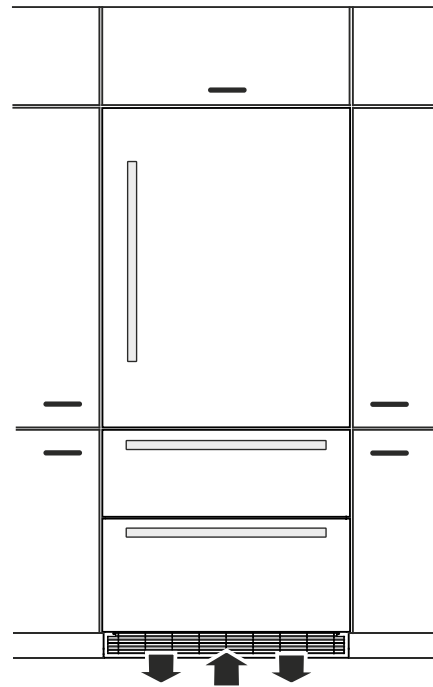
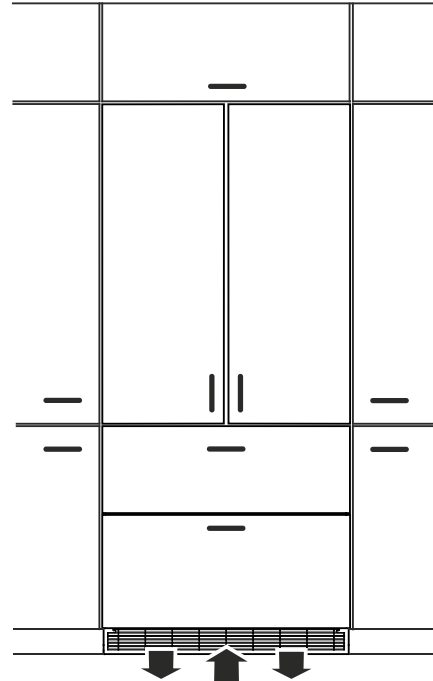
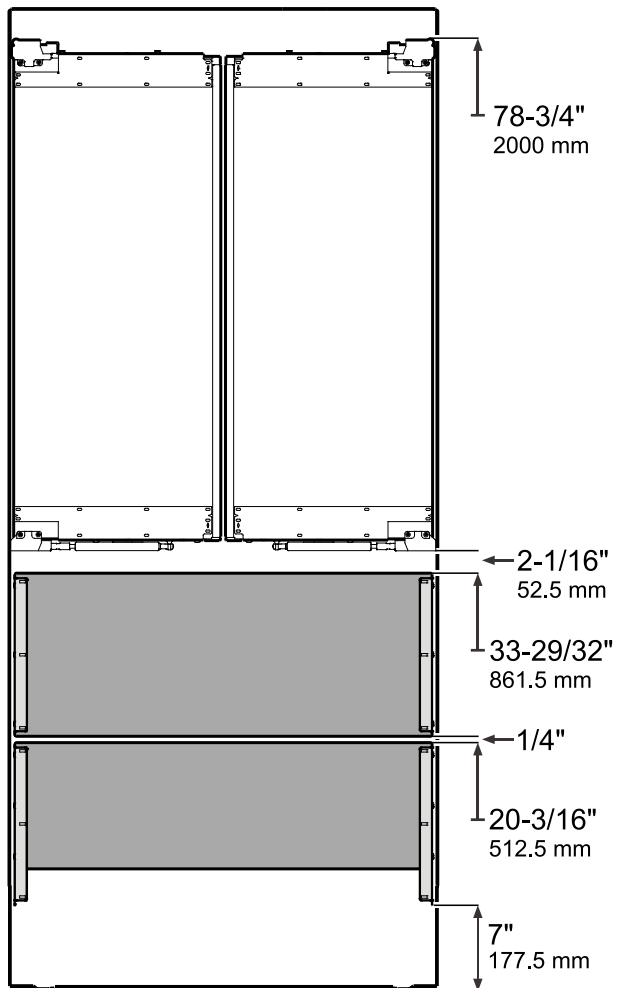

It is important to use the provided cover grille for the ventilation opening.

This opening must not be covered with a cabinet base.

## Cabinet Opening Dimensions HC 2060, HC 2061, HC 2062, HCB 2062

Inset cabinet Depth <b>D</b>	Frameless cabinet Depth <b>D</b>
24 3/4"	24"

### IMPORTANT

Factory available stainless steel panels are designed for an inset installation only and require a cabinet / gable depth of 24 - 3/4".

Concerning the refrigerator compartment there is the option to choose between stainless steel panels for a 80" or a 84" installation situation.

When using your own custom overlay panels, only the 80" opening minimum would apply. Opening height can be taller than the 80" minimum by any amount but be sure to adjust panel height accordingly.

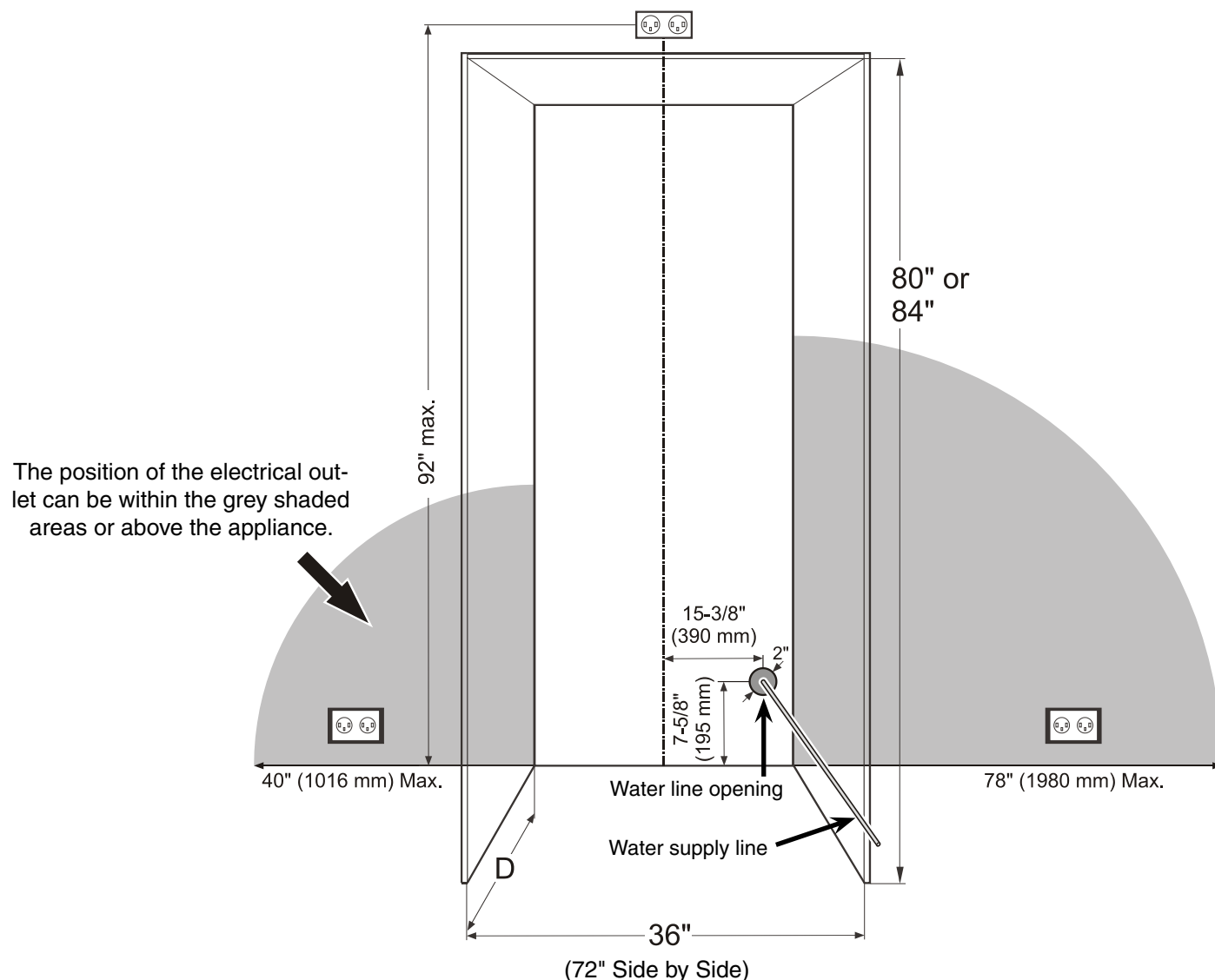

### IMPORTANT

With 24" cabinets, the water line opening must be in the location as shown.

With cabinets deeper than 24" there is room to fit the pipe behind the appliance and the wall so there are no requirements for the water line lead out position.

### IMPORTANT

The free length of the water supply line must be at least 31 - 1/2" (800 mm) when the tube comes out of the prescribed opening.

Do not install the shut-off valve behind the appliance.



# Fully Integrated

## Installation Styles

### Definition of Inset Installation Style

Appliance and panels sit fully within the opening and are flush with what could be its own box, between two pantry cabinets or decorative columns, etc. This is the most common installation scenario.

Side view of cabinet (sectional view)

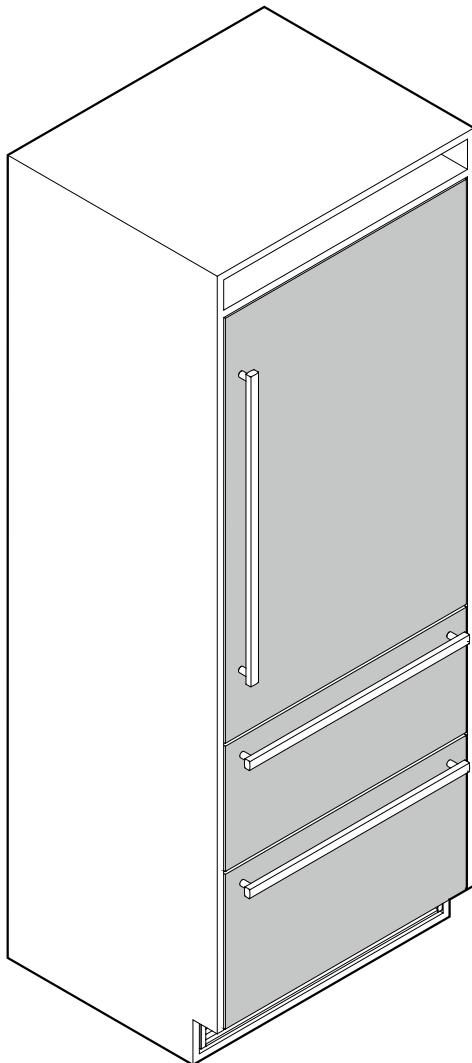
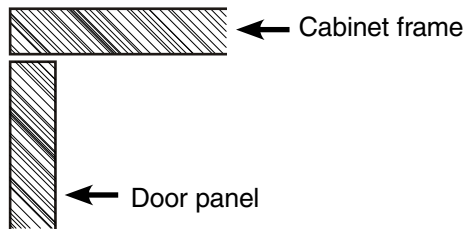

### Definition of Frameless Installation Style

With this installation style, these wider appliance panels partially overlay the shared side gables of adjacent cabinetry so as to mimic the look of a frameless style cabinet.

Side view of cabinet (sectional view)

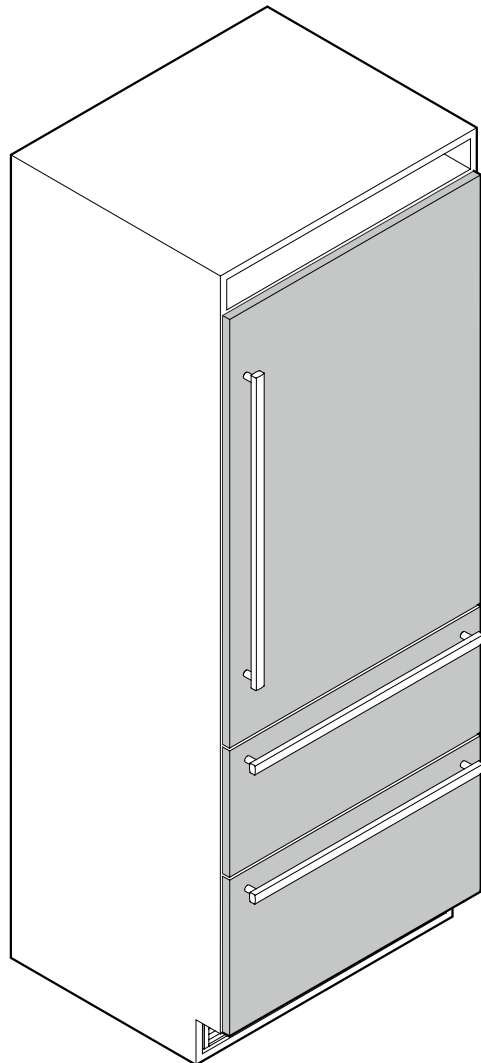
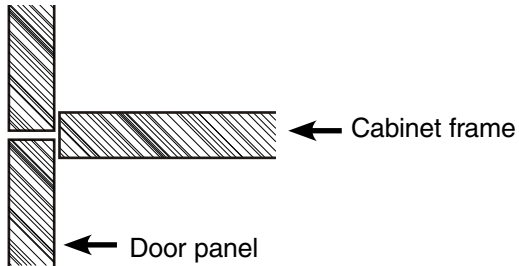

Panel Dimensions  
Inset Installation Style  
HC 2060, HC 2061

IMPORTANT

The minimum panel thickness is 5/8" (16 mm).  
The maximum panel thickness is 3/4" (19 mm).  
The maximum weight of the refrigerator panel is 60 lbs (27 kg).  
The maximum weight of each freezer panel is 26.5 lbs (12 kg).

Cabinet opening A	Refrigerator door panel B
80"	45-1/4" (1150 mm)
84"	49-1/4" (1251 mm)

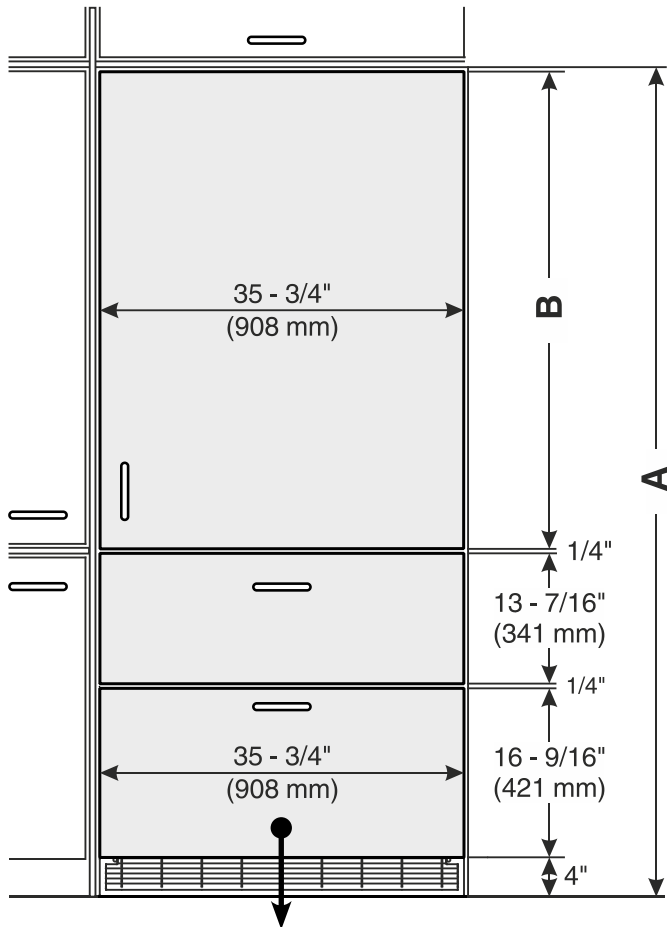

Panel Dimensions  
Frameless Installation Style  
HC 2060, HC 2061

IMPORTANT

The gap between panels at frameless installation style is 1/4" (6 mm).  
The minimum panel thickness is 5/8" (16 mm).  
The maximum panel thickness is 3/4" (19 mm).  
The maximum weight of the refrigerator panel is 60 lbs (27 kg).  
The maximum weight of each freezer panel is 26.5 lbs (12 kg).

Cabinet opening A	Refrigerator door panel B
80"	45-3/4" (1162 mm)
84"	49-3/4" (1264 mm)

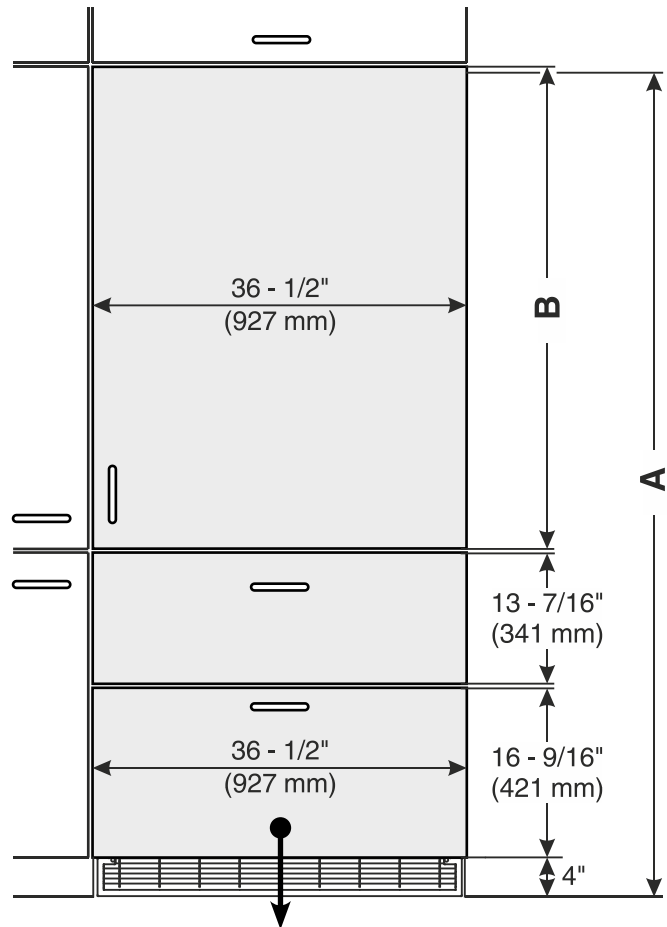

The height of this panel cannot be reduced for taller toe kicks as it will reveal structural elements of the appliance. Instead, install appliance on a platform and adjust the opening height to accommodate.

Panel Dimensions  
Inset Installation Style  
HC 2062, HCB 2062

IMPORTANT

The minimum panel thickness is 5/8" (16 mm).  
The maximum panel thickness is 3/4" (19 mm).  
The maximum weight for each panel is 26.5 lbs (12 kg).

Cabinet Opening A	Refrigerator door panel B
80"	45 - 1/4" (1150 mm)
84"	49 - 1/4" (1251 mm)

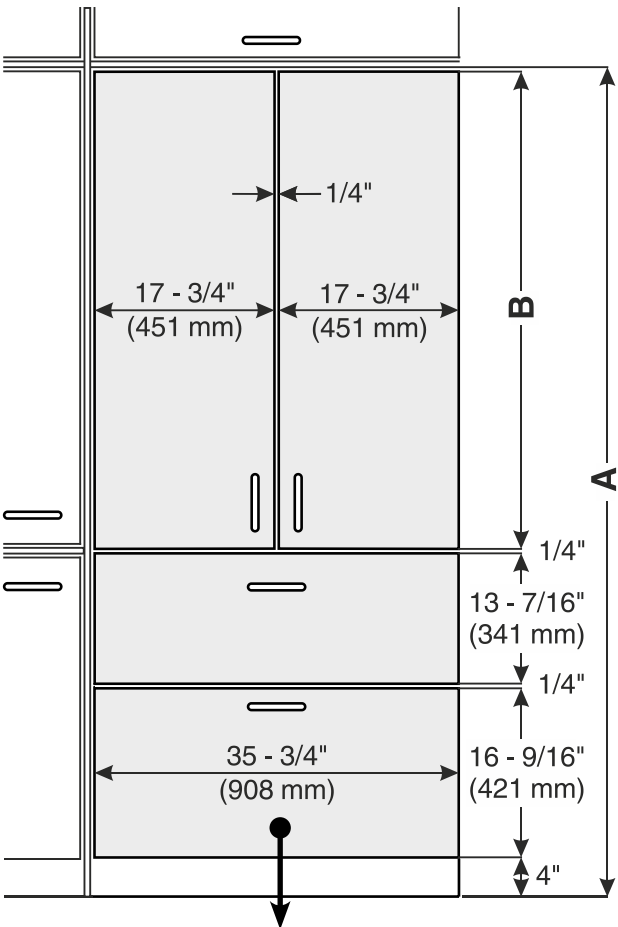

The height of this panel cannot be reduced for taller toe kicks as it will reveal structural elements of the appliance. Instead, install appliance on a platform and adjust the opening height to accommodate.

Panel Dimensions  
Frameless Installation Style  
HC 2062, HCB 2062

IMPORTANT

The gap between panels at frameless installation style is 1/4" (6 mm).  
The minimum panel thickness is 5/8" (16 mm).  
The maximum panel thickness is 3/4" (19 mm).  
The maximum weight for each panel is 26.5 lbs (12 kg).

Cabinet Opening A	Refrigerator door panel B
80"	45 - 3/4" (1162 mm)
84"	49 - 3/4" (1264 mm)

