



Vehicle Kit LV1 QUICK START GUIDE

Listen to your Lynx Radio
through your vehicle's stereo



What's in the Box?

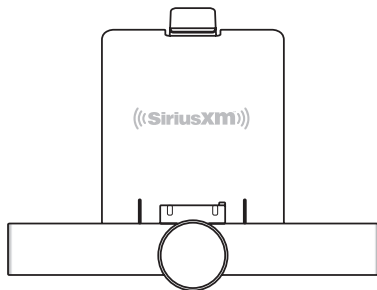

PowerConnect Vehicle Dock

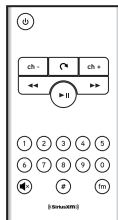

Remote Control

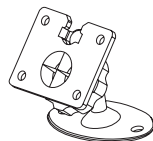

Dash Mount

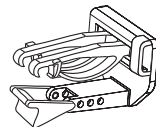
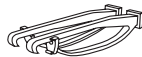

Vent Mount & Extended Vent Mount Clips

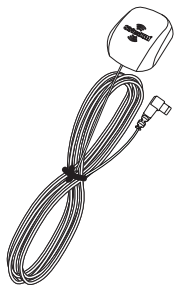

Magnetic Mount Antenna



Aux In Cable

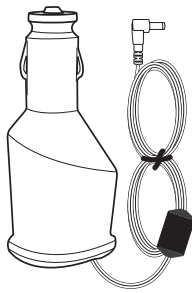

PowerConnect Power Adapter



Antenna Cable Routing Adapter



Alcohol Pads

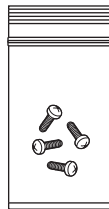

AMPS Screws
For optional AMPS compatible mount.

PowerConnect Vehicle Dock Controls & Connectors

PowerConnect Vehicle Dock Front View

Lock Tab

Secures Lynx in the Vehicle Dock. Push back to release Lynx from the dock.

Knob (Multifunction)

When listening to live satellite or Internet radio, turn to enter the Spectrum channel browsing mode, and scroll through channels.

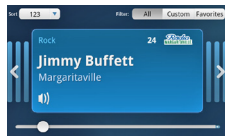

Press and release the **Knob** to select a channel and return to the **Now Playing** screen.

ANT (Silver)

Connection for the Magnetic Mount Antenna.

POWER (Red)

Connection for PowerConnect Power Adapter.

AMPS Mounts

Mounting points for Dash Mount. Use 4 provided screws.

Mounting Point

for Mounting Point for Vent Mount.

Knob (PowerConnect Only)

When at the **Now Playing** screen, press and hold for two seconds to display the **FM Settings** screen. Quickly select an FM preset by tapping a saved FM preset at the bottom of the screen.

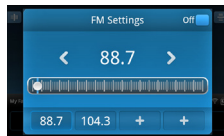

Turn the **Knob** to select an FM channel frequency.

Tap **+** at the bottom of the screen to save the FM channel as a new preset.

Press+Hold an existing preset to replace it with a new FM channel.

FM OUT (Blue)

Connection for optional FM Direct Adapter (sold separately).

AUDIO (Green)

Connection for Aux In Cable or optional Cassette Adapter (sold separately).

PowerConnect Vehicle Dock Rear View

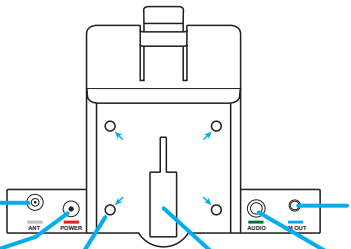

Remote Control Button Functions and Battery

Pause and Replay Buttons:

Pause/Play button ►||

Pauses or resumes playing of the currently tuned channel.

Rewind button ◀◀*

Rewinds through content so you can hear-that-again. Tap to rewind to the beginning of a song or show segment. (Press+hold to continuously rewind through content.**)

Fast-Forward button ►►*

Advances through content until live radio is reached. Tap to advance to the next song or show segment. (Press+hold to continuously fast forward through content.**)

Numbers 1-5

Selects the corresponding favorite channel in the current favorite page on the Now Playing screen.

Mute

Silences the audio.

Direct

Directly tunes a channel by entering the channel number with the number buttons.

*Internet radio music channels, and Radio Replays, are limited to 1 rewind and up to 5 skip forwards per hour (other channels may have same restrictions).

**When listening to satellite radio.

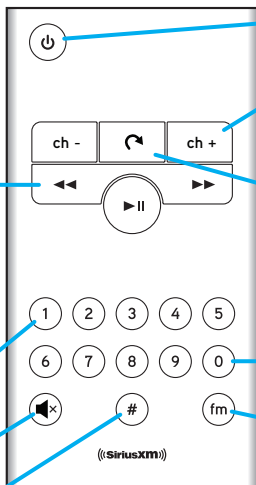

Power Button

Press for 3 seconds to turn Radio On; press and hold to turn Radio Off.

Tune Up/Down Channels

Immediately tunes up or down the channels.

Jump**

If configured for traffic/weather, jumps to the traffic/weather for the city you have selected.

If configured for last channel, jumps to the channel to which you had previously been listening.

Numbers 6-0

Selects the favorite channel page, i.e., 6=page 1, 7=page 2, etc.

FM (PowerConnect only)

Toggles through the FM presets. If no FM presets have been set, opens the **FM Settings** screen.

Battery Replacement. Turn the Remote Control over and remove the battery cover. It is best if you remove the battery door by inserting your fingernail in the center of the gap between the door and the back of the remote. Apply a little pressure and the door will pop open. Observe the orientation of the battery, then slide it out and replace it with a CR2025 battery. Reinstall the battery cover.

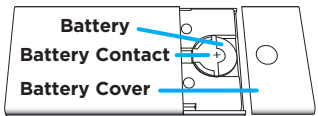
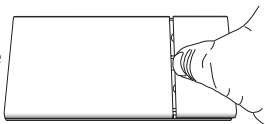

Find a Location for Lynx and Mount It

For mounting the *PowerConnect*™ Vehicle Dock, you can select either the **Dash Mount** method or the **Vent Mount** method. For the Vent Mount, wait until after you have connected all the cables to the Vehicle Dock before you attach it to the mount.

Dash Mount Method:

IMPORTANT: The air temperature needs to be at least 60° F to install the Dash Mount. If needed, turn on the heater in your vehicle.

- a. Select a flat surface for the Dash Mount with ample room for the Vehicle Dock and Radio. Avoid mounting on leather surfaces.
- b. Orient the adhesive foot so that the Vehicle Dock and Radio are easily accessible. Loosen the knob, adjust the adhesive foot, and then tighten it again.

Knob Adhesive Foot

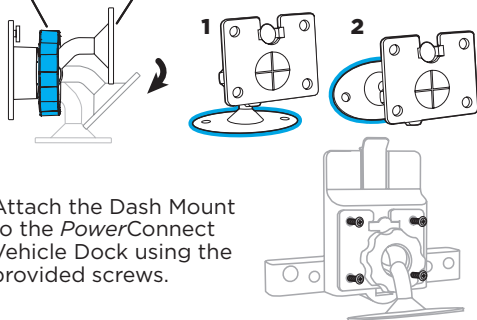

- c. Attach the Dash Mount to the *PowerConnect* Vehicle Dock using the provided screws.

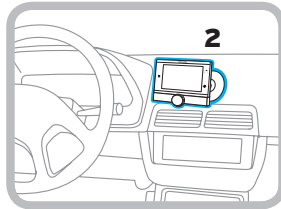
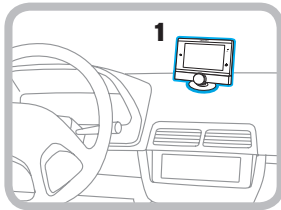
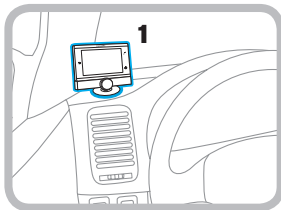

Find a Location for Lynx and Mount It (continued)

- a. Clean the surface where you are installing the Dash Mount with the alcohol preparation pad.
- b. Once the surface is dry, remove the adhesive liner. Press and hold the Dash Mount in place for 30 seconds. Allow the adhesive to cure for 2-4 hours.
- c. You can adjust the dock mounting plate, tilting it in your preferred direction.

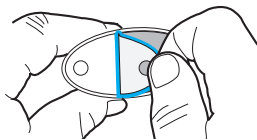

Dock Mounting Plate

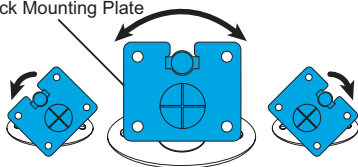

Vent Mount Method:

- a. Select a vent with ample room for the Radio and Vehicle Dock.
- b. Some vents have recessed louvers. If yours are recessed, remove the regular vent clamps and install the extended vent clamps as shown below.

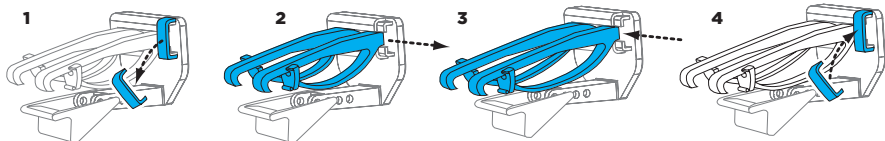
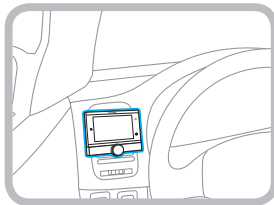
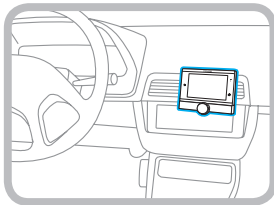

Find a Location for Lynx and Mount It (continued)

C. Install the Vent Mount onto the vehicle vent:

i. Insert the Vent Mount into the vent opening.

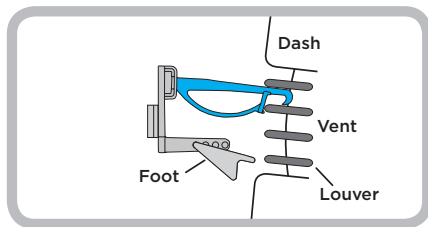

ii. Push until hooked on the rear of the vent louver. Rest the foot against the bottom of the vent.

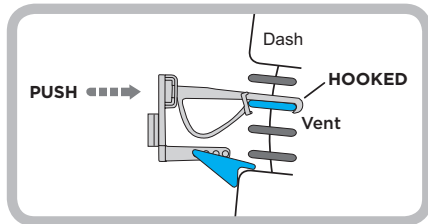

iii. If necessary, adjust the tilt of the Vent Mount by repositioning the foot to a different tilt adjustment hole.

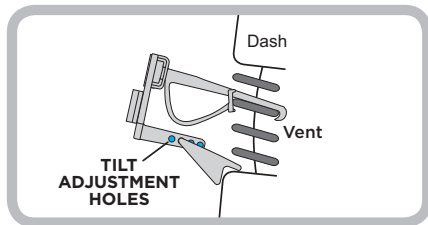

Install the Magnetic Mount Antenna...

- a. Mount the Magnetic Mount Antenna outside your vehicle, on a clean and dry horizontal surface that will always face the sky.
- b. Choose the location for the antenna according to your type of vehicle. Center it between the left and right sides, and away from other antennas. Use the Alcohol Prep Pad to clean the surface.

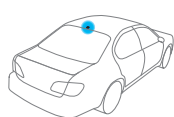

Sedans and Coupes
(above front windshield
or rear window)



Pickups
(above front
windshield)



Convertibles
(leading edge
of trunk)

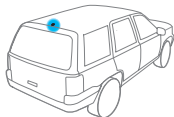

SUVs
(rear of roof)

- c. Install the Cable Routing Adapter to direct the antenna cable downward, if mounting on an edge. Then mount the antenna on the vehicle.

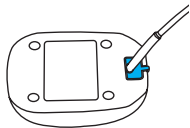
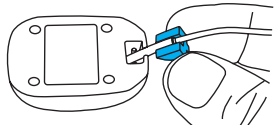

NOTE: Steps **d** through **f** describe the antenna cable routing for a sedan or coupe where the antenna is mounted above the front windshield. The Lynx User Guide has detailed antenna cable routing instructions for all types of vehicles, online at www.siriusxm.com.

- d. Tuck the antenna cable under the windshield rubber molding and run it to the nearest corner.
- e. Route the cable out of the molding and into the rubber weather stripping around the door opening. Lift the weather stripping, tuck and run the cable inside of it to the bottom of the door opening. Replace the weather stripping.

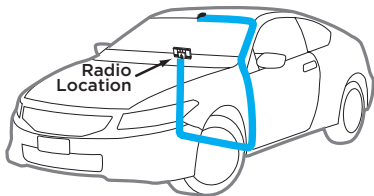

...and PowerConnect Power Adapter

TIP: Include enough slack in your cable routing to accommodate open doors or the hood lid. Coil any excess cable in a hidden location and keep it away from any vehicle pedals or controls.

- f. Run the cable under the dash, or under a floor mat, bringing it out at the Radio location.
- g. Plug the Magnetic Mount Antenna connector into the **silver ANT** connector at the rear the Vehicle Dock.
- h. Insert the *PowerConnect* Power Adapter into your vehicle's cigarette lighter or power adapter socket. Plug the other end into the **red POWER** connector on the rear of the Vehicle Dock.
- i. Place Lynx into the Vehicle Dock and press the **Power button** for 3 seconds.

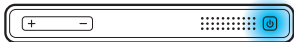
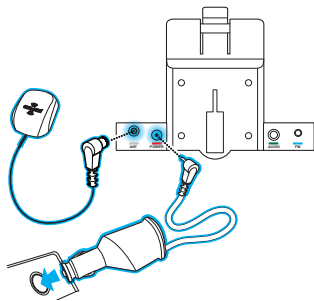

IMPORTANT! Wait until you have connected the audio before you connect the Vehicle Dock to the Vent Mount.

- j. If you are prompted to take the tour, tap **No thanks**. At the next screen tap **Continue** to be guided through the activation process.
 - k. Be sure the vehicle is parked in a safe place outside, with a clear view of the sky, and tap **Continue**.
 - l. If Lynx displays **Signal Found**, tap **Continue** and proceed with connecting the audio in the next section.
- If Lynx displays **No Signal/Check Antenna**, reposition the vehicle so that nothing is blocking the antenna's clear view of the sky, and tap  and then **Continue** to try again.

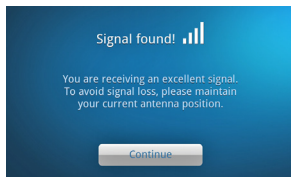
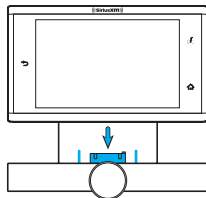

Connect the Audio

You'll need to decide how you will connect the audio so you can hear it in your vehicle.

- a. The chart to the right shows the possible audio connection options and their quality. Also consult the three sections in the next panel for more information about each type of audio connection option.
- b. The **Audio check** screen should be displayed. If you cannot hear the audio playing, tap **No**.
- c. You will be prompted to continue with the audio setup. Tap **Continue**.
- d. At the **How will you connect your audio?** screen, select your desired audio connection and tap **Continue**.
- e. Continue to follow the on-screen instructions until you reach the **Activation** screen.
- f. You should now be hearing the SiriusXM audio. Connect the Vehicle Dock to the Vent Mount if you are using the Vent Mount.
- g. Proceed to the **Subscribe** section on the opposite side of this Quick Start Guide.

Audio Quality	GOOD	BETTER	BEST
Aux In Cable (AUX)			★
Bluetooth (A2DP Profile)			★
FM Direct Adapter (FMDA)*		★	
Cassette Adapter*		★	
PowerConnect		★	

*The FMDA or Cassette Adapter can be purchased separately from your local retailer or from shop.siriusxm.com/ accessories. Professional installation is recommended for the FMDA.

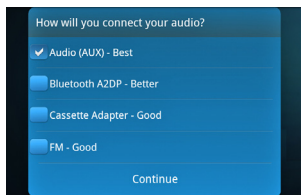

Should you should decide to change your type of audio connection at a later time, you can adjust the settings by tapping **Home** , tap **>**, tap **Settings** , tap **Mode**, and tap **Vehicle Dock**.

Connect the Audio (continued)

Aux In Cable (or Cassette Adapter) Audio Setup:

If your vehicle radio has an AUX jack, the Aux In Cable connects Lynx to your vehicle radio for the audio. If your vehicle has a cassette player, you can also use an optional Cassette Adapter (sold separately) for the audio.

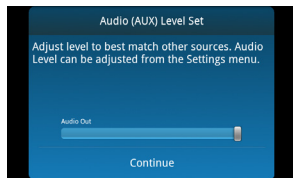
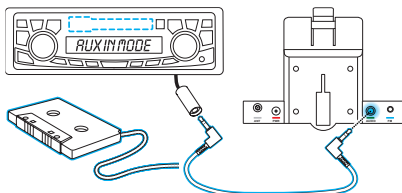

Bluetooth Stereo Audio Setup:

If your vehicle has *Bluetooth*[®] stereo audio streaming compatibility (A2DP Profile), you can connect it with Lynx for audio. Lynx is not compatible with the Hands Free Profile (HFP), which is typically used for a Bluetooth connection to a cellphone. Refer to the Lynx Radio Quick Start Guide for additional information on connecting the audio using *Bluetooth*.

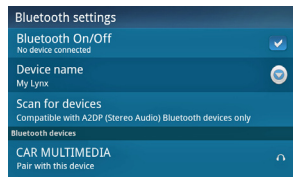

PowerConnect Audio Setup:

PowerConnect plays the audio through your vehicle's FM radio, when Lynx and your vehicle's FM radio are both tuned to the same FM channel.



Subscribe

To be able to tune the channels, you will need to subscribe to SiriusXM satellite radio. Once you have successfully connected the audio, keep your vehicle parked where it has a clear view of the sky throughout the activation process. Follow the instructions on the screen to subscribe.

- a. To subscribe to SiriusXM satellite radio, you will need the Radio ID which can be found:
- on the **Activation** screen
 - by tuning to channel 0
 - on a label on the bottom of the gift box
 - on the label inside the rear cover of Lynx
- The Radio ID does not use the letters I, O, S, or F.

- b. Lynx should be displaying the **Activation** screen. To subscribe:
- **By phone:** Call **1-866-635-2349**
 - **Online:** Go to **www.siriusxm.com/activatenow**

- c. Activation usually takes 10 to 15 minutes after you have completed the subscription process, but may take up to an hour. We recommend that your Radio remain on and in the Vehicle Dock until subscribed. Once subscribed, you'll be able to tune to the channels in your subscription plan.

If Lynx has a Wi-Fi connection, but you have not yet subscribed to SiriusXM Internet radio, Lynx will prompt you to set up Internet radio. Follow the instructions if you wish to subscribe to Internet radio.

Hardware and subscription sold separately. **Service will automatically renew for additional periods of the same length as the plan you choose, on the subscription package you choose (which may differ from the package which arrived with the radio) until you call us at 1-866-635-2349 to cancel. See our Customer Agreement for complete terms at www.siriusxm.com.** Activation fee of \$15, other fees and taxes apply. All fees and programming are subject to change.

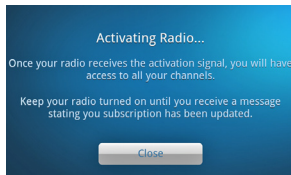
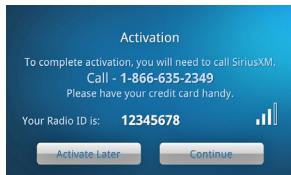

Specifications

System

Power Requirements:	9-16 V DC, 1.5 A (max)
Operating Temperature:	-4°F to +122°F (-20°C to +50°C)
Audio Output:	1.0 V _{rms} (max)

PowerConnect Vehicle Dock

Dimensions:	4.4 in (width) x 3.4 in (height) x 1.6 in (depth) 112 mm (width) x 87 mm (height) x 41 mm (depth)
Weight:	2.0 oz (57 g)
Audio Connector:	1/8 in (3.5 mm) female
Antenna Connector:	SMB male

Remote Control

Dimensions:	2.2 in (width) x 4.2 in (height) x 0.4 in (depth) 55 mm (width) x 105 mm (height) x 10 mm (depth)
Weight:	1.3 oz (37 g)
Battery:	CR2025 (3 V)

FCC and SAR Statements

FCC STATEMENT:

The user is cautioned that changes or modifications not expressly approved by Sirius XM Radio Inc. can void the user's authority to operate this device.

This device complies with Part 15 of the FCC Rules. Operation is subject to the following two conditions:

1. This device may not cause harmful interference.
2. This device must accept any interference received, including interference that may cause undesired operation.

This equipment has been tested and found to comply with the limits for a Class B digital device, pursuant to Part 15 of the FCC Rules. These limits are designed to provide reasonable protection against harmful interference in a residential installation.

This equipment generates, uses, and can radiate radio frequency energy and, if not installed and used in accordance with the installation instructions, may cause harmful interference to radio communications. However, there is no guarantee that interference will not occur in a particular installation. If this equipment does cause harmful interference to radio or television reception, which can be determined by turning the equipment off and on, the user is encouraged to try to correct the interference by one or more of the following measures:

- Reorient or relocate the receiving antenna of the affected receiver.
- Increase the separation between the SiriusXM equipment and the affected receiver.
- Connect the SiriusXM equipment into an outlet on a circuit different from that to which the affected receiver is connected.
- Consult the dealer or an experienced radio/TV technician for help.

WARNING! The FCC and FAA have not certified this Satellite Radio Receiver for use in any aircraft (neither portable nor permanent installation). Therefore, Sirius XM Radio Inc. cannot support this type of application or installation.

SAR STATEMENT: Exposure to Radio Frequency Energy (SAR)

To maintain compliance with FCC RF exposure guidelines when you carry this device on your body, use only belt clips, holsters or similar accessories that have no metallic component in the assembly. Use of other non-approved accessories might violate FCC RF exposure guidelines. This equipment has been evaluated as a body worn device with 0 cm separation and complies with FCC radiation exposure limits set forth for an uncontrolled environment. In order to comply with FCC RF exposure safety guidelines, the antenna(s) used for this transmitter must not transmit simultaneously with any other antenna or transmitter, except in accordance with FCC multi-transmitter product procedures. The user of this device should ensure that the operation of this device is in compliance with these provisions.

Copyrights and Trademarks

©2011 Sirius XM Radio Inc. Sirius, XM and all related marks and logos are trademarks of Sirius XM Radio Inc. The Bluetooth® word mark and logos are registered trademarks owned by Bluetooth SIG, Inc. and any use of such marks by Sirius XM Radio Inc is under license. Visit www.siriusxm.com/channellineup for updates. All programming/channel lineup/XM service subject to change or preemption. All other marks and logos are the property of their respective owners. All rights reserved.

Our satellite service is available only to those at least 18 and older in the 48 contiguous USA and DC. Our Sirius satellite service is also available in PR (with coverage limitations). Our Internet radio service is available throughout our satellite service area and in AK and HI. Certain channels are not available on our Internet radio service, including MLB® play-by-play.

This product contains chemicals known to the State of California to cause cancer and birth defects or other reproductive harm.

CAUTION: Do not attempt to install, activate, or adjust any of the setting options described in this Quick Start Guide unless your vehicle is parked in a safe location.

Self installation instructions and tips are provided for your convenience. It is your responsibility to determine if you have the knowledge, skills and physical ability required to properly perform an installation. SiriusXM shall have no liability for damage or injury resulting from the installation or use of any SiriusXM or third party products. It is your responsibility to ensure that all products are installed in adherence with local laws and regulations and in such a manner as to allow a vehicle to be operated safely and without distraction. SiriusXM product warranties do not cover the installation, removal, or reinstallation of any product.

Sirius XM Radio Inc.
1221 Avenue of the Americas
New York, NY 10020

siriusxm.com

1.866.635.2349

© 2011 Sirius XM Radio Inc.

Lynx VK QSG 111209a