



Stainless

Overlay

3018WC

3000 SERIES

FEATURES

PERFORMANCE

- Wine bottle capacity up to 31 bottles (.75L)
- Digitally controlled single-zone convection cooling system
- U-Select™ Control: Integrated OLED display with intuitive user interface ergonomically located on top of door
- Beverage Mode: 38° to 65°F, Sparkling Wine Mode: 38° - 50°F, White Wine Mode: 45° - 55°F, Red Wine Mode: 55° - 65°F
- U-Select™ Control provides 4 distinct settings designed to provide precise refrigeration and maximize preservation
- Convection Cooling Technology
- Sabbath / Black-Out mode
- UL Residential Listing

INTERIOR / EXTERIOR

- 2 wine racks will fit larger diameter wine bottles, including Champagne bottles
- Black interior with LED theater lighting optimizes elegant display
- Solid beech wood trimmed, full-extension black vinyl coated wine racks allow for full access to stored wines
- LowE coated, argon gas filled thermopane glass door provides protection
- Robust, concealed and covered hinges with built-in door stop and closer
- 2 wine racks will fit larger diameter wine bottles, including Champagne bottles
- Durable delrin feet on leveling legs glide easily on floor and reduce potential scratching

INTEGRATION

- Standard commercial stainless steel handle is interchangeable with professional handle option
- Adjustable toe-kick - front to back and up and down allows for seamless installation
- Front adjustable rear leveling legs greatly eases installation
- Allow a 2-1/2" clearance on hinged side for 90° door opening when installed adjacent to a wall (for stainless steel model)
- Allow 1/4" width overall for proper installation (see backside for details)
- No additional clearance around sides, top or rear of unit is needed for ventilation



2 wine racks will fit larger diameter wine bottles, including Champagne bottles



Single Zone Convection Cooling System featured in 3018WC

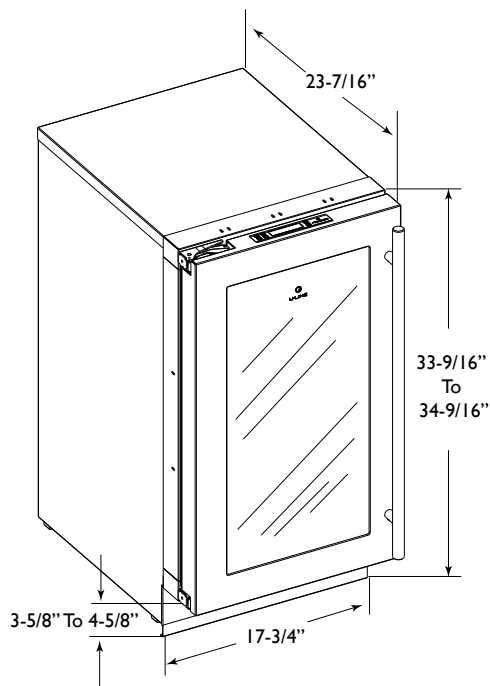

3018WCS Stainless Model

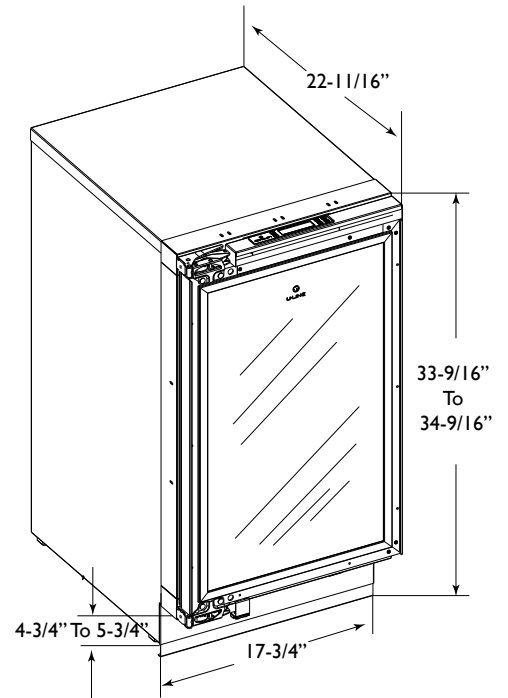

3018WCOL Overlay Model

DIMENSIONS AND SPECIFICATIONS

OVERALL DIMENSIONS

Height	33-9/16" (85.2)
Width	17-3/4" (45)
Depth	23-7/16" (60)
With stainless steel handle	25-5/16" (64.3)

Shipping weight:

Stainless model	139 lbs (63 kg)
Overlay model	133 lbs (60.3 kg)

Running amps	2.4
Amps pertain to voltage rating	110/115 Volt, 60 Hz

Capacities:

Wine bottle storage (0.75L)	Up to 31
-----------------------------	----------

3018WC

Stainless	U-3018WCS-00
Overlay	U-3018WCOL

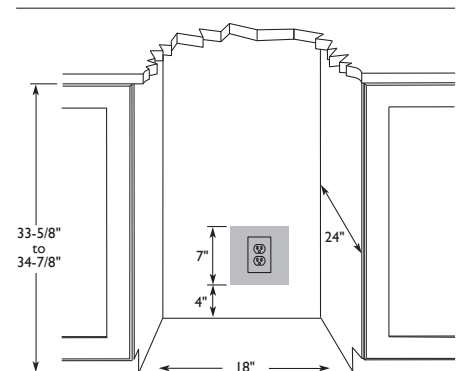

Please visit www.u-line.com for installation guide.

All specifications are subject to change without notice.