

1 Find a Location for Edge and Mount it

Select either the **Dash Mount** method or the **Vent Mount** method for your Edge. Do not attach the *PowerConnect Vehicle Dock* to the mount. Wait until after you have connected all the cables to the dock.

Dash Mount Method:

IMPORTANT: The air temperature needs to be at least 60° F to install the Dash Mount. If needed, turn on the heater in your vehicle.

- Select a flat surface for the Dash Mount with ample room for Edge. Avoid mounting on leather surfaces.
- Orient the adhesive foot so that Edge is easily accessible. Loosen the knob and adjust the adhesive foot to position **1** or **2**, and then tighten it.

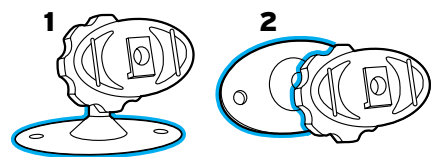
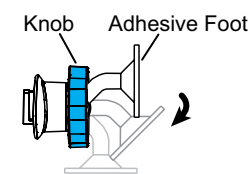
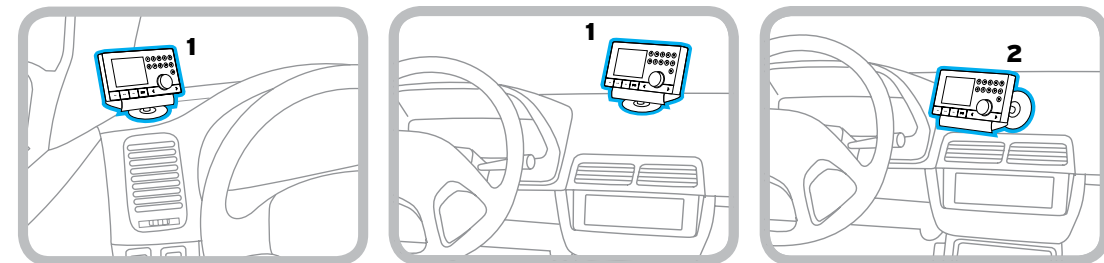

- Clean the surface with the alcohol preparation pad.
- Once the surface is dry, remove the adhesive liner. Press and hold the Dash Mount in place for 30 seconds. Allow the adhesive cure for 2-4 hours.

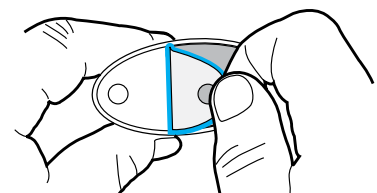

- You can tilt the dock mounting plate in your preferred direction.

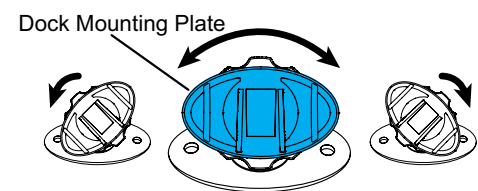

TIP: Choose a location that doesn't interfere with the driver's vision or access to driving controls, won't interfere with the deployment of airbags or other safety equipment, and makes Edge easily accessible for operation.

Vent Mount Method:

- Select a vent with ample room for Edge.

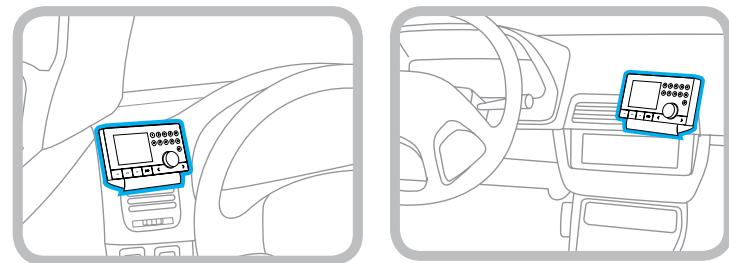

- Some vents have recessed louvers. If yours are recessed, remove the regular vent clamps and install the extended vent clamps.

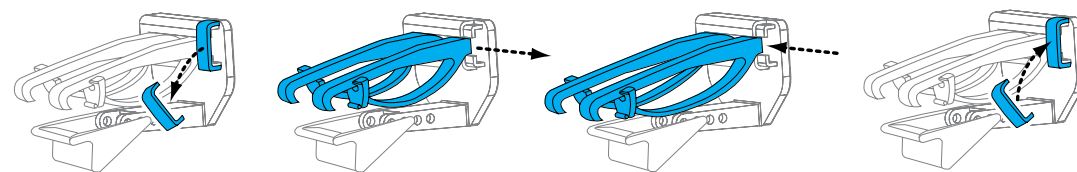

- Install the Vent Mount onto the vehicle vent:

- Insert the vent mount into the vent opening.

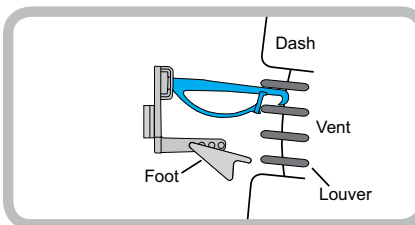

- Push until hooked on the rear of the vent louver. Rest the foot against the bottom of the vent.

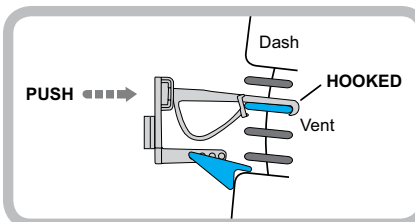

- If necessary, adjust the tilt of the Vent Mount by repositioning the foot to a different tilt adjustment hole.

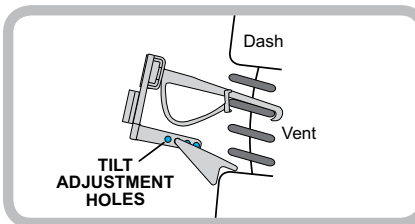

2 Mount the Magnetic Mount Antenna

- Mount the Magnetic Mount Antenna outside your vehicle, on a clean and dry horizontal surface that will always face the sky.
- Choose the location for the antenna according to your type of vehicle. Center it between the left and right sides, and away from other antennas.

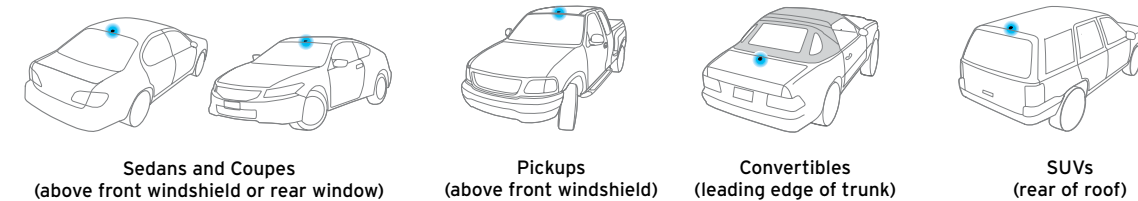

- Install the Cable Routing Adapter to direct the antenna cable downward, if mounting on an edge.

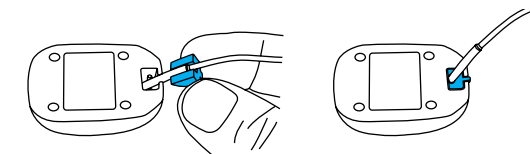

TIP: Use the Alcohol Prep Pad to clean the surface.

4 Connect the PowerConnect Power Adapter

- Insert the *PowerConnect Power Adapter* into your vehicle's cigarette lighter or power adapter socket. Plug the other end into the **red PWR** connector on the rear of the *PowerConnect Vehicle Dock*.

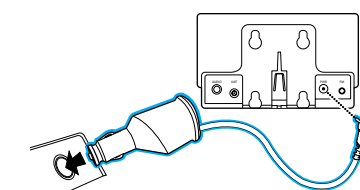

- Use the wire guide on the top of the dock to organize the wires connected to the dock.

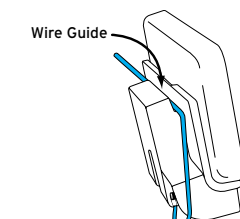

- Place Edge into the dock and press the **Power** button.

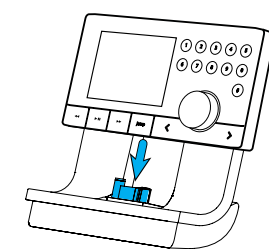

IMPORTANT! Don't attach the dock to the mount just yet.

3 Route the Antenna Cable

NOTE: These instructions are for a sedan or coupe where the antenna is mounted above the front windshield. The User Guide has detailed antenna cable routing instructions for all types of vehicles, beginning on page 26.

- Tuck the antenna cable under the windshield rubber molding and run it to the nearest corner.
- Route the cable out of the molding and into the rubber weather stripping around the door opening.
- Lift the weather stripping. Tuck and run the cable inside it to the bottom of the door opening. Replace the weather stripping.
- Pull the cable out and route it to Edge.
- Plug the Magnetic Mount Antenna connector into the silver **ANT** connector at the rear the *PowerConnect Vehicle Dock*.

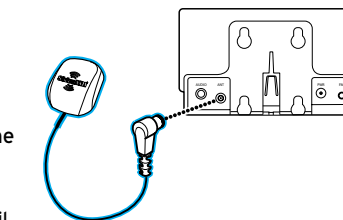
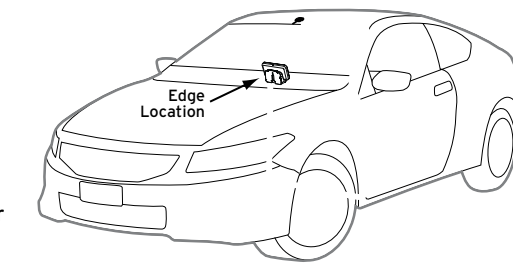

TIP: Include enough slack in your routing to accommodate open doors or the hood lid. Coil any excess cable in a hidden location and keep it away from any vehicle pedals or controls.

5 Verify Signal Reception

- Be sure the vehicle is outside and the antenna has a clear view of the sky.
- Verify that you are receiving the XM signal. The Radio should be tuned to channel 1, the XM Preview channel. There should at least be one bar on the upper left corner of the screen that denotes antenna signal strength.

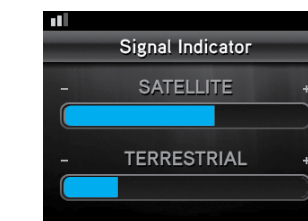

- You can also press **menu** and then turn the **Rotary Knob** to scroll to and highlight **Signal Indicator**. Press the **Select** button. The Satellite and Terrestrial bars show the strength of the signal being received. If the signal reception is good, press and hold **menu** to return to XM Preview channel 1.



EDGE QUICK START GUIDE



Self installation instructions and tips are provided for your convenience. It is your responsibility to determine if you have the knowledge, skills and physical ability required to properly perform an installation. SiriusXM shall have no liability for damage or injury resulting from the installation or use of any SiriusXM or third party products. It is your responsibility to ensure that all products are installed in adherence with local laws and regulations and in such a manner as to allow a vehicle to be operated safely and without distraction. SiriusXM product warranties do not cover the installation, removal or reinstallation of any product.

Sirius XM Radio Inc.
1221 Avenue of the Americas
New York, NY 10020
1.866.635.2349

siriusxm.com

6 Connect the Audio

Decide on one of the following in-box audio connection options. Refer to "Connect the Audio" on page 41 of the User Guide for details including other connection options.

Option 1: Best: Use the provided **Aux In Cable**, if your vehicle's stereo system has an auxiliary input jack.

- Plug one end of the cable into the **green AUDIO** connector on the **PowerConnect Vehicle Dock** and the other end into the auxiliary input jack on the vehicle's stereo system.

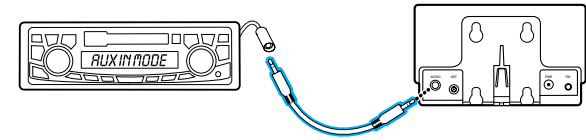

- Turn on your vehicle's stereo system and set it to play from the auxiliary input source.

- You should now hear channel 1, the XM Preview channel.

- Attach the dock to the mount and place the wires into the wire guide. The installation is complete.

TIP! Refer to your vehicle's owner's manual to find the location of the auxiliary input jack, or consult the vehicle dealer.

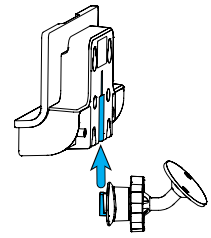

Option 2: Good: Use the **PowerConnect™** feature of Edge. **PowerConnect** plays the XM audio through your vehicle's FM radio.

- Find and make a list of all available FM channels in your area that are not being used by an FM radio station.

- Pick the first FM channel on your list. Tune your vehicle's FM radio to this FM channel.

- Set your Edge to transmit on the same FM channel that you have selected on your vehicle's FM radio:
 - Press **menu** and then turn the **Rotary Knob** to scroll to and highlight **FM Settings**. Press the **Select** button.
 - FM Channels** will be highlighted. If it is not, turn the **Rotary Knob** to scroll to and highlight **FM Channels**. Press the **Select** button.
 - Turn the **Rotary Knob** to scroll to and highlight **FM2**. Press the **Select** button.
 - Turn the **Rotary Knob** to tune in steps of .2, or press **◀** and **▶** to tune in steps of 1 to select the available FM channel you have chosen. Press the **Select** button to select the FM channel.
 - Start Using** will be highlighted. Press the **Select** button.
 - The selected FM channel will be confirmed on the display screen.

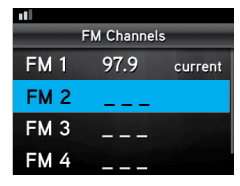

- You should hear channel 1, the XM Preview channel through your vehicle's FM radio. If you are satisfied with the sound quality, the installation is complete.

- If you are not satisfied, move to the next FM channel on your list and repeat the process. Continue until you have found an FM channel with which you are satisfied.

- Attach the dock to the mount and place the wires into the wire guide.

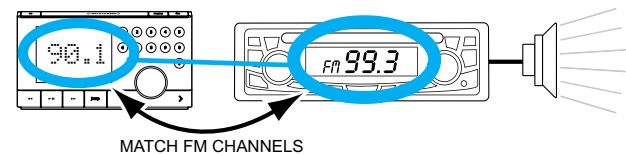

7 Subscribe

You can either follow the general activation and subscription process or use the on-board activation guide to activate your Edge and subscribe to the SiriusXM service.

General activation and subscription process:

- Make sure your Edge is turned on, tuned to channel 1, the XM Preview channel, and receiving the XM signal so that you can hear the XM audio.

- Make a note of the Radio ID. You can find it:
 - by selecting **Radio ID** in menu items
 - by tuning to channel 0 (zero)
 - on a label on the bottom of the gift box
 - on the label on the back of your Edge

NOTE! The XM Radio ID does not use the letters I, O, S, or F.

- To subscribe:
 - Online:** Go to www.siriusxm.com/activatenow to access or set up an online account, subscribe to the service, and activate your Radio
 - OR**
 - By phone:** Call 1-866-635-2349.

- Activation usually takes less than 15 minutes after you have completed the subscription process, but sometimes may take up to an hour. We recommend that your Radio remain on until activated. When your service is activated, Edge will display an alert message. To continue, press any button.

Turn the **Rotary Knob** to tune to other channels, and press **◀** or **▶** to browse the different categories of channels. Learn what all the buttons do in the next panel.

Activation guide:

For your convenience, Edge has an on-board activation guide. You can activate your Radio and subscribe to the SiriusXM service by using this guide, where you will be guided step-by-step through the subscription process. To access and use the guide, simply follow these steps:

- Press **menu**.
- Activate Radio** will be highlighted. Press the **Select** button.
- Follow the directions on each successive screen until you complete the subscription process.

Turn the **Rotary Knob** to tune to other channels, and press **◀** or **▶** to browse the different categories of channels. Learn what all the buttons do in the next panel.

Hardware and subscription sold separately. **Service will automatically renew for additional periods of the same length as the plan you choose, on the subscription package you choose (which may differ from the package which arrived with the Radio) until you call us at 1-866-635-2349 to cancel. See our Customer Agreement for complete terms at www.siriusxm.com.** Activation fee of \$15, other fees and taxes apply. All fees and programming are subject to change.

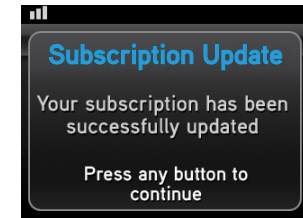

Edge Button Functions

Power Button
Press to turn Radio on and off.

Menu Button
Press to access advanced features and configuration options; in configuration options, press and hold to return to main display screen.

FM Button
Press to access and cycle through FM presets.

Number Buttons
Press to tune to a stored favorite channel, press and hold to store a favorite channel; also enter a channel number.

Direct Button
Press first before entering the channel number, to directly tune to a channel.

Select Button
Press to confirm selection of highlighted items in a menu or list, and of settings.

Left and Right Buttons
Press to search for channels by category.

Rotary Knob
Rotate to preview and tune to channels through the channel lineup; also scroll through lists and highlight menu options.

Pause and Replay Buttons
Pause, rewind, and replay up to 30 minutes of live radio.

Jump Button
Press to directly access traffic and weather for the city of your choice; or press it to go back to the previous channel to which you were listening.

Edge Main Display

When listening to a channel, information about the channel and what is currently playing is displayed.

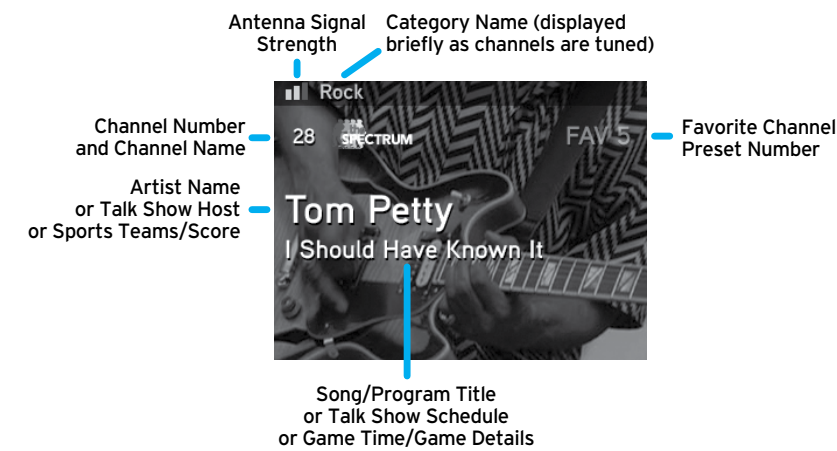

? What's in the Box?

CAUTION: Do not attempt to install, activate, or adjust any of the setting options described in this Quick Start Guide unless your vehicle is parked in a safe location.

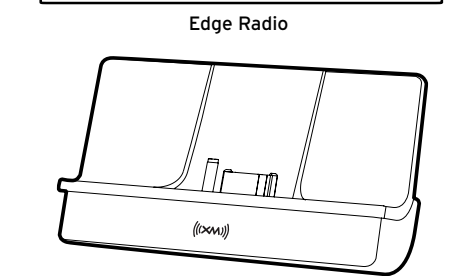
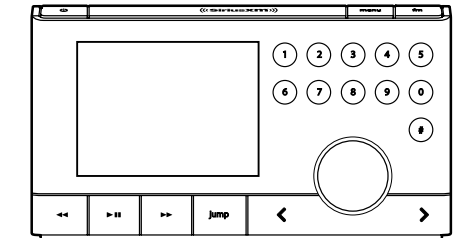

Dash Mount

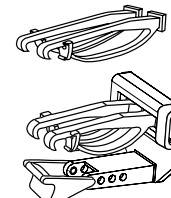

Vent Mount and Extended Vent Clamps



Antenna & Dash Mount Alcohol Preparation Pads



Cable Routing Adapter

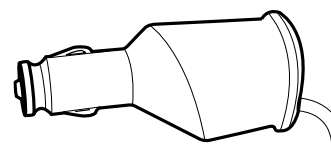

PowerConnect Power Adapter

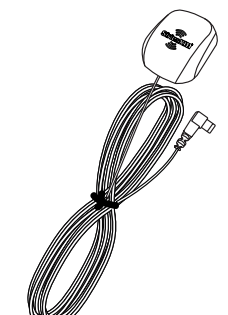

Magnetic Mount Antenna

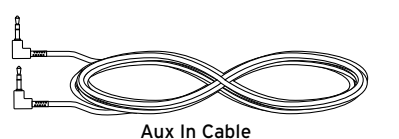

Aux In Cable