

1 Find a Location for Starmate 8 and Mount it

Select either the **Dash Mount** method or the **Vent Mount** method for your Starmate 8.

Dash Mount Method:

IMPORTANT: The air temperature needs to be at least 60° F to install the Dash Mount. If needed, turn on the heater in your vehicle.

- Select a flat surface for the Dash Mount with ample room for Starmate 8. Avoid mounting on leather surfaces.
- Orient the adhesive foot so that Starmate 8 is easily accessible. Loosen the knob and adjust the adhesive foot to position **1** or **2**, and then tighten it.

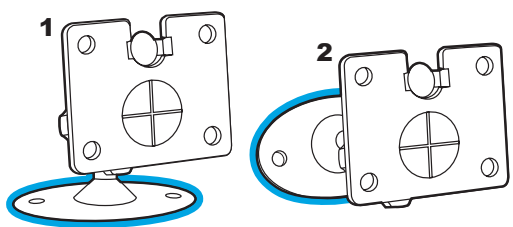
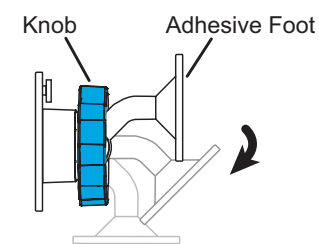
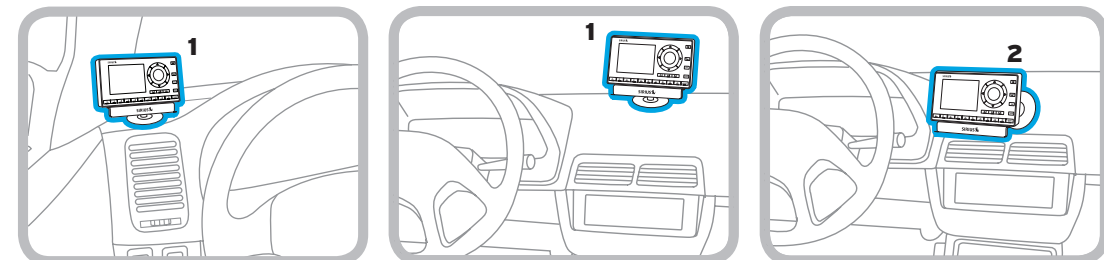

- Attach the Dash Mount to the PowerConnect Vehicle Dock using the provided screws.

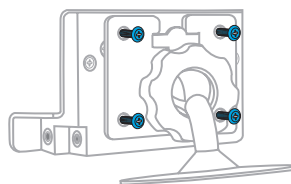

- Clean the dashboard surface with the alcohol preparation pad.

- Once the surface is dry, remove the adhesive liner. Press and hold the Dash Mount in place for 30 seconds. Allow the adhesive cure for 2-4 hours.

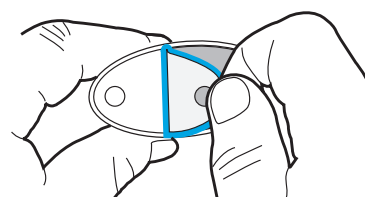

- You can tilt the dock mounting plate in your preferred direction.

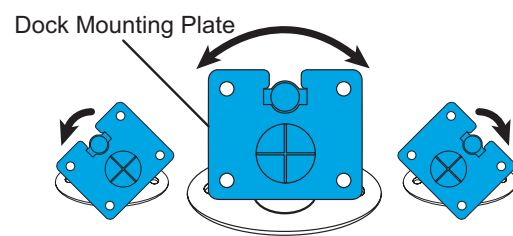

TIP: Choose a location that doesn't interfere with the driver's vision or access to driving controls, won't interfere with the deployment of airbags or other safety equipment, and makes Starmate 8 easily accessible for operation.

Vent Mount Method:

- Select a vent with ample room for Starmate 8.
- Some vents have recessed louvers. If yours are recessed, remove the regular vent clamps and install the extended vent clamps.

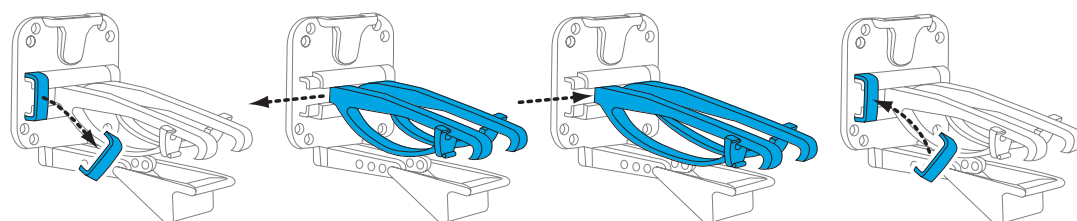

- Attach the Dash Mount to the PowerConnect Vehicle Dock using the provided screws.

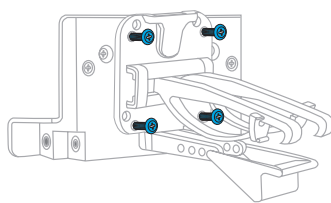

- Install the Vent Mount onto the vehicle vent:

- Insert the vent mount into the vent opening.

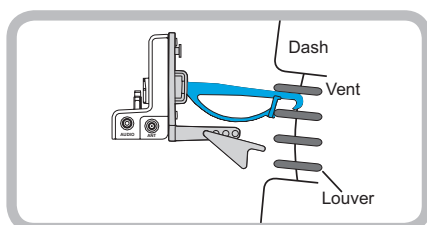

- Push until hooked on the rear of the vent louver. Rest the foot against the bottom of the vent.

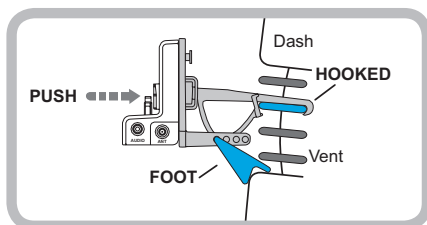

- If necessary, adjust the tilt of the Vent Mount by repositioning the foot to a different tilt adjustment hole.

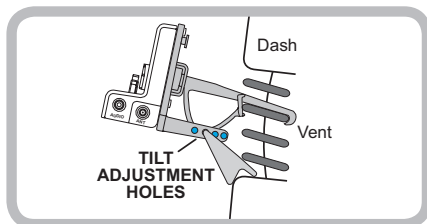

2 Mount the Magnetic Mount Antenna

- Mount the Magnetic Mount Antenna outside your vehicle, on a clean and dry horizontal surface that will always face the sky.



- Choose the location for the antenna according to your type of vehicle. Center it between the left and right sides, and away from other antennas.

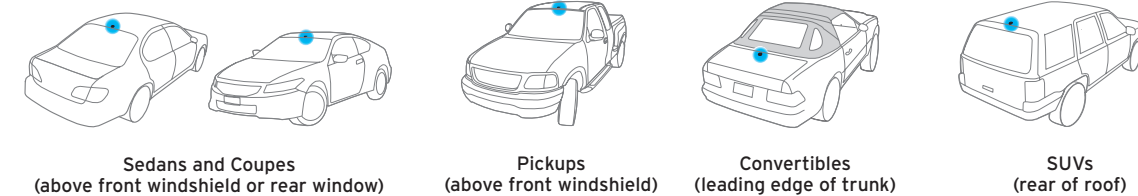

- Attach the Rubber Tail to the antenna and press the antenna cable into the Rubber Tail. Use the Rubber Tail to position the antenna the correct distance from the edge of the roof or trunk lid.

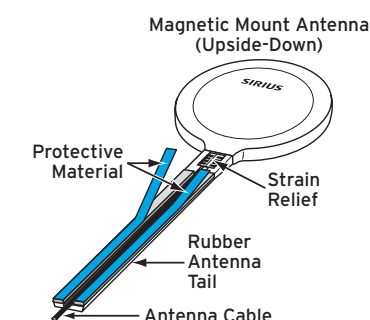

- Clean the surface of the selected mounting location using the alcohol preparation pad and let it dry thoroughly. Peel the protective material from the adhesive strips and press the Rubber Tail firmly into place on the vehicle for 30 seconds. At room temperature (68°F), maximum adhesion usually occurs within 72 hours. During this period, avoid car washes and other contact with the antenna and the Rubber Tail.

3 Route the Antenna Cable

NOTE: These instructions are for a sedan or coupe where the antenna is mounted above the front windshield. The User Guide has detailed antenna cable routing instructions for all types of vehicles, beginning on page 27.

- Tuck the antenna cable under the windshield rubber molding and run it to the nearest corner.
- Route the cable out of the molding and into the rubber weather stripping around the door opening.
- Lift the weather stripping. Tuck and run the cable inside it to the bottom of the door opening. Replace the weather stripping.
- Pull the cable out and route it to Starmate 8.
- Plug the Magnetic Mount Antenna connector into the silver ANT connector at the right side of the PowerConnect Vehicle Dock.

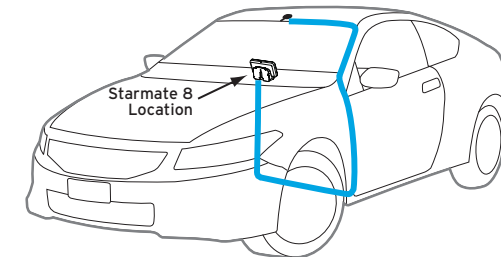

TIP: Include enough slack in your routing to accommodate open doors or the hood lid. Coil any excess cable in a hidden location and keep it away from any vehicle pedals or controls.

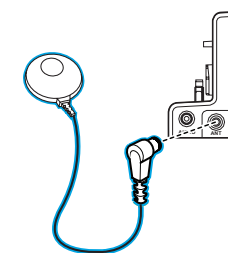

4 Connect the PowerConnect Power Adapter

- Insert the PowerConnect Power Adapter into your vehicle's cigarette lighter or power adapter socket. Plug the other end into the red PWR connector on the left side of the PowerConnect Vehicle Dock.

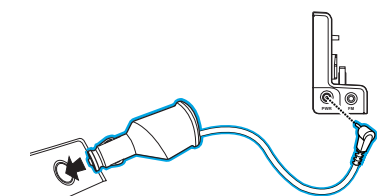

- Place Starmate 8 into the dock and press the **Power** button.

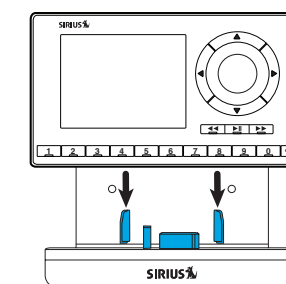

5 Verify Signal Reception

- Be sure the vehicle is outside and the antenna has a clear view of the sky.
- Verify that you are receiving the Sirius signal. The Radio should be tuned to channel 184, the Sirius Preview channel. There should be at least one bar on the lower left corner of the screen that denotes antenna signal strength.

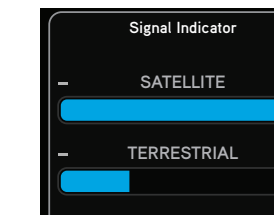
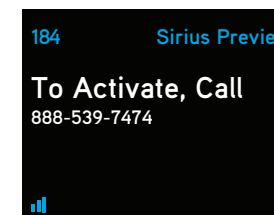

- You can also press **menu** and then press **▼** to scroll to and highlight **Signal Indicator**. Press the **Select** button. The Satellite and Terrestrial bars show the strength of the signal being received. If the signal reception is good, press and hold **menu** to return to channel 184, the Sirius Preview channel.



SIRIUS STARMATE 8

Dock & Play Radio + Vehicle Kit

Quick Start Guide

Self installation instructions and tips are provided for your convenience. It is your responsibility to determine if you have the knowledge, skills and physical ability required to properly perform an installation. SiriusXM shall have no liability for damage or injury resulting from the installation or use of any SiriusXM or third party products. It is your responsibility to ensure that all products are installed in adherence with local laws and regulations and in such a manner as to allow a vehicle to be operated safely and without distraction. SiriusXM product warranties do not cover the installation, removal or reinstallation of any product.

siriusxm.com

Sirius XM Radio Inc.
1221 Avenue of the Americas
New York, NY 10020

1.888.539.7474

6 Connect the Audio

Decide on one of the following in-box audio connection options. Refer to "Connect the Audio" on page 41 of the User Guide for details including other connection options.

Option 1: Best: Use the provided **Aux In Cable**, if your vehicle's stereo system has an auxiliary input jack.

- Plug one end of the cable into the **green AUDIO** connector on the **PowerConnect Vehicle Dock** and the other end into the auxiliary input jack on the vehicle's stereo system.
- Turn on your vehicle's stereo system and set it to play from the auxiliary input source.
- You should now hear channel 184, the Sirius Preview channel. The installation is complete.

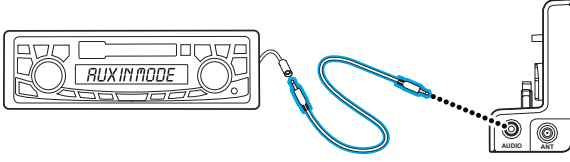

TIP! Refer to your vehicle's owner's manual to find the location of the auxiliary input jack, or consult the vehicle dealer.

Option 2: Good: Use the **PowerConnect™** feature of Starmate 8. **PowerConnect** plays the Sirius audio through your vehicle's FM radio.

- Find and make a list of all available FM channels in your area that are not being used by an FM radio station.
- Pick the first FM channel on your list. Tune your vehicle's FM radio to this FM channel.
- Set your Starmate 8 to transmit on the same FM channel that you have selected on your vehicle's FM radio:
 - Press **menu** and then press **▼** to scroll to and highlight **FM Settings**. Press the **Select** button.
 - Press **▼** to scroll to and highlight **FM Channels**. Press the **Select** button.
 - Press **▼** to scroll to and highlight **FM2**. Press the **Select** button.
 - Press **◀** and **▶** to tune in steps of .2, or press **▼** and **▲** to tune in steps of 1 to select the available FM channel you have chosen. Press the **Select** button to select the FM channel.
 - Start Using** will be highlighted. Press the **Select** button.
 - The selected FM channel will be confirmed on the display screen.

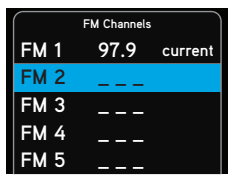

- If you are not satisfied, move to the next FM channel on your list and repeat the process. Continue until you have found an FM channel with which you are satisfied.



7 Subscribe

You can either follow the general activation and subscription process or use the on-board activation guide to activate your Starmate 8 and subscribe to the Sirius service.

General activation and subscription process:

- Make sure your Starmate 8 is turned on, tuned to Sirius Preview channel 184, and receiving the Sirius signal so that you can hear the Sirius audio.
- When you first turn on Starmate 8, the Sirius channel lineup may automatically update after the initial startup sequence. Wait until any channel updates have completed before pressing any buttons. Once the channels have been updated, the Radio will automatically tune to channel 184.
- Make a note of the Sirius ID. You can find it:
 - by selecting **Sirius ID** in menu items
 - on channel 0 (zero)
 - on a label on the bottom of the gift box
 - on the label on the back of your Starmate 8
- To subscribe:
 - Online: Go to www.siriusxm.com/activatenow to access or set up an online account, subscribe to the service, and activate your Radio.
 - OR
 - By phone: Call 1-888-539-Sirius (1-888-539-7474)
- Activation usually takes less than 5 minutes after you have completed the subscription process, but sometimes may take longer. We recommend that your Radio remain on until activated. When your service is activated, Starmate 8 will display an alert message. To continue, press any button.

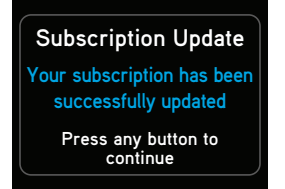

Press **▲** or **▼** to tune to other channels, and **◀** or **▶** to browse the different categories of channels. Learn what all the buttons do in the next box.

Activation guide:

For your convenience, Starmate 8 has an on-board activation guide. You can activate your Radio and subscribe to the Sirius service by using this guide, where you will be guided step-by-step through the subscription process. To access and use the guide, simply follow these steps:

- When you first turn on Starmate 8, the Sirius channel lineup may automatically update after the initial startup sequence. Wait until any channel updates have completed before pressing any buttons. Once the channels have been updated, the Radio will automatically tune to Sirius Preview channel 184.
- Press **menu**.
- Activate Radio** will be highlighted. Press the **Select** button.
- Follow the directions on each successive screen until you complete the subscription process.

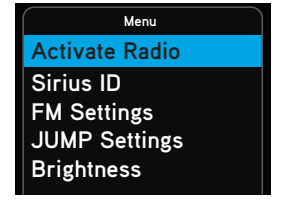

Starmate 8 Button Functions

- Up and Down Buttons:** Press to preview and tune to channels through the channel lineup; also press to scroll through lists and highlight menu items.
- Left and Right Buttons:** Press to search for channels by category.
- Power Button:** Press to turn Radio on and off.
- Select Button:** Press to confirm selection of highlighted items in a menu or list.
- Menu Button:** Press to access advanced features and configuration options; in configuration options, press and hold to return to main display screen.
- FM Button:** Press to access and cycle through FM presets.
- Jump Button:** Press to directly access traffic and weather for the city of your choice; or press it to go back to the previous channel to which you were listening.
- Direct Button:** Press first before entering the channel number, to directly tune to a channel.
- Number Buttons (1-0 direct):** Press to tune to a stored favorite channel, press and hold to store a favorite channel; also enter a channel number.
- Trim Ring:** Changeable decorative Trim Ring.
- Pause and Replay Buttons:** Pause, rewind, and replay live radio.

? What's in the Box?

CAUTION: Do not attempt to install, activate, or adjust any of the setting options described in this Quick Start Guide unless your vehicle is parked in a safe location.

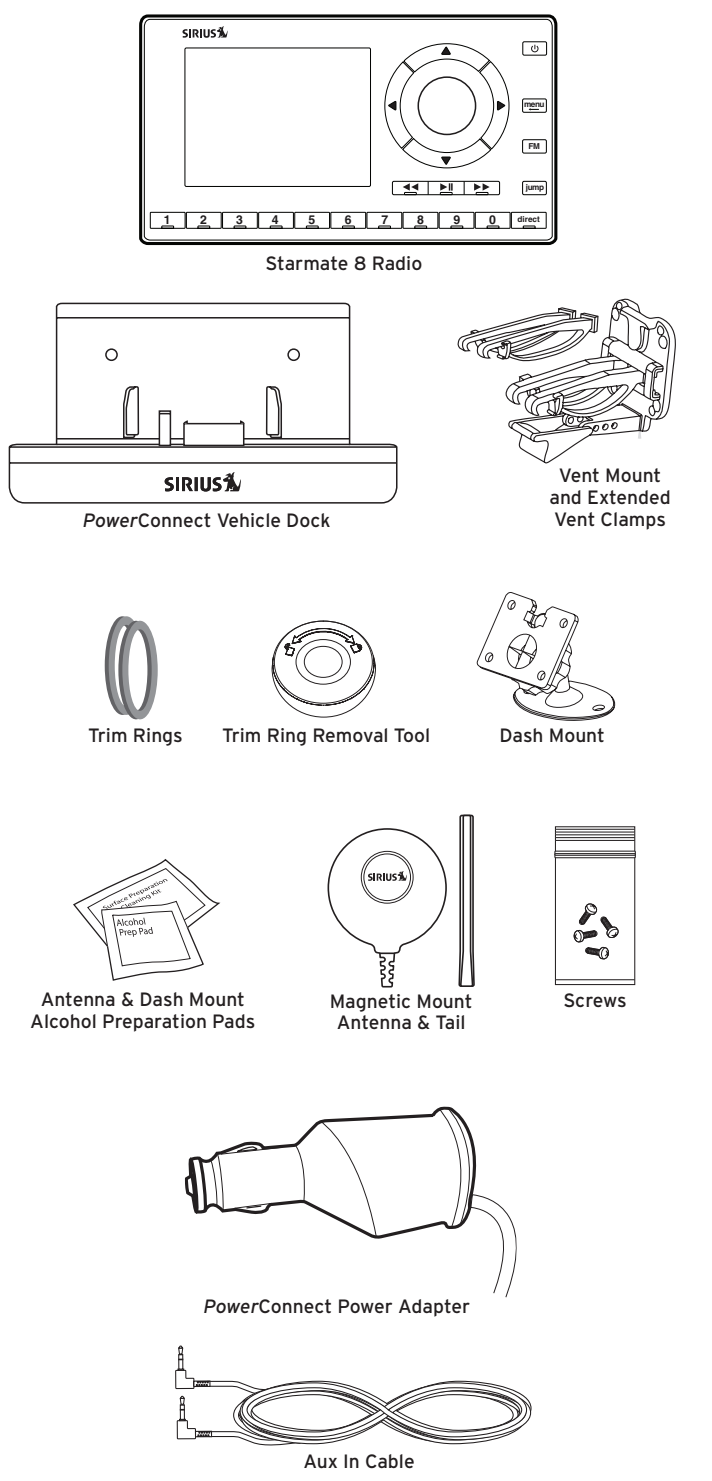

Starmate 8 Main Display

When listening to a channel, information about the channel and what is currently playing is displayed.

- Channel Number:** 28
- Channel Name:** The Spectrum
- Artist Name or Talk Show Host or Sports Teams/Score:** Tom Petty
- Song/Program Title or Talk Show Schedule or Game Time/Game Details:** I Should Have Known It
- Antenna Signal Strength:** (indicated by a bar graph)