

**Item No. 516041 - Padded Holder with Tilt Swivel and Pass-Through Connector with Horizontal support**



**Compatible with:**

Apple iPhone 2nd Generation (3G)  
Apple iPhone 3G  
Apple iPhone 3GS  
Apple iPhone 3rd Generation (3G)  
Apple iPhone 3rd Generation (3GS)  
AT&T Apple iPhone 3G

AT&T Apple iPhone 3GS



**Warnings:**

Carefully read all instructions and review the images before attaching.

**Do not** attach anything to the mount until after attaching the mount to the dashboard. Doing so makes it more difficult to attach the mount to the dash. **Please note:** If you screw into the mount it will be considered used and therefore non-refundable.

The ProClip mount and/or holder in the installation pictures may look slightly different from the one you have received. However, the same instructions apply. If you have questions call our customer service at **1-800-296-3212** or **+1-847-388-7171**.

ProClip USA, Inc. may not be held liable for any personal injury or damage to a vehicle or device, resulting from accident or improper use or installation, before, during or after the installation or removal of this mount and/or holder.



Loosen the screw in the center of the holder so you can remove the tilt swivel attaching plate on the back. Place the attaching plate on desired position. Screw the attaching plate into place with the enclosed screws. Place the holder over the attaching plate so the tilt swivel fits. Screw the holder onto the attaching plate. You can easily switch between an upright and a horizontal position, simply by turning the holder into desired position.

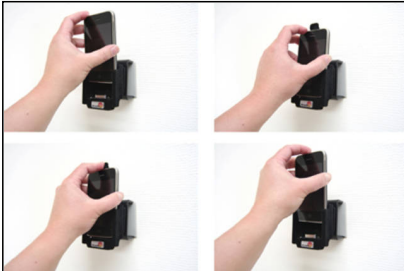

To place the device in the holder: Place the bottom part of the device into the holder. Press the top of the device forward and in the same time slide the device downward into place in the holder. To remove the device from the holder: Press the upper part of the holder forward. When the device is set free, lift it upward out of the holder.

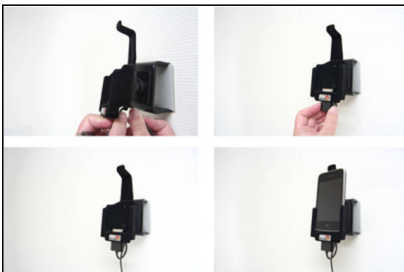

If you are using a cable to your device: Press the cable into place in the cable holder in the bottom part of the holder. The cable will then be held in place giving a neat installation.



The holder is in place.