

BOSE[®]



LIFESTYLE[®] 235 HOME ENTERTAINMENT SYSTEM

Setup Guide | Guía de instalación | Guide d'installation

SAFETY INFORMATION

Please read this guide

Please take the time to follow the instructions in this guide carefully. They will help you set up and use your system properly so you can enjoy its advanced features. Please save this guide for future reference.

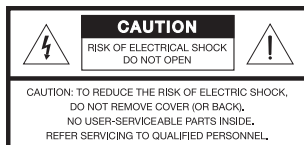

 The lightning flash with arrowhead symbol within an equilateral triangle alerts the user to the presence of uninsulated, dangerous voltage within the system enclosure that may be of sufficient magnitude to constitute a risk of electric shock.

 The exclamation point within an equilateral triangle alerts the user to the presence of important operating and maintenance instructions in this guide.

WARNINGS:

- To reduce the risk of fire or electrical shock, do not expose the product to rain or moisture.
- Do not expose this apparatus to dripping or splashing, and do not place objects filled with liquids, such as vases, on or near the apparatus. As with any electronic products, use care not to spill liquids into any part of the system. Liquids can cause a failure and/or a fire hazard.
- Do not place any naked flame sources, such as lighted candles, on or near the apparatus.
- Contains small parts that may be a choking hazard. Not suitable for children under age 3.



CAUTIONS:

- Make no modifications to the system or accessories. Unauthorized alterations may compromise safety, regulatory compliance, and system performance, and may void the warranty.
- Long-term exposure to loud music may cause hearing damage. It is best to avoid extreme volume when using headphones, especially for extended periods.

Notes:

- Where the mains plug or appliance coupler is used as the disconnect device, such disconnect device shall remain readily operable.
- The product must be used indoors. It is neither designed nor tested for use outdoors, in recreation vehicles, or on boats.
- This product is intended to be used only with the power supply provided.
- The product label is located on the bottom of the product.
- The speaker wire and interconnect cables included with this system are not approved for in-wall installation. Please check your local building codes for the correct type of wire and cable required for in wall installation.

Additional safety information

See the additional instructions on the *Important Safety Information* sheet enclosed in the shipping carton.

©2010 Bose Corporation. No part of this work may be reproduced, modified, distributed, or otherwise used without prior written permission.

Batteries



Please dispose of used batteries properly, following any local regulations. Do not incinerate.



廢電池請回收

Names and Contents of Toxic or Hazardous Substances or Elements

Part Name	Toxic or Hazardous Substances and Elements					
	Lead (Pb)	Mercury (Hg)	Cadmium (Cd)	Hexavalent (CR(VI))	Polybrominated Biphenyl (PBB)	Polybrominated diphenylether (PBDE)
PCBs	X	0	0	0	0	0
Metal parts	X	0	0	0	0	0
Plastic parts	0	0	0	0	0	0
Speakers	X	0	0	0	0	0
Cables	X	0	0	0	0	0

O: Indicates that this toxic or hazardous substance contained in all of the homogeneous materials for this part is below the limit requirement in SJ/T 11363-2006.

X: Indicates that this toxic or hazardous substance contained in at least one of the homogeneous materials used for this part is above the limit requirement in SJ/T 11363-2006.



Welcome

Thank you for choosing a Bose® LIFESTYLE® 235 home entertainment system. This guide provides step-by-step instructions for setting up your new system. There are two phases to the setup process:

Physical setup phase: Placing the system components and connecting them together.

Interactive setup phase: Completing your setup following the interactive steps on your TV screen provided by the Unify™ intelligent integration system.

Unpacking

The parts of your new system are packaged in four numbered kits plus a small box containing the appropriate power cords:

- **1** Control console kit
- **2** Acoustimass® module kit
- **3** Speaker kit
- **4** Interactive kit
-  Power cord kit (used with kits 1 and 2)

Starting with Kit 1, unpack each kit and set up its contents before unpacking the next one.

Be sure to save all of the packing materials. These provide the safest means for any necessary shipping or transporting.

If any part appears damaged, do not attempt to use it. Notify Bose or your authorized Bose dealer immediately. For Bose contact information, refer to the address sheet included in Kit 4.

SYSTEM SETUP

1

Control console kit

What you need for the following steps:

From Kit 1

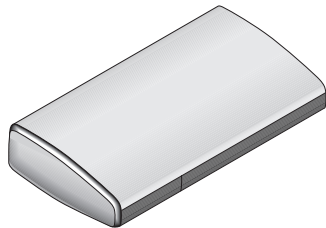

Control console

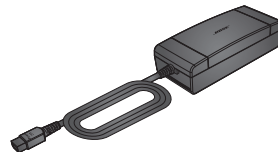

Power supply



Audio input cable



HDMI® Cable



From the power cord kit



Power cord

1. Place the control console on a flat, stable surface near your TV.

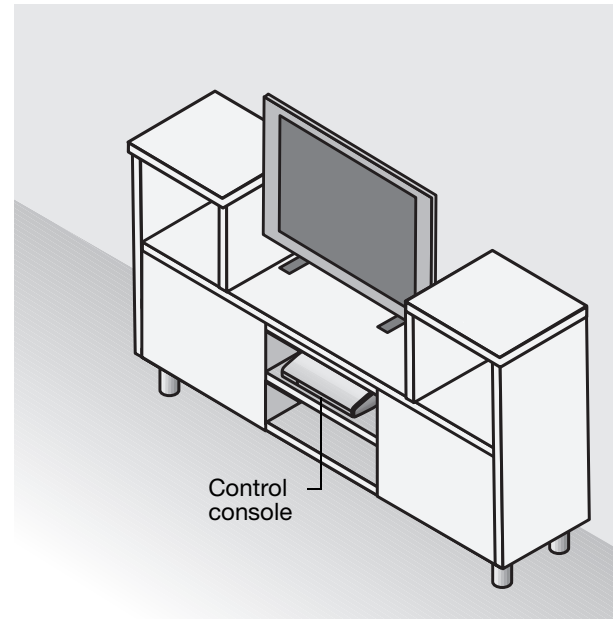

Control console

Note: Until your system is completely installed, it may be helpful to keep the control console positioned for easy access to its rear connection panel.

2. Plug one end of the HDMI® cable into an HDMI INPUT connector on your TV.
If an HDMI cable is already connected to an HDMI input on your TV, you can use this connected cable. Just disconnect the other end.

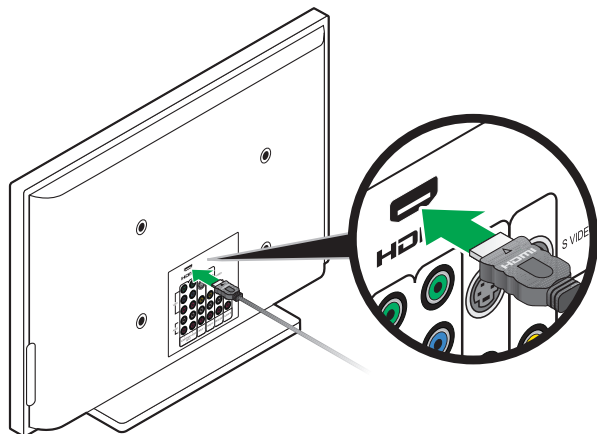

3. Plug the other end of the HDMI cable you are using into the connector labeled **HDMI OUT Video to TV** on the control console.

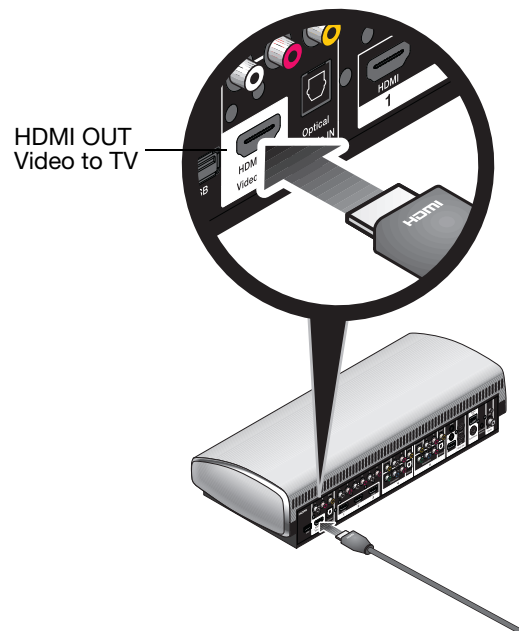

SYSTEM SETUP

4. Plug one end of the audio input cable into the **Acoustimass® Module** connector on the control console.

Make sure the flat surface with the arrow on the plug faces up.

Leave the other end of the cable on the floor. You will be asked to connect it while setting up the next kit.

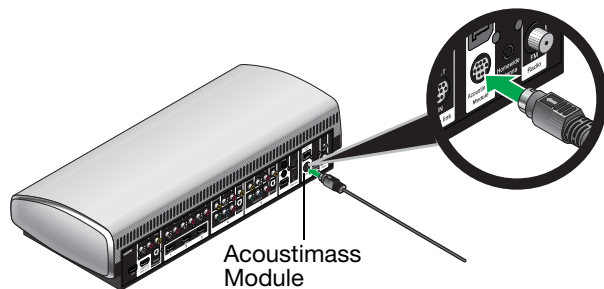

5. Plug the power supply output cord into the control console **Power** connector.

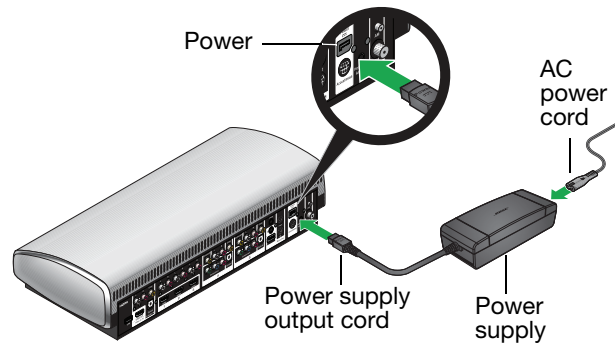

6. Remove a power cord from the power cord kit. 
7. Plug one end of the power cord into the power supply. *Make sure you push the plug in as far as it can go.*
8. Plug the other end of the power cord into a live AC (mains) power outlet.
9. Continue with Kit **2** on the next page.

2

Acoustimass® module kit

What you need for the following steps:

From Kit 2

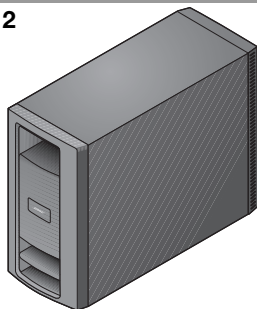

Acoustimass module



From the
power
cord kit



Power cord

1. Place the Acoustimass module on the floor at the same end of the room as the TV. Make sure there is a live AC outlet nearby.

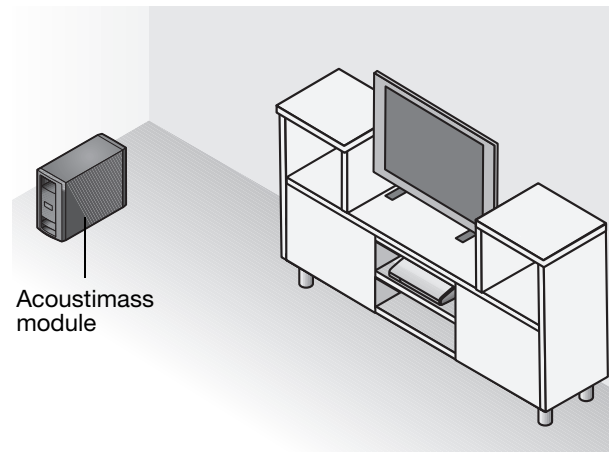

2. Lay the module on its side and locate the connector panel.

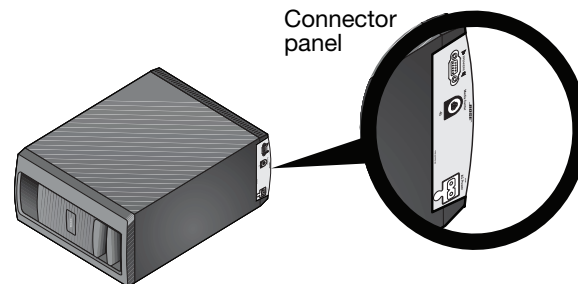

SYSTEM SETUP

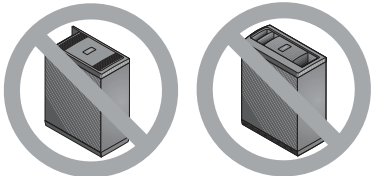

CAUTION: DO NOT stand the Acoustimass® module on its front or back end.

- Using the audio input cable from the control console, plug the free end into the **Media Center** connector on the Acoustimass module.

Make sure the flat surface with the arrow faces the front of the module.

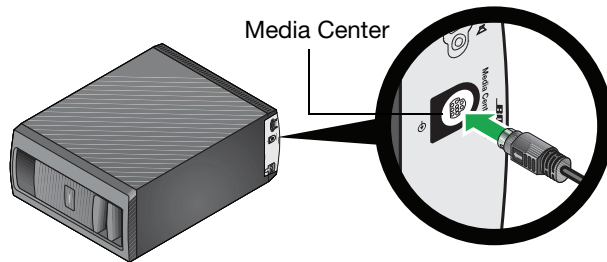

- Remove a power cord from the power cord kit.



- Plug one end of the power cord into the **AC Power** connector on the Acoustimass module. *Make sure you push the plug in as far as it can go.*

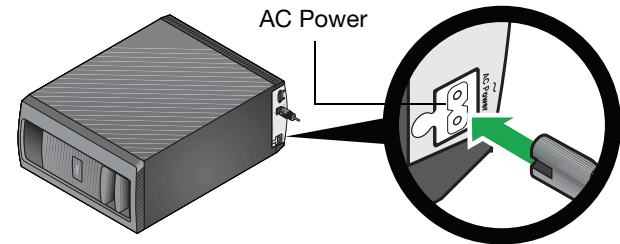

- Plug the other end of the power cord into a live AC (mains) power outlet.
- Continue with Kit **3** on the next page.

3

Speaker kit

What you need for the following steps:

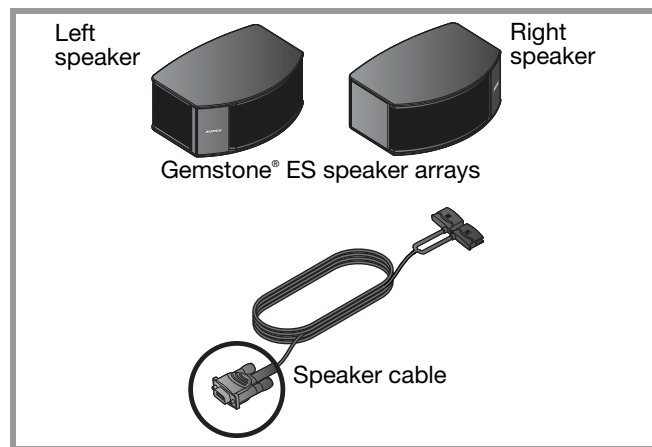

Note: You can place system speakers on wall brackets or floor stands. To purchase these accessories, contact your local Bose dealer or visit www.Bose.com.

1. Place the speaker marked L (on the back) to the left of the TV and the other (marked R) to the right.

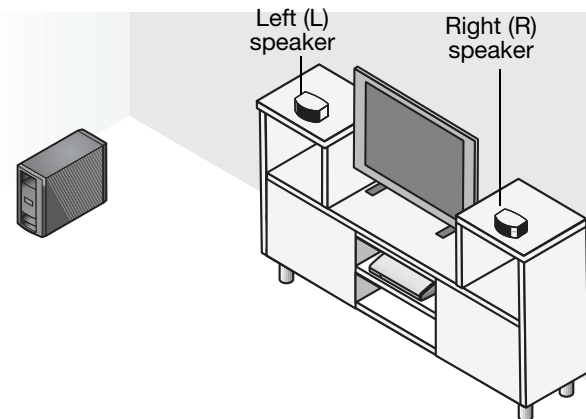

- Keep each speaker within 3 ft (1 m) of the TV screen to prevent too much separation of the sound from the picture. Vary this distance to suit your room conditions and personal preference.
- If possible, place the speakers on an open shelf.
- If placing the speakers in an enclosed bookcase, center them between sides and position them at the front edge of the shelf.
- Keep each speaker facing straight out into the room. Do not place them at an angle.

SYSTEM SETUP

2. At the end of the speaker cable with two plugs, separate the cable so each plug can reach one speaker.

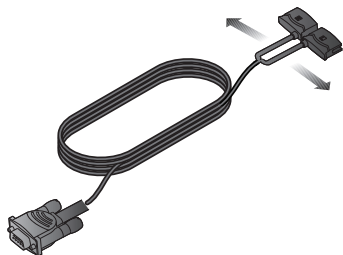

3. Select the plug labeled **L** and insert it into the speaker that is marked **L** and sits to the left of the television as you face it.

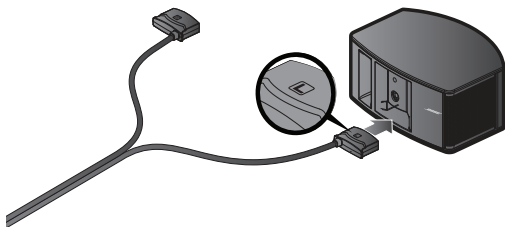

4. Insert the plug marked **R** into the speaker to the right of your television as you face it.

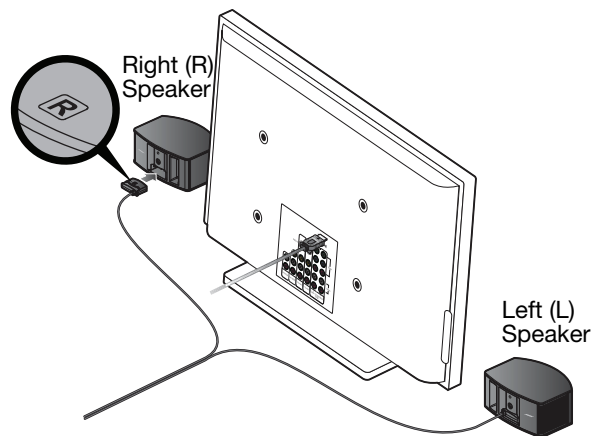

5. Plug the free end of the speaker cable into the **SPEAKERS** connector on the Acoustimass® module.

Tighten each fastener screw by hand to secure the plug.

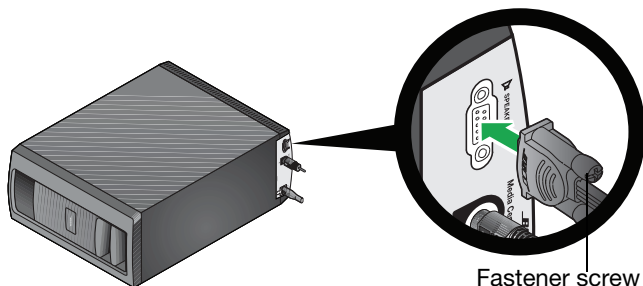

6. Put the Acoustimass module in its final position:
 - Upright (BEST) or on either side (ALTERNATE).

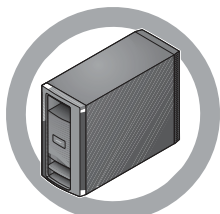

BEST

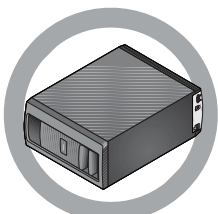

ALTERNATE

- With the front opening facing into the room.
- At least 18 in (45 cm) from any TV to avoid magnetic interference with the TV image. Move it farther away if you still notice interference.

- When the position is determined, you can use the supplied rubber feet on the bottom surface of the module.

You can locate these rubber feet when you open Kit 4.

CAUTION: Do not put electronic media, such as video or audio tapes, on or next to the module for long periods of time. The magnetic field surrounding the module may erase some or all of the recorded material.

CAUTION: DO NOT BLOCK the ventilation openings on the module. This can cause it to overheat.

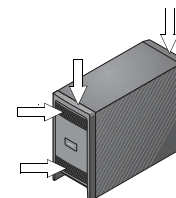

7. Continue with Kit **4** on the next page.

SYSTEM SETUP

4

Interactive kit

What you need for the following steps:

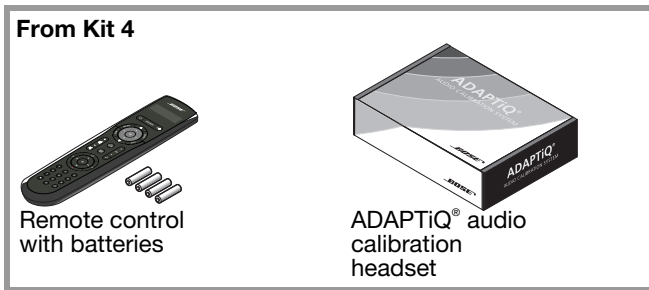

Congratulations! At this point you have set up the control console, the Acoustimass® module, and the speakers. You are now ready to turn on your system and enter the interactive phase of the setup process using the Unify™ intelligent integration system.

IMPORTANT!

- **Before you start, make sure your speakers and Acoustimass module are in their final positions.**
- **Do not connect any devices to the control console at this time. The instructions provided on your TV will tell you when to do this.**

1. Slide the battery compartment cover off the back of the remote control.

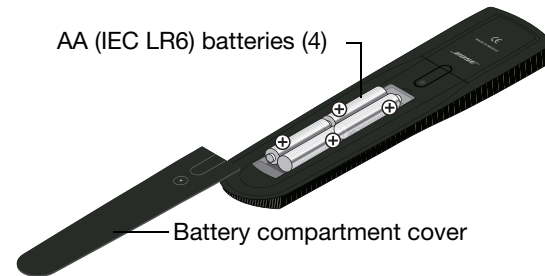

2. Install four AA (IEC LR6) batteries, matching the polarity markings (+ and -) to the markings inside the battery compartment.
3. Slide the battery cover back into place.

4. Press the power button (⏻) on the control console to turn on your system.

Because the system is in a low power state when in standby, it takes several seconds to start. When the power light changes from blinking to steady green, your system is ready to use.



5. Turn on your TV.
6. Using the remote that came with your TV, change the TV input to the one that is connected to your LIFESTYLE® 235 system.
7. Follow the instructions on your TV screen. You will be prompted to do the following:
 - Select your language.
 - Optimize the audio from your system using the ADAPTIQ® audio calibration system.
 - Connect audio/video devices to the control console.
 - Configure your Bose® remote to control your connected devices.

Other Kit 4 items

The remaining items in Kit 4 may or may not be required to set up your LIFESTYLE® 235 system. For more information on using these accessories or adding other devices to your system at another time, see the operating guide.



IR emitter cable



Stereo audio cable



AM antenna



FM antenna



Rubber feet
for Acoustimass®
module



Rubber feet
for front center
speaker



Dock compatible
with iPod/iPhone



Operating guide



USB flash drive
(for system
updating only)

SYSTEM SETUP

Applying rubber feet

When placing the Acoustimass® module on bare floors, you can attach the included rubber feet to the bottom of the module for greater stability and to protect your floor.

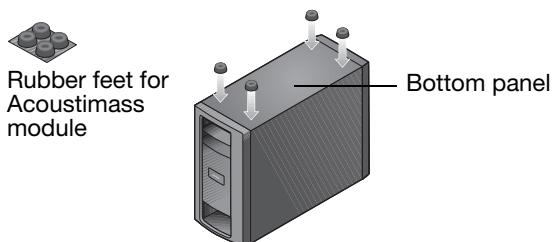

Vibration can cause speakers to move, particularly if placed on a smooth surface like glass or highly polished wood. If you are placing the center speaker on such a surface, you can attach the included rubber feet to the bottom of the speaker for greater stability.

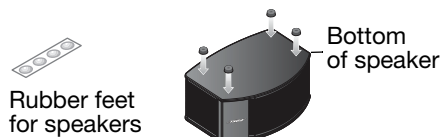

If you have setup problems

If you experience any difficulties during the setup process, such as an unrecognized device remote or a connection error, you can reactivate the interactive setup mode at any time and correct or change part of your system setup. See “Using the Setup Mode” in your system operating guide.

For help in trying to resolve any problems, see the troubleshooting table in your system operating guide.

Contacting customer service

For additional help in solving problems, contact Bose® Customer Service. See the address sheet included in Kit 4.

iPod and iPhone are trademarks of Apple Inc., registered in the U.S. and other countries.

HDMI and the HDMI logo are trademarks or registered trademarks of HDMI Licensing LLC in the United States and other countries.

©2010 Bose Corporation. No part of this work may be reproduced, modified, distributed, or otherwise used without prior written permission.



328338-0010

BOSE[®]
Better sound through research[®]

©2010 Bose Corporation, The Mountain,
Framingham, MA 01701-9168 USA
AM328338 Rev.00