

quick start guide

English

RFG293HA

Product features



Surround Multi Flow

A center-positioned fan and ducts with multiple flow effluences provide uniform cooling for each shelf and fresh food compartment corners.



Secure Auto Close Door System

- Secure Auto Close Door System
- Cool tight doors
- Energy saving
- Prevents condensation on fridge doors



Twin Cooling System

The refrigerator and the freezer have two evaporators. Given this independent system, the freezer and the refrigerator are cooled individually and more efficiently. Food odor from the refrigerator does not affect food in the freezer due to separate air flow circulation.



Easy Handle System

- Ez-open Freezer Door
- Ergonomic Door Design



Electronic control from outside of Pantry Cover

The Cool Select Pantry is a full width drawer with an adjustable temperature control to help keep food fresh longer.



Super Extended Drawer

The upper drawer in the freezer comes out automatically when you open the freezer door and can be pulled out all the way to the Tilting Pocket.

The Installation Space

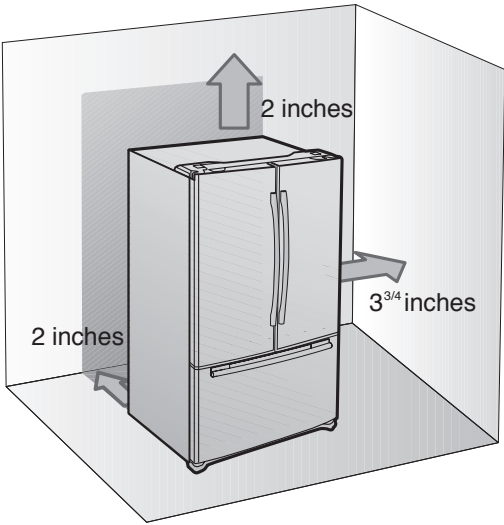

Selecting the best location for the refrigerator

- A location with easy access to the water supply.
- A location without direct exposure to sunlight.
- A location with a leveled floor.
- A location with enough space for the refrigerator doors to open easily.
- Allow sufficient space for air circulation of the internal cooling system.
If the refrigerator does not have enough space, the internal cooling system may not work properly.

If your refrigerator has an ice maker, allow extra space at the back for the water line connections. When you install the refrigerator next to a fixed wall, minimum clearance is 3 3/4" (95mm) between the refrigerator and wall to allow the door to swing open.

First thing! Make sure that you can easily move your Refrigerator to its final location by measuring doorways (both width and height), thresholds, ceilings, stairways, etc.

The following chart details the exact height and depth of Samsung French Door Refrigerator.

Model	Depth "A"	Width "B"	Height "C"	Overall Height "D"	Depth "E"
RFG293HA	32.91" (83.6cm)	35.75" (90.8cm)	68.66" (174.4cm)	69.84" (177.4cm)	35.63" (90.5cm)

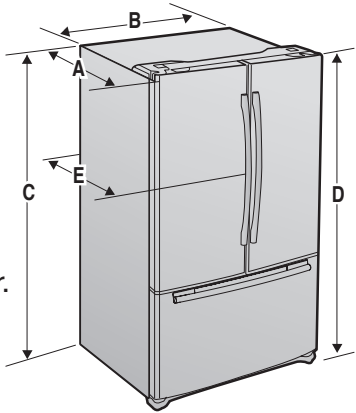

- Allow clearance to the right, left, back and top when installing.
This will help reduce power consumption and keep your energy bills lower.
- Do not install the refrigerator where the temperature will go below 50°F (10°C).
- Do not locate the refrigerator where it may become wet.



FLOORING

For proper installation, this refrigerator must be placed on a leveled surface of hard material that is the same height as the rest of the flooring. This surface should be strong enough to support a fully loaded refrigerator, or approximately 328lbs (150kg). To protect the finish of the flooring, cut a large section of the cardboard carton and place under the refrigerator where you are working. When moving a refrigerator, it is needed to pull and push in the back-and-forth direction.

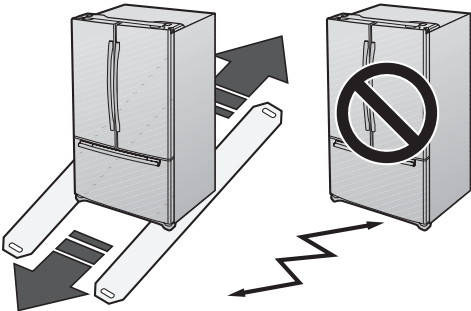

Operating your French Door Refrigerator

USING THE CONTROL PANEL & DISPLAY

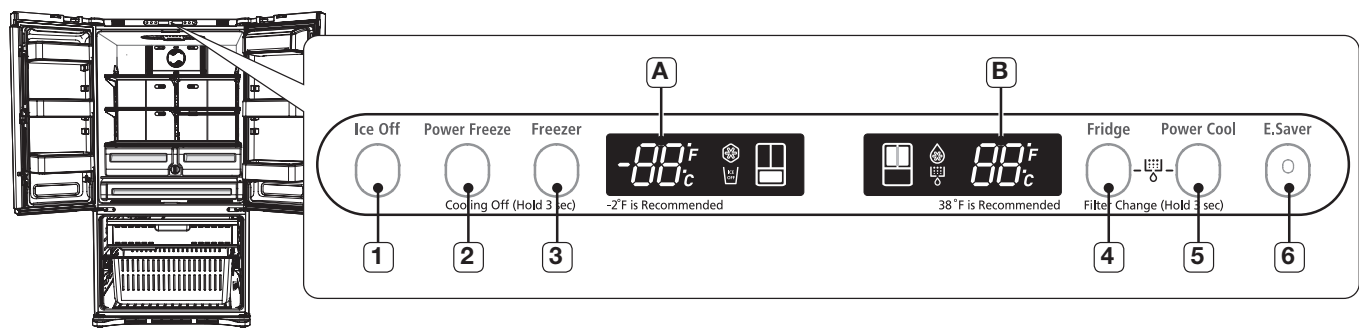

Ice off Button

Press the Ice Off button (1), if you don't want to make more ice. The icon (ICE OFF) will light up the Ice-Maker stops making ice.

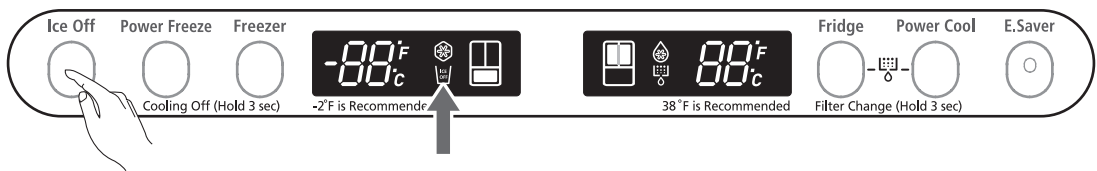

In this case of following, it is recommended to stop making ices.

- There are enough ices in the ice bucket.
- You want to save on water and energy.
- Water does not supply to refrigerator.



If ice maker function is ON, and water line is not connected, there will be a water valve noise from back of unit. Press the Ice Off button until Ice Off indicator (ICE OFF) illuminated.

If you want to fill the case ice cube to maximum capacity after installation, make sure to do the following steps.

1. Check the display whether the Ice off light (ICE OFF) is ON or OFF. If the Ice off light is ON, press the Ice off button (1).
2. Allow your refrigerator to operate and cool down for 24 hours (or 1 full day). Waiting 24 hours will allow your ice maker to cool properly.



- In case ice doesn't come out, press the test button located on the right side of ice maker.
- Do not press the test button continuously, when the tray is filled with ice or water. Water may overflow or ice jamming may occur.
- Use only the ice maker provided with the refrigerator.
- The water supply to this refrigerator must only be installed/connected by a suitably qualified person and connect to a potable water supply only.
- In order to operate the ice maker properly, water pressure of 20~125psi is required.
- Do not try to disassemble the ice maker.

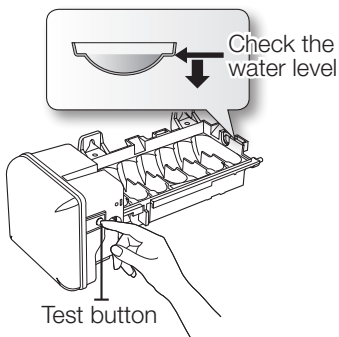

Operating your French Door Refrigerator

USING THE CONTROL PANEL & DISPLAY

Power Freeze Button

Press the Power Freeze button (2) if you want to speed up the time needed to freeze products in the Freezer. The icon (❄️) will light up and the inside temperature of the Freezer will decrease for about two and a half hours. When you have enough, just press the button again to cancel the Power Freeze mode.

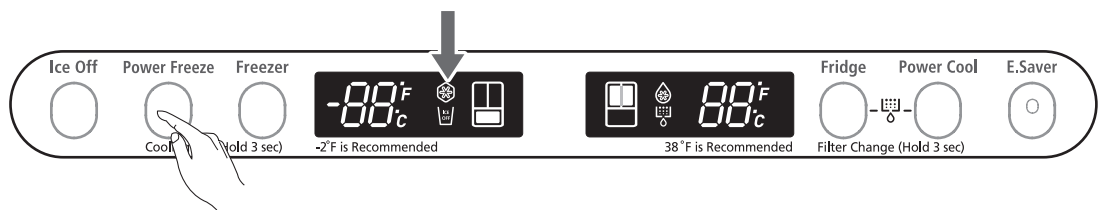

❏ If the Power Freeze mode is selected, a little of noise can be happen because of the continuous operation of compressor.

Power Cool Button

Press the Power Cool button (5) if you want to speed up the time needed to cool products in the Fridge. The icon (❄️) will light up and the inside temperature of the Fridge will decrease for about two and a half hours. When you have enough, just press the button again to cancel the Power Cool mode.

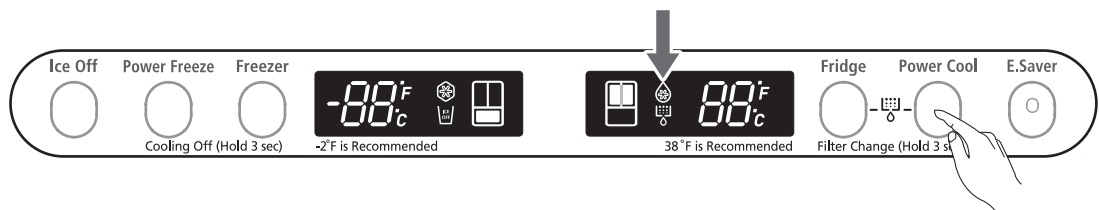

❏ If the Power Cool mode is selected, a little of noise can be happen because of the continuous operation of Compressor.

Freezer Button

Press the Freezer button (3) repeatedly until the desired temperature is shown in the display (A). Whenever you press the button, the temperature will move 2°F degrees each push and you can set the temperature between 8°F and -8°F. Five seconds after the new temperature is set, the display will again show the actual current freezer temperature until the new temperature is selected.

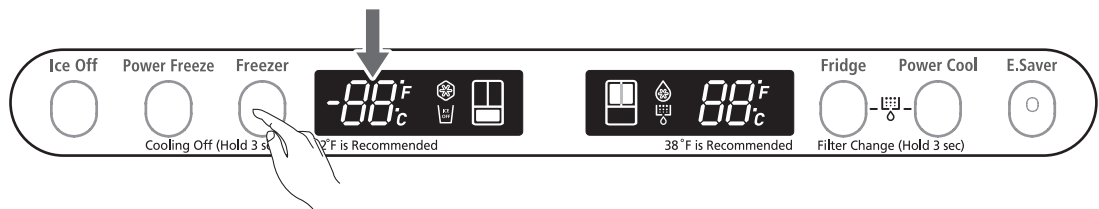

❏ -2°F is recommended.

Fridge Button

Press the Fridge button (4) repeatedly until the desired temperature is shown in the display (B). Whenever you press the button, the temperature will move 2°F degrees each push and you can set the temperature between 46°F and 34°F. Five seconds after the new temperature is set, the display will again show the actual current freezer temperature until the new temperature is selected.

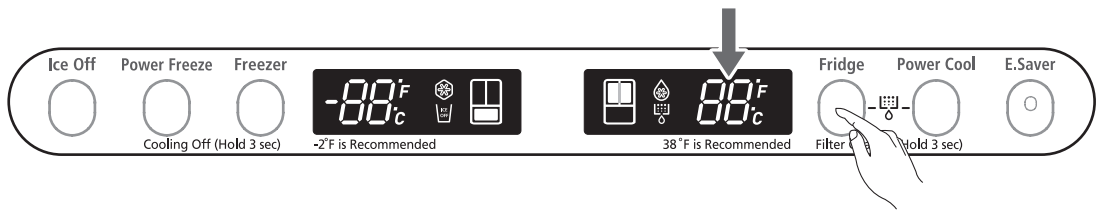

- 38°F is recommended.
- The temperature of the freezer, fridge or pantry room may rise when you open the doors too frequently, or if a large amount of warm or hot food is placed inside. This may cause the digital display to blink. Once the Freezer and Refrigerator temperature return to their normal set temperatures, the blinking will stop. If the blinking continues, you may need to “reset” the Refrigerator. Try unplugging the appliance, wait for around 10 minutes and then plug the power cord back in.

E.Saver Button

Press the E.Saver Button (6) for better energy efficiency. If E. Saver mode is ON, the button will light up blue.

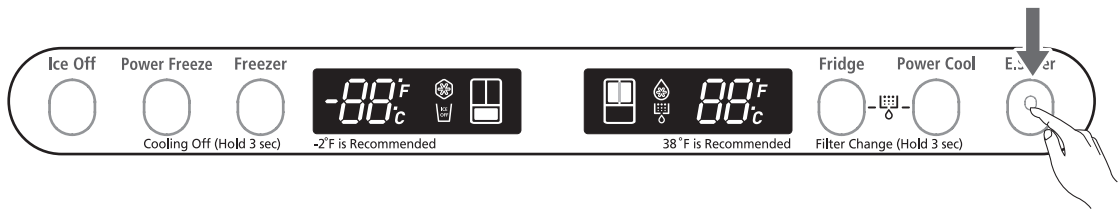

- If condensation occurs on the doors, wipe the water drops and turn E.Saving function.

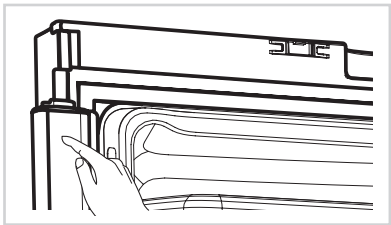

Cooling Off Mode

- This function is for store display refrigerators. It is not for customer use.
- CAUTION** In Cooling Off Mode, the refrigerator works but doesn't make cool air. To cancel this mode, press the Power Freeze and Freezer buttons at the same time for 3 seconds until a “Ding-Dong” sound is heard and the unit will now cool.

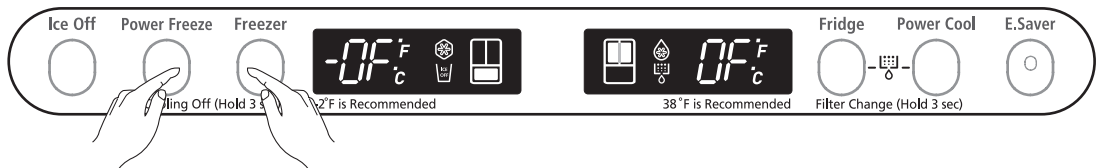



Operating your French Door Refrigerator

USING THE CONTROL PANEL & DISPLAY

Filter

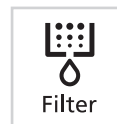
The Filter light () lets you know when it is time to change your water filter cartridge. When the filter indicator lights up red, it is time to change the filter. Changing the filter on time provides you with the freshest, cleanest water from your refrigerator. Typically this happens about every 6 months.



-  • The Filter Indicator will be Blue when you purchase the new refrigerator.
- The Filter Indicator will be Pink when you have used your water filter for 270 gallons or 5 months.
- The Filter Indicator will be Red when you have used your water filter for 300 gallons or 6 months.
-  Depending on the condition of water and region, time to change the water filter can be changed. So some area can be taken only two months until changing the new one.

How to change the water filter

1. Turn the water filter (**1**) about 1/4 turn, counter-clockwise.
2. Pull the water filter (**1**) from the case filter (**2**).

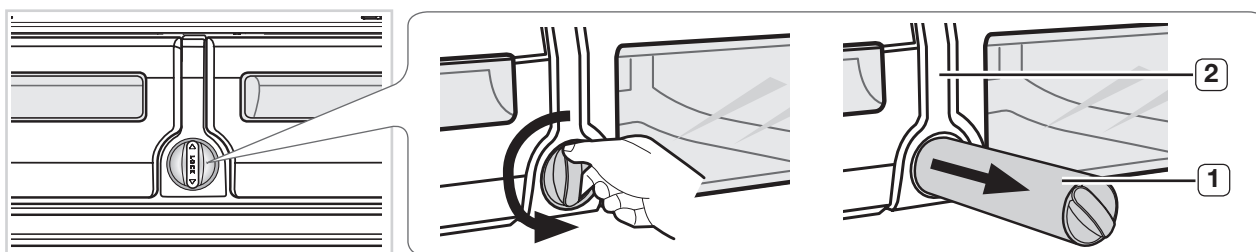

-  - To change the water filter more easily, shut off the water supply valve.
- Sometimes, it is hard to disassemble the water filter because of impurities in water.
In this case, put the grip of water filter and pull it hard.
- When you pull the water filter, a little of water can be leaked. It is normal.
To minimize the water leak, keep the filter cartridge horizontal or down the grip when you pull it.
- In order to prevent overflow, empty the tray water filter (**3**).
And dry around of case filter (**2**).

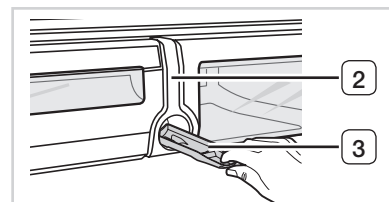

3. Insert new one into the case filter (**4**).
4. Push and turn the water filter clockwise, until it locked.

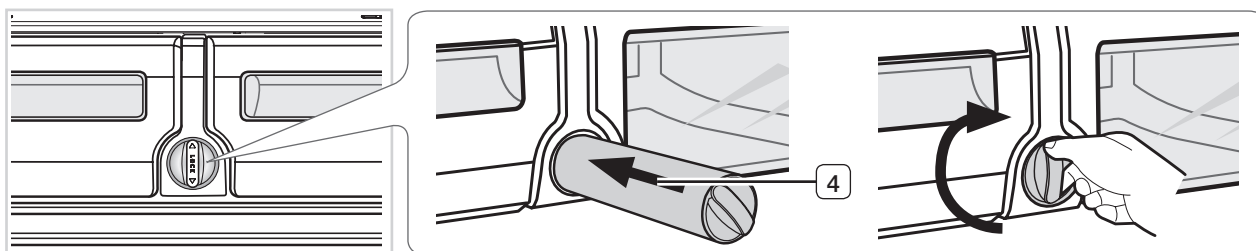

- If you are in trouble of inserting the water filter as high pressure of water, shut off the water supply valve.
- The locked symbol should be lined up with the indicator line.

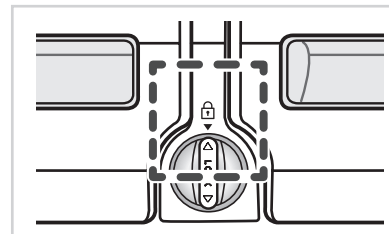

5. After above steps, press the “Fridge” and “Power Cool” button simultaneously for about 3 seconds to reset the water filter. The color of indicator () will be changed to blue from red.

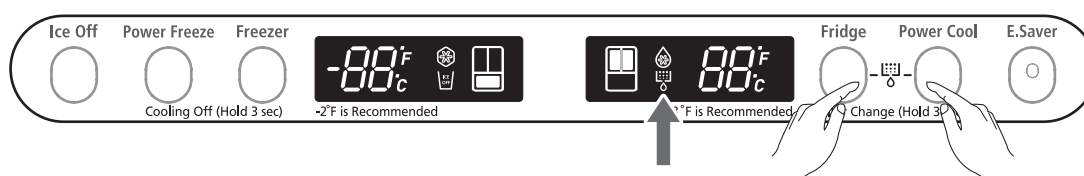

- For a replacement water filter, you can visit your local home improvement center or contact the Samsung Parts distributor.
Be sure the replacement water filter has the SAMSUNG logo on the box and on the water filter.
Link : <http://www.samsungparts.com>

Names and basic functions

NAME OF EACH COMPONENT

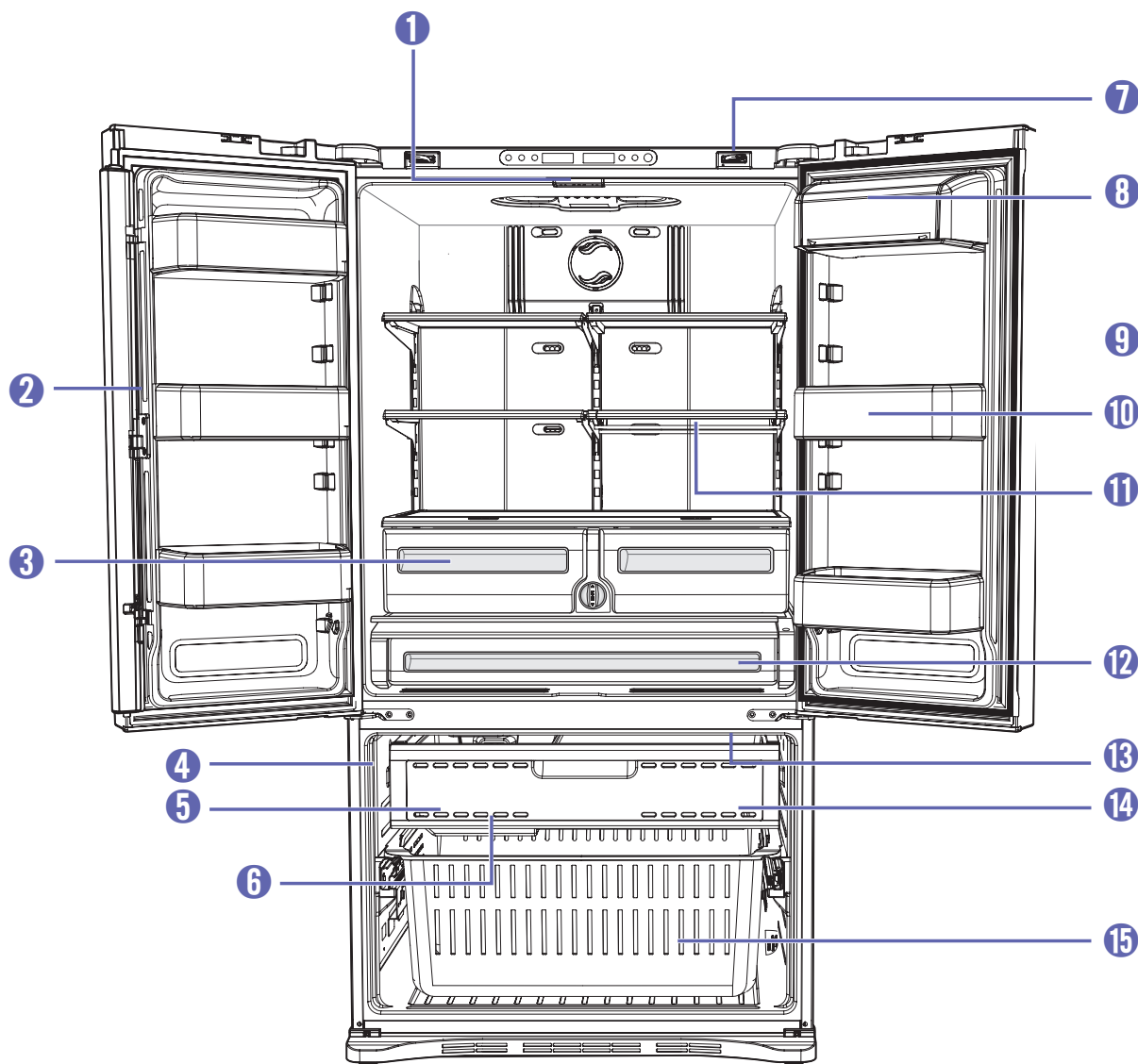

1. Light	6. Tilting Pocket	11. Quick-Space Glass Shelf
2. Vertical Hinged Section	7. Door Closer	12. Cool Select Pantry ^{PLUS}
3. Vegetable & Fruit Drawers	8. Dairy Compartment	13. Light
4. FZ Ice-Maker	9. Tempered glass shelves	14. Auto Pull Out Drawer
5. Ice Bucket	10. Door Bins	15. Freezer Drawer Bin

Troubleshooting

PROBLEM	SOLUTION
The refrigerator does not work at all or it does not chill sufficiently.	<ul style="list-style-type: none">• Check that the power plug is properly connected.• Check the set temperature on the digital display is warmer than freezer or fridge inner temperature.• Set the refrigerator colder.• Is the refrigerator in direct sunlight or located near a heat source?• Is the back of the Refrigerator too close to the wall and therefore keeping air from circulating?
The food in the fridge is frozen.	<ul style="list-style-type: none">• Check the set temperature on the digital display is too low.• Try setting it to a warmer temperature.• Is the temperature in the room too low? Set the refrigerator warmer.• Did you store the food which is juicy in the coldest part of the refrigerator?• Try moving those items on the other shelves in fridge instead of keeping them in the Cool Select Pantry^{PLUS}.
You hear unusual noise or sounds.	<ul style="list-style-type: none">• Check that the refrigerator is level and stable.• Is the back of the refrigerator too close to the wall and therefore keeping air from circulating?• Try locate the refrigerator keep away from the wall over 2 inches.• Was anything dropped behind or under the refrigerator?• A “ticking” sound is heard from inside the refrigerator. It is normal and occurs because various accessories are contracting or expanding according to the temperature of the refrigerator interior.
The cabinet-door sealing area of the appliance is hot and condensation is occurring.	<ul style="list-style-type: none">• Some heat is normal as anti-condensators are installed in the vertical hinged section of the refrigerator to prevent condensation.• Is the refrigerator door ajar? Condensation can occur when you leave the door open for a long time.• If a sound that hit something is heard from inside the refrigerator, It is normal. The sound comes due to ice cubes rubbing in the bucket periodically.
Ice Maker is not producing ice.	<ul style="list-style-type: none">• Did you wait for 12 hours after installation of the water supply line before making ice?• Is the water line connected and the shut-off valve opened?• Did you manually stop the ice making function?• Is the freezer temperature too warm? Try setting the freezer temperature lower.
You can hear water bubbling in the refrigerator.	<ul style="list-style-type: none">• This is normal. The bubbling comes from refrigerant circulating through the refrigerator.
There is a bad smell in the refrigerator.	<ul style="list-style-type: none">• Check for spoiled food.• Foods with strong odors(for example, fish) should be tightly covered.• Clean out your freezer periodically and throw away any spoiled or suspicious food.
Frost forms on the walls of the freezer.	<ul style="list-style-type: none">• Is the air vent blocked? Remove any obstructions so air can circulate freely.• Allow sufficient space between the foods stored for efficient air circulation.• Is the freezer drawer closed properly?
Auto close system does not work with the freezer door.	<ul style="list-style-type: none">• Is there an imbalance between the right and left parts of the door?• Close and open the door smoothly 1~2 times. Then, the auto close system will be worked well again.• Try opening the door smoothly to avoid the unbalance between the right part and the left part of the door.