

NISSAN

Maxima 2007-2008
Navigation Radios

****READ THIS FIRST****

Changing Sources (iPod, HD Radio, *Satellite Radio, AUX)

- Press the "FM" button
- Press the "SAT" button
- Press "SEEK ►" until the source you want is displayed
- Press "TUNE ◀" to select the source

*if available



iPod

Seek ► Button

- Press to advance to the next track
- Press to advance to the next option in the browse menu

Seek ◀ Button

- Press to advance to the previous track
- Press to advance to the previous option in the browse menu

Tune ◀ Button

- Press to enter the browse menu
- Press to make a selection while in the browse menu

Tune ► Button

- Press to go back one step in the browse menu

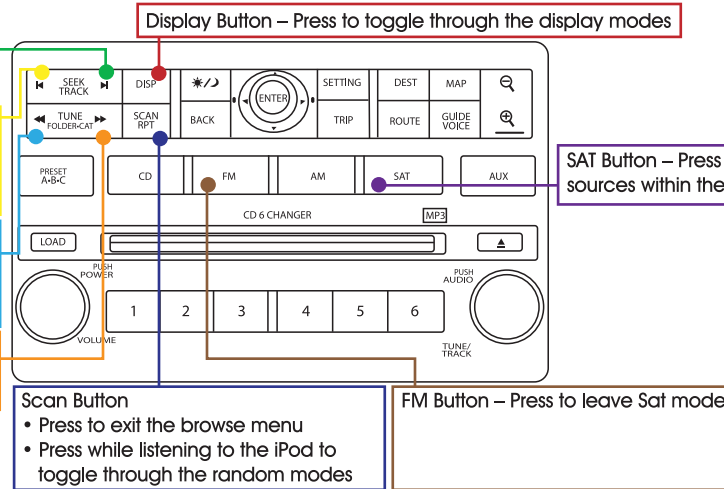

Browsing Example:

To select the song "Star-Spangled Banner" through the Artist category

1) Press the Tune ◀ button to enter into the Browse menu. The radio will display "PL:List".

2) Press the Seek ► button until radio displays "AR:Artist". Press the ◀Tune button to select. Radio will display "AR:All"

3) Press the Seek ► button until radio displays "AR:Francis Scott Key". Press the ◀Tune button to select. Radio will display "AL:All".

4) Press the Seek ► button until radio displays "AL:Patriot Hits Vol.1" Press the ◀Tune button to select. Radio will display "TR:All".

7) Press the Seek ► button until radio displays "TR:Star-Spangled Banner". Press the ◀Tune button to select. Song will begin to play and the display will show track info.

(Actual Radio Appearance may differ from representation.)

NISSAN

Maxima 2007-2008
Navigation Radios



****READ THIS FIRST****

Changing Sources (iPod, HD Radio, *Satellite Radio, AUX)

- Press the "FM" button
- Press the "SAT" button
- Press "SEEK ►" until the source you want is displayed
- Press "TUNE ◀" to select the source

*if available

Seek ► Button

- Press to seek up to the next available station
- Press to cycle forward through the preset menu

Seek ◀ Button

- Press to seek down to the next available station
- Press to cycle backwards through the preset menu

Tune ◀ Button

- Press to manually tune down
- Press to recall a preset stored into memory while in the preset menu

Tune ► Button

- Press to manually tune up
- Press to store a preset while in the preset menu

Display Button – Press to toggle through the display modes

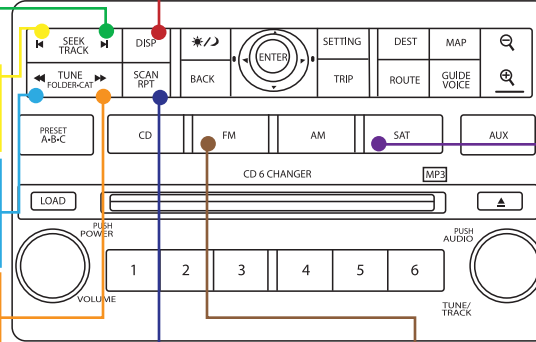

SAT Button – Press to enter SAT mode or change sources within the Media Gateway

Scan Button – Press to enter or exit the preset menu

FM Button – Press to leave Sat mode

HD RADIO EXAMPLE

To select an HD radio station.

Press the 'SEEK ►' button to get to the desired station. The Radio will auto lock on to an HD Radio Station if available example: 92.5 HD1 MHZ When locked into an HD Radio Station, press the 'SEEK ►' button to access multi-cast HD Station(s). (if available) example: 92.5 HD2 MHZ

To store a radio station into preset memory.

Press the "Scan" button to enter the Preset Menu. Press the "Seek ►" button until the location you want is displayed. Press the "Tune ►" button to store the preset. Radio will display "PR Saved"

To recall a station stored into preset memory.

Press the "Scan" button to enter the Preset Menu . Press the "Seek ►" button until the preset you want to recall is displayed. Press the "◀Tune" button to select the preset

(Actual Radio Appearance may differ from representation.)