

MMD24, MMD30 & MMDV30

dacor
The Life of the Kitchen.®

Revised
08/27/08

24", 30" Microwave In-A-Drawer™ 1/1

**PLANNING
GUIDE**

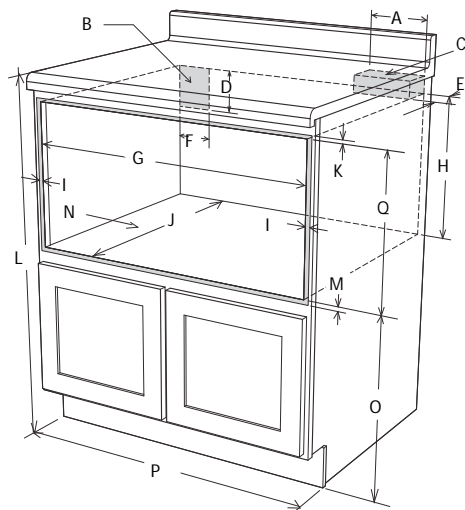

NOTES:

1. All tolerances: $+1/16"$, -0 , ($+1.6\text{mm}$, -0), unless otherwise stated.
2. Spacing between appliances and doors/drawers is minimum required to allow for ventilation and to prevent scraping. Additional space may be required for appearance.

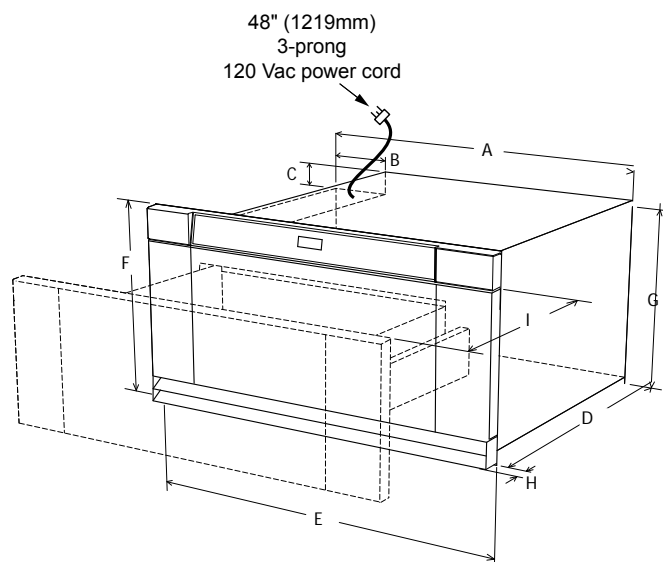

MMD24	MMD30, MMDV30
A. 6"	A. 6"
B. Electrical outlet location	B. Electrical outlet location
C. Anti-Tip block	C. Anti-Tip block
D. 5"	D. 5"
E. 3 1/2"	E. 3 1/2"
F. 4"	F. 4"
G. 22 1/4" opening	G. 28 1/2" opening
H. 14 3/16" to bottom of Anti-Tip block	H. 14 3/16" to bottom of Anti-Tip block
I. Allow 7/8" minimum overlap	I. Allow 3/4" minimum overlap
J. 23 1/2" minimum depth	J. 23 1/2" minimum depth
K. Allow 3/16" minimum overlap	K. Allow 1/4" minimum overlap
L. 36" nominal countertop height	L. 36" nominal countertop height
M. Allow 7/16" minimum overlap	M. Allow 7/16" minimum overlap
N. Floor must support 100 lbs. minimum	N. Floor must support 100 lbs. minimum
O. 19" to top of floor (recommended)	O. 19" to top of floor (recommended)
P. 24" cabinet minimum	P. 30" cabinet minimum
Q. 15 3/16" \pm 1/16" opening	Q. 15 3/16" \pm 1/16" opening

NOTE: Open Top Cabinet illustrated

CUTOUT DIMENSIONS

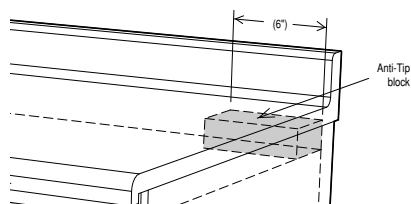

ANTI-TIP BLOCK LOCATION

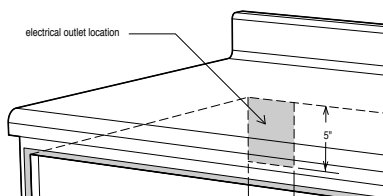

ELECTRICAL UTILITY LOCATION

MMD24	MMD30, MMDV30
A. 21 19/32"	A. 28 5/16"
B. 4 11/16"	B. 4 11/16"
C. 1 23/32"	C. 2"
D. 23 3/8"	D. 23 3/8"
E. 23 13/16"	E. 30"
F. 15 5/8"	F. 15 5/8"
G. 15 1/16"	G. 15 1/16"
H. 1" door thickness	H. 1 1/4" door thickness
I. 15" auto drawer opening	I. 15 1/4" auto drawer opening

Power cord length: 48"

OVERALL DIMENSIONS

Model No.	Dedicated Circuit Required	Total Connected Load	Approximate Shipping Weight
All Models	120 Vac, 60 Hz, 15 Amp (Breaker)	1.56 kW (13 Amp)	128 lbs.

ELECTRICAL SPECIFICATIONS

Web: <http://www.Dacor.com>
Corporate Phone: 800-793-0093

Specifications are subject to change without notice.
See installation instructions for additional details.