

## General Questions about 3D Viewing

**Question:** What Mitsubishi models are 3D Ready?

**Answer:** The following Mitsubishi DLP 1080p HDTV's are 3D Ready. The following model numbers were introduced in 2007.

WD-57833 – Diamond 57"

WD-65833 – Diamond 65"

WD-73833 – Diamond 73"

**Question:** What is the 3D Mode on Mitsubishi TV's?

**Answer:** On the 3D Ready models listed above the 3D Mode is called *FX Gaming* and is a menu setting. You will see it at the end of the AV Menu choices.

**Question:** Is the 3D mode or FX Gaming only used for 3D video gaming?

**Answer:** No, the 3D mode can be used with compatible 3D video/movie content as well as video games.

**Question:** What is compatible content?

**Answer:** 3D content must be mastered for display on DLP HDTV's. At the current time this content would be provided to the TV from a PC, however in the future there will be other sources of content.

**Question:** Beside a PC or other source device, what equipment is required to view 3D?

**Answer:** You will need 3D glasses and a matching VESA compliant sync emitter. The glasses are active LCD shutter glasses and the sync emitter is use to synchronize the glasses to the display. Most emitters use IR (infrared) light beams as synchronization signals. Some Third party vendors sell kits that include: a PC, LCD shutter glasses, sync emitter and software

**Question:** Where do I get a suitable PC or source device, content and 3D glasses systems?

**Answer:** The last section of this document will provide some information about how to convert your PC or media center or where you can get a package of equipment that include 3D glasses. Some packages include the PC and the 3D glasses. This information is current as of 11/01/07 and may change in the future, please check back for updated information.

**Question:** What connections do I need to make to my Mitsubishi DLP HDTV to use the FX Game/3D mode?

**Answer:** You will need to connect a compatible source PC to any one of the HDMI inputs on the TV.

- A.** All HDMI inputs can be compatible with the 3D mode; however no other inputs are compatible.
- B.** You will need to "name" the HDMI input either "PC" or "GAME". If you do not name the input PC or GAME, the FX GAMING selection in the menu will not be available.
- C.** If you name the input GAME, the source PC must be set to 1080p @ 60Hz. No other signals are compatible with the 3D mode.

- D.** If you name the input PC, the source PC should be set to 1920 x 1080 @ 60Hz.
- a.** You can also use 1024 x 768 @ 60 Hz, 1280 x 720 @ 60Hz 1360 x 768 @ 60Hz or 1280 x 1024 @ 60Hz *however* these other resolutions will not fill the screen.
  - b.** The TV will not accept interlaced signals on an input named PC, only progressive signals are compatible when the input is named PC.

You will also need to connect the 3D Glasses sync emitter to the back of the TV.

## Connection and Setup

1. Connect the PC or other 3D source device to one of the HDMI inputs on the TV.
  - a. If your device has an HDMI output, the audio will be included on the same cable.
  - b. If your device has a DVI output, use a *DVI to HDMI cable*.
  - c. If your device has a DVI output and you would like to use the TV speakers for audio, connect left and right audio cables to the input labeled DVI/PC Audio Input on the back of the TV.

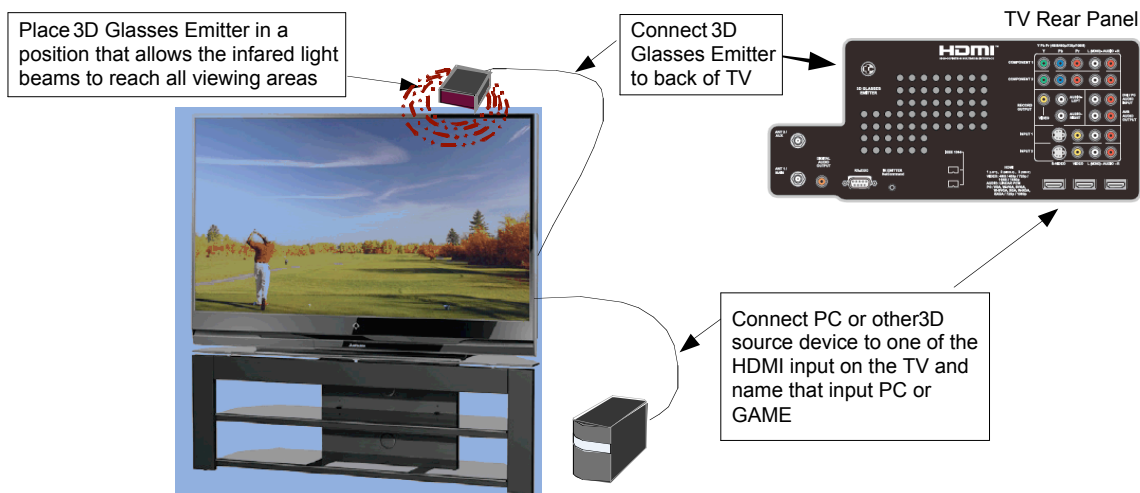

2. Connect the 3D Glasses Sync Emitter to the back of the TV using the jack labeled *3D Glasses Emitter*. If the emitter requires power, plug the power cord into the emitter and wall AC power outlet.
3. Turn on the PC or 3D source device. The Auto Input Sensing screen will display where you can name the input. For 3D, you must name the input PC or GAME.
  - a. Use the ▼▲ buttons to highlight the name and then press EXIT.

Use the arrow buttons to select either PC or GAME as a name and then press EXIT to clear the screen

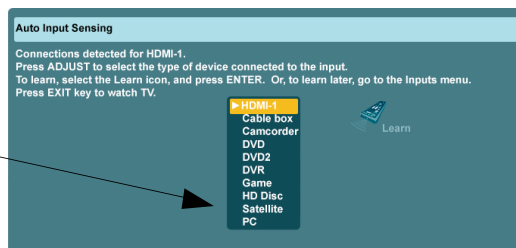

4. If the HDMI input has already been used and named something else, you can change the name in the INPUTS menu.
  - a. Press MENU on the remote control to display the TV menu.
  - b. Use the ▼ button to highlight the INPUTS icon
  - c. Use the ► button to highlight the NAME icon.
  - d. Use the ▼ and then the ► buttons to highlight the input to be renamed.
  - e. Use the ▲▼ buttons to select a new name then press EXIT to clear the screen

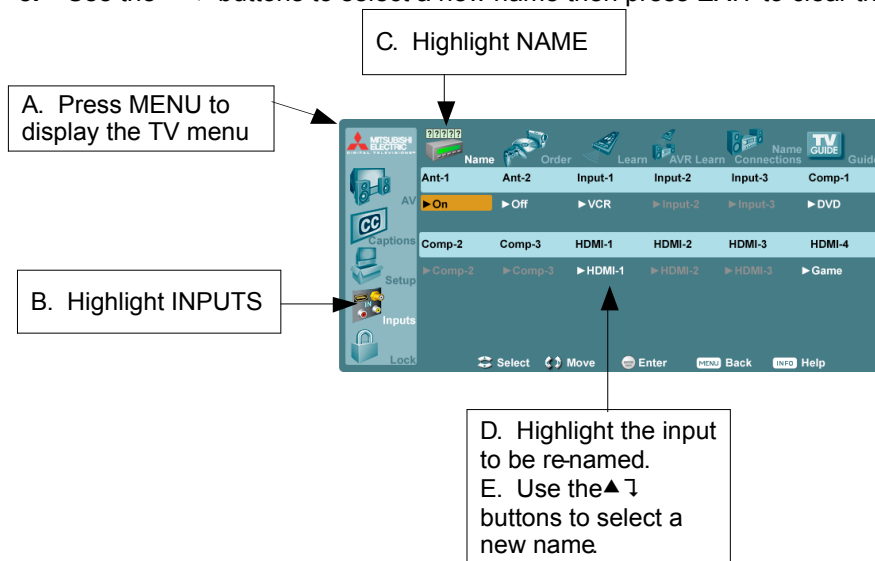

5. To turn on the FX GAMING / 3D Mode, while viewing the input for the source device:
  - a. Press MENU to on the remote control to display the TV menu.
  - b. Use the ▼ button to highlight the AV icon.
  - c. Use the ► button to highlight the FX GAMING icon.
  - d. Use the ▼ button to move to the sub-menu area.
  - e. Use the ▼ button to change the setting from OFF to ON (or reverse to turn off the FX GAMING mode) and then press EXIT to clear the screen.

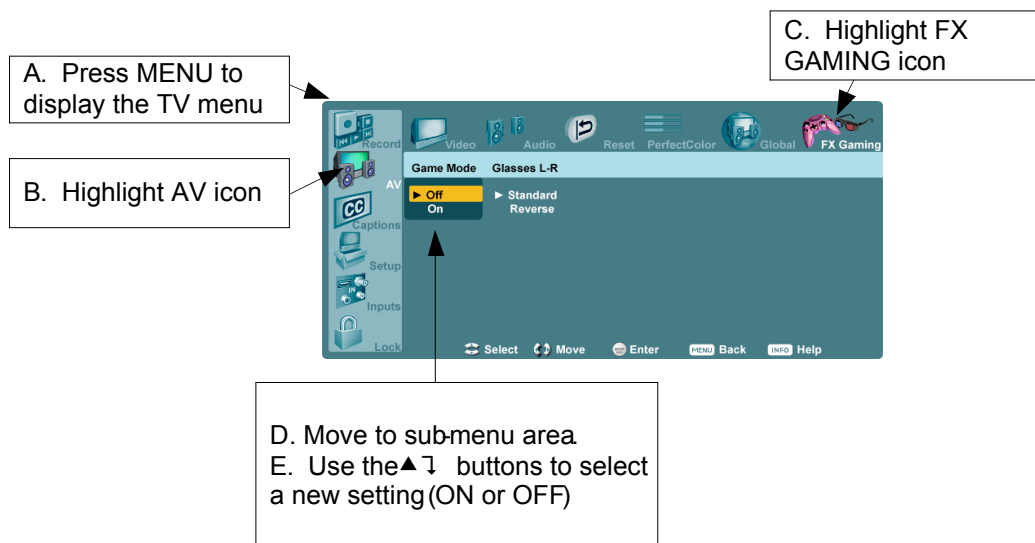

---

**Note:** If while watching the 3D images, the images do not seem correct, try changing the GLASSES L-R setting in the FX GAMING sub-menu from Standard to Reverse.

**Note:** Some 3D Glasses Emitters will interfere with the signals from the TV remote control or the remote control for other devices. If this happens, move the remote control closer to the TV, or use the front panel controls to turn off the FX GAMING mode.

## Obtaining 3D Source Devices, Glasses and Content

As of now, 3D content is still limited; however content providers such as movie/TV studios and video game publishers should release more 3D content over the next couple of years. Currently, some third party vendors sell software and hardware packages that play 3D content on all Mitsubishi Diamond DLP 1080p HDTV's. The software in these packages can also turn 2D content into 3D content. Below you will find a PC based package with web site links for more information.

### **Complete package:**

This system can be purchased online at <http://www.i-glassesstore.com/dlp3d-complete.html> . The website notes that this package is compatible with Mitsubishi Diamond 1080p DLP HDTV's (833 Series). The system is priced at \$1499 (price as of 11/01/07).

Other information concerning DLP 3D opportunities and equipment can be found on the DLP web site at [http://www.dlp.com/hdtv/3-d\\_dlp\\_hdtv.aspx](http://www.dlp.com/hdtv/3-d_dlp_hdtv.aspx)

### **Upgrade Existing PC:**

If you already have a PC or Media Center PC and you would like to upgrade it for DLP 3D use, PC requirements and links for compatible glasses can be found below.

The PC configuration or Media Center needs to have the following specification:

Processor: Intel® Core 2 Duo or Athlon™ 64 X2 Dual-Core CPU

Memory: 1 GB RAM

Graphics: NVIDIA® GeForce 6600 or ATI Radeon™ X800

Hard Drive: 100MB free disk space

OS: Windows® XP, Vista

Sound Card: DirectX 9.0c compatible sound card

DVD-ROM Drive

[InterVideo WinDVD](#) (XP & Vista) or [Intervideo XPack](#) (XP)

High Speed Internet connection

### **Purchasing Glasses Separately:**

Once the PC specification is confirmed, consumers can purchase LCD shutter glasses, emitter and software at <http://www.i-glassesstore.com/dlp3d-bundl-adv.html>

These systems come with 2-pair of glasses. Additional glasses can be purchased online at <http://www.i-glassesstore.com/dlp3d-glasses-wless.html> .

Other tested, high quality glasses can be obtained at <http://www.reald-corporate.com/scientific>  
The CrystalEyes 3 glasses and EXXR emitters are Mitsubishi Diamond DLP HDTV compatible.

**Note:** Mitsubishi uses VESA compliant jacks for Stereographic Glasses so other 3D glasses will also be compatible on Mitsubishi DLP HDTV's.

3D for TV is just beginning, new 3D sources and equipment will become available in the future, please visit the Mitsubishi web site [www.mitsubishi-tv.com](http://www.mitsubishi-tv.com) for the latest 3D updates.