

HIGH PERFORMANCE
FURNITURE FOR YOUR
HOME THEATER



7/2007

NoviaTM 8428

Assembly Instructions

Novia™ Home Theater Furniture

www.bdiusa.com
customerservice@bdiusa.com

Placement and Maintenance

Novia™ Home Theater Furniture is designed for indoor use on level floors. Clean glass with glass cleaner, and steel parts and wood veneer with a moist cloth.

Your Novia™ Home Theater Furniture is engineered for easy assembly. Carefully follow this procedure to prevent any damage.

Designed by BDI Design Studio.

'Novia' is a trademark of Becker Designed, Inc. All rights reserved. ©2007 Becker Designed, Inc.

Unpack and identify the parts listed on this page.

The assembly workspace should be a non-marring surface such as carpet. For missing hardware pieces, please contact BDI Customer Service at: customerservice@bdiusa.com For all other concerns please contact your local BDI Retailer.

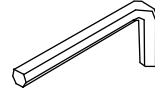

A - Allen Wrench x 1

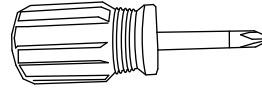

B - Phillips Screwdriver x 1

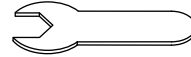

C - Leveler Wrench x 1



D - Knob Screw x 3

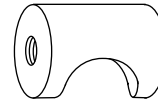

E - Knob x 3

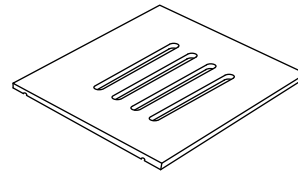

F - Adjustable Shelf x 2

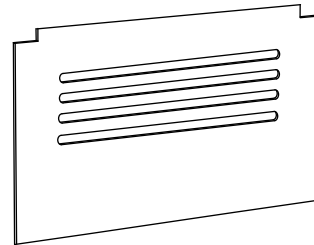

G - Back Panel x 2

Step 1

Install glass panel (H) on top of assembled cabinet (I).

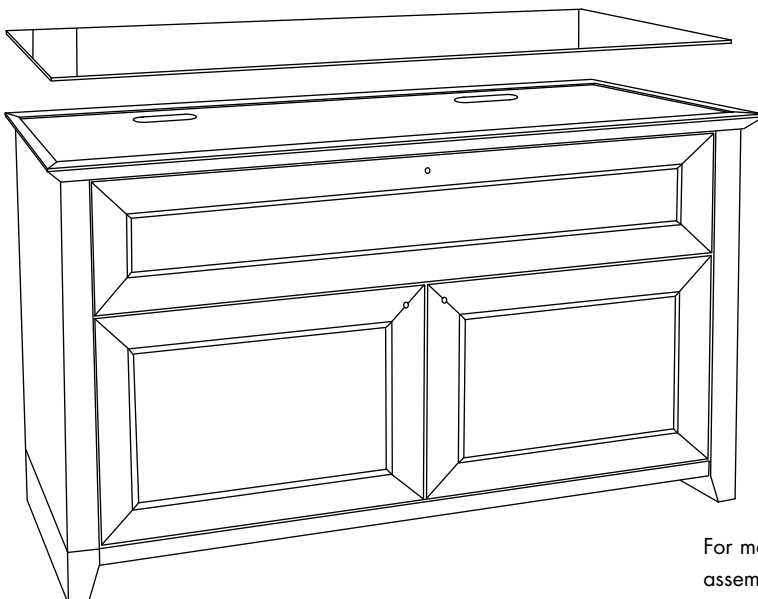
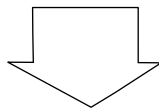

H - Glass Panel x 1

I - Assembled Cabinet x 1

For more information about the adjustable levelers and troubleshooting assembly, be sure to check out "Fine tuning your new BDI Novia Home Theater Furniture" at the end of these instructions.

Step 2

Install knob (E) to the front side of door and drawer faces using knob screw (D) and Phillips screwdriver (B).

The shelf pins located inside the left and right cabinet space may be repositioned, allowing you to raise or lower the shelf to the desired level.

Install adjustable shelf (F)

inside the left and right cabinet area.

Note: To place the adjustable shelf inside the cabinet, the shelf must be tilted sideways to clear the door.

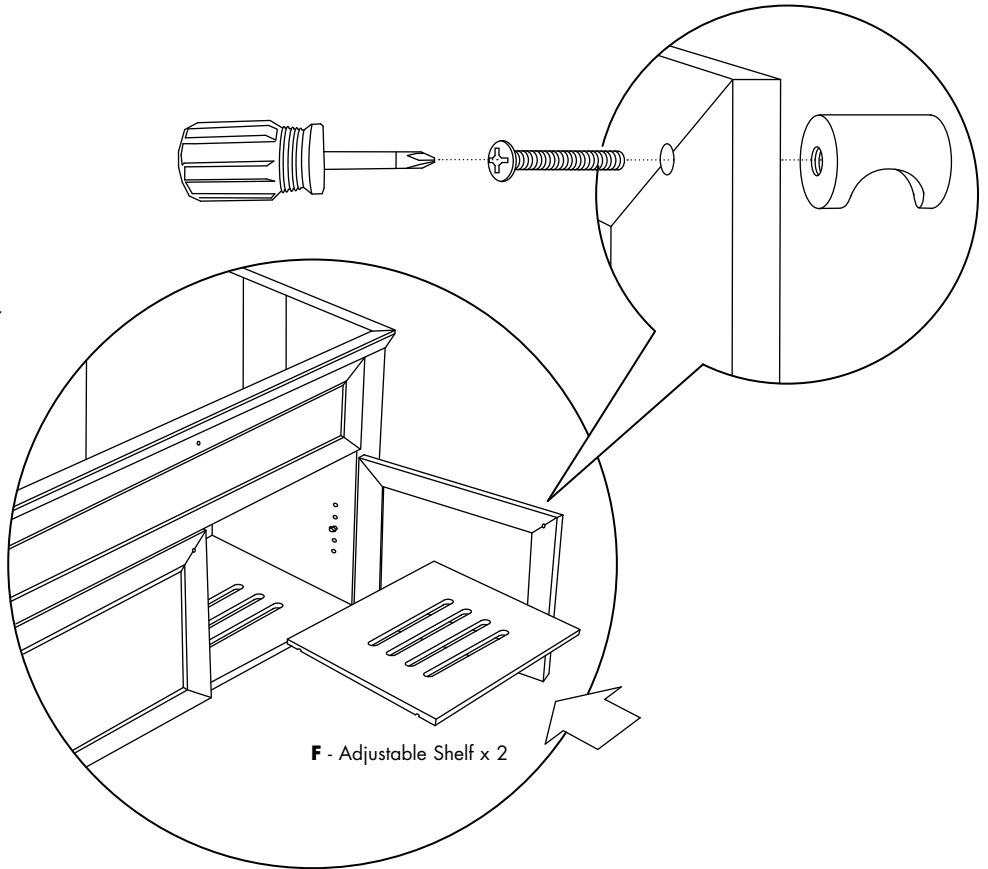

Step 3

Install back panel (G) to the rear side of cabinet. **Velcro straps** are included as wire management for your convenience.

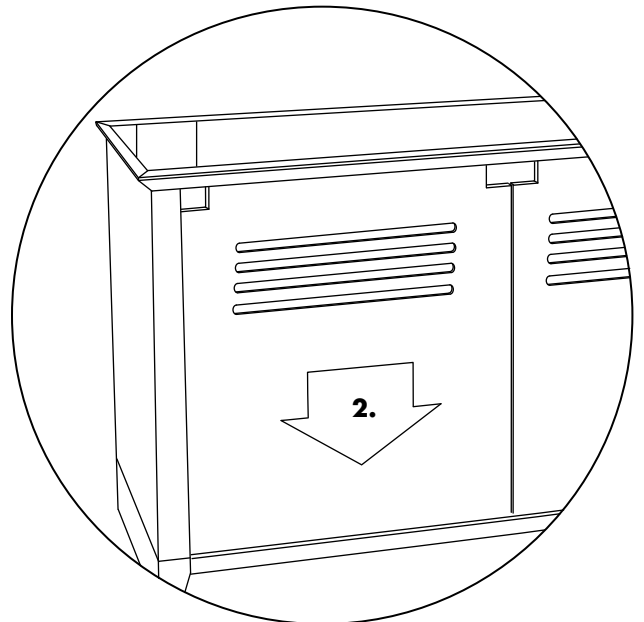
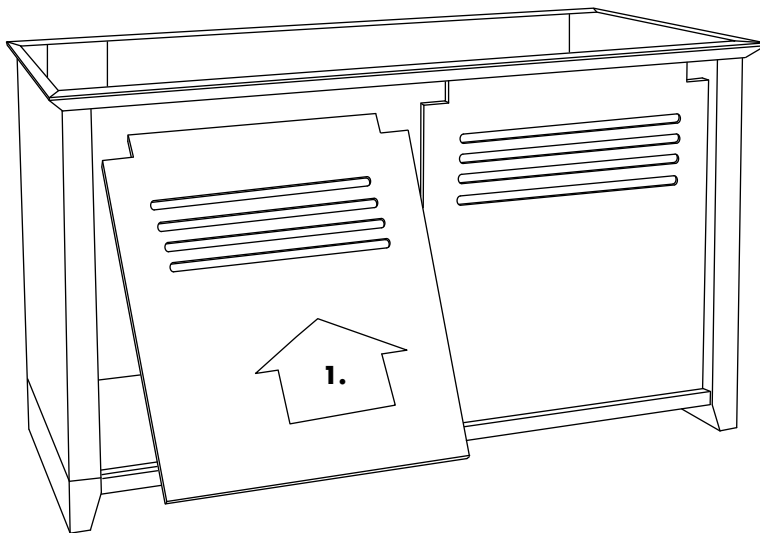

Option A

The flip-down door compartment may be used to house a center channel speaker (up to 43" width x 9" depth x 8.5" height).

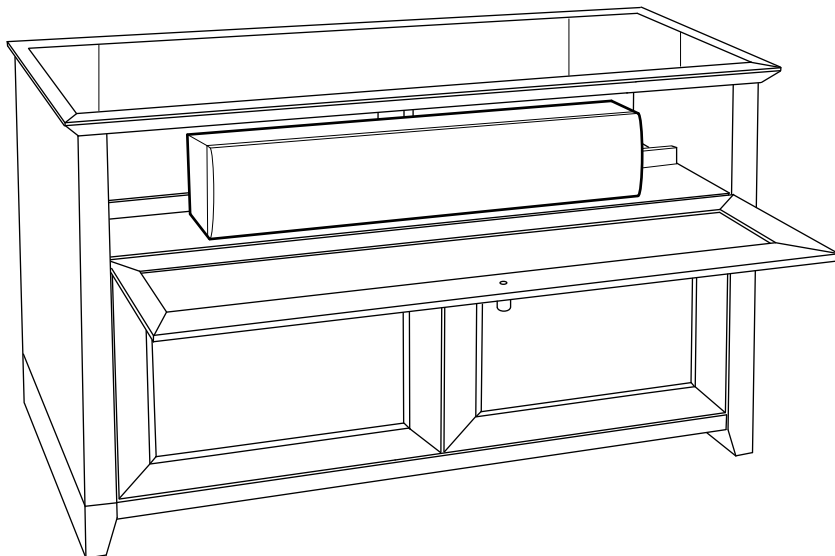

Option B

In conjunction with a center channel speaker, or component, this area may be used to store DVD's, VHS cassettes, and CD's.

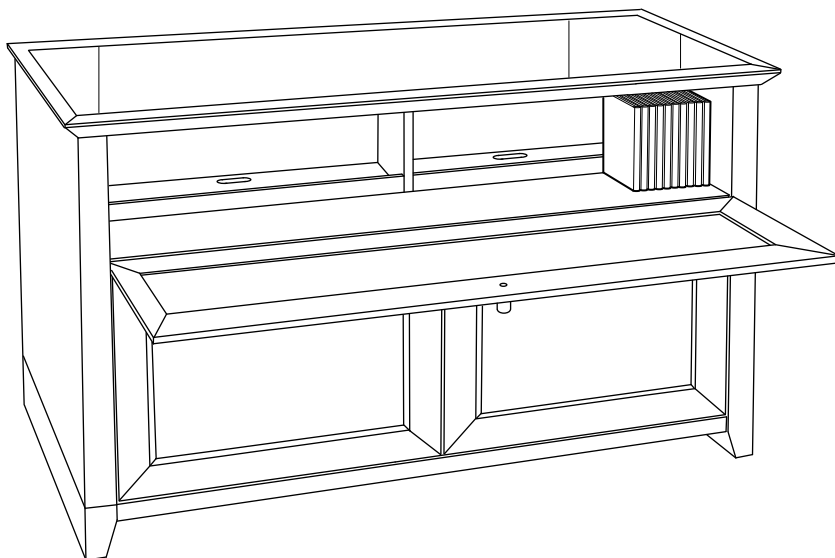

Option C

In order to use this space for additional component storage, remove wood strip from either side of the center divider panel.

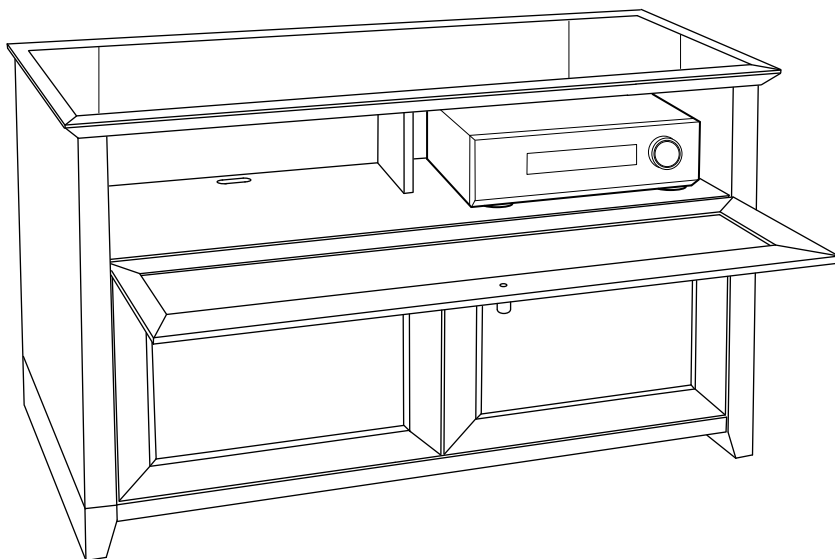
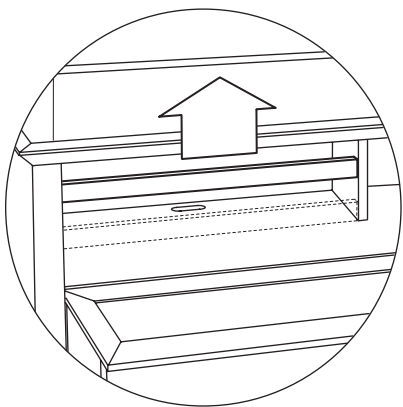

Gaming Console Compartment

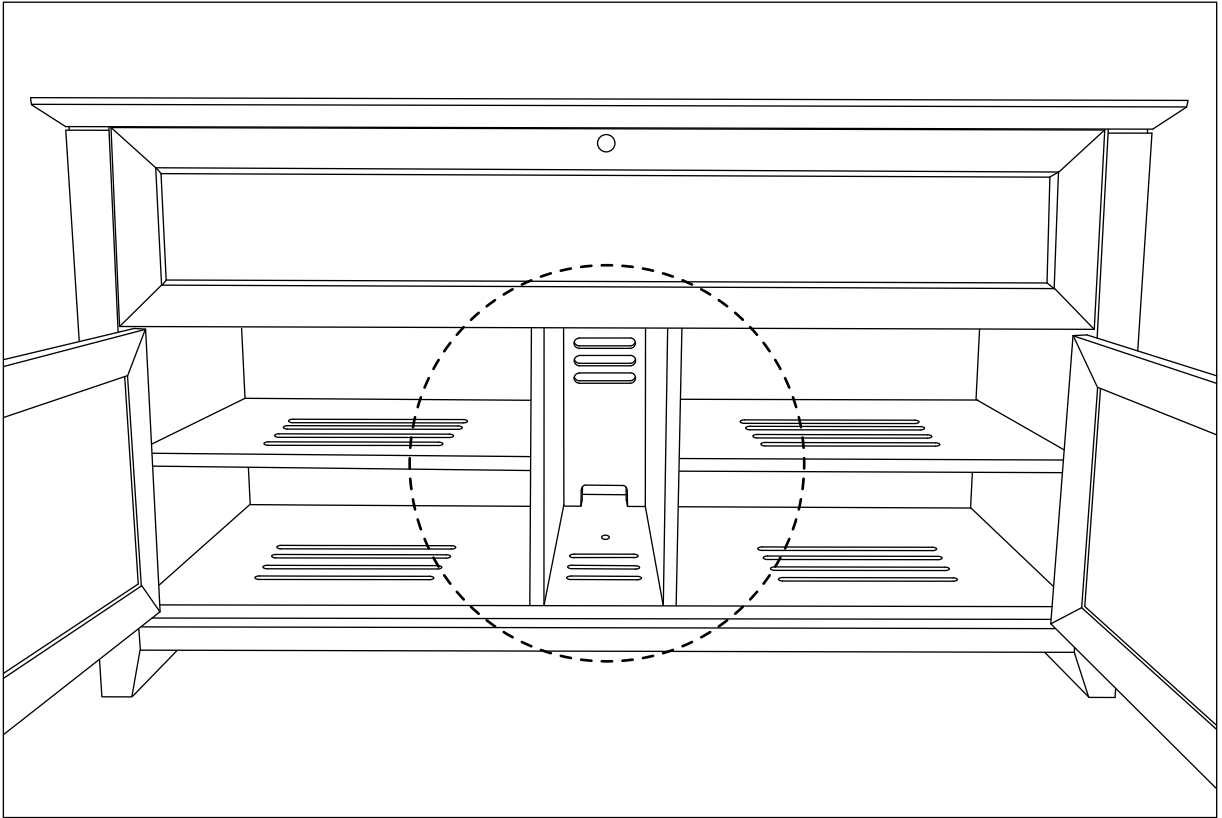

The central area is designed to accommodate vertical format video game consoles. This area may also be used to store media (DVD's, CD's, etc.).

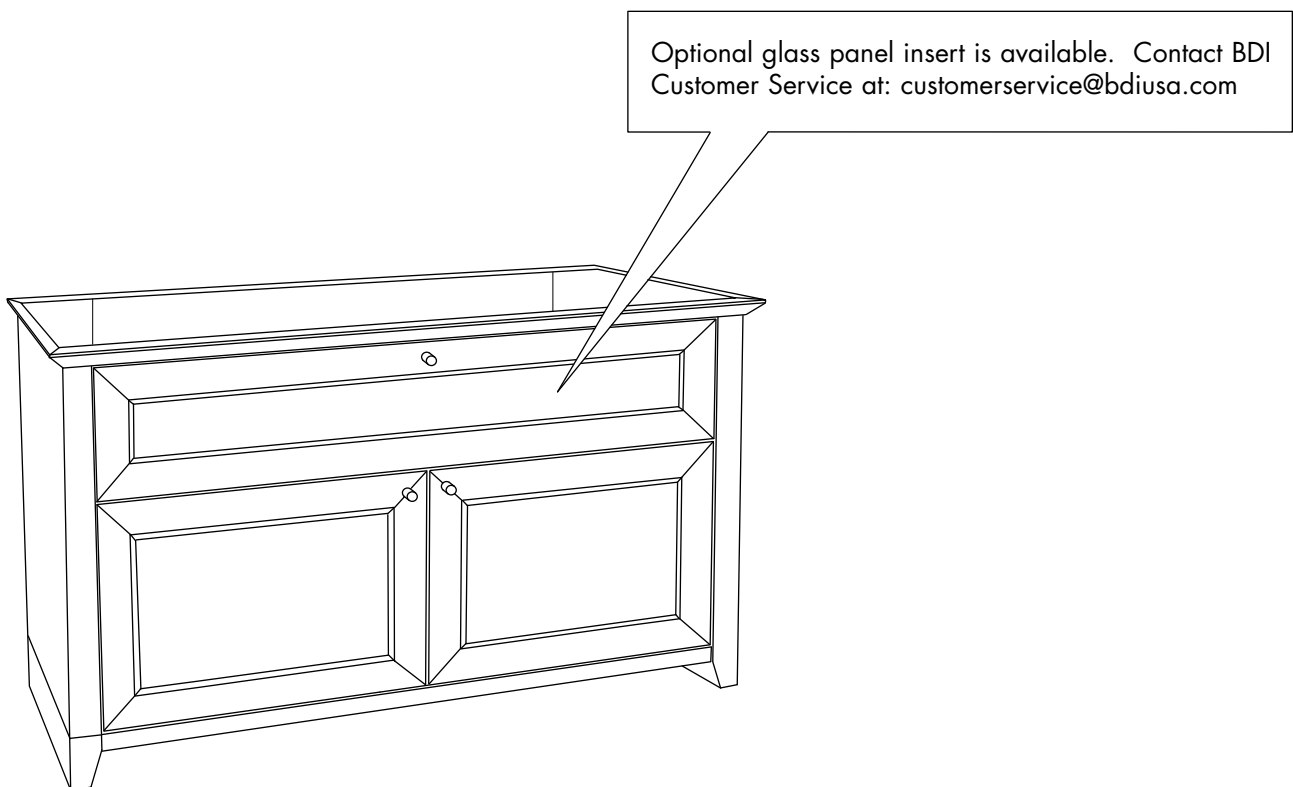

Step 4 Leveling: There are adjustable levelers on the bottom of the cabinet, which may be adjusted depending on your leveling situation.

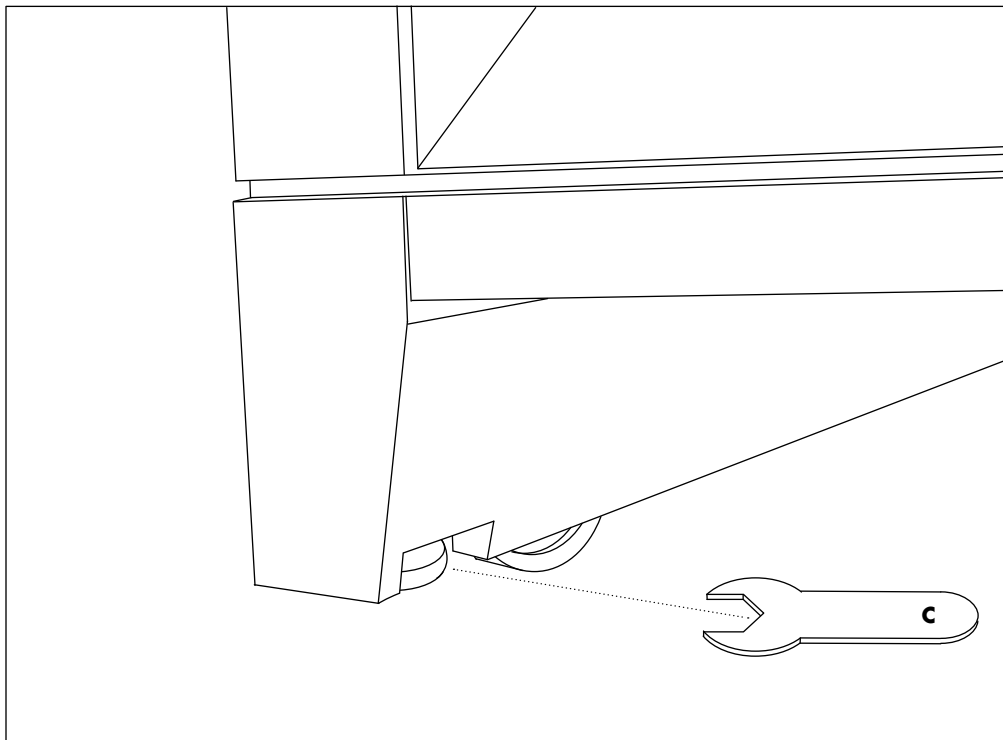

Four of the five leveler glides are accessible near the bottom of the side panels using the **leveler wrench (C)**.

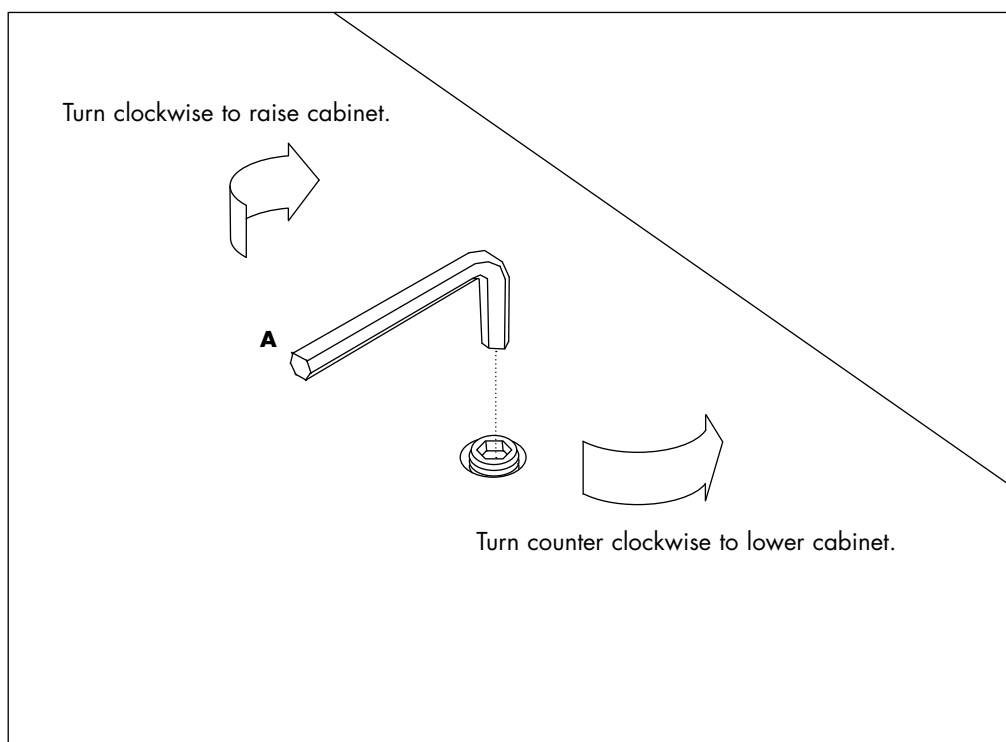

There is an adjustable leveler glide located on the bottom shelf of the gaming console compartment. Use **allen wrench (A)** to adjust.

Fine tuning your new BDI Nova Home Theater Furniture

These steps are to be followed after you have unpackaged and completed the simple assembly instructions for your Nova AV stand. Due to jostling in freight or perhaps an uneven floor, the doors and drawers on your Nova stand may not appear to be in perfect alignment. Making a few minor adjustments can rectify this situation. Be aware that depending on your situation, patience and a bit of trial and error are required. The high-quality European hinge hardware is infinitely adjustable, but changing one element can cause the need for further adjustments. Through a little adjustment, you can modify the orientation of the cabinet doors to make sure that they are sitting perfectly on your Nova unit.

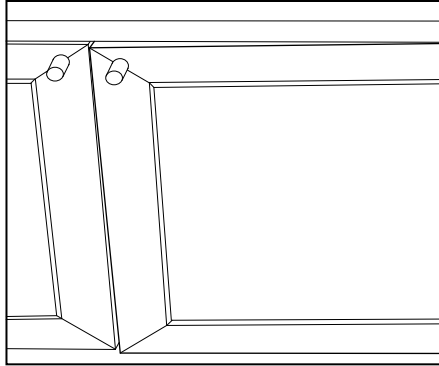

INCORRECT! Door is out of alignment with the rest of the unit.

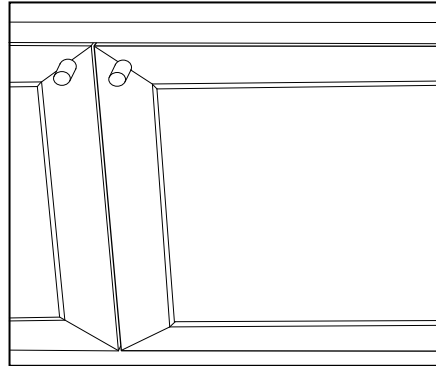

CORRECT! Door is sitting squarely and evenly spaced on tops and sides.

STEP 1 - Level your Nova unit (as shown on previous page)

The levelers which are located within the center cabinet area may be adjusted from inside the cabinet to compensate for an uneven floor or to secure your cabinet so that it does not roll. If you are having difficulty with misaligned doors, it is recommended that you first retract all levelers and make sure that the unit is resting on it's wheels. If the center section of the cabinet appears to be sagging, raise the levelers on both of the center legs to compensate for this.

STEP 2 - Adjust Door Hinges (if needed)

The doors on your Nova stand should be perfectly spaced and the doors should open and close freely without rubbing against the door frame. Adjustments may be made to the Nova door hinges with the use of the Phillips head screwdriver. The hinge hardware has three adjustment screws.

- By adjusting Screw 1, the door will move left and right within the frame. For best results, make minor adjustments to top and bottom hinge for best results.
- If adjusting Screw 1 has not achieved the desired result, you can adjust Screw 2 and the door will move up and down within the frame (the top and bottom hinges need to be adjusted the same amount).
- Adjusting Screw 3 will cause the entire door to move in and out, opening and closing the gap between the door frame and cabinet. This screw rarely needs adjustment.

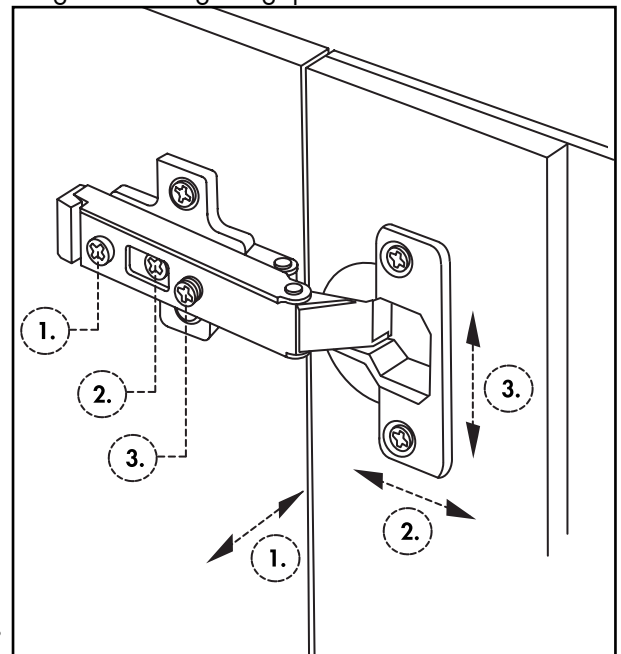

Step 2: Adjust Door Hinges.