

# AT-LP7X

**Quick Start Guide**

Belt-Drive Turntable

**Guide de démarrage rapide**

Tourne-disque à entraînement par courroie

**Kurzanleitung**

Riemenbetriebener Plattenspieler

**Guida rapida**

Giradischi

**Guía de inicio rápido**

Giradiscos de tracción por correa

**Guia de início rápido**

Toca-discos acionado por correia

**Краткое руководство по установке**

Проигрыватель с ременным приводом

**快速启动指南**

皮带传动唱盘机

**快速入門指南**

皮带驅動式黑膠唱盤

**간편 사용 설명서**

벨트 드라이브 턴테이블

**User Manual (Online Manual)**  
<https://www.audio-technica.co.jp/document/AT-LP7X/Default.html>



Audio-Technica Corporation  
 2-46-1 Nishi-naruse, Machida, Tokyo 194-8666, Japan  
[www.audio-technica.com](http://www.audio-technica.com)  
 ©2025 Audio-Technica Corporation  
 Global Support Contact: [www.at-globalsupport.com](http://www.at-globalsupport.com)

162307950-01-01 ver.1 2025.07.01

## Contents

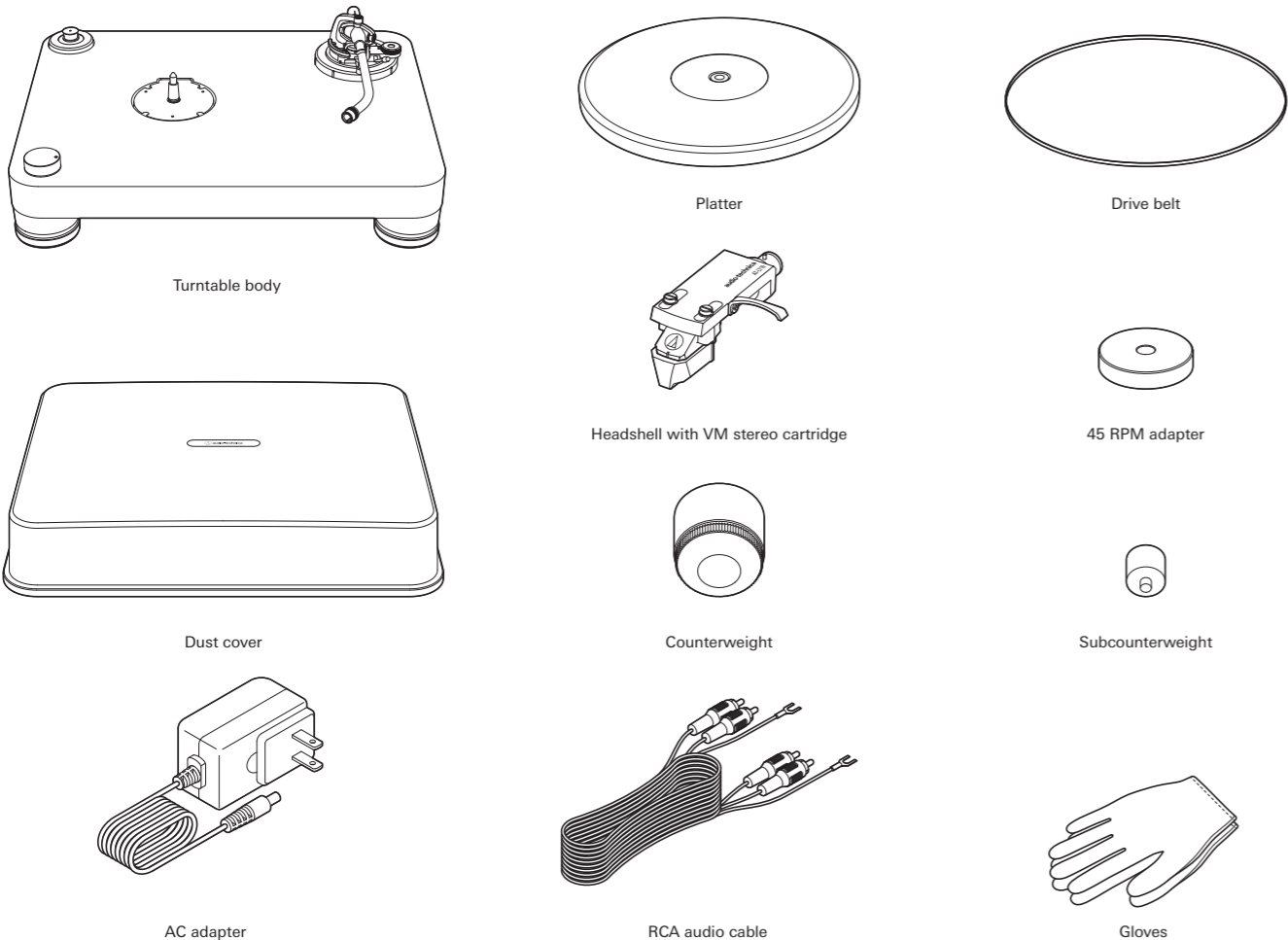

## Preparation

Use the included gloves to avoid fingerprints on the product.

**1 Attach the drive belt to the side of the platter.**

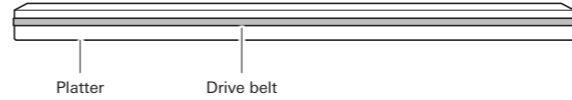

**2 Set the platter.**

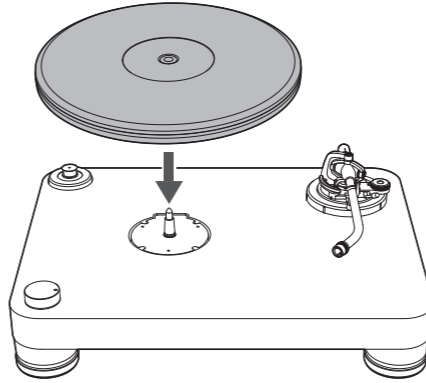

**3 Attach the drive belt to the motor pulley.**

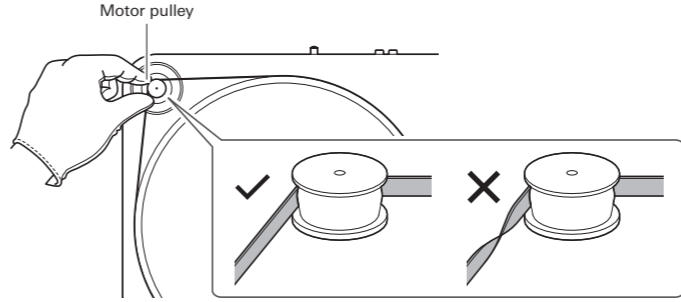

**4 Level the turntable.**

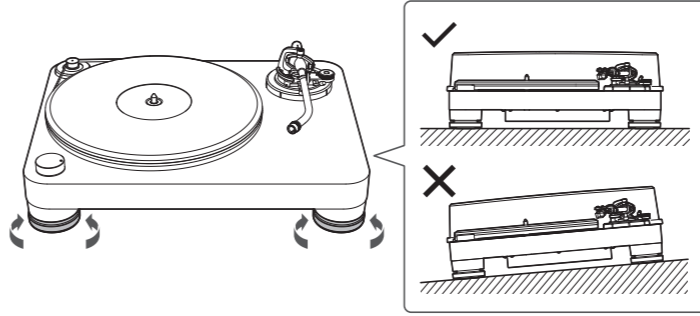

**5 Attach the headshell to the tonearm, and remove the cartridge's protector.**

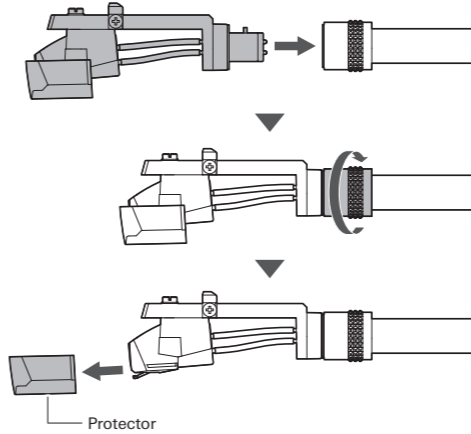

**6 Attach the counterweight to the back of the tonearm, and slowly turn it counterclockwise (to the left).**

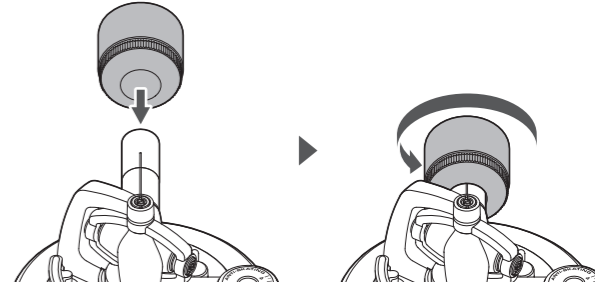

**7 Unlatch the clamp.**

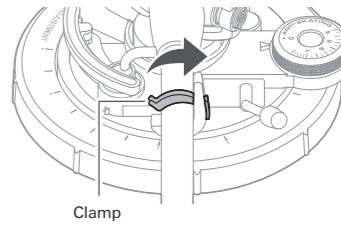

**8 Turn the counterweight to adjust the tonearm's balance so that the tonearm is level when you release the headshell.**

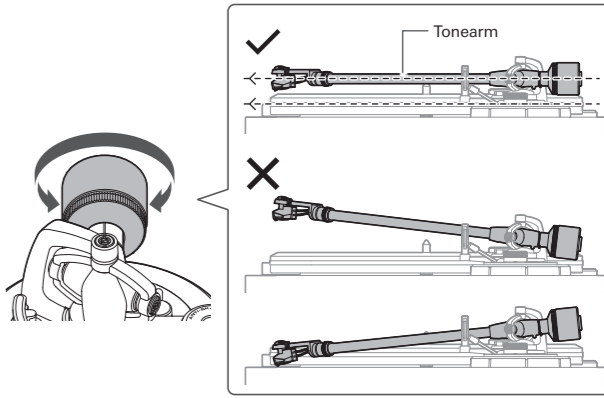

! • Make sure that the stylus tip does not touch the platter or turntable body.

**9 Set the tracking force gauge ring to the "0" position. After that, turn the counterweight and the tracking force gauge ring together counterclockwise (to the left) to the "2" position.**

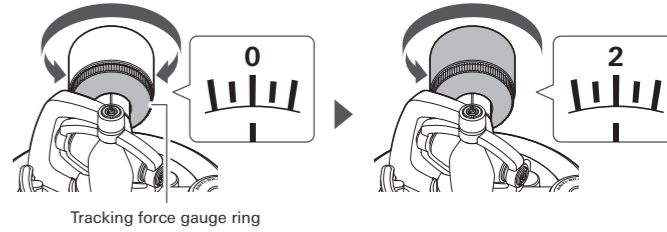

**10** Set the anti-skate control dial to "2", the same value as the tracking force value. After adjustment is complete, fix the tonearm with the clamp.

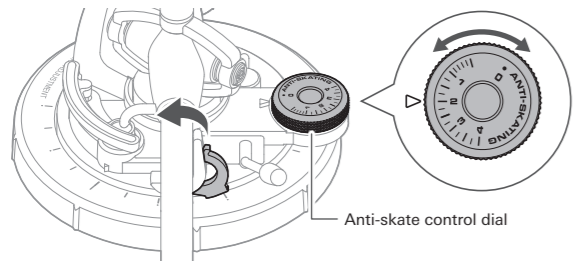

Anti-skate control dial

## Connection

This product has a built-in phono equalizer function. You can use the product, even if you do not have a phono amplifier or connectable equipment with a built-in phono amplifier, by connecting an active speaker, etc. Use the pre-amplifier selector switch to set the output.

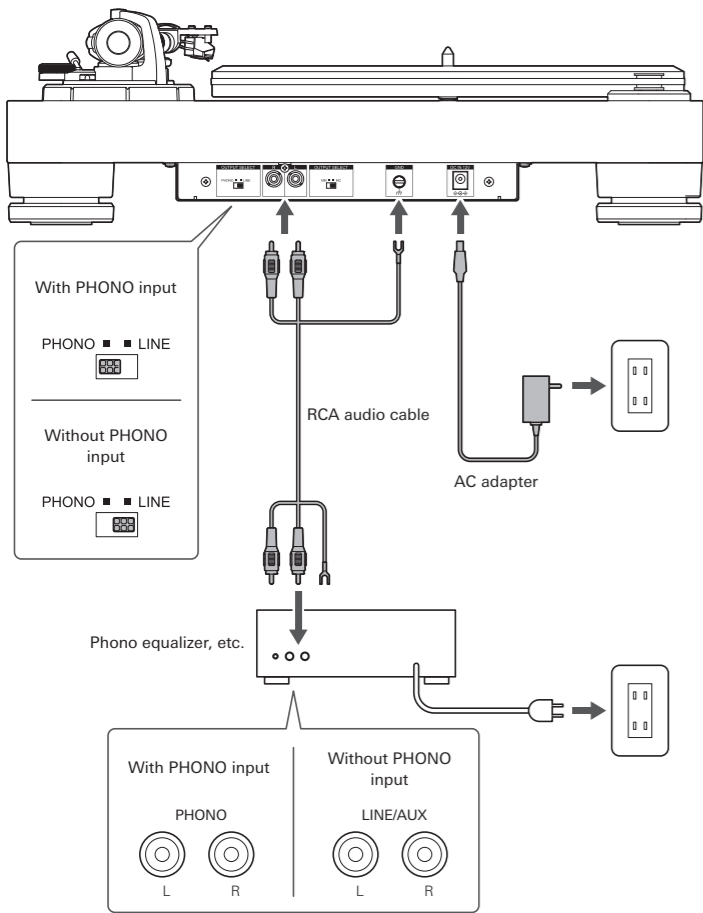

## Play

**1** Remove the cartridge's protector.

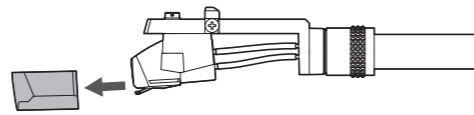

**2** Unlatch the clamp.

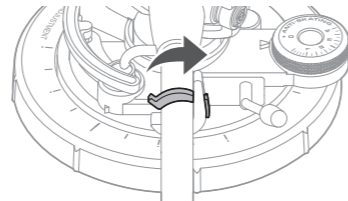

**3** Place the record on the platter and use the control knob to select the speed. The platter will begin to spin.

At 33-1/3 RPM

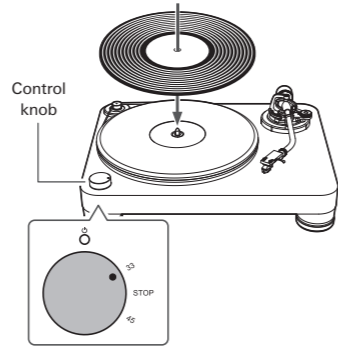

At 45 RPM

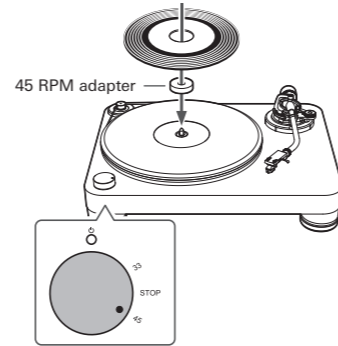

**4** Raise the tonearm by lifting the tonearm lift control lever to the UP position.

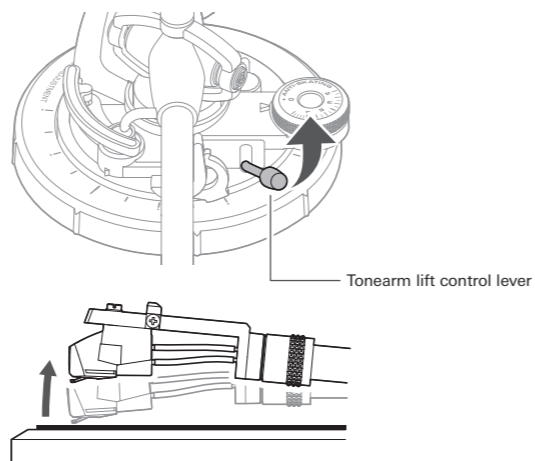

**5** Position the tonearm over the desired location (groove) on the record.

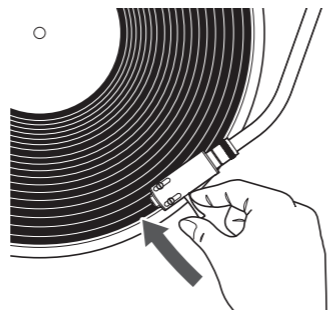

**6** Lower the tonearm by moving the tonearm lift control lever to the DOWN position.

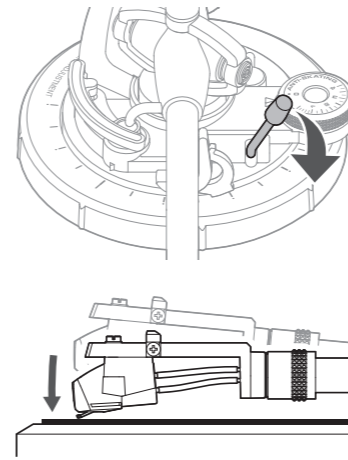

## Stop

**1** Lower the volume of the connected device (amplifier, etc.).

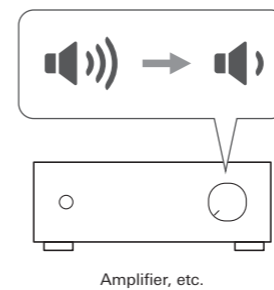

**2** Raise the tonearm by lifting the tonearm lift control lever to the UP position.

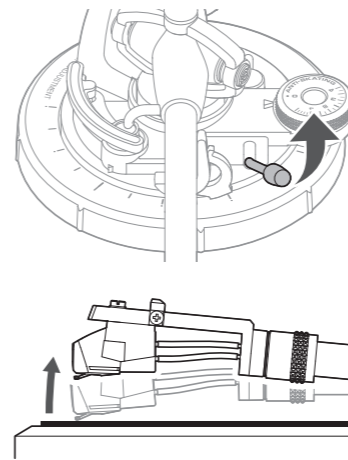

**3** Return the tonearm to the tonearm rest.

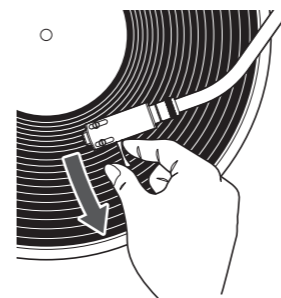

**4** Lower the tonearm by moving the tonearm lift control lever to the DOWN position and fix it with the clamp.

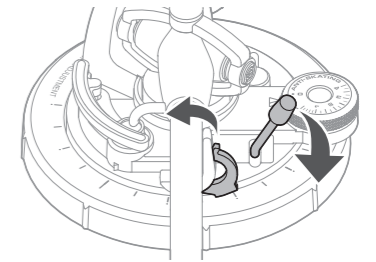

**5** Attach the cartridge's protector.

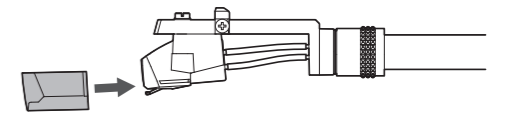

**6** Turn the control knob to the "STOP" position.

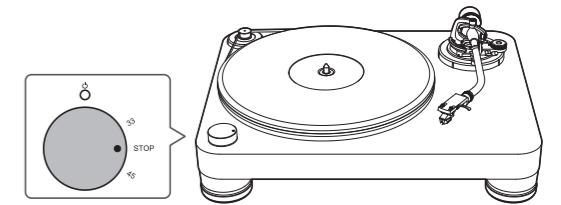

## Cleaning

After unplugging the AC adapter from the outlet, clean the turntable as necessary. For details about turntable and cartridge care accessories, visit <https://www.audio-technica.com>.

## Stylus

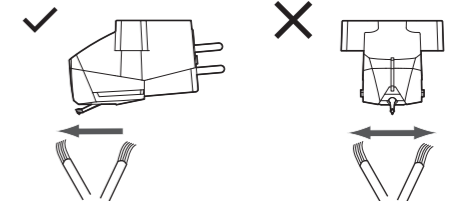

## Record

