

HOVERAir

X1 PRO|PROMAX

Quick Start Guide

ZEROZERO
R O B O T I C S



PA46H014

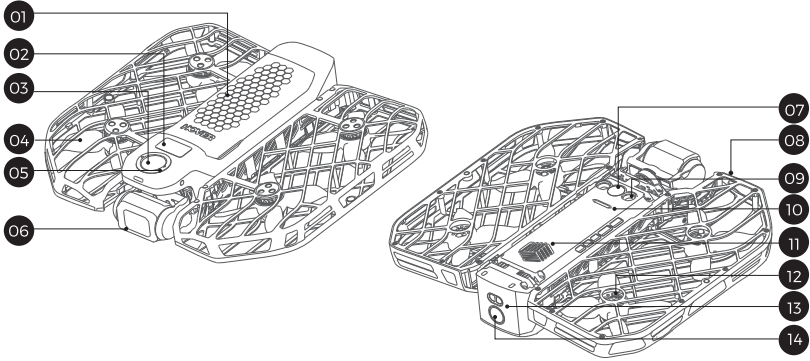

01 Battery

02 Display Screen

03 Power Button

04 Propeller

05 Select Button

06 Gimbal and Camera

07 VIO Sensor

08 Prop guard

09 Bottom TOF Sensor

10 Speaker

11 Heat Vent

12 Motor

13 Rear TOF Sensor

14 Rear Obstacle Sensor

Step 1 Charge the battery

- Please charge the battery first to activate it.



Take out the HOVERAir
X1 PRO/PROMAX



Fold the HOVERAir
X1 PRO/PROMAX

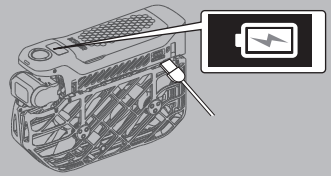

Charge to activate

The screen displays a charging animation indicating it is charging.

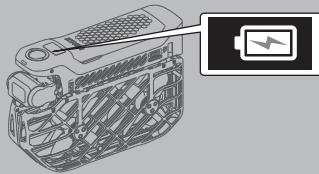

If the screen shows 100% battery or is completely off, the device is fully charged.

Step 2 Download the App

- Scan the QR code to download and install the Hover X1 App to activate the device.



iOS / Android

Step 3 Power on/off

- Press and hold the power button.

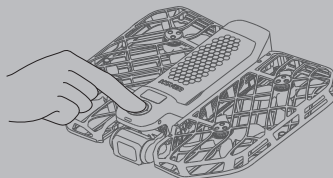

Press and hold the power button for about 2 seconds to turn on the screen. Press and hold the power button to power off.

Step 4 Connect the App

- HOVERAir X1 PRO/PROMAX connects to the app via Bluetooth. Please follow these steps.

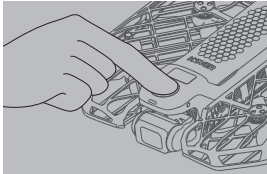

Turn on the HOVERAir X1 PRO/PROMAX.

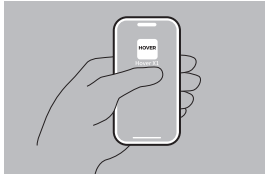

Open the Hover X1 App.



Tap to enter the 'Hover' page, follow the prompts to enable Bluetooth. Tap 'Hover' to search for nearby HOVERAir devices, then select to connect.

Note: Press and hold both select buttons simultaneously until the status light turns blue. This indicates the device has entered Bluetooth pairing mode and can be connected to your phone.

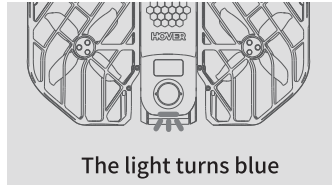
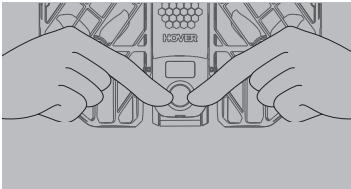

The light turns blue

Step 5 Launch the HOVERAir X1 PRO/PROMAX

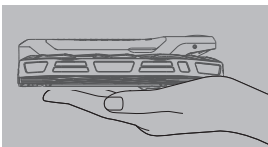

Unfold the HOVERAir X1 PRO/PROMAX as shown in the illustration and hold it horizontally.

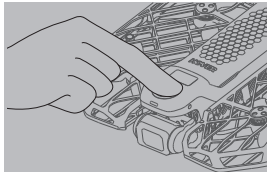

Press the power button.

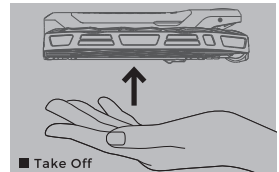

■ Take Off

Release the device when the propellers start spinning rapidly.

Step 6

Land/retrieve the HOVERAir X1 PRO/PROMAX

Intelligent Flight Modes

- After completing the intelligent flight modes, the HOVERAir X1 PRO/PROMAX will automatically return to the area near the takeoff point. When the drone approaches the takeoff location, place your hand about 20 cm directly beneath it. The device will then land on your palm, and the propellers will stop rotating.

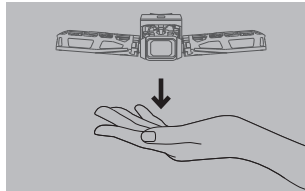

place your hand approximately 20cm directly beneath HOVERAir X1 PRO/PROMAX.

- In an emergency, grab the HOVERAir X1 PRO/PROMAX and briefly press the power button, or rotate it 180 degrees. The propellers will stop spinning immediately.



Press the power button briefly.

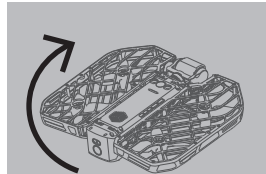

Rotate the aircraft 180 degrees to stop the propellers from spinning.

Manual control

- In manual control mode, pilot the HOVERAir X1 PRO/PROMAX to a suitable location and land it manually. Alternatively, use the one-click return function to bring the HOVERAir X1 PRO/PROMAX back near the takeoff point.

Notice: Do not insert fingers or other objects into the prop guard. For additional safety precautions, please refer to the disclaimer and safety manual on our official website (<https://hoverair.com/pages/x1-pro-and-promax-support>).

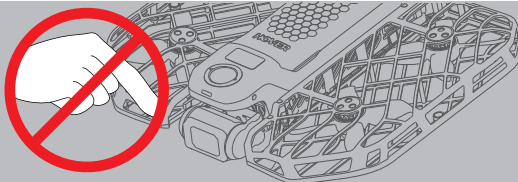

Step 7 Switch Modes and Set Parameters

Introduction to Screen Functions

■ OmniTerrain



Water surface



Large-area
monochromatic
ground surface



Rice fields,
flower meadows



Low-light
environments

NOTE: When the 'OmniTerrain icon' is illuminated, the flying camera can capture a broader range of scenes, including water surfaces, expansive monochromatic landscapes, swaying rice fields, flower meadows, and low-light environments. It is recommended not to fly in these scenes when the icon is not illuminated.

■ Switch the Intelligent Flight Mode

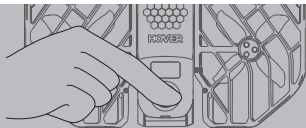

Flight Mode



Switch flight mode by short pressing the select button.

■ Setting parameters

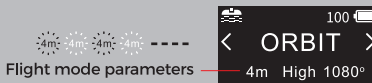
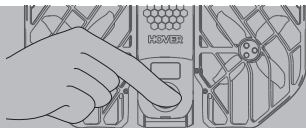

Press and hold the switch button to enter the flight path parameter settings. The parameters will start flashing, indicating that they can be adjusted. Use short presses of the switch button to cycle through the flashing flight path parameters.

■ Setting parameters

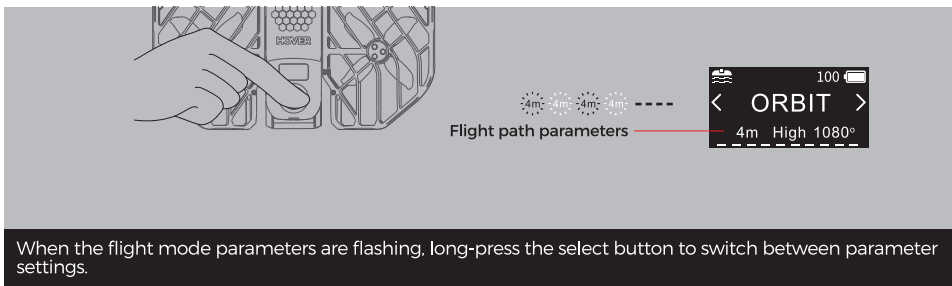

- Both mode switching and parameter settings can be done through the App.

Step 8 Video and photo downloads

- After connecting via Bluetooth to the HOVERAir X1 PRO/PROMAX, you can view low-resolution thumbnails of newly captured footage on the 'Hover' page in the app. Select your preferred works for downloading.
- After downloading, you can view the downloaded content in 'Home > Moments' or in your phone's local gallery.

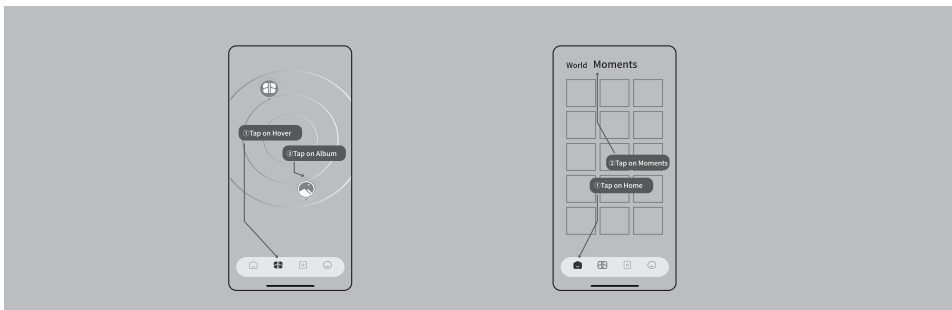

Note: To download content, please connect to the Wi-Fi of the Hover flying camera and follow the prompts until the connection is complete.

Flight restrictions

1. You should use this product in accordance with local laws and regulations for safety. Ensure that both the firmware of the flying camera and the app are updated to the latest versions.
2. Flight restricted areas include but are not limited to major airports worldwide, major cities/regions, event venues, etc. Before operating this product, please consult and comply with all local laws and regulations.

Product Specifications

Product Name: HOVERAir X1 PRO/HOVERAir X1 PROMAX
Model: ZZ-H-1-003-IL / ZZ-H-1-004-IL
MTOM (Maximum Take-Off Mass): 192g
(including propellers and Li-ion battery).
Unfolded Dimensions: 173mm x 149mm x 39mm
Folded Dimensions: 105mm x 149mm x 34mm
Maximum Ascent Speed: 3m/s
Maximum Descent Speed: 3m/s
Maximum Horizontal Flight Speed: 11m/s
Maximum Flight Altitude: 2000m
Maximum Flight Time: 16 min
Maximum Hover Time: 15 min
Maximum Wind Resistance: 10.7 m/s (Level 5 wind)
Maximum propeller speed: 35000rpm
Operating Temperature: -5°C to 40°C (23°F to 104°F)
Supported Connector Type: USB-C
Supported Chargers: HOVER 30W Charger, HOVER 65W Charger, or other chargers that support USB PD fast charging protocol.

Li-ion Battery
Rated Capacity: 1920mAh
Energy: 14.17Wh
Nominal Voltage: 7.38V
Max Charge Voltage: 8.5V
WIFI
Protocol: 802.11 a/b/g/n/ac/ax
Wi-Fi Frequency Bands for Connecting the App to the Flying Camera:
2.4GHz - 2.4835GHz
5.725GHz - 5.850GHz
Frequency range: 2.4GHz, 5.8GHz
Transmitting power: 2.4-100mW EIRP , 5.8-25mW EIRP
Bandwidth: 40MHz, 80MHz
Modulation: DSSS, OFDM

*In regions where the 5.8GHz frequency band is restricted by law (such as Japan), the phone will only use the 2.4GHz frequency band to connect to the flying camera.

*If the phone does not support the 5.8GHz frequency band, it will automatically use the 2.4GHz frequency band to connect to the flying camera.

Supported control methods: App control, Beacon control.

HOVER X1 app supports Android 7.0 and above, and iOS 12.1 and above.

Supported Automatic Flight Modes

Hover	The flying camera will hover in place. The camera will rotate to follow the subject, keeping them in the frame at all times.
Zoom Out	The flying camera intelligently locks onto the subject and then flies upward and away, capturing expanding views from a distance.
Orbit	The camera continuously follows the subject while circling around them for dynamic shots.
Follow	The camera locks onto the subject and follows their movement.
Bird's Eye	The flying camera will ascend to a higher altitude and capture wide landscapes from a top-down, classic aerial perspective.
Side Track	The camera locks onto the subject and maintains a position beside them while following their movement.
Dolly Track	The camera locks onto the subject and stays in front of them, following their movement.
Ski Mode	Optimized for ski scenes, the flying camera locks onto the subject and tracks their movement.

Note: In all follow modes, the maximum speed of the flying camera is 11 m/s.

List of Items

Items	Model Number	Dimensions	Weight
Propellers	H141_BLACK_CCW / H141_BLACK_CW	60mm*60mm*8.8mm	0.86g(each piece)
Li-ion Battery	ZZ-H-3-003/004/004T	86.7mm*34mm*18.8mm	63.6g
*ND Filter	ZZ-H-9-004	24.8mm*17.1mm*3.5mm	0.61g(each piece)

Users are prohibited from carrying accessories other than List of items or official recommendations.

