



X10 (NAB) Instructions for Use



For your safety: read and understand manual before use.
At least one copy of this manual should be kept in a location available at all times
to maintenance and management staff.

en

es

fr

Your X10





1	IMPORTANT SAFEGUARDS	4
2	Control elements	8
3	Preparing and using for the first time	10
	Setting up the machine	10
	Filling the bean container	10
	Determining the water hardness	10
	First-time use	11
	Managing your X10 – the JURA Cockpit	12
	Connecting milk	13
4	Preparation	13
	Preparation with preselection (Specialty Selection)	14
	Espresso and coffee	14
	Cold Brew	15
	Latte macchiato, cappuccino and other specialty coffees with milk	15
	Americano and lungo	16
	Hot water	16
	Adjusting the grinder	16
	Adjusting the product settings	16
5	Daily operation	17
	Switching the machine on and off	17
	Filling the water tank	17
	Maintenance actions	18
6	Machine settings	19
7	Maintenance	20
	Rinsing the machine	20
	Automatic milk system rinsing	21
	Inserting/changing the filter	21
	Cleaning the milk system	21
	Dismantling and rinsing the dual spout	22
	Cleaning the machine	24
	Descaling the machine	25
	Descaling the water tank	27
	Cleaning the bean container	27

8	Display messages	28
9	Troubleshooting	29
10	Transport and environmentally friendly disposal	30
	Transport / Emptying the system	30
	Disposal	30
11	Technical data	31
12	Index	32
13	JURA contact details / Legal information	34

1 IMPORTANT SAFEGUARDS

Comply with the instructions for use

Failure to observe the instructions for use may result in serious injuries or damage to property. Safety information is therefore indicated as follows:

	This is the safety alert symbol. It is used to alert you to potential personal injury hazards. Obey all safety messages that follow this symbol to avoid possible injury or death.
	DANGER indicates a hazardous situation which, if not avoided, will result in death or serious injury.
	WARNING indicates a hazardous situation which, if not avoided, could result in death or serious injury.
	CAUTION, used with the safety alert symbol, indicates a hazardous situation which, if not avoided, could result in minor or moderate injury.
NOTICE	NOTICE is used to address practices not related to personal injury.

Follow the basic safety precautions

When using electrical appliances, basic safety precautions shall always be followed, to reduce the risk of fire, electric shock, and/or injury to persons, including the following:

- Read all instructions.
- Do not touch hot surfaces. Use handles or knobs.
- To protect against fire, electric shock and injury to persons, do not immerse power cord, plugs, or body of machine in water or other liquid.
- Close supervision is necessary when any appliance is used by or near children.
- Unplug from outlet when not in use and before cleaning. Allow to cool before putting on or taking off parts, and before cleaning the appliance.
- Do not operate any appliance with a damaged cord or plug or after the appliance malfunctions, or has been damaged in any manner. Return appliance to the nearest authorized service facility for examination, repair or adjustment.

- The use of an accessory attachment not recommended by the appliance manufacturer may result in fire, electric shock, or injury to persons.
- Do not use outdoors.
- Do not let the cord hang over the edge of a table or counter, or touch hot surfaces.
- Do not place on or near a hot gas or electric burner, or in a heated oven.
- Always attach plug to appliance first, then plug cord into the wall outlet.
- To disconnect, turn any control to 'OFF' then remove plug from wall outlet.
- Do not use appliance for other than intended use.
- Use extreme caution when dispensing hot steam, hot water or hot coffee.

SAVE THESE INSTRUCTIONS. Pass them on to any subsequent user.

Intended use This machine is intended for use by specialist or trained staff in businesses, light industry and agricultural facilities or for commercial use by non-professionals. It shall only be used for coffee preparation and to heat milk and water, according to these instructions. Use for any other purpose will be deemed improper. JURA Elektroapparate AG cannot accept any responsibility for the consequences of improper use.

People, including children, who

- do not have the physical, sensory or mental capabilities to use the appliance safely or
- are inexperienced or lack knowledge in how to use the appliance safely

must be supervised by a responsible person when using it, or must be instructed in how to use it correctly.

Special power cord set instructions

- A short power-supply cord is to be provided to reduce risks resulting from becoming entangled in or tripping over a longer cord.
- The cord shall be arranged so that it will not drape over the counter top or table top where it can be pulled on by children or tripped over.
- This appliance has a 3-pin grounded plug.
- Do not modify the plug in any way.

Extension cords are available and may be used if care is exercised in their use.

If the user chooses to use an extension cord,

- the marked electrical rating of the extension cord should be at least as great as the electrical rating of the appliance, and
- if the appliance is of the grounded type, the extension cord should be a grounding type 3-wire cord, and
- the longer cord should be arranged so that it will not drape over the counter top or tabletop where it can be pulled on by children or tripped over.

 **WARNING**



To reduce the risk of fire or electric shock, DO NOT remove any service covers. DO NOT modify the appliance in any way that is not described in these instructions. NO user serviceable parts included. Repair MUST be done by authorized personnel only.

In the event of signs of damage, for example if there is a smell of burning, unplug the machine immediately from outlet and contact JURA customer service.

 **CAUTION**

- Office building, hotel maintenance and management staff must ensure that servicing should be performed by an authorized service facility only.
- Do not immerse base in water or try to disassemble.
- Do not put the appliance or any individual parts in the dishwasher.
- Check voltage to be sure that the voltage indicated on the name plate complies with your voltage. The name plate is located on the underside of the appliance.
- Never use warm or hot water to fill the water container. Use cold water only.
- Keep your hands and the cord away from hot parts of the appliance during operation.

There is a risk of scalds or burns on the spouts and the cappuccino frother / nozzle.

- Keep children away.
- Do not touch any hot parts. Use the handles or knobs provided.
- Ensure that the cappuccino frother / nozzle is correctly fitted and clean. If incorrectly fitted or if they become blocked, the cappuccino frother or its parts might come off.

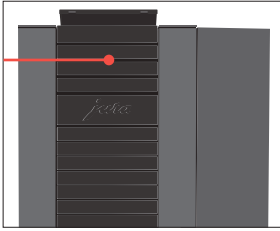
NOTICE

- Never clean with scouring powders or hard implements.
- Ensure that the ventilation slots are not covered.
- Never pull out the drip tray during the brewing process. Only pull the drip tray when the display instructs you or when the appliance is ready for use.

NEVER DO
(or you will void your
warranty protection):

- Never fill instant coffee, chocolate mix etc. into the bean container or ground coffee funnel (filler funnel for ground coffee). It will damage the functioning of the brewing chamber.
- Never fill sugar coated coffee beans into the bean container. In case of doubt, call your dealer.
- Never fill anything other than coffee beans into the bean container (no chocolate, no rice, no nuts, no spices, nothing other than roasted coffee beans).
- Never fill frozen beans into the bean container. If you store beans in the freezer, let them thaw 3 to 4 hours before filling them into the bean container.
- Never fill anything but fresh, cold and clean water into the water tank, except when decalcifying.
- Never use mineral or carbonated water. You can use tap water, bottled water, spring water and reverse osmosis water.
- Never do anything with the machine which is not described in these instructions. In case of doubt, call your dealer.

2 Control elements

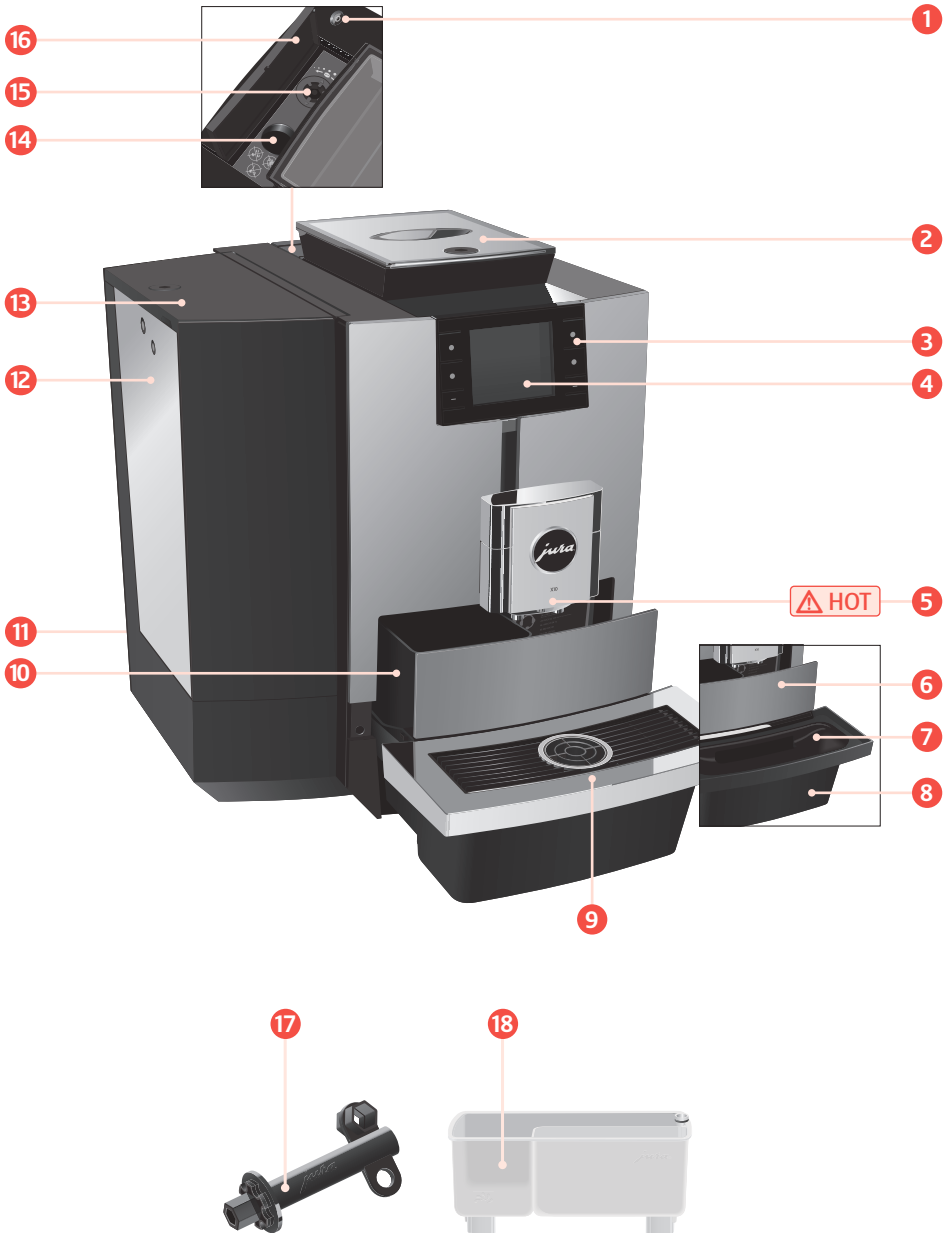

- 1 On/Off button 
- 2 Bean container with aroma preservation cover (lockable)
- 3 Multi-function buttons (button function depends on what is shown in the display)
- 4 Display
- 5 Height-adjustable dual spout
- 6 Insert with panel
- 7 Insert for drip tray
- 8 Drip tray
- 9 Cup platform
- 10 Coffee grounds container
- 11 Power cord (permanently connected or plug-in) (back of the machine)
- 12 Water tank
- 13 Water tank cover (lockable)
- 14 Filler funnel for cleaning tablet
- 15 Grinder adjustment wheel
- 16 Cover
- 17 Spanner for aroma preservation cover, water tank cover and grinder adjustment wheel
- 18 Container for milk system cleaning

Service socket for optionally available JURA Connector

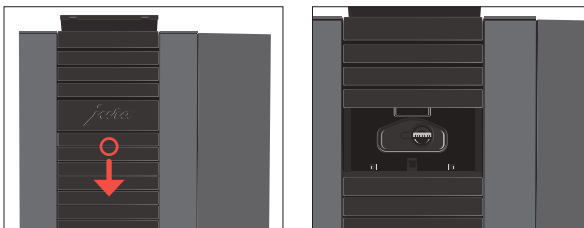

3 Preparing and using for the first time

Setting up the machine

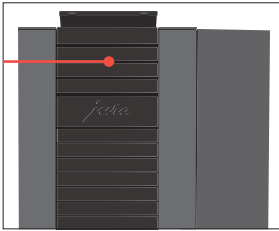

- ▶ Choose a spot for your X10 which protects the machine against overheating. Ensure that the ventilation slots are not covered.
- ▶ Place the X10 on a horizontal surface that is not sensitive to water (minimum height of 31.5 in (80 cm)).

Filling the bean container

The aroma preservation cover of the bean container is lockable (spanner supplied as standard).

NOTICE

Coffee beans which have been treated with additives (e.g. sugar), ground coffee or freeze-dried coffee will damage the grinder.

- ▶ Only use roasted, untreated coffee beans to fill the bean container.

- ▶ Remove the aroma preservation cover.
- ▶ Fill the bean container with coffee beans and close the aroma preservation cover.

Determining the water hardness

When you use the machine for the first time, you must set the water hardness. If you know the hardness of your water, go straight to the next section. If you do not know the water hardness, you can find this out first:

- ▶ Hold the Aquadur® test strip supplied under running water for one second. Shake off the water.
- ▶ Wait for about 1 minute.
- ▶ You will then be able to read the degree of water hardness from the discoloration of the Aquadur® test strip and the description on the packaging.

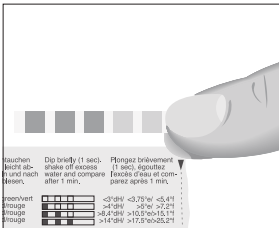

Level	Display German Degree (°dH)	Degrees of general hardness (°dGH)	Parts per million (ppm)	Indicator Strip number of 'reddish' fields
Not active	-	-	-	-
Very soft water	<3	<3	< 53.4	None
Soft water	> 4	> 4	> 71	1
Hard water	> 8.4	> 8.4	> 150	2
Very hard water	> 14	> 14	> 250	3

First-time use

WARNING

If the machine is operated with a defective power cord, there is a danger of potentially fatal electric shock.

- ▶ Never use a machine which is damaged.
- ▶ Never use a machine which has a defective power cord.

NOTICE

Milk, sparkling mineral water or other liquids can damage the water tank or the machine.

- ▶ Only fill the water tank with fresh, cold water.

Precondition: The bean container has been filled.

- ▶ For machines with a **plug-in** power cord: Connect the power cord to the machine.
- ▶ Insert the power plug into a power socket.
- ▶ Press the On/Off button  to switch the X10 on.

'Language' 'English'

- ▶ Press the > or < button until the desired language is displayed, e.g. 'English'.

- ▶ Press the 'Save' button.

'Water hardness'

i Please refer to the section above for a description of how to determine the water hardness.

- ▶ Press the > or < button to change the setting for the water hardness.
- ▶ Press the 'Save' button.

'Filter operation' / 'Insert filter'

3 Preparing and using for the first time



- ▶ Place a receptacle under the dual spout.
- ▶ Remove the water tank and rinse it with cold water.
- ▶ Open the filter holder.

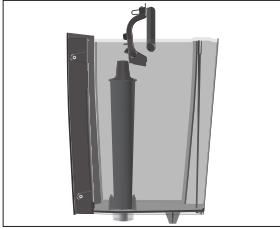

- ▶ Insert the CLEARYL Pro Smart+ filter cartridge into the water tank, exerting slight pressure.
- ▶ Close the filter holder. It will click into place audibly.
- ▶ Fill the water tank with fresh, cold water and reinsert the tank.

i The machine automatically detects that you have just inserted the filter cartridge.

'Filter is being rinsed', water flows directly into the drip tray.

'System is filling', water flows out of the dual spout.

'Machine is heating'

'Machine is rinsing'

'Milk system is being rinsed'

The start screen is displayed. Your X10 is ready for use.

Managing your X10 – the JURA Cockpit



The **JURA Cockpit** allows you to manage your X10. Press the > button for **approx. 2 seconds** to enter the JURA Cockpit.

Symbol	Meaning
	'Maintenance' area (blue)
	'Machine settings' area (green)
	Product counter, day counter, maintenance counter
	Filter mode

Connecting milk

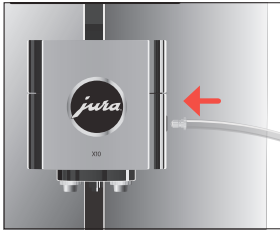

Your X10 creates fine, creamy, feather-light milk foam with a perfect consistency. The most important requirement for frothing milk is a milk temperature of 39–46 °F (4–8 °C). We would therefore recommend using a milk cooler or a milk container.

- ▶ Connect the milk pipe to the dual spout.
 - i** The milk system of your X10 has a connector **HP3** and an interchangeable milk spout **CX2**.
- ▶ Connect the other end of the milk pipe to a milk container or a milk cooler.

4 Preparation

⚠ WARNING

Hot coffee, hot steam and hot water can cause scalding. Scalding is a serious burn.

- ▶ Use extreme care when handling hot liquid or steam.
- ▶ Allow liquid to cool down before drinking.
- ▶ In the event of scalding, rinse affected area with cold water and seek medical attention.
- ▶ Keep children AWAY.

Specialties:

Page ● ○ ○	'Espresso'	'Americano'
	'Coffee'	'Latte macchiato'
Page ○ ● ○	'Flat White'	'Lungo'
	'Cappuccino'	'Jug of coffee'
Page ○ ○ ●	'Caffè latte'	'Milk'
	'Hot water'	'Milk foam'

Basic information about preparing drinks:

Aim	What to do
Change the coffee strength of a single product	Press the < or > button during grinding
Change the amount for a single product	Press the < or > button during preparation

- i** The longer you press the < and > buttons, the faster your setting changes.

4 Preparation

Aim	What to do
Permanently save the amount for a single product	Press 'Save' straight after preparation
Change the amount, coffee strength and temperature for any given product	Press the button for a product for two seconds and configure the desired settings in 'Product settings'
Display more products	Press the > button to display the next product page
Prepare two speciality coffees	Press the preparation button twice within two seconds
Stop preparation	Press the 'X' button



i Coffee tastes best served hot. A cold porcelain cup cools the beverage – and impairs the taste. We therefore recommend prewarming the cups. You can purchase a JURA cup warmer from your specialized dealer.

Preparation with preselection (Specialty Selection)



Press the  button to open the Specialty Selection.

Now choose the desired preselection for the product:



Specialty Selection	Meaning
 – 'Cold Brew' (all specialty coffees)	The product is prepared as a cold beverage.
 – 'Extra Shot' (for latte macchiato, flat white and cappuccino)	The product is prepared with two brewing operations, with half the amount of water – for a specialty coffee with a particularly intense taste.

i If you press and **hold** your preselection (for 2 seconds), the preselection will be active until you switch off your X10.

Espresso and coffee



Example: Coffee

- ▶ Place a cup under the dual spout.
 - ▶ Press the 'Coffee' button (on page   ).
- The preset amount of water for coffee flows into the cup.

Cold Brew



The 'Cold Brew' preselection ☼ is used to prepare a cold specialty coffee.

Example: Flat white with 'Cold Brew' preselection

Precondition: Milk is connected to the dual spout.

- ▶ Fill the water tank with **cold** water.
 - ▶ **i** You can influence the brewing result: The colder the water in the water tank, the colder the brewed beverage will be.
 - ▶ Add ice cubes to a glass according to your own preferences.
 - ▶ Place the glass under the dual spout.
 - ▶ Press the > button to display the **second page** of the start screen (○●○).
 - ▶ Press the ☑ button to open the Specialty Selection.
 - ▶ **i** If the 'Cold Brew' preselection is not shown, adjust the consistency of grind to **coarser** using the spanner.
 - ▶ Press the ☼ button to activate the 'Cold Brew' preselection.
 - ▶ Press the ✓ button.
 - ▶ Press the 'Flat White' button.
- The preset amounts of coffee and milk foam flow into the glass.

Latte macchiato, cappuccino and other specialty coffees with milk

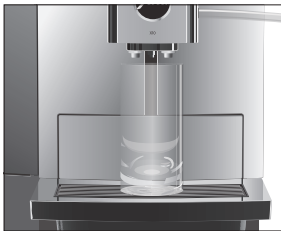

Your X10 prepares the following specialty coffees with milk at the touch of a button:

- 'Latte macchiato'
- 'Flat White'
- 'Cortado'
- 'Cappuccino'
- 'Caffè latte'

Example: Latte macchiato

Precondition: Milk is connected to the dual spout.

- ▶ Place a glass under the dual spout.
 - ▶ Press the 'Latte macchiato' button (on page ●○○).
- The preset amounts of milk and milk foam flow into the glass.
- ▶ **i** There is a short interval while the hot milk separates from the milk foam. This allows the typical layers of a latte macchiato to form.
- The preset amount of water for espresso flows into the glass.
- ▶ **i** **15 minutes** after preparation, the milk system is **automatically** rinsed. Therefore always place a receptacle under the dual spout after preparing milk.

To ensure that the milk system in the dual spout always works properly, you must clean it **daily** (see chapter 7 ‘Maintenance – Cleaning the milk system’).

Americano and lungo

For the americano and lungo, the X10 blends the coffee with hot water using a special preparation method. This results in a full-bodied specialty coffee which is particularly easy to digest. You can change the amount of this additional water (see chapter 4 ‘Preparation – Adjusting the product settings’).

Hot water

⚠ CAUTION

There is a danger of scalding from hot water splashes.

- ▶ Avoid direct contact with the skin.
 - ▶ Place a cup under the dual spout.
 - ▶ Press the ‘Hot water’ button (on page ○○●).
- The preset amount of water flows into the cup.
-



Adjusting the grinder

You can adjust the grinder to suit the degree of roast of your coffee.

The consistency of grind is correct if the coffee flows regularly from the coffee spout. In addition a fine, thick crema forms.

You can set the consistency of grind using the spanner provided.

- ▶ Open the cover behind the bean container.
- ▶ Turn the grinder adjustment switch to the desired position.
- ▶ Close the cover.



Adjusting the product settings

Press a product button for **about two seconds** to view the list of settings:

- ‘Product settings’: Specify individual settings such as coffee strength, amount of water, etc.

- **'Reposition the product'**: Replace the products on the start screen with your favorites.

Permanent settings in programming mode always follow the same model.

Example: Proceed as follows to change the coffee strength for one coffee.

- ▶ Press the **'Coffee'** button for **about two seconds**.
- ▶ Press the **'Product settings'** button.
'Coffee strength'
 - ❗ Different settings will be available depending on the selected product: Press the ◀ or ▶ button to navigate the various settings.
- ▶ Press the > or < button to change the setting.
- ▶ Press the **'Save'** button.
- ▶ Press the **'X'** button to return to the start screen.

5 Daily operation

Switching the machine on and off



- ▶ Place a receptacle under the dual spout.
- ▶ Press the On/Off button .

'Machine is rinsing'

Your X10 is switched on or off.

- ❗ When the machine is switched off, the system is only rinsed if a specialty coffee has been prepared.
- ❗ If milk has been prepared before switching off, you will be prompted to carry out milk system cleaning (**'Clean the milk system'**). After 30 seconds the switch-off process continues automatically.

Filling the water tank

Daily maintenance of the machine and hygiene when handling milk, coffee and water are key to a perfect coffee result in the cup every time. You should therefore change the water **daily**.

CAUTION

Milk, sparkling mineral water or other liquids can damage the water tank or the machine.

- ▶ Only fill the water tank with fresh, cold water.

5 Daily operation

You can lock the water tank cover with the spanner provided.

- ▶ Open the water tank cover.
- ▶ Remove the water tank and rinse it with cold water.
- ▶ Fill the water tank with fresh, cold water and reinsert the tank.
- ▶ Close the water tank cover.

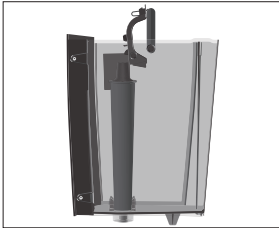

Maintenance actions

Optimal coffee quality depends on many factors. One important prerequisite is regular maintenance of your X10. Carry out the following steps:

Maintenance action	Daily	If necessary	Note
Empty the drip tray and coffee grounds container and rinse with warm water (The insert for the drip tray, including the drip tray itself, and the coffee grounds container are dishwasher-safe)	▪		Always empty the coffee grounds container when the machine is switched on. This is the only way of resetting the coffee grounds counter.
Clean the milk system (if heavily soiled, also dismantle and rinse it)	▪		See chapter 7 ‘Maintenance – Cleaning the milk system’. We recommend dismantling and rinsing the milk system once a week (see chapter 7 ‘Maintenance – Dismantling and rinsing the dual spout’)
Rinse the milk pipe	▪		
Rinse the water tank	▪		
Wipe the surface of the machine with a clean, soft, damp cloth (e.g. microfiber cloth)	▪		
Changing milk pipe with connector HP3		approx. every 3 months	
Change the interchangeable milk spout CX2		approx. every 3 months	
Clean the inside of the water tank with a brush		▪	

Maintenance action	Daily	If necessary	Note
Clean the top and bottom of the cup platform		▪	
Thoroughly clean the drip tray and coffee grounds container		▪	

i You will find more information about the maintenance of your X10 in the 'Maintenance' area  in the programme item 'Information'.

6 Machine settings

Press the > button for **approx. 2 seconds** to enter the JURA Cockpit. The following settings can be saved in 'Machine Settings' .

Program item	Explanation
Page ● ○ ○ ○ ○	
'Switch off after'	Set the automatic switch-off time to save energy (switch-off after 15 minutes, 30 minutes or 1 – 9 hours after the last action on the machine)
'Water hardness'	Set the hardness of the water used (1 °dH to 30 °dH) to prevent limescale building up in your machine
'Product name'	Display product images with/without product names on the start screen
'Units'	Set the unit for the amount of water (ml or oz)
Page ○ ● ○ ○ ○	
'Choose language'	Set language
'Factory setting'	Reset your X10 to factory settings (the machine then switches off)
'Empty system'	Empty the system to protect the X10 from frost damage during transport (see chapter 10 'Transport and environmentally friendly disposal – Transport / Emptying the system')
'Version'	View software version
Page ○ ○ ● ○ ○	
'Lock/enable'	Blocking and releasing individual products
'Product settings'	Define whether the permanent product settings can be changed or not
'One-off settings'	Permit/do not permit one-off settings during preparation
Page ○ ○ ○ ● ○	
'Accessories' (only displayed if JURA Connector is being used)	Sub-menu(s) when using JURA Payment Connect: 'QR code' / 'Reset Payment Connect' JURA Business Connect: 'Pocket Pilot' / 'Reset Business Connect' JURA MDB Connect: 'Incasso' JURA Wi-Fi Connect (V2): 'Wi-Fi connection'

7 Maintenance

⚠ WARNING

Use of maintenance products that are harmful to health and discharge of liquids during maintenance program. Harmful if swallowed. Irritating to eyes and skin.

- ▶ Keep children AWAY.
- ▶ Keep children away from the machine while it is performing a maintenance program.
- ▶ Avoid contact with skin and eyes.
- ▶ Avoid generation of dust. Do not inhale dust.
- ▶ When using do not eat or drink.
- ▶ Keep maintenance products away from food, drink and animal food.
- ▶ Keep container tightly closed and dry. Keep in a cool place.

Basic information about maintenance:

- Press the > button for **approx. 2 seconds** to enter the JURA Cockpit. You can manage the maintenance of your X10 in the ⚙ section.
- If a maintenance program is pending, a fourth page (red dot) will appear on the start screen.
- In the Cockpit of your X10, maintenance programs that need to be carried out are shown in the form of messages with red backgrounds. Press the button that corresponds to the message to go straight to the maintenance program. Maintenance programs that are due imminently are indicated on your X10 by means of a bar display within the message.
- Carry out each maintenance program when you are prompted to do so.

Rinsing the machine



You can start coffee system rinsing manually at any time.

Precondition: The start screen is displayed.

- ▶ Place a receptacle under the dual spout.
- ▶ Press the > button for **approx. 2 seconds** to enter the JURA Cockpit.
- ▶ Press the ⚙ button.
- ▶ Press the **'Rinse the coffee system'** button to start the rinse operation.

'Milk system is being rinsed' / 'Machine is rinsing'

The operation stops automatically.

Automatic milk system rinsing

15 minutes after preparation, the milk system is **automatically** rinsed. Therefore always place a receptacle under the dual spout after preparing milk.

Inserting/changing the filter

Once the filter cartridge stops working (depending on the water hardness setting), the X10 will prompt you to change the filter.

- i** Your X10 no longer has to be descaled if you are using the CLEARYL Pro Smart+ filter cartridge. CLEARYL Pro Smart+ filter cartridges are available from specialized dealers.

Precondition: 'Filter' is displayed in the Cockpit if the filter's capacity has been exhausted.

- Remove and empty the water tank.
- Open the filter holder and remove the **old** CLEARYL Pro Smart+ filter cartridge.
- Insert a **new** CLEARYL Pro Smart+ filter cartridge into the water tank, exerting slight pressure.
- Close the filter holder. It will click into place audibly.
- Fill the water tank with fresh, cold water and reinsert the tank. The machine automatically detects that you have just inserted/changed the filter cartridge.

'Filter is being rinsed', water flows directly into the drip tray.

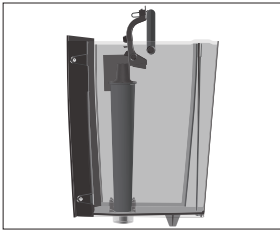

Cleaning the milk system

To ensure that the milk system in the dual spout always works properly, you must clean it **daily** when you have been preparing milk.

⚠ WARNING

Non-recommended cleaning agents will not optimally remove milk residues. This may cause the cappuccino frother to become blocked and fly off the machine. Discharge of hot steam.

- Use only original JURA milk system cleaner.

⚠ WARNING

Harmful and irritating cleaning agent. Harmful if swallowed. Irritating to eyes and skin.

- Keep children **AWAY**.
- Avoid contact with skin and eyes.
- After contact with skin, wash immediately with plenty of water. In case of skin irritation, seek medical advice.
- After eye contact, immediately flush eyes with plenty of water and seek medical advice.
- If swallowed, rinse mouth immediately and drink large quantities of water. Do not induce vomiting. Seek medical advice immediately and show label.

- ❗ JURA milk system cleaner is available from specialized dealers.
- ❗ Use the container supplied for milk system cleaning.

Precondition: 'Clean the milk system' is displayed in the Cockpit.

- ▶ Press the > button for **approx. 2 seconds** to enter the JURA Cockpit.
- ▶ Press the 'Clean the milk system' button.
'Clean the milk system'
- ▶ Press the 'Start' button.
'Add milk system cleaner'
- ▶ Remove the milk pipe from the milk container or milk cooler.
- ▶ Add 1 dosing unit of milk system cleaner to the rear part of the container.
- ▶ Place the container under the dual spout.

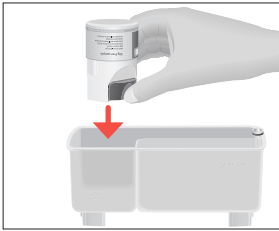

- ▶ Connect the milk pipe to the container.
 - ❗ To connect the milk pipe to the container correctly, the pipe must be fitted with a connector HP3.
- ▶ Press the 'Next' button.
'Cleaning milk system', the dual spout and the milk pipe are cleaned.
The operation stops automatically.

Dismantling and rinsing the dual spout

If insufficient foam is produced when the milk is frothed or milk sprays out of the dual spout, the spout may be dirty. If this happens, dismantle and rinse the dual spout.

- ▶ Remove the milk pipe and rinse it thoroughly under running water.

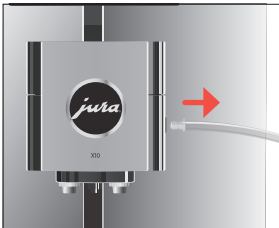

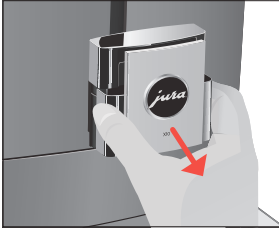

- ▶ Pull the cover of the dual spout forwards and off.

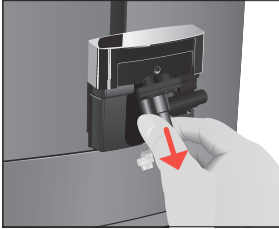

- ▶ Remove the milk system from the dual spout.

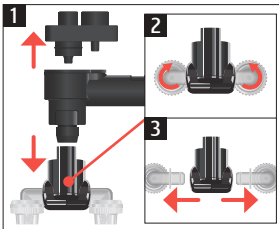

- ▶ Dismantle the milk system into its individual parts.
- ▶ Rinse all the parts under running water. If there are severely dried-on milk residues, firstly immerse the individual parts in a solution of 8.5 oz (250 ml) water and one dosing unit of JURA milk system cleaner. Then rinse the individual parts thoroughly.

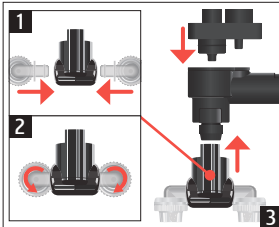

- ▶ Reassemble the milk system.

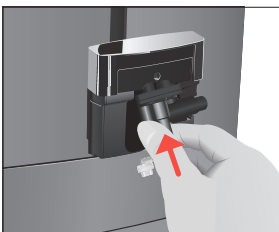

- ▶ Fit the assembled individual parts back in the dual spout and press it firmly.

7 Maintenance

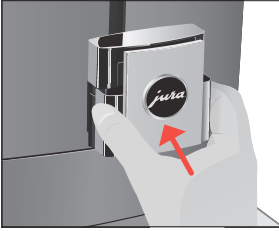

- ▶ Fit the cover of the dual spout.

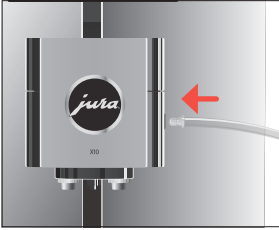

- ▶ Connect the milk pipe to the dual spout.

Cleaning the machine

After 180 preparations or 80 switch-on rinses, the X10 will prompt you to clean it.

WARNING



Non-recommended (e.g. liquid) cleaning agents may contain substances that could damage the machine or leave residues.

- ▶ Use only original JURA cleaning tablets. These are formulated especially for your machine.

WARNING

Harmful and irritating cleaning agent. Harmful if swallowed. Irritating to eyes and skin.

- ▶ Keep children AWAY.
- ▶ Avoid contact with skin and eyes.
- ▶ Avoid generation of dust. Do not inhale dust.
- ▶ After contact with skin, wash immediately with plenty of water. In case of skin irritation, seek medical advice.
- ▶ After eye contact, immediately flush eyes with plenty of water and seek medical advice.
- ▶ If swallowed, rinse mouth immediately and drink large quantities of water. Do not induce vomiting. Seek medical advice immediately and show label.

-  The cleaning program lasts approximately 20 minutes.
-  Do not interrupt the cleaning program. The quality of cleaning will be impaired if you do so.
-  JURA cleaning tablets are available from specialized dealers.

Precondition: 'Clean' is displayed in the Cockpit.

- ▶ Fill the water tank.
- ▶ Press the > button for **approx. 2 seconds** to enter the JURA Cockpit.
- ▶ Press the 'Clean' button.
- ▶ Press the 'Start' button.
'Empty grounds'
- ▶ Empty the drip tray and coffee grounds container and put them back into the machine.
'Clean'
- ▶ Place a receptacle under the dual spout.
- ▶ Press the 'Next' button.
'Machine is being cleaned', water flows out of the dual spout repeatedly.
The operation is interrupted, 'Add cleaning tablet'.
- ▶ Open the cover of the filler funnel for the cleaning tablet.

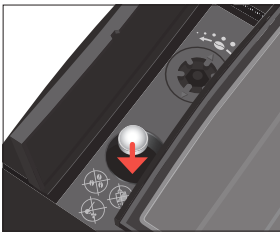

- ▶ Insert a JURA cleaning tablet into the filler funnel.
- ▶ Close the cover.
- ▶ Press the 'Next' button.
'Machine is being cleaned', water flows out of the dual spout repeatedly.
'Empty grounds'.
- ▶ Empty the drip tray and coffee grounds container and put them back into the machine.

Descaling the machine

The X10 builds up deposits of limescale over time and automatically prompts you to descale it when necessary (unless you are using a CLEARYL filter cartridge Pro Smart⁺).

- ▶ **i** If you are using a CLEARYL Pro Smart⁺ filter cartridge, you will not be prompted to descale.

⚠ WARNING

Non-recommended descaling agents (e.g. vinegar) may contain substances that could damage the machine or leave residues.

- ▶ Use only original JURA descaling tablets. These are formulated especially for your machine.

⚠ WARNING

Harmful and irritating descaling agent. Harmful if swallowed.
Irritating to eyes and skin.

- ▶ Keep children **AWAY**.
- ▶ Avoid contact with skin and eyes.
- ▶ Avoid generation of dust. Do not inhale dust.
- ▶ After contact with skin, wash immediately with plenty of water. In case of skin irritation, seek medical advice.
- ▶ After eye contact, immediately flush eyes with plenty of water. Remove contact lenses. Seek medical advice.
- ▶ If swallowed, rinse mouth immediately and drink large quantities of water. Do not induce vomiting. Seek medical advice immediately and show label.

NOTICE

If the descaling operation is interrupted, there may be damage to the machine.

- ▶ Allow the descaling program to run to the end.

- i** The descaling program lasts approximately 25 minutes.
- i** JURA descaling tablets are available from specialized dealers.
- i** If the descaling agent comes into contact with sensitive surfaces (e.g. marble), damage cannot be ruled out. Clean up any splashes immediately.

Precondition: 'Descale' is displayed in the Cockpit.

- ▶ Press the > button for **approx. 2 seconds** to enter the JURA Cockpit.
- ▶ Press the 'Descale' button.
- ▶ Press the 'Start' button.
- ▶ 'Empty drip tray'
- ▶ Empty the drip tray and coffee grounds container and put them back into the machine.
- ▶ 'Agent in tank'
- ▶ Remove and empty the water tank.
- ▶ Completely dissolve 3 JURA descaling tablets in a receptacle holding 17 oz (500 ml) of water. This may take several minutes.
- ▶ Pour the solution into the **empty** water tank and insert it into the machine.

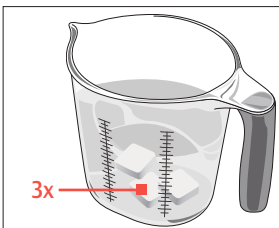



- ▶ Place a receptacle under the dual spout.
- ▶ Press the 'Next' button.
'Machine is being descaled', water will flow from the hot-water spout several times.
'Empty drip tray'.
- ▶ Empty the drip tray and coffee grounds container and put them back into the machine.
'Rinse the water tank' / 'Fill water tank'
- ▶ Empty the receptacle and place it under the dual spout again.
- ▶ Remove the water tank and rinse it thoroughly.
- ▶ Fill the water tank with fresh, cold water and reinsert the tank.
- ▶ Press the 'Next' button.
The descaling operation is continued.
'Empty drip tray'
- ▶ Empty the drip tray and coffee grounds container and put them back into the machine.
 - ▶ **i** If the descaling operation stops unexpectedly, rinse the water tank thoroughly.

Descaling the water tank

Limescale deposits may form in the water tank. To ensure correct function of the machine, descale the water tank from time to time.

- ▶ Remove the water tank.
- ▶ If you use a CLEARYL Pro Smart⁺ filter cartridge, remove this.
- ▶ Completely fill the water tank and dissolve 3 JURA descaling tablets in it.
- ▶ Leave the water tank with the descaling solution for several hours (e.g. overnight).
- ▶ Empty the water tank and rinse it thoroughly.
- ▶ If you use a CLEARYL Pro Smart⁺ filter cartridge, insert this again.
- ▶ Fill the water tank with fresh, cold water and reinsert the tank.

Cleaning the bean container

Coffee beans may be covered with a slight oil film which remains on the walls of the bean container. These traces may negatively affect the coffee result. For this reason clean the bean container from time to time.

Precondition: 'Fill bean container' is displayed.

- ▶ Switch the machine off with the On/Off button .
- ▶ Remove the aroma preservation cover.
- ▶ Clean the bean container with a soft, dry cloth.
- ▶ Fill the bean container with coffee beans and close the aroma preservation cover.

8 Display messages

Messages on the start screen

Message	Cause/Result	Action
'Fill water tank'	The water tank is empty. You cannot prepare any products.	▶ Fill the water tank (see chapter 5 'Daily operation – Filling the water tank').
'Empty grounds' / 'Empty drip tray'	The coffee grounds container is full. / The drip tray is full. You cannot prepare any products.	▶ Empty the coffee grounds container and the drip tray (see chapter 5 'Daily operation – Maintenance actions').
'Drip tray not fitted'	The drip tray is not inserted correctly or is not inserted at all. You cannot prepare any products.	▶ Fit the drip tray.
'Fill bean container'	The bean container is empty. You cannot prepare any specialty coffees, but you can prepare hot water and milk.	▶ Fill the bean container (see chapter 3 'Preparing and using for the first time – Filling the bean container').
'Too hot'	The system is too hot to start a maintenance program.	▶ Wait for several minutes until the system has cooled or prepare a specialty coffee or hot water.

Messages in the Cockpit

Message	Cause/Result	Action
The filter symbol  lights up red. 'Filter'	The filter cartridge no longer works.	▶ Replace the CLEARYL Pro Smart+ filter cartridge (see chapter 7 'Maintenance – Inserting/changing the filter').
'Clean'	The X10 is prompting you to clean it.	▶ Perform cleaning (see chapter 7 'Maintenance – Cleaning the machine').
'Descale'	The X10 is prompting you to descale it.	▶ Perform descaling (see chapter 7 'Maintenance – Descaling the machine').
'Clean the milk system'	The X10 prompts you to clean the milk system.	▶ Perform milk system cleaning (see chapter 7 'Maintenance – Cleaning the milk system').

9 Troubleshooting

Problem	Cause/Result	Action
Insufficient foam is produced when the milk is frothed or milk sprays from the dual spout.	The dual spout is dirty.	<ul style="list-style-type: none"> ▸ Clean the milk system in the dual spout (see chapter 7 'Maintenance – Cleaning the milk system'). Dismantle and rinse the dual spout (see chapter 7 'Maintenance – Dismantling and rinsing the dual spout').
Coffee only comes out in drips when it is being prepared.	The coffee is ground too finely and obstructs the system.	<ul style="list-style-type: none"> ▸ Set the grinder to a coarser setting (see chapter 4 'Preparation – Adjusting the grinder').
	The water hardness may not have been correctly set.	<ul style="list-style-type: none"> ▸ Perform descaling (see chapter 7 'Maintenance – Descaling the machine').
There is dry ground coffee behind the coffee grounds container.	The beans used are resulting in an above-average volume of ground coffee.	<ul style="list-style-type: none"> ▸ Reduce the coffee strength or choose a finer grinder setting (see chapter 4 'Preparation – Adjusting the product settings').
Little or no steam comes out of the dual spout. The pump is very quiet.	The connector of the milk system in the dual spout may be blocked by milk residues or limescale fragments loosened during descaling.	<ul style="list-style-type: none"> ▸ Pull the cover of the dual spout forwards and off. ▸ Remove the milk system from the dual spout. ▸ Unscrew the black connector using the hexagonal hole on the spanner. ▸ Clean the connector thoroughly. ▸ Screw the connector back on by hand. ▸ Carefully tighten it using the hexagonal hole on the spanner, turning by no more than a quarter of a rotation.
Grinder is making a very loud noise.	There are foreign objects in the grinder.	<ul style="list-style-type: none"> ▸ Contact customer support in your country (see chapter 13 'JURA contact details / Legal information').
'ERROR 2' or 'ERROR 5' is displayed.	If the machine has been exposed to the cold for a long period of time, heating may be disabled for safety reasons.	<ul style="list-style-type: none"> ▸ Warm the machine at room temperature.

Problem	Cause/Result	Action
Other 'ERROR' messages are displayed.	–	▶ Contact customer support in your country (see chapter 13 'JURA contact details / Legal information').

i If you were unable to solve the problem, contact customer support in your country (see chapter 13 'JURA contact details / Legal information').

10 Transport and environmentally friendly disposal



Transport / Emptying the system

Keep the packaging for your X10. It should be used to protect the machine during transport.

In order to protect the X10 from frost during transport, the system must be emptied.



Precondition: The start screen is displayed.

- ▶ Place a receptacle under the dual spout.
- ▶ Press the > button for **approx. 2 seconds** to enter the JURA Cockpit.
- ▶ Press the  button.
- ▶ Press the > button to go to page .
- ▶ Press the 'Empty system' button.
- ▶ Remove and empty the water tank.

'System is emptying'

Steam will continue to be discharged from the dual spout until the system is empty. Your X10 is switched off.

Disposal

Please dispose of old machines in an environmentally neutral way.



11 Technical data

Voltage	120 V ~, 60 Hz
Power	1450 W
Ambient conditions	Humidity max. 80 % Ambient temperature 50–95 °F (10 – 35 °C)
Sound pressure level	$L_p < 70$ dB (A)
Conformity mark	
Pump pressure	static, max. 15 bar
Holding capacity of water tank (without filter)	176 oz (5 l)
Holding capacity of bean container	17.6 oz (500 g) (can be increased to 35.2 oz (1000 g))
Holding capacity of coffee grounds container	max. 40 portions
Milk system with connector	HP3
Interchangeable milk spout	CX2
Cord length	approx. 47 in. (1.2 m)
Weight	approx. 29.1 lb (13.2 kg)
Dimensions (W × H × D)	14.7 × 18.5 × 18.2 in. (37.3 × 47 × 46.1 cm)
CLEARYL Pro Smart [®] filter cartridge (RFID technology)	Frequency band 13.56 MHz Max. transmission power < 1 mW
JURA Wi-Fi Connect (Wi-Fi connection)	Frequency band 2.4 GHz Max. transmission power < 100 mW
JURA type	777

Directives The machine complies with the following directives:

- Standard UL 1082
- Canadian Standard CSA C22.2 No. 60335-2-15

FCC Rules This equipment has been tested and found to comply with the limits for a class B digital device, pursuant to part 15 of the FCC Rules.

12 Index

A

- Addresses 34
- Adjusting the product settings 16
- Americano 16
- Aroma preservation cover
 - Bean container with aroma preservation cover 9

B

- Bean container
 - Bean container with aroma preservation cover 9
 - Cleaning 27
 - Filling 10
- Bus bar
 - Technical data 31
- Button
 - On/Off button 9

C

- Caffè latte 15
- Cappuccino 15
- Cleaning
 - Bean container 27
 - Machine 24
- CLEARYL Pro Smart filter cartridge
 - Changing 21
 - Inserting 21
- Cockpit 12, 19, 20
- Coffee 14
- Coffee grounds container 9
- Cold Brew 15
- Consistency of grind
 - Adjusting the grinder 16
 - Grinder adjustment wheel 9
- Contact details 34
- Cover 9
 - Water tank 9
- Cup platform 9
- Customer support 34

D

- Descaling
 - Machine 25
 - Water tank 27
- Display 9
 - Cockpit 12
- Display messages 28
- Disposal 30
- Drip tray 9
 - Insert 9
- Dual spout
 - Dismantling and cleaning 22
 - Height-adjustable dual spout 9

E

- Emptying the system 30
- Errors
 - Troubleshooting 29
- Espresso 14

F

- Filler funnel
 - Filler funnel for cleaning tablet 9
- Filling
 - Bean container 10
 - Water tank 17
- Filter
 - Changing 21
 - Inserting 21
- First-time use 11
- Flat white 15

G

- Grinder adjustment wheel 9

H

- Hotline 34
- Hot water 16

I

- Important safeguards
 - Safety 4
- Insert for drip tray 9
- Interchangeable milk spout 31

- J**
 JURA
 Contact details 34
- L**
 Latte macchiato 15
 Lungo 16
- M**
 Macchiato 15
 Machine
 Cleaning 24
 Descaling 25
 Rinsing 20
 Setting up 10
 Machine settings 19
 Maintenance 20
 Maintenance actions 18
 Messages, display 28
 Milk
 Connecting milk 13
 Milk system 31
 Clean 21
 Milk system rinsing 21
- P**
 Power cord 9
 Preparation 13, 15
 Americano 16
 Caffè latte 15
 Cappuccino 15
 Coffee 14
 Cold Brew 15
 Espresso 14
 Flat white 15
 Hot water 16
 Latte macchiato 15
 Lungo 16
 Macchiato 15
 Specialty Selection 14
 Problems
 Troubleshooting 29
 Product settings
 Adjusting 16
- R**
 RFID 31
 Rinsing
 Machine 20
- S**
 Safety
 Important safeguards 4
 Setting up
 Setting up the machine 10
 Specialty Selection
 Extra Shot 14
 Ground coffee 14
 Spout
 Height-adjustable dual spout 9
 Switching off 17
 Switching on 17
- T**
 Technical data 31
 Interchangeable milk spout 31
 Milk system 31
 Tel 34
 Transport 30
 Troubleshooting 29
- U**
 Use, first time 11
- W**
 Water hardness
 Determining the water hardness 10
 Water tank 9
 Descaling 27
 Filling 17
 Wi-Fi 31
 Wireless connection 11, 21, 31

13 JURA contact details / Legal information

JURA Elektroapparate AG
Kaffeeweltstrasse 10
CH-4626 Niederbuchsiten
Switzerland

	USA: JURA Inc.	Canada: FAEMA
Customer Service		
Phone	1-800-220-5701	1-(855)-544-8600
Email	info@us.jura.com	info@juracanada.ca
Hours of Operation (EST)	Mon – Fri 8 am – 8 pm, Sat 9 am – 5 pm	
Distributor Address	20 Craig Road Montvale, NJ 07645	115 Matheson Boulevard East Mississauga, Ontario, L4Z 1X8
Phone	1 (201) 767-3999	1-(905)-501-8600
Fax	1 (201) 767-9684	
Internet	us.jura.com	ca.jura.com

@ You will find additional contact details for your country at **jura.com**.

Technical changes We reserve the right to make technical changes. The diagrams used in these instructions for use are for illustration purposes only and do not represent the original colors of the machine. Some details of your X10 may vary.

Feedback Your opinion is important to us! Use the contact details at **jura.com**.

Copyright The instructions for use contain information which is protected by copyright. It is not permitted to photocopy these instructions for use or translate them into another language without the prior written consent of JURA Elektroapparate AG.