

Scan to see the online manual.



# LG SIGNATURE

## OWNER'S MANUAL **WASHING MACHINE**

Read this owner's manual thoroughly before operating the appliance and keep it handy for reference at all times.

**ENGLISH**



MFL71693772  
Rev.05\_071625

[www.LGSIGNATURE.com](http://www.LGSIGNATURE.com)

Copyright © 2024-2025 LG Electronics. All Rights Reserved

## **TABLE OF CONTENTS**

### **3 IMPORTANT SAFETY INSTRUCTIONS**

---

- 3 READ ALL INSTRUCTIONS BEFORE USE
- 3 WARNING STATEMENTS
- 6 CAUTION STATEMENTS

### **7 PRODUCT OVERVIEW**

---

- 7 Product Features

### **9 INSTALLATION**

---

- 9 Before Installing
- 10 Choosing the Proper Location
- 11 Unpacking and Removing Shipping Material
- 12 Connecting the Water Inlet Hoses
- 13 Connecting the Drain Hose
- 14 Leveling the Washer
- 15 Final Installation Check

### **17 OPERATION**

---

- 17 Before Use
- 18 Sorting Laundry
- 19 Loading the Washer
- 20 Adding Cleaning Products
- 23 Control Panel
- 25 Wash Cycles
- 32 Cycle Modifiers
- 32 Options and Extra Functions
- 36 More Options and Settings

### **39 SMART FUNCTIONS**

---

- 39 Using LG ThinQ Application
- 41 Smart Diagnosis™ Function

### **43 MAINTENANCE**

---

- 43 Regular Cleaning
- 43 Periodic Maintenance
- 47 Care in Cold Climates

### **49 TROUBLESHOOTING**

---

- 49 Before Calling for Service

### **58 LIMITED WARRANTY**

---

- 58 USA

# IMPORTANT SAFETY INSTRUCTIONS

## READ ALL INSTRUCTIONS BEFORE USE

### Safety Messages

**Your safety and the safety of others are very important.**

We have provided many important safety messages in this manual and on your appliance. Always read and follow all safety messages.



This is the safety alert symbol.

This symbol alerts you to potential hazards that can kill or injure you and others. All safety messages will follow the safety alert symbol and either the word WARNING or CAUTION.

These words mean:



### **WARNING**

You may be killed or seriously injured if you do not follow instructions.



### **CAUTION**

You may be injured or cause damage to the product if you do not follow instructions.

All safety messages will tell you what the potential hazard is, tell you how to reduce the chance of injury, and tell you what may happen if the instructions are not followed.

## WARNING STATEMENTS

### **! WARNING**

- To reduce the risk of explosion, fire, death, electric shock, scalding or injury to persons when using this product, follow basic precautions, including the following:

### **Installation**

- Adhere to all industry recommended safety procedures including the use of long-sleeved gloves and safety glasses.
- Never attempt to operate this appliance if it is damaged, malfunctioning, partially disassembled, or has missing or broken parts, including a damaged cord or plug.
- Before use, the appliance must be properly installed as described in this manual.
- To reduce the risk of severe injury or death, follow all installation instructions.
- Refer to the INSTALLATION INSTRUCTIONS for detailed grounding procedures. Installation instructions are packed with the appliance for the installer's reference. If the appliance is moved to a new location, have it checked and reinstalled by qualified service personnel.
- Moving or installation of the appliance requires two or more people.
- Do not install the appliance in humid spaces.
- Store and install the appliance where it will not be exposed to temperatures below freezing or exposed to outdoor weather conditions.
- This appliance is not designed for maritime use or for mobile installations such as in RVs, trailers, or aircraft.
- Keep packing materials out of the reach of children. Packaging material can be dangerous for children. There is a risk of suffocation.

## 4 IMPORTANT SAFETY INSTRUCTIONS

---

- Destroy the carton, plastic bag, and other packing materials after the appliance is unpacked. Children might use them for play. Cartons covered with rugs, bedspreads, or plastic sheets can become airtight chambers.
- The appliance must be installed and electrically grounded by qualified service personnel in accordance with local codes.
- When installing or moving the appliance, be careful not to pinch, crush, or damage the power cord.
- Connect to a properly rated, protected, and sized power circuit to avoid electrical overload.
- This appliance must be positioned near to an electrical power supply.
- Disconnect the power cord, house fuse or circuit breaker before installing or servicing the appliance.
- The power cord of this appliance is equipped with a 3-prong (grounding) plug which mates with a standard 3-prong (grounding) wall outlet to minimize the possibility of electric shock from this appliance.
- Do not, under any circumstances, cut or remove the third (ground) prong from the power cord.
- Use new hoses when connecting the washer to the water supply. Do not reuse old hoses.

### Operation

- Read all instructions before using the appliance and save these instructions.
- Use this appliance only for its intended purpose.
- If the product has been submerged in water, sitting in standing water, or waterlogged, do not come in contact with the product and immediately contact an LG Electronics Customer Information Center for instructions before resuming use.
- If you detect a strange sound, a chemical or burning smell, or smoke coming from the appliance, unplug it immediately and contact an LG Electronics Customer Information Center.
- Under certain conditions, hydrogen gas may be produced in a hot-water system that has not been used for two weeks or more. HYDROGEN GAS IS EXPLOSIVE. If the hot-water system has not been used for such a period, before using the appliance, turn on all hot water faucets and let the water flow from each for several minutes. This will release any accumulated hydrogen gas. As the gas is flammable, do not smoke or use an open flame during this time.
- Do not reach into the washer if the tub or drum, agitator, or any interior parts are moving. Before loading, unloading, or adding items, press Start/Pause and allow the tub or drum to coast to a complete stop before reaching inside.
- This appliance is not intended for use by persons (including children) with reduced physical, sensory or mental capabilities, or lack of experience and knowledge, unless they have been given supervision or instruction concerning the use of the appliance by a person responsible for their safety.
- Do not allow children or pets to play on, in or with the appliance. Close supervision is necessary when the appliance is used near children or pets.
- Keep laundry products out of children's reach. To prevent injury to persons, observe all warnings on product labels.
- Repair or immediately replace all power cords that have become frayed or otherwise damaged. Do not use a cord that shows cracks or abrasion damage along its length or at either end.
- Never unplug the appliance by pulling on the power cord. Always grip the plug firmly and pull straight out from the outlet.
- Do not use an extension cord or adapter with this appliance.
- Do not grasp the power cord or touch the appliance controls with wet hands.
- Do not modify or extend the power cord.
- If the electrical supply cord is damaged, it must only be replaced by the manufacturer or its service agent or a similar qualified person in order to avoid a hazard.
- Do not put oily or greasy clothing, candles or flammable materials on top of the appliance.
- Keep the area underneath and around your appliances free of combustible materials (lint, paper, rags, etc.), gasoline, chemicals and other flammable vapors and liquids.

- Do not store or use gasoline or other flammable vapors and liquids in the vicinity of this or any other appliance.
- Do not mix chlorine bleach with ammonia or acids such as vinegar. Follow package directions when using laundry products. Incorrect usage can produce poisonous gas, resulting in serious injury or death.
- Never use harsh chemicals, abrasive cleaners, or solvents to clean the washer. They will damage the finish.
- Do not wash laundry that has been previously cleaned in, washed in, soaked in, or spotted with gasoline, dry-cleaning solvents, vegetable or cooking oil, or other flammable or explosive substances, as they give off vapors that could ignite or explode.
- Do not add gasoline, dry cleaning solvents, or other flammable or explosive substances to the wash water. These substances give off vapors that could ignite or explode.
- In the event of a gas leak (propane gas, LP gas, etc.), do not operate this or any other appliance. Open a window or door to ventilate the area immediately.
- Do not tamper with controls.
- Fix the drain hose securely in place to avoid flooding.
- Do not abuse, sit on, or stand on the door of the appliance.
- Always check the inside of the appliance for foreign objects.
- Do not allow water, bleach or other liquids to sit in the drum for extended periods. Doing so can corrode the drum or cause mildew or odors.
- Do not dry unwashed items in the appliance.
- Do not use replacement parts that have not been recommended by the manufacturer (e.g. parts made at home using a 3D printer).

## Maintenance

- Do not repair or replace any part of the appliance. All repairs and servicing must be performed by qualified service personnel unless specifically recommended in this owner's manual. Use only authorized factory parts.
- Disconnect this appliance from the power supply before cleaning and attempting any user maintenance. Turning the controls to the OFF position does not disconnect this appliance from the power supply.
- Remove any dust or foreign matter from the power plug pins.
- Do not disassemble or repair the appliance by yourself.
- Remove the door before the appliance is removed from service or discarded to avoid the danger of children or small animals getting trapped inside.
- Make sure the dispenser drawer or lid is closed at all times when not being filled with laundry products.

## Grounding Instructions

- Improper connection of the equipment-grounding conductor can result in a risk of electric shock. Check with a qualified electrician or service personnel if you are in doubt whether the appliance is properly grounded. Do not modify the plug provided with the appliance; if it will not fit the outlet, have a proper outlet installed by a qualified electrician.
- The appliance must be grounded. In the event of a malfunction or breakdown, grounding will reduce the risk of electric shock by providing a path of least resistance for electric current. The appliance is equipped with a cord having an equipment-grounding conductor and a grounding plug. The plug must be plugged into an appropriate outlet that is installed and grounded in accordance with all local codes and ordinances.

## CAUTION STATEMENTS

---

### CAUTION

- To reduce the risk of minor or moderate injury to persons, malfunction, or damage to the product or property when using this product, follow basic precautions, including the following:
- 

### Installation

- Install the product on a firm and level floor.

### Operation

- Do not place objects on top of the appliance.
- Turn off the water faucets and unplug the appliance if the appliance is to be left for an extended period of time, such as during vacations.
- ALWAYS follow the fabric care instructions supplied by the garment manufacturer.
- Use fabric softeners or products to eliminate static only as recommended by the manufacturer.
- Do not combine laundry products for use in one load unless specified on the label.
- Do not touch draining water which may be hot.
- If the drain hose and the water inlet hose are frozen in winter, defrost them before using the appliance.
- Do not store or spill liquid detergents, cleaners, or bleaches (chlorine bleach, oxygen bleach) on the appliance. Doing so may result in corrosion, discoloration or damage to the surface of the appliance.
- Clothing or articles that are waterproof or water-resistant must be washed in the **Waterproof, Bedding, Bulky/Large, or Jumbo Wash** cycle only. (Examples include water resistant clothing, mattress covers, outdoor clothes, and plastic mats.) Failure to do so may result in personal injury or damage to the washer, clothes, walls, floor, and surrounding objects due to abnormal vibration.

**SAVE THESE INSTRUCTIONS**

# PRODUCT OVERVIEW

## Product Features

The images in this guide may be different from the actual components and accessories, which are subject to change by the manufacturer without prior notice for product improvement purposes.

### **⚠ WARNING**

- For your safety and for extended product life, use only authorized components. The manufacturer is not responsible for product malfunction, property damage or bodily injury caused by the use of separately purchased unauthorized components, parts, or non-LG products.

**Front View**

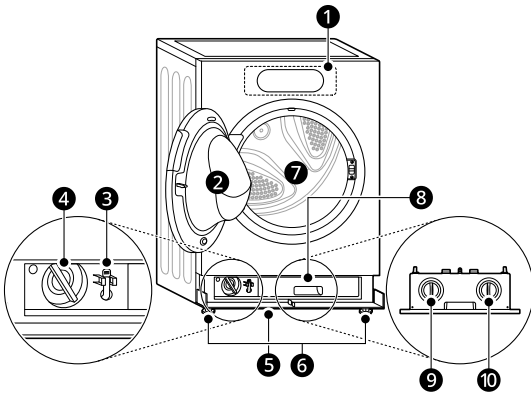

- ❶ Control Panel
- ❷ Door
- ❸ Drain Hose
- ❹ Drain Pump Filter
- ❺ Lower Cover (Push Type)
- ❻ Leveling Feet
- ❼ Drum
- ❽ Auto Dispense tray
- ❾ Liquid detergent dispenser
- ❿ Liquid softener dispenser

**Rear View**

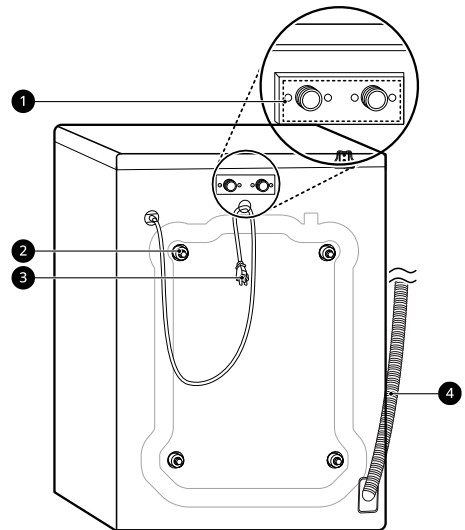

- ❶ Water Inlets
- ❷ Shipping Bolts
- ❸ Power Cord
- ❹ Drain Hose

## Accessories

### Included Accessories

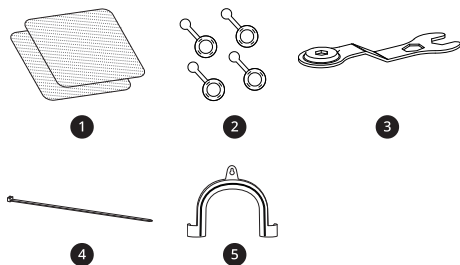

- ❶ Non-skid Pads
- ❷ Hole Caps
- ❸ Wrench
- ❹ Tie Strap
- ❺ Elbow Bracket (for securing drain hose)

### Required Accessories (sold separately)

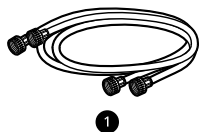

- ❶ Hot and Cold Water Hoses

### Optional Accessories (sold separately)

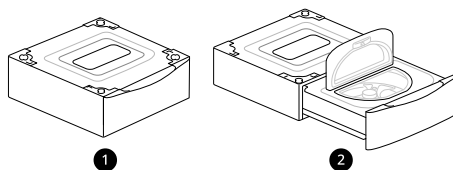

- ❶ Pedestal<sup>†</sup>
- ❷ Pedestal Washer<sup>†</sup>

<sup>†</sup> Check the width of the pedestal before purchasing to make sure that it matches the width of your appliance (27" (70 cm) or 29" (74 cm)).

## Product Specifications

| Model                               | WM9900H*A / WM9901H*A                                |
|-------------------------------------|--|
| Electrical Requirements             | 120 V~, 60 Hz  |
| Min. / Max. Water Pressure          | 20 psi - 120 psi (138 kPa - 827 kPa)                 |
| Dimensions (Width X Height X Depth) | 29" X 40 3/4" X 31 1/8" (73.7 cm X 103.5 cm X 79 cm) |
| Maximum Depth with Door Open        | 54 5/16" (137.9 cm)                                  |
| Net Weight                          | 217 lb (98.5 kg)                                     |
| Max. Spin Speed                     | 1300 RPM   |

# INSTALLATION

## Before Installing

### Installation Overview

Please read the following installation instructions first after purchasing this washer or transporting it to another location.

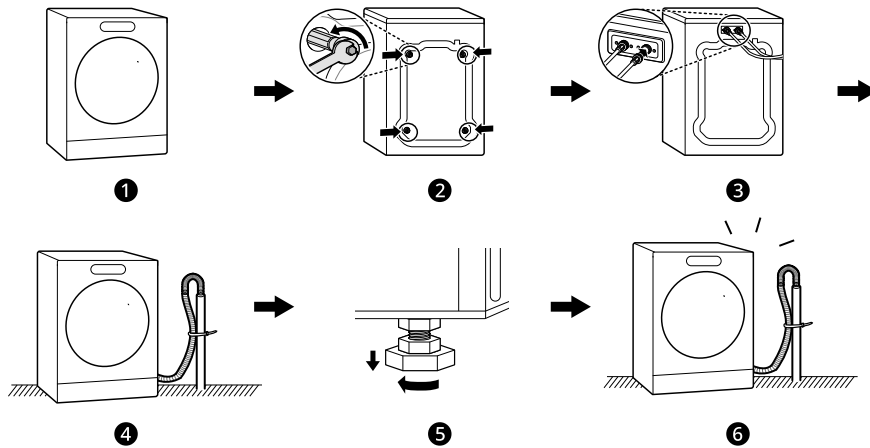

- ❶ Choosing the Proper Location
- ❷ Unpacking and Removing Shipping Material
- ❸ Connecting the Inlet Hoses
- ❹ Connecting the Drain Hose
- ❺ Leveling the Washer
- ❻ Final Installation Check

### **⚠ WARNING**

- Moving or installation of the appliance requires two or more people. Failure to follow these instructions may result in injury.
- Store and install the appliance where it will not be exposed to temperatures below freezing or exposed to outdoor weather conditions. Failure to follow this warning can cause product or part failure, serious injury, fire, electric shock, or death.
- Properly ground the washer to conform with all governing codes and ordinances. Failure to follow this warning can cause serious injury, fire, electric shock, or death.
- To ensure proper airflow, do not block the large opening on the bottom of the washer with carpeting or other materials.
- Do not remove the ground prong from the power cord. Do not use an adapter or extension cord. Plug into a grounded 3-prong outlet. Failure to follow this warning can cause serious injury, fire, electric shock, or death.
- Certain internal parts are intentionally not grounded and may present a risk of electric shock only during servicing. Service personnel- Do not contact the following parts while the appliance is energized: pump, valve, motor, control board.

## Tools Needed

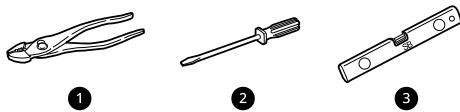

- ❶ Pliers
- ❷ Flat-Blade Screwdriver
- ❸ Level

## Choosing the Proper Location

Check the following requirements for the install location before installing the washer.

- Allow for sufficient space between the walls and the washer for installation.
- Make sure that the floor is clean, dry and free of dust, dirt, water and oil so the leveling feet cannot slide easily. Leveling feet that can move or slide on the floor can contribute to excess vibration and noise.
- If the floor has too much flex, reinforce it to make it more rigid. If the floor is not solid, it may cause severe vibration and noise.
- If a drain pan must be used, take extra care to follow the instructions provided with the drain pan and make sure the leveling feet are adjusted for firm and even contact with the pan. Use of drain pans and failure to properly level the washer may result in increased vibration and noise during operation.

## Power Outlet

- The power outlet must be within **60 inches (1.5 m)** of either side of the washer.
- Position the washer so that the outlet and plug are easily accessible.
- Do not overload the outlet with more than one appliance.
- The outlet must be grounded in accordance with current electrical wiring codes and regulations.
- Use a time-delay fuse or circuit breaker.
- It is the personal responsibility and obligation of the washer owner to have a proper outlet installed by a qualified electrician.

## Flooring

- To minimize noise and vibration, install the washer on a level, solidly constructed floor

capable of supporting the washer without flexing or bouncing.

- The washer must be installed on firm flooring to minimize vibration during the spin cycle. Concrete flooring is best, but a wood floor is sufficient, provided it is built to FHA standards.
- The floor under the washer must not slope more than 1 inch (2.5 cm) from front to back or side to side.
- Installing on carpeting and soft tile surfaces is not recommended.
- Never install the washer on a platform or weakly supported structure.

## Floor Installation

To ensure sufficient clearance for water inlet hoses, drain hose and airflow, allow minimum clearances of at least **1 inch (2.5 cm)** at the sides and **4 inches (10 cm)** behind the washer. Be sure to allow for wall, door, or floor moldings that may increase the required clearances.

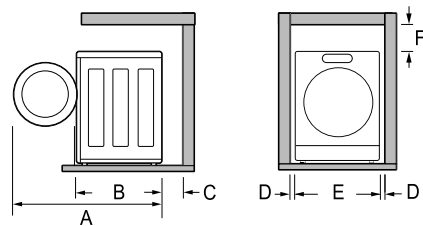

| Dimensions and Clearances |                   |
|---------------------------|-------------------|
| A                         | 54 5/16" (138 cm) |
| B                         | 31 1/8" (79 cm)   |
| C                         | 4" (10 cm)        |
| D                         | 1" (2.5 cm)       |
| E                         | 29" (73.7 cm)     |
| F                         | 1/4" (0.5 cm)     |

### Stacking or Pedestal Installation

The washer can be stacked on top of a pedestal or pedestal washer.

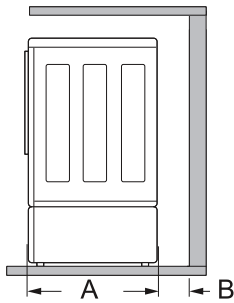

| Dimensions and Clearances |                   |
|---------------------------|-------------------|
| A                         | 32 7/8" (83.5 cm) |
| B                         | 4" (10 cm)        |

#### NOTE

- Refer to the instructions packaged with the optional pedestal kit before stacking the appliance on a pedestal.
- Do not use a drain pan with a pedestal or pedestal washer installation as it can block the drawer. Using a drain pan may result in increased vibration and noise during operation.

## Unpacking and Removing Shipping Material

Remove all shipping materials from the washer for proper operation and inspect it for shipping damage.

#### CAUTION

- Failure to remove shipping materials can cause excessive noise and vibration.

### Unpacking Shipping Material

\*Some models do not ship with drum support.

Lift the washer off the foam base.

- After removing the carton and shipping material, lift the washer off the foam base.
- Make sure the plastic drum support ①\* comes off with the base and is not stuck to the bottom of the washer.
- If you must lay the washer down to remove the carton base ②, always protect the side of the

washer and lay it carefully on its side. Do not lay the washer on its front or back.

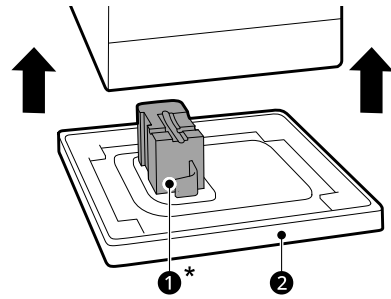

### Removing Shipping Material

1 Remove the bolt assemblies.

- Starting with the bottom two shipping bolts ③, use the included wrench to fully loosen all 4 shipping bolts by turning them counterclockwise.
- Remove the bolt assemblies (bolts and retainers) by wiggling them slightly while pulling them out.

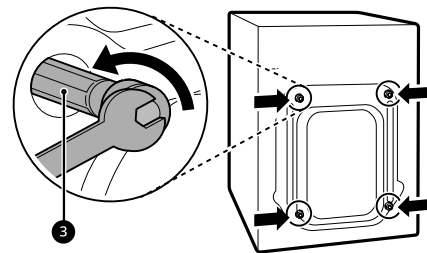

#### NOTE

- All 4 bolt assemblies must be completely removed from the unit to avoid product damage.
- Make sure to remove the entire bolt assembly, including:
  - metal bolt and washer
  - rubber damper
  - plastic rod

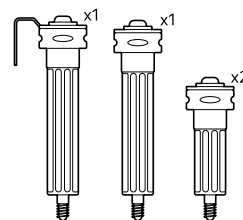

## 2 Install the hole caps.

- Locate the hole caps ④ included in the accessory pack or attached to the back of the washer. Install the caps in the holes left by the bolt assemblies.

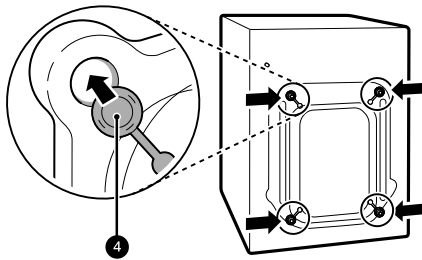

### ⚠ CAUTION

- Once removed, save the bolt assemblies for future use. To prevent damage to internal components, do not transport the washer without reinstalling the shipping bolts. Failure to remove shipping bolts and retainers may cause severe vibration and noise, which can lead to permanent damage to the washer.

### NOTE

- The power cord is secured to the back of the washer with a shipping bolt to help prevent operation with shipping bolts in place.

## Connecting the Water Inlet Hoses

To avoid the risk of costly water damage, purchase and install new water inlet hoses when installing the washer.

### ⚠ WARNING

- Do not overtighten the hoses or cross-thread the hose fittings. Overtightening or cross-threading can damage the valves or couplings, resulting in leaking and property damage.
- Do not reuse old hoses. Use only new hoses when installing the washer. Old hoses could leak or burst causing flooding and property damage. Contact an LG Customer Information Center for assistance in buying hoses.

### NOTE

- Periodically check the hoses for cracks, leaks, and wear, and replace the hoses every five years.

- Do not stretch the water hoses intentionally, and make sure that they are not pinched, crushed or kinked by other objects.
- Water supply pressure must be between **20 psi** and **120 psi (138 - 827 kPa)**. If the water supply pressure is more than **120 psi**, a pressure reducing valve must be installed.
- Your hot water heater should be set to deliver water at **120–135 °F (48–57 °C)** to allow the washer to properly control wash temperatures.
- If your water supply contains a lot of debris, a whole home water filter may help to remove the debris from the water before it reaches the washer inlets.
- Do not store or install the washer in a location subject to freezing temperatures. Damage to the water inlet hoses and internal mechanisms of the washer can result. If the washer was exposed to freezing temperatures prior to installation, allow it to stand at room temperature for several hours before use and check for leaks prior to operation.
- Do not use flood-preventing hoses with auto shut off devices. The devices can be tripped during fill and prevent the washer from filling properly.

## How to Connect the Water Inlet Hoses

- 1 Check the fittings and seals. Inspect the threaded fitting on each hose and make sure there is a rubber seal ① in place in both ends of each hose to prevent leaking.

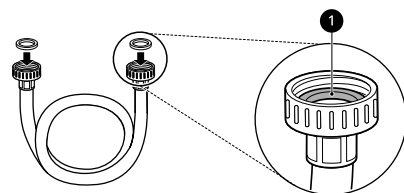

- 2 Connect the water supply hoses.
  - Connect the water inlet hoses to the hot and cold water faucets tightly by hand and then tighten another 2/3 turn with pliers.
  - Connect the blue hose to the cold water faucet and the red hose to the hot water faucet.

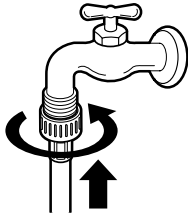

**3** Flush out the inlet hoses.

- After the hoses are connected, turn on the water faucets and flush out any foreign substances such as dirt, sand, or sawdust. Foreign substances can damage washer inlets and lead to leakage.
- Let the water drain into a bucket, and check the water temperature to make sure you've connected the hoses to the correct faucets.



**4** Attach the inlet hoses to the back of the washer.

- Attach the hot water inlet hose to the hot water inlet on the back of the washer. Attach the cold water inlet hose to the cold water inlet on the back of the washer.
- Tighten the fittings securely. Turn on both faucets all the way and check for leaks at both ends of the hoses.

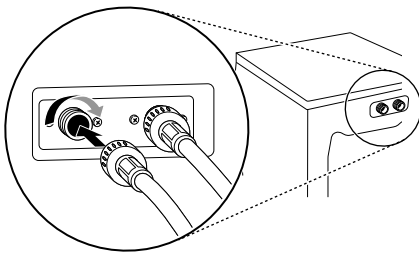

**Connecting the Drain Hose**

Connect the drain hose to either a standpipe or laundry tub.

**⚠ WARNING**

- The drain hose should always be properly secured. Failure to properly secure the drain

hose can result in flooding and property damage.

**NOTE**

- The drain must be installed in accordance with any applicable local codes and regulations.
- Make sure that the drain hose is not stretched, pinched, crushed, or kinked.
- The end of the drain hose should be located a minimum of **24" (61 cm)** and a maximum of **96" (244 cm)** above the bottom of the washer.
- For best results, locate the end of the drain hose no higher than **66" (168 cm)** above the bottom of the appliance. As the drain outlet is raised beyond **66" (168 cm)**, the drain function will be increasingly affected during washing.
- Never create an airtight seal between the hose and the drain with tape or other means. If no air gap is present, water can be siphoned out of the drum resulting in poor wash/rinse performance or clothing damage.

**Using a Standpipe to Drain**

**1** Clip the end of the hose into the elbow bracket.

- Connect the elbow bracket **1** within **4 inches (10 cm)** of the end of the drain hose. If the drain hose is extended more than **4 inches (10 cm)** beyond the end of the elbow bracket, mold or microorganisms could spread to the inside of the washer.

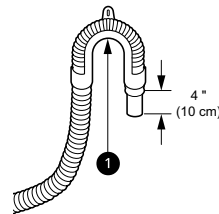

**2** Insert the end of the drain hose into the standpipe.

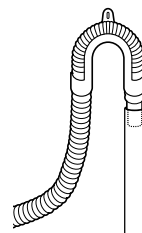

## 14 INSTALLATION

- 3** Use the provided tie strap **2** to secure the drain hose in place.

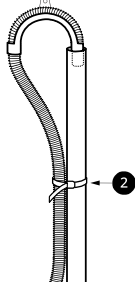

- 4** If the water valves and drain are built into the wall, fasten the drain hose to one of the water hoses with the provided tie strap **3** (ribbed side on inside).

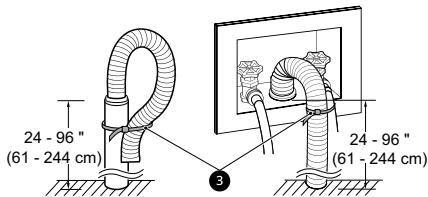

### Using the Laundry Tub to Drain

- 1** Clip the end of the hose into the elbow bracket.
- Connect the elbow bracket **1** within **4 inches (10 cm)** of the end of the drain hose. If the drain hose is extended more than **4 inches (10 cm)** beyond the end of the elbow bracket, mold or microorganisms could spread to the inside of the washer.

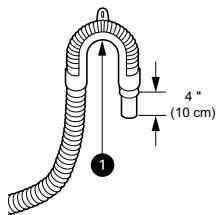

- 2** Hang the end of the drain hose over the side of the laundry tub.

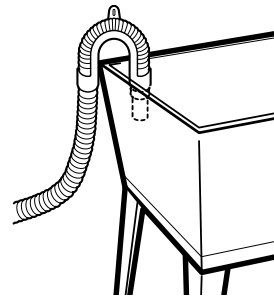

- 3** Use the provided tie strap to secure the drain hose in place.

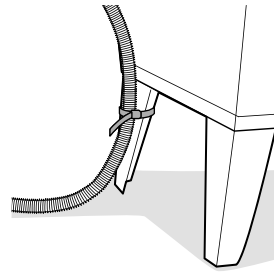

### Leveling the Washer

The drum of the washer spins at very high speeds. To minimize vibration, noise, and unwanted movement, the floor must be a solid, level surface.

#### **CAUTION**

- Using the washer without leveling it may cause excess vibration and noise, leading to a washer malfunction.
- Adjust the leveling feet only as far as necessary to level the washer. Extending the leveling feet more than necessary can cause the washer to vibrate.

#### **NOTE**

- Before installing the washer, make sure that the floor is clean, dry and free of dust, dirt, water and oil so the washer feet cannot slide easily. Feet that move or slide on the floor can contribute to excessive vibration and noise.

### How to Level the Washer

- 1** Position the washer in its final location.
- Take special care not to pinch, strain, or crush the water and drain hoses. If you have a carpenter's level **1**, you can use it to check that the washer is level. The slope

beneath the washer should not exceed **1 inch**, and all 4 leveling feet must rest firmly on the floor.

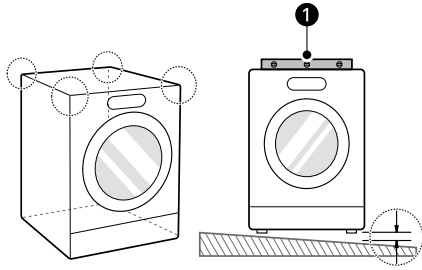

**2** Adjust the leveling feet.

- Turn all 4 leveling feet in one direction to raise the washer or the other direction to lower it.

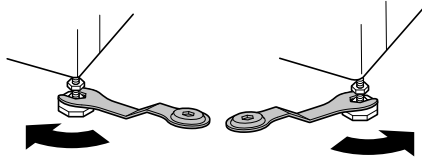

**3** Check the level again.

- Push or rock the top edges of the washer gently to make sure the washer does not rock. If the washer rocks, readjust the leveling feet.

**4** Tighten the locknuts **2**

- Turn the locknuts counterclockwise and tighten them when the washer is level.

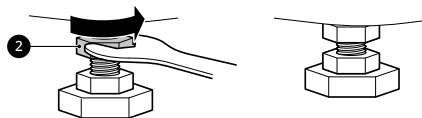

**Using Non-Skid Pads**

If you install the washer on a slippery surface, it may move because of excessive vibration. Incorrect leveling may cause malfunction through noise and vibration. If this occurs, install the non-skid pads under the leveling feet and adjust the level.

- 1** Clean the floor to attach the non-skid pads.
  - Use a dry rag to remove and clean foreign objects or moisture. If moisture remains, the non-skid pads may slip.
- 2** Adjust the level after placing the washer in the installation area.
- 3** Place the adhesive side **3** of the non-skid pad on the floor.
  - It is most effective to install the non-skid pads under the front leveling feet. If it is hard to place the pads under the front leveling feet, place them under the back leveling feet.

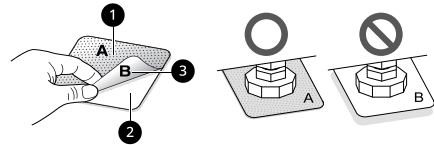

- 1** This side up
- 2** Remove backing

**4** Recheck the washer's levelness.

- Push or rock the top edges of the washer gently to make sure the washer does not rock. If the washer rocks, level the washer again.

**Final Installation Check**

**Connecting to the Power Supply**

Plug the washer into a **120 V, 60 Hz** grounded 3-prong outlet.

**! WARNING**

- Do not use a worn or damaged power cord or power plug. Replace or repair it immediately. Failure to do so may result in death, fire, electric shock, or malfunction.
- Do not modify the power cord and plug provided with the appliance. Do not damage it when installing or moving the appliance. Doing so may result in death, fire, electric shock, or malfunction.
- Make sure that the appliance is grounded.

### **WARNING**

- Connect this appliance to a grounded outlet conforming to the rating prior to use. Failure to do so may result in fire, electric shock, or malfunction.
  - Do not damage or cut off the ground prong of the power cord. Doing so may cause death, fire, electric shock, or product malfunction.
  - Improper connection of the equipment grounding conductor can result in risk of electric shock. Check with a qualified electrician or service technician if you are in doubt as to whether the appliance is properly grounded. If the plug does not fit the outlet, have a proper outlet installed by a qualified electrician.
  - The appliance and outlet must be positioned so that the plug is easily accessible.
  - Do not use an adapter or extension cord. Doing so may result in serious injury, fire, electric shock, or death.
  - For best performance, plug the appliance into its own individual outlet. This helps prevent overloading house wiring circuits which could cause a fire hazard from overheated wires.
  - If necessary, use a new, UL-listed extension cord with a 3-prong (grounding) plug rated at no less than the branch circuit. Do not use an extension cord longer than 3 feet. Failure to follow these warnings may result in serious injury, fire, electric shock, or death.
- 

### **NOTE**

- If water leaks during water supply, see **Connecting the Water Inlet Hoses** to connect them properly.
  - If the washer rocks and vibrates excessively, see **Leveling the Washer** to level it again.
  - If the drain does not work, see **Connecting the Drain Hose** to install the hose properly.
- 

## Testing the Washer

Check if the washer is properly installed and run a test cycle.

- 1** Load the washer with 6 thick bath towels (approximately 6 pounds).
- 2** Press the **Power** button.
- 3** Select the **Quick Wash** cycle.
- 4** Press the **Start/Pause** button to start the wash cycle.
- 5** Make sure that water is supplied, that the washer does not rock or vibrate excessively, and that it drains well during the spin cycle.

# OPERATION

## Before Use

### WARNING

- To reduce the risk of fire, electric shock, or injury to persons, read the SAFETY INSTRUCTIONS before operating this appliance.

## Operation Overview

- 1** Sort laundry and load the washer.
  - Sort laundry by fabric type, soil level, color and load size as needed. Open the door and load items into the washer.
  - If using single-use detergent packs, or gel or tablet detergents, place them in the drum before loading the laundry.
  - If a load weighs more than 22 lb (10kg), it may take a few seconds after the washer boots up to finish detecting the load weight.
- 2** Add cleaning products.
  - Fill the larger **ezDispense** reservoir with **HE (High-Efficiency)** liquid detergent. Fill the smaller reservoir with liquid fabric softener, if desired.
  - If using a powder detergent, open the door and add it directly inside the drum.
  - If needed, chlorine bleach packs can be placed directly in the drum. (Use only with warm or hot water temperatures with white garments.)
- 3** Turn on the washer.
  - Press the **Power** button to turn on the washer.
- 4** Select a cycle.
  - Swipe to view and select the desired cycle in the **Cycle** Select Screen, or press the **Cycle View** button to see a list of cycles.
  - Press the wash cycle in the center of the display to show the preset wash temperature, spin speed, soil level and option settings for the selected cycle.
  - Pressing the **Start/Pause** button without selecting a cycle immediately starts the **Normal** cycle with the default settings.
- 5** Adjust settings.
  - Default settings for the selected cycle can be changed, if desired, by pressing on the cycle in the center of the display and then pressing on the cycle modifier or option buttons.
  - Not all modifiers and options are available on all cycles. A different chime sounds and the indicator does not change if the selection is not allowed.
- 6** Begin cycle.
  - Press the **Start/Pause** button to begin the cycle. The door locks, and the washer agitates briefly without water to measure the weight of the load.

## 18 OPERATION

---

- If the **Start/Pause** button is not pressed within a certain time, the washer shuts off and all settings are lost.

### 7 End of cycle.

- When the cycle is finished, a melody sounds. Immediately remove the clothing from the washer to reduce wrinkling.
- Check around the door seal when removing the load for small items that may be caught in the seal.

---

#### NOTE

- The washer rotates the laundry in a way that allows it to use less water while still fully saturating the clothing. It is normal to be unable to see water during the wash cycle.
  - If the temperature or the water level inside the machine is too high, the door will not unlock when the **Start/Pause** button is pressed, and the **Add Garments** function will not be available (on applicable models). To stop a cycle and drain the water completely, turn the power off, then on, and then select **Quick Wash**.
- 

## Sorting Laundry

### Grouping Similar Items

For the best washing results, and to reduce the possibility of damage to clothing, sort clothing into loads made up of similar items.

Mixing different fabric types and/or soil levels can result in poor wash performance, color transfer, discoloration, fabric damage or linting. Fabrics should be sorted into groups as described below.

#### Colors

Sort articles by color. Wash dark clothes separately from light colors or whites. Mixing dark clothes with light clothes can result in dye transfer or discoloration of the lighter clothes.

#### Soil Level

Wash heavily soiled clothing together. Washing lightly soiled clothing in the same load with heavily soiled clothing could result in poor wash performance for the lightly soiled clothing.

#### Fabric Type

Delicate articles should not be mixed with heavy or sturdy fabric types. Washing heavy fabrics with delicates can result in poor wash performance for the heavy fabrics and possible damage to the delicates.

#### Lint Type

Some fabrics attract and bind lint to them while others give off lint in the laundry process. Avoid mixing these lint collectors and lint producers in the same load. Mixing these fabrics will result in pilling and linting on the lint collectors. (For example, lint collector - knit sweater; lint producer - terry cloth towels.)

### How to Sort Laundry











| By Colors | By Soil | By Fabric | By Lint        |
|-----------|---------|-----------|----------------|
| White     | Heavy   | Delicates | Lint Producer  |
| Lights    | Normal  | Easy Care | Lint Collector |
| Darks     | Light   | Sturdy    |                |

**⚠ CAUTION**

- Clothing or articles that are waterproof or water-resistant must be washed in the **Waterproof, Bedding, Bulky/Large, or Jumbo Wash** cycle only. (Examples include water resistant clothing, mattress covers, outdoor clothes, and plastic mats.) Failure to do so may result in personal injury or damage to the washer, clothes, walls, floor, and surrounding objects due to abnormal vibration.
- Remove the stuffing from pillows and cushions before washing the covers. Failure to do so can cause excessive vibration, resulting in damage to the washer, clothes, nearby objects, walls, and floor.

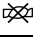
**Fabric Care Labels**

Many articles of clothing include a fabric care label. Using the chart below, adjust the cycle and option selections to care for your clothing according to the manufacturer's recommendations.

| Category  | Label   | Directions  |
|---|---|---|
| <br>Washing          |    | Hand wash   |
|   |    | Machine wash, Normal cycle  |
|   |    | Perm Press/Wrinkle Resistant setting (which has a cool down or cold spray before the slower spin) |
|   |    | Gentle/Delicate setting (slow agitation and/or reduced wash time)                                 |
|   |    | Do not wash   |
|   |    | Do not wring  |
| Water Temperature   | ...   | Hot   |
|   | ..  | Warm  |
|   | .   | Cold/Cool   |
| <br>Bleach Symbols |  | Any bleach (when needed)  |
|   |  | Only non-chlorine bleach (when needed)  |
|   |  | Do not bleach   |

**Loading the Washer**

- For best performance, load clothes as shown.

**General Tips**

- Check and empty pockets. Paper clips, coins, matches, and other items can damage clothing and the washer.
- Close zippers and hooks, and tie drawstrings to prevent snagging or tangling of clothes.
- Pretreat heavily stained areas for best results.
- Brush off heavy soil, dust, and hair from items before washing. Excess dirt or sand can abrade other fabrics and lead to poor wash performance.

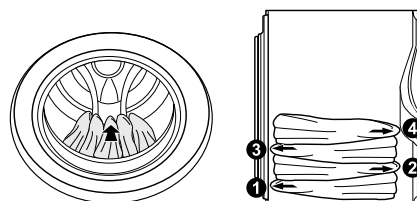

- Do not press down on items while stacking them in the drum.
- Load clothes loosely, and do not overfill the drum. Clothes need room to circulate in order to get clean.

## 20 OPERATION

- Combine large and small items in the drum. Load large items first. Large items should not be more than half of the total load.
- The washer can be fully loaded, but the drum should not be tightly packed with items. The door of the washer must close easily.
- The washer will not fill or operate with the door open.

### **⚠ CAUTION**

- Clothing or articles that are waterproof or water-resistant must be washed in the **Waterproof, Bedding, Bulky/Large, or Jumbo Wash** cycle only. (Examples include water resistant clothing, mattress covers, outdoor clothes, and plastic mats.) Failure to do so may result in personal injury or damage to the washer, clothes, walls, floor, and surrounding objects due to abnormal vibration.

### **Bulky Items**

- Wash thick, bulky items individually. Heavy blankets, comforters, bedspreads, or pet beds can get tangled or cause an unbalanced load if combined with other items.

### **Small Items**

- Do not wash a single small item. Add enough similar items to the load to prevent an out-of-balance load.
- Wash small, light items in a mesh bag. Small items can get caught in the impeller at the bottom of the drum, and brassiere hooks can snag on other clothing or the drum.

## **Adding Cleaning Products**

### **About Detergent Use**

This washer is designed for use with only HE (High-Efficiency) detergents.



- HE detergents produce fewer suds, dissolve more efficiently to improve washing and rinsing performance, and help to keep the interior of the washer clean. Using detergent that is not HE may cause oversudsing and unsatisfactory performance which could result in error codes, cycle failure, and washer damage.

- Detergents designated as HE-compatible may not provide optimal results.
- For proper wash performance, always measure detergent using the measuring device provided by the detergent manufacturer. For an average load, use less than half of the recommended maximum. Use less detergent for soft water, light soil, or smaller loads.
- Use extra care when measuring 2X and 3X concentrated detergents because even a small amount of extra detergent can lead to problems.
- Never use more than the maximum amount of detergent recommended by the manufacturer. Using too much detergent can lead to oversudsing, poor rinsing, detergent buildup in clothing, and residue buildup that can contribute to odors in the washer.
- Do not use more than one single-use detergent pack in the washer. Using too much detergent may cause oversudsing and unsatisfactory performance. Reduce detergent amount or add an extra rinse if detergent residue is left on fabrics. To add an extra rinse, select the **Extra Rinse** option.

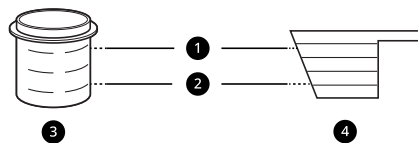

- ① Maximum fill line
- ② Average load fill line
- ③ Liquid detergent
- ④ Powdered detergent

### **Single-Use Detergent Packs / Gel or Tablet Detergents**

Place liquid or powdered detergent packs, or gel or tablet detergents in the drum before loading laundry. Do not place these detergents in the dispenser.

### **Using the Auto Dispense Function**

When the **Auto Detergent** and **Auto Softener** functions are turned on, detergent and softener are automatically dispensed at the appropriate time during the cycle.

- 1 Press the **O** mark to open the lower cover as shown below.

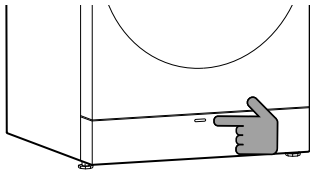

- 2** Press **PUSH** on the Auto Dispense tray as shown. Use the handle to pull the tray out.
- Do not use force when pulling out the Auto Dispense tray.

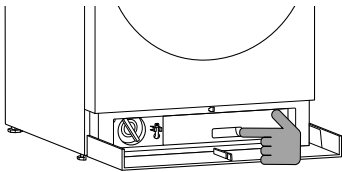

- 3** Turn the caps on the Auto Dispense tray to the left to open the two reservoirs.

- 4** Pour the detergent and softener into their respective reservoirs.
- The Auto Dispense tray has two reservoirs. Put the liquid detergent **1** into the left reservoir and the fabric softener **2** into the right reservoir.
  - Fill to the **Max** line.

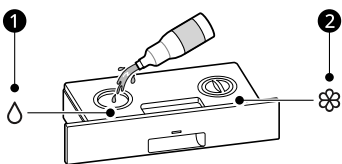

- 5** After filling, insert and turn the caps to the right until tightly closed.

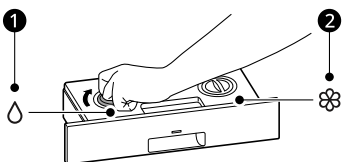

- 6** Insert the Auto Dispense tray until it clicks.

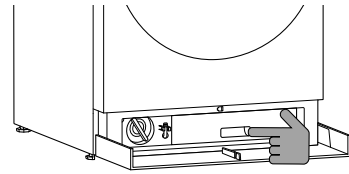

- 7** Close the lower cover.
- 8** Touch the Settings screen and select **Auto Detergent** and **Auto Softener** functions.

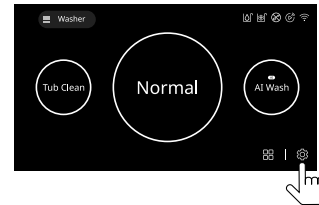

### ⚠ WARNING

- Do not mix chlorine bleach with ammonia or acids such as vinegar or rust/scale remover. Mixing chemicals like these can produce a lethal gas, resulting in severe injury or death.

### ⚠ CAUTION

- Do not place or store laundry products, such as detergent, bleach, or liquid fabric softener, on top of your washer. These products can damage the washer's finish and controls.
- Remove the Auto Dispense tray only when refilling or replacing detergent or softener.
- Use only liquid HE detergents in the Auto Dispense tray.
- Do not pour any powdered cleaning products into the Auto Dispense reservoirs.
- Do not put liquid bleach into the Auto Dispense tray or the collapsible manual dispenser. If needed, chlorine bleach packs can be placed directly in the drum. (Use only with warm or hot water temperatures with white garments.)
- The Auto Dispense function may not work properly with some concentrated gel detergents. Use the collapsible manual dispenser to dispense gel detergents.
- Do not mix detergent with fabric softener.
- Use care when removing and inserting the Auto Dispense tray, as detergent or fabric softener may spill. Wipe up any spills before proceeding.

### **⚠ CAUTION**

- To use the Auto Dispense function, **Auto Detergent** and/or **Auto Softener** must be turned on in the Settings screen.
- Detergent or fabric softener left in the Auto Dispense reservoirs for an extended period may harden and fail to dispense properly.
- The ventilation holes **3** help in dispensing the detergent and fabric softener. Do not hold the Auto Dispense tray upside down, as cleaning products may leak.

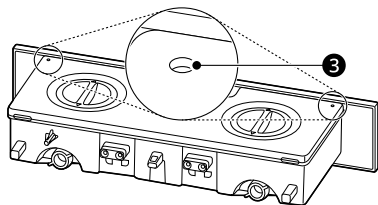

- Do not block the ventilation holes in the Auto Dispense tray.

---

### **NOTE**

- Before using the appliance, make sure there is detergent in the Auto Dispense reservoir.
  - A full detergent reservoir will last for about 18 standard cycles, with half a load of laundry in the drum.
  - The default settings are configured to automatically dispense 1.5 oz (45ml) of detergent and 2.0 oz (60ml) of softener for 9lb~10lb (4kg-4.5kg) of normally soiled laundry. This can be changed by pressing the **Settings** button and selecting **ezDispense**. The dispense amounts are relative to the set **Normal** amount, based on the soil level and type of laundry. The amount dispensed may vary depending on the amount of laundry and the cycle. For more details, see the **Settings** section of this manual.
  - To set the Auto Dispense amounts for 11lb (5kg), see the manufacturer's recommendations on the detergent or fabric softener.
  - Turn on the detergent/softener refill alarm to be notified when the reservoirs need to be refilled.
  - Remove any residual detergent on the outside of the Auto Dispense tray before inserting it.
  - To change detergents, follow the steps above or turn off the **Auto Detergent** function and use the included manual dispenser.
  - Do not use force when pulling out the Auto Dispense tray.
-

# Control Panel

## Control Panel Features

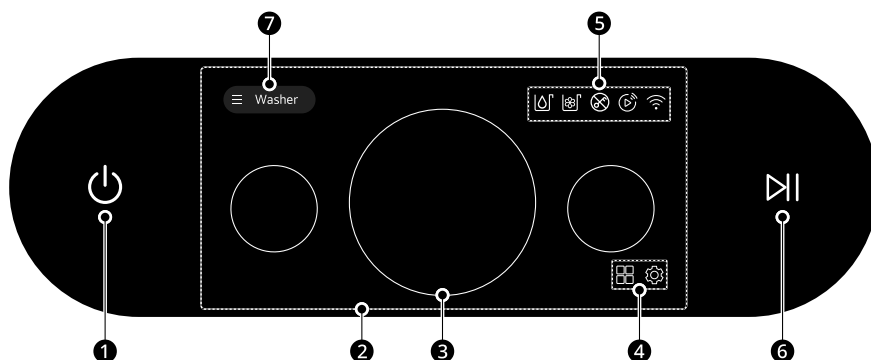

### 1 Power On/Off Button

- Press this button to turn the washer on or off.
- Pressing this button during a cycle will cancel that cycle and any load settings will be lost.
- The door will unlock after a brief pause.

### NOTE

- If there is any water remaining in the drum after the washer shuts off, it will drain after a delay. The washer can be restarted at any time before the drain begins. However, once the water begins to drain, all functions will be suspended until the water has been completely drained and the washer shuts off.

### 2 Status Display

- This LCD shows the settings, estimated time remaining, options, and status messages.

### 3 Cycle Select Screen

- Either swipe over the cycle name or touch the next cycle name to select a cycle.
- Once the desired cycle has been selected, the standard presets will appear in the display. These settings can be adjusted using the **Cycle Modifier buttons** at any time before starting the cycle.

### 4 Cycle View and Settings Buttons

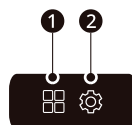

- This button 1 allows you to see a list of cycles.
- This button 2 allows you to select additional settings.

### 5 Indicators

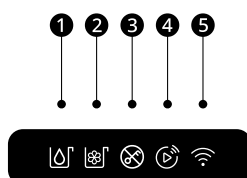

#### 1) Auto Detergent Indicator

- This indicator lights up when the **Auto Detergent** feature is activated.

## 24 OPERATION

---

### 2) **Auto Softener Indicator**

- This indicator lights up when the **Auto Softener** feature is activated.

### 3) **Door Lock Indicator**

- This indicator lights up when the cycle starts and the door is locked.
- The indicator light stays on until the cycle is paused, stopped or has finished.

### 4) **Remote Start Indicator**

- This indicator lights up when the **Remote Start** feature is activated.

### 5) **Wi-Fi Indicator**

- This indicator lights up when the product is connected to a home **Wi-Fi** network.

### 6) **Start/Pause Button**

- Press this button to start the selected cycle.
- If the washer is running, use this button to pause the cycle without losing the current settings.

---

### NOTE

- If the **Start/Pause** button is not pressed to start the selected cycle, after a delay the washer automatically turns off and all cycle settings are lost. Any water remaining in the drum will be drained.
- 

### 7) **Mode Change Button**

- Press this button to change between Washer / SideKick mode.
- In Washer mode, you can select main washer cycle.
- In SideKick mode, you can select the cycle on the pedestal washer control panel.

## Wash Cycles

The wash cycles are designed for specific types of wash loads. Select the cycle that best matches the load contents for maximum wash performance and fabric care. See **Sorting Laundry** section for best results, and follow the fabric care labels on your garments. For a guide to fabric care symbols, see **Sorting Laundry** section.

### Cycle Guide

Select the desired cycle. When you press the cycle name, the standard presets appear in the display.

#### NOTE

- Whenever load weights are mentioned, assume **1 lb (0.45 kg)** = 1 thick bath towel (dry).

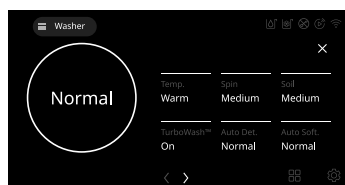

- Press the Temp button to show the available settings in the display: **Tap Cold**①, **Cold**②, **Warm**③, **Hot**④ or **Ex. Hot**
- Press the Spin button to show the available settings in the display: **No Spin**①, **Low**②, **Medium**③, **High**④ or **Ex. High**
- Press the Soil button to show the available settings in the display: **Light**, **Med. Light**, **Medium**, **Med. Heavy**, **Heavy**

### Default Cycles

| Cycle              | Normal  |   |
|--------------------|---|---|
| <b>Description</b> | Use to wash all normal items such as cotton, linen, shirts, jeans or mixed loads, except delicate fabrics such as wool or silk. <ul style="list-style-type: none"> <li>Pressing the <b>Start/Pause</b> button without selecting a cycle will cause the <b>Normal</b> cycle to begin immediately, using the default settings.</li> </ul> |   |
| <b>Wash Temp.</b>  | Default: <b>Warm</b>  | Available: All  |
| <b>Spin Speed</b>  | Default: <b>High</b>  | Available: <b>Ex. High</b> , <b>High</b> , <b>Medium</b> , <b>Low</b> |
| <b>Soil Level</b>  | Default: <b>Medium</b>  | Available: All  |

| Cycle              | AI Wash  |   |
|--------------------|--|---|
| <b>Description</b> | This cycle adjusts wash and rinse patterns automatically after detecting load size. <ul style="list-style-type: none"> <li>Detects the amount of laundry, and operates in a suitable washing motion if the load is 6 kg or lower.</li> <li>The washing motion, water temperature and number of rinse cycle may be changed to provide optimal washing suited to clothing characteristics.</li> <li>Wash time and number of rinse cycles may be changed by sensing contamination.</li> <li>Additional detergent may be dispensed depending on the degree of contamination by sensing contamination. (If automatic dispensing function is selected)</li> <li>The wash time may increase or decrease when the sensing information is reflected.</li> </ul> |   |
| <b>Wash Temp.</b>  | Default: <b>Warm</b>   | Available: <b>Warm</b> , <b>Cold</b> , <b>Tap Cold</b>                |
| <b>Spin Speed</b>  | Default: <b>High</b>   | Available: <b>Ex. High</b> , <b>High</b> , <b>Medium</b> , <b>Low</b> |
| <b>Soil Level</b>  | Default: <b>Medium</b>   | Available: <b>Medium</b>  |

| Cycle              | Bedding  |   |
|--------------------|--|---|
| <b>Description</b> | Suitable for washing blankets or bulky items which have difficulty absorbing water, such as pillows, blankets, comforters, sheets or pet bedding. <ul style="list-style-type: none"> <li>• Do not use this cycle to wash a mixed load of bedding and non-bedding items.</li> <li>• Do not mix large/bulky items with smaller articles of clothing.</li> <li>• Do not wash excessively large items. If large/bulky items do not fit easily into the tub, there may not be enough room for them to move during washing.</li> </ul> |   |
| <b>Wash Temp.</b>  | Default: <b>Warm</b>   | Available: <b>Hot, Warm, Cold, Tap Cold</b> |
| <b>Spin Speed</b>  | Default: <b>Medium</b>   | Available: <b>Medium, Low, No Spin</b>      |
| <b>Soil Level</b>  | Default: <b>Medium</b>   | Available: All                              |

| Cycle              | Delicates   |  |
|--------------------|---|--|
| <b>Description</b> | Suitable for washing dress shirts/blouses, nylons, lingerie, or sheer and lacy clothes which can easily be damaged. ( <b>less than 8 lb (3.63 kg)</b> ) |  |
| <b>Wash Temp.</b>  | Default: <b>Cold</b>  | Available: <b>Warm, Cold, Tap Cold</b> |
| <b>Spin Speed</b>  | Default: <b>Medium</b>  | Available: <b>Medium, Low, No Spin</b> |
| <b>Soil Level</b>  | Default: <b>Medium</b>  | Available: All                         |

| Cycle              | Towels  |   |
|--------------------|---|---|
| <b>Description</b> | Use this cycle for washing towels, shirts, jeans and mixed loads. |   |
| <b>Wash Temp.</b>  | Default: <b>Warm</b>  | Available: <b>Hot, Warm, Cold, Tap Cold</b> |
| <b>Spin Speed</b>  | Default: <b>Ex. High</b>  | Available: All                              |
| <b>Soil Level</b>  | Default: <b>Medium</b>  | Available: All                              |

| Cycle              | Quick Wash  |   |
|--------------------|---|---|
| <b>Description</b> | Quickly washes lightly soiled clothing and small loads. For high wash and rinse efficiency, wash small loads of 2-3 lightly soiled garments. ( <b>less than 3 lb (1.36 kg)</b> ) <ul style="list-style-type: none"> <li>• Use very little detergent in this cycle. To add an extra rinse, use the <b>Rinse</b> option.</li> </ul> |   |
| <b>Wash Temp.</b>  | Default: <b>Hot</b>   | Available: <b>Hot, Warm, Cold, Tap Cold</b> |
| <b>Spin Speed</b>  | Default: <b>Ex. High</b>  | Available: All                              |
| <b>Soil Level</b>  | Default: <b>Light</b>   | Available: All                              |

| Cycle              | Heavy Duty   |   |
|--------------------|--|---|
| <b>Description</b> | Suitable for washing heavily soiled laundry, such as cotton fabrics, using more powerful wash motions. <ul style="list-style-type: none"> <li>• When washing large loads, there will be brief periods of <b>2 minutes</b> or more without agitation. These soak periods are part of the cycle's design, and are normal.</li> </ul> |   |
| <b>Wash Temp.</b>  | Default: <b>Warm</b>   | Available: All                                |
| <b>Spin Speed</b>  | Default: <b>Ex. High</b>   | Available: <b>Ex. High, High, Medium, Low</b> |

| Cycle      | Heavy Duty            |                |
|------------|-----------------------|----------------|
| Soil Level | Default: <b>Heavy</b> | Available: All |

| Cycle       | Allergiene™   |                |
|-------------|---|----------------|
| Description | This is a powerful, high-temperature cycle designed specifically to reduce certain allergens.<br><br><b>NOTE</b>  |                |
|             | <ul style="list-style-type: none"> <li>• Selecting this cycle automatically incorporates steam into the wash cycle.</li> <li>• This cycle can significantly reduce allergens in bedding and clothing.</li> <li>• This cycle helps reduce dust mite populations and allergens. Due to the higher energy and temperatures used, this cycle is not recommended for wool, silk, leather, or any other delicate or temperature-sensitive items.</li> </ul> |                |
| Spin Speed  | Default: <b>High</b>  | Available: All |

| Cycle       | Perm. Press   |  |
|-------------|---|--|
| Description | Use this cycle to minimize wrinkles when washing tablecloths or “wrinkle-free” clothes. |  |
| Wash Temp.  | Default: <b>Warm</b>  | Available: <b>Hot, Warm, Cold, Tap Cold</b>  |
| Spin Speed  | Default: <b>Medium</b>  | Available: <b>High, Medium, Low, No Spin</b> |
| Soil Level  | Default: <b>Medium</b>  | Available: All                               |

## Non-Default Cycles

Edit the list of wash cycles using the **Cycle List Edit** option to use these cycles.

| Cycle       | Bright Whites™  |   |
|-------------|---|---|
| Description | This cycle is for washing white items only. ( <b>less than 15 lb (6.8 kg)</b> ) |   |
| Wash Temp.  | Default: <b>Hot</b>   | Available: <b>Hot, Warm, Cold, Tap Cold</b> |
| Spin Speed  | Default: <b>High</b>  | Available: All                              |
| Soil Level  | Default: <b>Medium</b>  | Available: All                              |

| Cycle       | Sanitary   |                           |
|-------------|--|---------------------------|
| Description | Washes clothes using the extra hot wash temperature. |                           |
| Wash Temp.  | Default: <b>Ex. Hot</b>                              | Available: <b>Ex. Hot</b> |
| Spin Speed  | Default: <b>High</b>                                 | Available: All            |
| Soil Level  | Default: <b>Medium</b>                               | Available: All            |

| Cycle       | Tub Clean   |  |
|-------------|---|--|
| Description | This is a special cycle designed to clean the inside of the washer. |  |

| Cycle              | Rinse+Spin  |                        |
|--------------------|---|------------------------|
| <b>Description</b> | Select this cycle to rinse and spin a load separately from a regular cycle. <ul style="list-style-type: none"> <li>• This can be helpful in preventing fresh stains from setting in fabrics.</li> <li>• Change the spin speed by repeatedly pressing the <b>Spin</b> button after selecting the cycle.</li> </ul> |                        |
| <b>Wash Temp.</b>  | Default: <b>Cold</b>  | Available: <b>Cold</b> |
| <b>Spin Speed</b>  | Default: <b>High</b>  | Available: All         |

| Cycle              | Spin Only   |                |
|--------------------|---|----------------|
| <b>Description</b> | This cycle drains and spins the load without washing or rinsing it. |                |
| <b>Spin Speed</b>  | Default: <b>High</b>  | Available: All |

| Cycle              | Hand/Wool   |   |
|--------------------|---|---|
| <b>Description</b> | Washes delicate hand-washable and machine-washable clothes such as washable wool, lingerie, dresses etc. <ul style="list-style-type: none"> <li>• Use detergent designed for machine washable woolens.</li> </ul> |   |
| <b>Wash Temp.</b>  | Default: <b>Warm</b>  | Available: <b>Warm, Cold, Tap Cold</b>      |
| <b>Spin Speed</b>  | Default: <b>Low</b>   | Available: <b>Low, No Spin</b>              |
| <b>Soil Level</b>  | Default: <b>Medium</b>  | Available: <b>Medium, Med. Light, Light</b> |

| Cycle              | Activewear   |  |
|--------------------|--|--|
| <b>Description</b> | Washes special garments like sports and outdoor wear. <ul style="list-style-type: none"> <li>• Use for clothing treated with a water-repellent coating.</li> </ul> |  |
| <b>Wash Temp.</b>  | Default: <b>Warm</b>   | Available: <b>Warm, Cold, Tap Cold</b> |
| <b>Spin Speed</b>  | Default: <b>Medium</b>   | Available: <b>Medium, Low, No Spin</b> |
| <b>Soil Level</b>  | Default: <b>Medium</b>   | Available: All                         |

| Cycle              | Swimwear   |   |
|--------------------|--|---|
| <b>Description</b> | Removes chlorine or salt from swimwear with delicate care. |   |
| <b>Wash Temp.</b>  | Default: <b>Cold</b>                                       | Available: <b>Warm, Cold, Tap Cold</b>      |
| <b>Spin Speed</b>  | Default: <b>Medium</b>                                     | Available: <b>Medium, Low, No Spin</b>      |
| <b>Soil Level</b>  | Default: <b>Light</b>                                      | Available: <b>Medium, Med. Light, Light</b> |

| Cycle              | Kids Wear   |   |
|--------------------|---|---|
| <b>Description</b> | Washes children's heavily soiled clothes using a high wash temperature. |   |
| <b>Wash Temp.</b>  | Default: <b>Hot</b>   | Available: <b>Hot, Warm, Cold, Tap Cold</b> |
| <b>Spin Speed</b>  | Default: <b>High</b>  | Available: All                              |
| <b>Soil Level</b>  | Default: <b>Heavy</b>   | Available: All                              |

| Cycle              | Jeans  |   |
|--------------------|--|---|
| <b>Description</b> | This cycle is designed specifically for jeans. |   |
| <b>Wash Temp.</b>  | Default: <b>Cold</b>                           | Available: <b>Hot, Warm, Cold, Tap Cold</b>   |
| <b>Spin Speed</b>  | Default: <b>High</b>                           | Available: <b>Ex. High, High, Medium, Low</b> |
| <b>Soil Level</b>  | Default: <b>Medium</b>                         | Available: All                                |

| Cycle              | Dresses                                 |  |
|--------------------|---|--|
| <b>Description</b> | Washes lightly soiled cocktail dresses. |  |
| <b>Wash Temp.</b>  | Default: <b>Cold</b>                    | Available: <b>Warm, Cold, Tap Cold</b> |
| <b>Spin Speed</b>  | Default: <b>Low</b>                     | Available: <b>Medium, Low, No Spin</b> |
| <b>Soil Level</b>  | Default: <b>Light</b>                   | Available: All                         |

| Cycle              | Color Care                                   |   |
|--------------------|--|---|
| <b>Description</b> | This cycle helps to keep colors from fading. |   |
| <b>Wash Temp.</b>  | Default: <b>Cold</b>                         | Available: <b>Warm, Cold, Tap Cold</b>        |
| <b>Spin Speed</b>  | Default: <b>Medium</b>                       | Available: <b>Ex. High, High, Medium, Low</b> |
| <b>Soil Level</b>  | Default: <b>Medium</b>                       | Available: All                                |

| Cycle              | Sweat Stains                        |   |
|--------------------|-------------------------------------|---|
| <b>Description</b> | Helps remove sweat stains and odor. |   |
| <b>Wash Temp.</b>  | Default: <b>Warm</b>                | Available: All                                |
| <b>Spin Speed</b>  | Default: <b>High</b>                | Available: <b>Ex. High, High, Medium, Low</b> |
| <b>Soil Level</b>  | Default: <b>Light</b>               | Available: All                                |

| Cycle              | Small Load                                       |   |
|--------------------|--|---|
| <b>Description</b> | Washes a small load of laundry (less than 3 lb). |   |
| <b>Wash Temp.</b>  | Default: <b>Warm</b>                             | Available: <b>Hot, Warm, Cold, Tap Cold</b> |
| <b>Spin Speed</b>  | Default: <b>High</b>                             | Available: All                              |
| <b>Soil Level</b>  | Default: <b>Medium</b>                           | Available: All                              |

| Cycle              | Large Load   |   |
|--------------------|--|---|
| <b>Description</b> | Optimized wash settings for half-sized wash loads. |   |
| <b>Wash Temp.</b>  | Default: <b>Warm</b>                               | Available: All                                |
| <b>Spin Speed</b>  | Default: <b>High</b>                               | Available: <b>Ex. High, High, Medium, Low</b> |
| <b>Soil Level</b>  | Default: <b>Medium</b>                             | Available: All                                |

| Cycle              | XL Load  |   |
|--------------------|--|---|
| <b>Description</b> | Optimized wash settings for full-sized wash loads. |   |
| <b>Wash Temp.</b>  | Default: <b>Warm</b>                               | Available: All                                |
| <b>Spin Speed</b>  | Default: <b>High</b>                               | Available: <b>Ex. High, High, Medium, Low</b> |
| <b>Soil Level</b>  | Default: <b>Heavy</b>                              | Available: All                                |

| Cycle              | Overnight Wash  |   |
|--------------------|---|---|
| <b>Description</b> | Reduces washing noise and continues tumbling after the cycle to prevent wrinkles. |   |
| <b>Wash Temp.</b>  | Default: <b>Warm</b>  | Available: All                                |
| <b>Spin Speed</b>  | Default: <b>Low</b>   | Available: <b>Ex. High, High, Medium, Low</b> |
| <b>Soil Level</b>  | Default: <b>Medium</b>  | Available: All                                |

## Available Options

† This option is automatically included in the cycle and cannot be deselected.

### NOTE

- **Delay Start** can be selected for every cycle in this table.
- **Steam** and **Cold Wash™** cannot be selected at the same time.
- If the **TurboWash™** option is on, you cannot select **No Spin** as your **Spin**.

| Cycle         | Soil Level | Extra Rinse | Spin | Wash Temp | Steam | Turbo Wash | Pre-wash | Cold Wash | Fresh Care |
|---------------|------------|-------------|------|-----------|-------|------------|----------|-----------|------------|
| Normal        | ●          | ●           | ●    | ●         | ●     | ●†         | ●        | ●         | ●          |
| AI Wash       |            | ●           | ●    | ●         |       | ●†         |          |           | ●          |
| Bedding       | ●          | ●           | ●    | ●         | ●     | ●          | ●        | ●         | ●          |
| Delicates     | ●          | ●           | ●    | ●         |       |            | ●        | ●         | ●          |
| Towels        | ●          | ●           | ●    | ●         |       | ●          | ●        | ●         | ●          |
| Quick Wash    | ●          | ●           | ●    | ●         |       | ●          |          | ●         | ●          |
| Heavy Duty    | ●          | ●           | ●    | ●         | ●     | ●†         | ●        | ●         | ●          |
| Allergiene    |            | ●           | ●    |           | ●†    | ●          |          |           | ●          |
| Perm. Press   | ●          | ●           | ●    | ●         |       | ●          | ●        | ●         | ●          |
| Bright Whites | ●          | ●           | ●    | ●         | ●     | ●          | ●        |           | ●          |
| Sanitary      | ●          | ●           | ●    |           | ●     | ●          | ●        |           | ●          |
| Tub Clean     |            |             |      |           | ●†    |            |          |           |            |
| Rinse+Spin    |            | ●           | ●    |           |       |            |          |           | ●          |

| Cycle              | Soil Level | Extra Rinse | Spin | Wash Temp | Steam | Turbo Wash     | Pre-wash | Cold Wash | Fresh Care |
|--------------------|------------|-------------|------|-----------|-------|----------------|----------|-----------|------------|
| Spin Only          |            |             | ●    |           |       |                |          |           | ●          |
| Hand/Wool          | ●          | ●           | ●    | ●         |       |                |          | ●         | ●          |
| Activewear         | ●          | ●           | ●    | ●         |       |                |          |           | ●          |
| Swimwear           | ●          | ●           | ●    | ●         |       |                | ●        | ●         | ●          |
| Kids Wear          | ●          | ●           | ●    | ●         | ●     |                | ●        |           | ●          |
| Jeans              | ●          | ●           | ●    | ●         | ●     | ● <sup>†</sup> | ●        | ●         | ●          |
| Dresses            | ●          | ●           | ●    | ●         |       |                | ●        | ●         | ●          |
| Color Care         | ●          | ●           | ●    | ●         |       | ● <sup>†</sup> | ●        | ●         | ●          |
| Sweat Stains       | ●          | ●           | ●    | ●         | ●     | ● <sup>†</sup> | ●        | ●         | ●          |
| Small Load         | ●          | ●           | ●    | ●         |       |                | ●        | ●         | ●          |
| Large Load         | ●          | ●           | ●    | ●         | ●     | ● <sup>†</sup> | ●        | ●         | ●          |
| XL Load            | ●          | ●           | ●    | ●         | ●     | ● <sup>†</sup> | ●        | ●         | ●          |
| Overnight          | ●          | ●           | ●    | ●         | ●     | ● <sup>†</sup> | ●        | ●         | ●          |
| Ez Dispenser Clean |            |             |      |           |       |                |          |           |            |

## Cycle Modifiers

### About Modifier Buttons

Each cycle has default settings that are selected automatically. You can also customize these settings using the cycle modifier buttons. Press on the selected cycle in the main display to show the cycle modifiers and options.

- Repeatedly Press the button for the desired modifier to select the desired setting.
- The washer automatically adjusts the water level for the type and size of wash load for best results and maximum efficiency.
- This is a high-efficiency washer, and the water levels may be much lower than you expect. This is normal, and cleaning/rinsing performance will not be compromised.

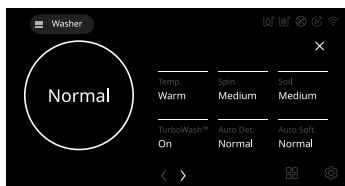

- Press the Temp button to show the available settings in the display: **Tap Cold, Cold, Warm, Hot or Ex. Hot**
- Press the Spin button to show the available settings in the display: **No Spin, Low, Medium, High or Ex. High**
- Press the Soil button to show the available settings in the display: **Light, Med. Light, Medium, Med. Heavy, Heavy**

#### NOTE

- The setting lights up when it is selected and the setting is shown in the display.
- To protect your garments, not every wash temperature, spin speed, soil level, or option is available with every cycle.
- The button is not lit up if the desired setting is not allowed for the selected cycle.
- Follow the fabric care labels on the garment for best results.

#### Temp.

Make sure the wash temperature is suitable for the type of load you are washing.

- Press the **Temp.** button and select the wash and rinse temperature combination for the selected cycle.
- All rinses use unheated cold water.
- Cold rinses use less energy. The actual cold rinse temperature depends on the temperature of the cold water at the faucet.
- Your washer features a heating element to boost the hot water temperature for **Ex. Hot** settings. This provides improved wash performance at normal water heater settings.

#### Spin

Higher spin speeds extract more water from clothes, reducing drying time and saving energy.

- Press the **Spin** button and select the desired speed.
- Some fabrics, such as delicates, require a slower spin speed.

#### Soil

Adjusting the soil level setting will modify the cycle times and/or wash actions.

- Press the **Soil** button and select the desired soil level.
- The **Heavy** soil setting may increase cycle times. The **Light** soil setting may decrease cycle times.

## Options and Extra Functions

### Basic Options

Your washer includes several additional cycle options to customize cycles to meet your individual needs.

- Select the desired option after selecting the desired cycle and cycle modifiers.

#### NOTE

- The indicator for the option will light when the option is selected.
- To protect your garments, not every option is available with every cycle.
- If an option is not available for the selected cycle, the button will be dimmed and will not respond.

#### Steam

Adding this option to a wash cycle helps provide superior cleaning performance. Using steam gives fabrics the cleaning benefits of a very hot wash.

- Steam may not be clearly visible during steam cycles. This is normal. Too much steam could damage clothing.
- Do not use steam with delicate fabrics such as wool and silk, or easily discolored fabrics.

### ⚠ WARNING

- Do not touch the door during steam cycles. The door surface can become very hot and can cause severe burns. Allow the door lock to release before opening the door.
- Do not attempt to override the door lock mechanism or reach into the washer during a steam cycle. Steam can cause severe burns.

### Extra Rinse

This option adds an extra rinse to the selected cycle. Use this option to help ensure the removal of detergent or bleach residue from fabrics.

- Press the **Extra Rinse** button to add from 1 to 3 additional rinses to the cycle.

### Delay Start

Once you have selected the cycle and other settings, press the **Delay Start** button to delay the start of the wash cycle.

- Select desired the delay time in 5 minute increments, from 1 hour up to 19 hours.
- Once the desired delay time is set, press the **Start/Pause** button to start the delay time.

### NOTE

- If the **Start/Pause** button is not pressed to begin the delay time, the washer automatically turns off after a certain time and all cycle settings are lost.

### Fresh Care

Use this function when you will not be able to unload your clothes immediately after the wash cycle ends.

- The drum will tumble periodically for up to 19 hours to prevent wrinkles.

### TurboWash™

Adding this option reduces the cycle time while still providing similar wash performance to the same cycle without **TurboWash™**.

- For cycles in which **TurboWash™** is automatically selected, the **TurboWash™** option cannot be turned off.

- These cycles are designed for optimum performance with the **TurboWash™** option applied.

### Cold Wash™

Add the **Cold Wash™** option to save energy by using cooler water. Wash and rinse times are increased to maintain wash performance.

- Wash time will increase up to several minutes with this option.
- For best wash results, only wash small loads (less than 8 lb) with this option.

### Pre-Wash

This option adds a pre-wash (for about **15 - 17 minutes**) for improved cleaning of heavily soiled or stained clothing.

### NOTE

- If you select **Pre-wash** after putting the detergent directly in the drum, the detergent may be washed away, reducing the washing performance.

## Using the ezDispense Function

### ezDispense Reservoirs

The ezDispense function automatically dispenses liquid detergent and softener.

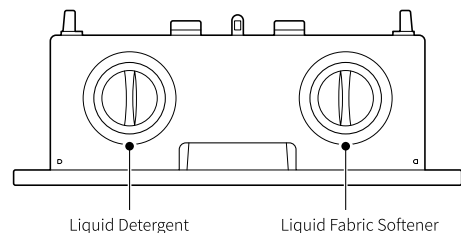

### ⚠ CAUTION

- Use both hands when opening or closing the dispenser drawer and gently slide the drawer to avoid damaging the washer or causing detergent or softener to leak from the vent holes in the reservoirs.
- Do not leave detergent or fabric softener in the ezDispense reservoirs for an extended period. They may harden and fail to properly dispense.
- Do not remove the dispenser drawer while the product is in operation.

**CAUTION**

- Empty the ezDispense reservoirs before moving the washer.

**Changing the Dispense Amounts****Adjusting Dispense for Current Cycle**

- 1 Press the circle and select Detergent Level or Softener Level.

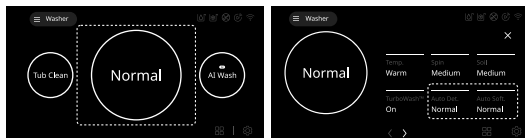

- 2 Press **Auto Det.** or **Auto Soft.** to adjust the dispense amounts for the current cycle.
  - **Off** : Turns off the ezDispense function for that reservoir
  - **Minimum** : Decreases the default amount by 20%
  - **Less** : Decreases the default amount by 10%
  - **Normal** : Uses the default amount for that reservoir
  - **More** : Increases the default amount by 10%
  - **Maximum** : Increases the default amount by 20%

**Adjusting Default Dispense Amounts**

- 1 Press the **Settings** button and select **ezDispense™**.

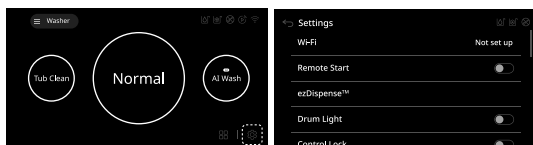

- 2 Select **Default Dispense**.

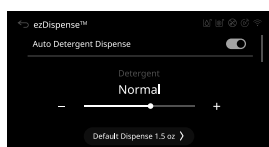

- 3 Scroll to set the **Default Dispense**.

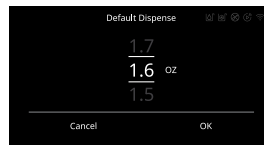

- 4 Press **OK** to save the desired default amount.

**NOTE**

- The default settings are initially configured to dispense 1.5 oz (45 ml) of detergent and 2.0oz (60ml) of softener for 9lb–10lb (4kg-4.5kg) of normally soiled laundry. The dispense amounts are relative to the set **Normal** amount, based on the soil level and type of laundry. The amount dispensed may vary depending on the amount of laundry and the cycle.
- Default dispense amounts can be increased or decreased in 0.1 oz (3 ml) increments, from 0.3 oz (9 ml) to 4.0 oz (120 ml).

**Changing the Softener Reservoir Use**

Use the softener reservoir as a second detergent reservoir.

- 1 Press the **Settings** button and select **ezDispense™**.

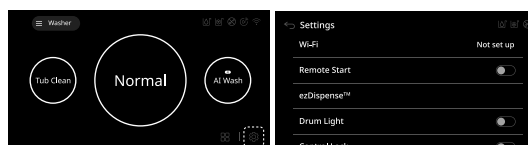

- 2 Select **Dispenser Usage**.

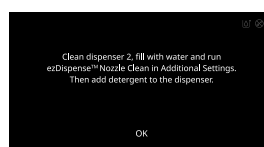
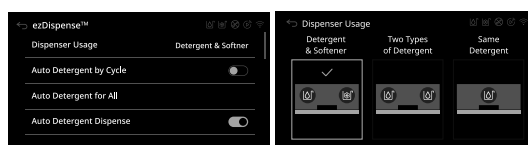

**⚠ CAUTION**

- Before using the softener reservoir to dispense detergent, empty and clean the reservoir and run the **ezDispense™ Nozzle Clean** function, or the reservoir may fail to dispense properly.

**Cleaning the ezDispense Reservoirs**

Use this function to periodically clean the ezDispense reservoirs or before changing the softener reservoir to a detergent reservoir.

- This function cleans residual detergent or softener in the hose connected to the ezDispense (when changing the type of detergent or softener).

- 1 Press the **Settings** button.

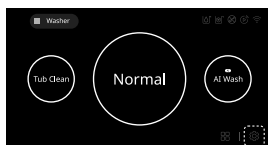

- 2 Select **ezDispense™ Nozzle Clean** and select a **dispenser**.

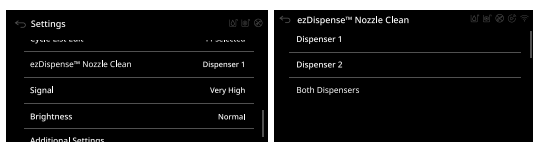

- 3 Fill the dispenser with water and press the Start button to start cleaning.

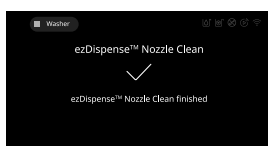
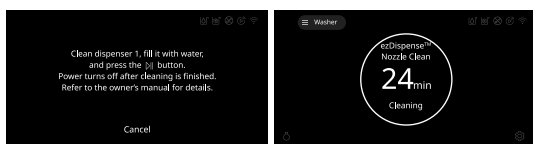
**⚠ CAUTION**

- Before using the function, remove the ezDispense reservoir, clean it, fill it with water and reassemble it in the dispenser drawer.

**Cleaning the ezDispense Drawer**

Remove and clean the ezDispense reservoirs every time you refill them or change to a new type of detergent or softener.

**⚠ CAUTION**

- Do not spray water inside the washer. Doing so may cause a fire or electric shock.
- Slide the detergent dispenser drawer out or in slowly and use both hands for safety. Failure to do so can damage the washer or cause the detergent or softener to leak out of the ventilation holes in the reservoirs.

- 1 Turn off the washer, and unplug it.
- 2 Press **Push** on the dispenser drawer as shown. Use the handle to pull the tray out.

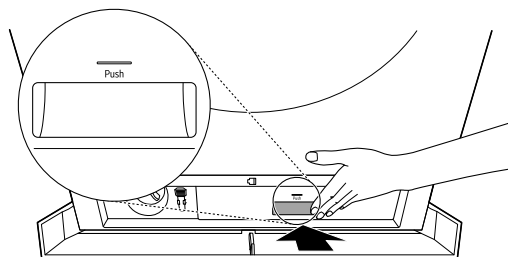

- 3 Turn the caps on the dispenser drawer to the left to open the two reservoirs.
  - Rinse the drawer in warm water to dissolve any detergent or softener scale.

- 4 Clean the outside and inside of the ezDispense reservoirs with warm water.
  - Use a soft cloth or brush to remove any residue.
  - Do not use soap when cleaning the drawer, reservoirs and inserts.

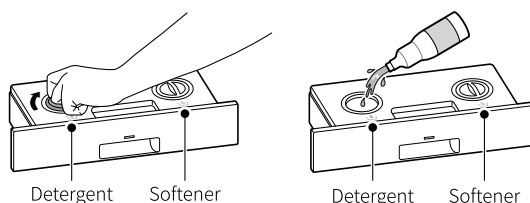

- 5 Wipe off any moisture with a dry towel or cloth after cleaning.
- 6 After filling, insert and turn the caps to the right until tightly closed. Insert the dispenser drawer until it clicks and close the lower cover.

### Before Calling for Service

| Problem                                   | Possible Cause & Solution   |
|---|---|
| <b>Check det. Tank / Check soft. Tank</b> | <p>The amount of liquid detergent/fabric softener in the reservoir did not decrease. After putting the detergent/softener into the reservoir, it was left for a long time and the detergent/softener hardened.</p> <ul style="list-style-type: none"> <li>• Clean the reservoir thoroughly, fill it with liquid detergent/fabric softener, install it in the drawer, and run a wash cycle. If the error is displayed continuously, call for service.</li> </ul> |
| <b>No detergent / No softener</b>         | <p>The automatic detergent injection function does not work properly.</p> <ul style="list-style-type: none"> <li>• Call for service.</li> </ul>   |
| <b>ezDispense™ error</b>                  | <p>The ezDispense did not work properly.</p> <ul style="list-style-type: none"> <li>• Call for service.</li> </ul>  |
| <b>Drawer open</b>                        | <p>The washer was operated without completely closing the drawer. The drawer was opened during the washer operation.</p> <ul style="list-style-type: none"> <li>• Push the drawer completely closed. If the error is displayed continuously, call for service.</li> </ul>   |

## More Options and Settings

Press the **Settings** button and select the desired option or setting from the menu. Press the **✓(OK)** button to select the options or change the settings.

### Settings

- 1 Press the **Settings** button.
- 2 Select the desired setting and press the **✓(OK)** button.
- 3 To return to the previous screen, press the **↶(Previous)** button.

#### NOTE

- If no action is taken for several minutes after pressing the **Settings** button, the display reverts to the previous screen.

#### Wi-Fi

Use to set up the **Wi-Fi** connection. When **Wi-Fi** is turned on, the **Wi-Fi** icon appears in the display.

#### Remote Start

Use a smartphone to control your washer remotely.

- For more information, see **SMART FUNCTIONS** in this manual.

#### ezDispense™

Select to manage the auto detergent and auto softener settings. Includes settings for **Dispenser Usage, Auto Detergent by Cycle, Auto Detergent Dispense, and Auto Softener Dispense.**

- 1) **Dispenser Usage**
  - Switches the softener reservoir to a secondary detergent reservoir for those who don't use liquid fabric softener.
- 2) **Default Det. Dispense / Default Soft. Dispense**
  - Use this function to adjust the default detergent / softener dispense amount in 0.1 oz (3 ml) increments, within a range of 0.3 oz (9 ml) to 4.0 oz (120 ml).
  - The default settings are configured to dispense 1.5 oz (45 ml) of detergent and 2.0

oz (60 ml) of softener for 9lb~10lb (4kg-4.5kg) of normally soiled laundry. The washer then optimizes these amounts based on load size, soil level, and your settings.

### Drum Light

The drum is equipped with a white LED light that illuminates when the washer is turned on. This light automatically turns off when the door is closed and the cycle starts.

- The drum light will turn off automatically after 4 minutes.

### Control Lock

Use this function to disable the controls. This function can prevent children from changing cycles or operating this washer.

#### NOTE

- The function does not lock the door.
- Once this function is set, all buttons are locked except the **Power** and **Settings** button.
- When the controls are locked, the **Control Lock** indicator lights up and the wash cycle is shown on the display.
- Turning off the power will not reset this function. You must deactivate this function before you can access any other options and functions.

### Cycle List Edit

Edit the list of wash cycles as desired.

- 1) Select the desired cycle to include or exclude.
  - If a cycle is added, a check mark is displayed by that cycle.
  - If a cycle is deleted, the check mark is not displayed by that cycle.
- 2) Press the  (**Previous**) button to save the cycle list.

#### NOTE

- The **Normal** and **Tub Clean** cycles cannot be deleted.
- The order of cycles in the list can be changed. Change the order of the cycles in the list using **Additional Settings > Cycle Optimization** on the product or **Product Cycle Management** in the **LG ThinQ** application.

### ezDispense™ Nozzle Clean

Use this function to periodically clean the ezDispense reservoirs or before changing the softener reservoir to a detergent reservoir.

- This function cleans residual detergent or softener in the hose connected to the **ezDispense** (when changing the type of detergent or softener).

#### ⚠ CAUTION

- Before using the function, remove the **ezDispense** reservoir, clean it, fill it with water and reassemble it in the dispenser drawer.

### Signal



The volume of the notification sounds and button sounds can be set from quiet to very loud.

### Brightness

Use this function to adjust the brightness of the display.

- Normal is the default setting.

### Additional Settings

- 1 Press the **Settings** button.
- 2 Select **Additional Settings** and press the  (**OK**) button.
- 3 Select the desired setting and press the  (**OK**) button.
- 4 To return to the previous screen, press the  (**Previous**) button.

#### NOTE

- If no action is taken for several minutes after pressing the **Settings** button, the display reverts to the previous screen.

### Cycle Optimization

When activated, this feature organizes the cycle list and options automatically based on your usage patterns.

- **On** is the default setting.
- Selecting **Off** retains the current list order.

### **SideKick™ Connection**

You can also operate the mini wash from the washer by linking the two together.

- The link can be activated by pressing the **SideKick™ Connection** button and then pressing the **Connect** button for 3 seconds.
- Setting functions may vary depending on the model.

### **Smart Diagnosis**

Use this to help troubleshoot errors or malfunctions.

- See the Smart Diagnosis section for more details.

### **Factory Reset**

Select this to delete all the stored data and reset settings to factory defaults.

### **Open Source License**

To obtain source codes distributed under open-source licenses obligated to disclose GPL, LGPL, MPL and other source codes embedded in this product, or to verify the license details, copyright notices, and other relevant documents, visit <https://opensource.lge.com>. In addition, if a consumer requests the open-source code of the software embedded in this product by sending an email to [opensource@lge.com](mailto:opensource@lge.com), LG Electronics will provide it in a storage medium at the minimum cost required to provide it, such as media costs and transportation costs. This offer is valid for anyone in receipt of this information for a period of three years after our last shipment of this product.

# SMART FUNCTIONS

## Using LG ThinQ Application

The **LG ThinQ** application allows you to communicate with the appliance using a smartphone.

### LG ThinQ Application Features

For products that contain a Wireless LAN module

- **Remote Start**
  - Control the appliance remotely from the **LG ThinQ** application.
- **Downloaded**
  - Download new and specialized cycles that are not included in the standard cycles on the appliance.
- **Tub Clean Coach**
  - Find out how many cycles remain before it is time to run the **Tub Clean** cycle.
- **Energy Monitoring**
  - Keep track of the washer's power consumption and how it is affected by your selected wash cycles and options.
- **Smart Diagnosis™**
  - This function provides useful information for diagnosing and solving issues with the appliance based on the pattern of use.
- **Push Alerts**
  - When the cycle is complete or the appliance has problems, you will receive a push message.
- **Settings**
  - Set various options on the appliance and in the application.

### NOTE

- In the following cases, you must update the network information for each appliance in the **LG ThinQ** application under **Device Cards** → **Settings** → **Change Network**.
  - wireless router is changed
  - wireless router password is changed
  - Internet service provider is changed
- This information is current at the time of publication. The application is subject to change for product improvement purposes without notice to users.

## Installing LG ThinQ Application and Connecting an LG Appliance

### Models with QR Code

Scan the QR code attached to the product using the camera or a QR code reader application on your smartphone.

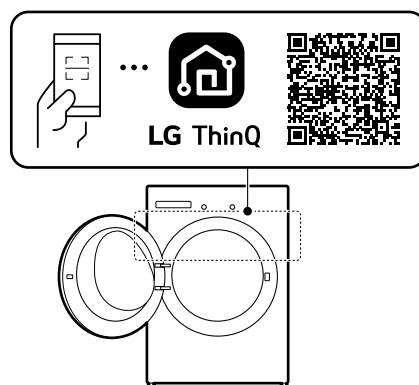

### Models without QR Code

- 1 Search for and install the **LG ThinQ** application from the Google Play Store or Apple App Store on a smartphone.
- 2 Run the **LG ThinQ** application and sign in with your existing account or create an LG account to sign in.
- 3 Touch the add (+) button in the **LG ThinQ** application to connect your LG appliance. Follow the instructions in the application to complete the process.

### NOTE

- You may be asked to provide a password to connect to the LG network (not your home network) during the Wi-Fi setup. The password is the last 4 characters of the network name, repeated twice, with no spaces. For example, if the network name appears as LG\_XXXX\_8b92, then you would enter 8b928b92 as your password. The password is case sensitive and the last 4 characters are unique to your appliance.
- To verify the Wi-Fi connection, check that the Wi-Fi indicator on the control panel is lit.

**NOTE**

- The appliance supports 2.4 GHz Wi-Fi networks only. To check your network frequency, contact your Internet service provider or refer to your wireless router manual.
- **LG ThinQ** is not responsible for any network connection problems or any faults, malfunctions, or errors caused by network connection.
- The surrounding wireless environment can make the wireless network service run slowly.
- If the appliance and the wireless router are too far apart, the signal becomes weak. It may take a long time to connect or fail to install the application.
- If the appliance is having trouble connecting to the Wi-Fi network, it may be too far from the router. Purchase a Wi-Fi repeater (range extender) to improve the Wi-Fi signal strength.
- The network connection may not work properly depending on the Internet service provider.
- The Wi-Fi may not connect or the connection may be interrupted because of the home network environment.
- If the appliance cannot be connected due to problems with the wireless signal transmission, unplug the appliance and wait about a minute before trying again.
- If the firewall on your wireless router is enabled, disable the firewall or add an exception to it.
- The wireless network name (SSID) should be a combination of English letters and numbers. (Do not use special characters.)
- Smartphone user interface (UI) may vary depending on the mobile operating system (OS) and the manufacturer.
- If the security protocol of the router is set to **WEP**, network setup may fail. Change the security protocol (**WPA2** is recommended), and connect the product again.

**Using the Appliance Remotely****Remote Start**

Use a smartphone to control your appliance remotely. You can also monitor your cycle operation so you know how much time is left in the cycle.

**Using Remote Start**

- 1 Put the laundry in the drum. If using the manual dispenser, add detergent to the collapsible manual dispenser and place it in the drum. If using **ezDispense**, make sure that there is sufficient detergent and softener in the reservoirs.
  - If desired, add a chlorine bleach pack to the drum.
- 2 Press the **Power** button.
- 3 Press the **Options** button.
- 4 Start a cycle from the **LG ThinQ** application on your smartphone.

**NOTE**

- Once this function is enabled, you can only start a cycle from the **LG ThinQ** smartphone application. If the cycle is not started, the appliance will wait to start the cycle until it is turned off remotely from the application or the remote function is disabled.
- If the door has been opened, you cannot start a cycle remotely.

**Disabling Remote Start Manually**

When the function is activated, press the **Options** button.

**Radio Equipment Specifications**

To identify the RF module installed in the appliance, refer to the label attached to the appliance.

| Type                   | Operating Frequency Range | Output Power (Max.) |
|------------------------|---------------------------|---------------------|
| Wireless LAN           | 2400 MHz - 2472 MHz       | < 1 W               |
| Bluetooth <sup>†</sup> | 2400 MHz - 2483.5 MHz     |                     |

<sup>†</sup> This feature is only available on some models.

## FCC Notice

The following notice covers the transmitter module contained in this product.

This equipment has been tested and found to comply with the limits for a Class B digital device, pursuant to Part 15 of the FCC Rules. These limits are designed to provide reasonable protection against harmful interference in a residential installation. This equipment generates, uses, and can radiate radio frequency energy and, if not installed and used in accordance with the instructions, may cause harmful interference to radio communications. However, there is no guarantee that interference will not occur in a particular installation. If this equipment does cause harmful interference to radio or television reception, which can be determined by turning the equipment off and on, the user is encouraged to try to correct the interference by one or more of the following measures:

- Reorient or relocate the receiving antenna.
- Increase the separation between the equipment and the receiver.
- Connect the equipment to an outlet on a circuit different from that to which the receiver is connected.
- Consult the dealer or an experienced radio/TV technician for help.

This device complies with part 15 of the FCC Rules. Operation is subject to the following two conditions:

- (1) This device may not cause harmful interference and
- (2) This device must accept any interference received, including interference that may cause undesired operation.

Any changes or modifications in construction of this device which are not expressly approved by the party responsible for compliance could void the user's authority to operate the equipment.

## FCC RF Radiation Exposure Statement

This equipment complies with FCC radiation exposure limits set forth for an uncontrolled environment. This transmitter must not be co-located or operating in conjunction with any other antenna or transmitter.

This equipment should be installed and operated with a minimum distance of 20 cm (7.8 inches) between the antenna and your body. Users must follow the specific operating instructions for satisfying RF exposure compliance.

## Open Source Software Notice Information

To obtain the source code that is contained in this product, under GPL, LGPL, MPL, and other open source licenses that have the obligation to disclose source code, and to access all referred license terms, copyright notices and other relevant documents, please visit <https://opensource.lge.com>.

LG Electronics will also provide open source code to you on CD-ROM for a charge covering the cost of performing such distribution (such as the cost of media, shipping, and handling) upon email request to [opensource@lge.com](mailto:opensource@lge.com).

This offer is valid to anyone in receipt of this information for a period of three years after our last shipment of this product.

## Smart Diagnosis™ Function

Use this feature to help you diagnose and solve problems with your appliance.

### NOTE

- For reasons not attributable to LGE's negligence, the service may not operate due to external factors such as, but not limited to, Wi-Fi unavailability, Wi-Fi disconnection, local app store policy, or app unavailability.
- The feature may be subject to change without prior notice and may have a different form depending on where you are located.

## Using LG ThinQ to Diagnose Issues

If you experience a problem with your Wi-Fi equipped appliance, it can transmit troubleshooting data to a smartphone using the **LG ThinQ** application.

- Launch the **LG ThinQ** application and select the **Smart Diagnosis™** feature in the menu. Follow the instructions provided in the **LG ThinQ** application.

## Using Smart Diagnosis to Diagnose Issues

Follow the instructions below to use the smart diagnosis method.

- 1 Press the **Power** button to turn on the appliance.

## 42 SMART FUNCTIONS

---

- 2 Press the **Settings** button.
- 3 Select **Additional Settings** and then **Smart Diagnosis**.
- 4 After the diagnosis is complete, the results will be displayed on the display.

# MAINTENANCE

## **⚠ WARNING**

- To reduce the risk of fire, electric shock, or injury to persons, read this entire owner's manual, including the **SAFETY INSTRUCTIONS**, before operating this appliance.
- Unplug the appliance before cleaning to avoid the risk of electric shock. Failure to follow this warning can cause serious injury, fire, electric shock, or death.
- Do not use volatile substances (benzene, paint thinner, alcohol, acetone, etc.), abrasive cleaners, or detergents with strong chemical components when cleaning the appliance. Doing so may cause discoloration or damage to the appliance, or may cause a fire.
- Certain internal parts are intentionally not grounded and may present a risk of electric shock only during servicing. Service personnel - Do not contact the following parts while the appliance is energized: pump, valve, motor, control board.

## Regular Cleaning

### Care after Wash

After the cycle is finished, wipe the door and the inside of the door seal to remove any moisture.

- Wipe the body of the washer with a dry cloth to remove any moisture.
- Leave the door open to dry the drum interior.

## **⚠ WARNING**

- Make sure children and pets do not climb into the drum. Engage the **Control Lock** feature if needed to prevent children from accidentally starting a wash cycle.

## Cleaning the Exterior

Proper care of your washer can extend its life.

### Door:

Wash with a damp cloth on the outside and inside and then dry with a soft cloth.

### Exterior:

- Immediately wipe off any spills.

- Wipe with a damp cloth.
- Do not touch the surface or the display with sharp objects.

## Periodic Maintenance

- Use a towel or soft cloth to wipe around the washer door opening and door glass.
- Always remove items from the washer as soon as the cycle is complete. Leaving damp items in the washer can cause wrinkling, color transfer, and odor.

## Cleaning the Drum

Over time, residue may build up in the drum, leading to mildew or a musty odor. Run the **Tub Clean** cycle **monthly** to remove residue and prevent odor.

## NOTE

- Make sure to run the **Tub Clean** cycle only when the drum is empty. Never load laundry while using this cycle. The laundry may be damaged or contaminated with cleaning products.
- Run the cycle more often under heavy use conditions or if odor is already present.
- If mildew or musty smell already exists, run this cycle once a week for three consecutive weeks.

**1** Remove any clothing from the drum.

**2** Add cleaning agents.

| Cleaner                | Instructions                         |
|------------------------|--------------------------------------|
| Drum cleaner           | Place directly into the washer drum. |
| Lime scale remover     |                                      |
| Liquid chlorine bleach | Place directly into the washer drum. |
| Powdered cleaner       | Place directly into the washer drum. |
| Cleaning tablets       |                                      |

- For other drum cleaning products, follow the cleaner manufacturer's instructions and recommendations.

**3** Close the door and press the **Power** button.

- 4 Select the **Tub Clean** cycle and press the **Start/Pause** button to begin the cycle.
- 5 After the cycle ends, open the door and allow the drum interior to dry completely.

### ⚠ WARNING

- Make sure children and pets do not climb into the drum. Engage the **Control Lock** feature if needed to prevent children from accidentally starting a wash cycle.

### NOTE

- If you use a descaler or drum cleaner during the **Tub Clean** cycle, use the **Rinse+Spin** cycle to rinse the washer drum before running your next wash cycle.

### Automatic Alert for Tub Clean

When the power is on and the **Tub Clean** message blinks on the display, it means the washer drum needs cleaning. Use the **Tub Clean** cycle to clean the washer drum. The frequency of the automatic alert's appearance depends on how often the washer is used. However, the message will generally appear every one to two months.

### Removing Mineral Buildup

In areas with hard water, mineral scale can form on internal components of the washer. Periodically clean the mineral buildup on the internal components to extend the lifespan of the washer. Use of a water softener is recommended in areas with hard water.

- Use a descaler to remove visible mineral buildup on the washer drum.
- After descaling, always run the **Tub Clean** cycle before washing clothing.
- Mineral scale and other spots may be removed from the stainless steel drum using a soft cloth soaked in stainless steel cleaner.
- Do not use steel wool or abrasive cleaners.

### Leaving the Door Open

After you finish using the washer, leave the door open overnight to allow air to circulate and dry the drum. This helps prevent odors.

### Cleaning the Auto Dispense Tray

Remove and clean the Auto Dispense tray **every time** you refill the detergent/softener or change to a new type of detergent/softener.

Remove and clean the detergent dispenser drawer **once or twice a month**. Leaving detergent in the detergent dispenser drawer for an extended period or using the washer for a long time may cause the build-up of residue in the detergent dispenser drawer.

### ⚠ WARNING

- Do not spray water inside the washer. Doing so may cause fire or electric shock.

- 1 Turn off the washer, and unplug the power cord.
- 2 Press the circle to open the lower cover.

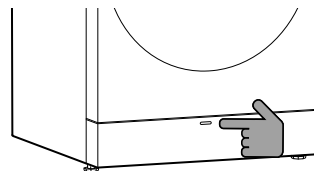

- 3 Push in on the top of the Auto Dispense tray to slide it out and use the handle to remove the tray.

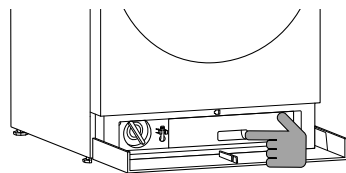

- 4 Turn the liquid detergent dispenser cap ① and liquid softener dispenser cap ② counterclockwise to remove them.

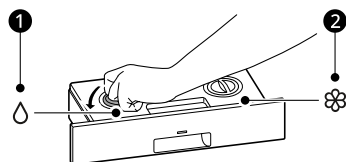

- 5 Turn the check valves ③ on the back of the tray counterclockwise to remove them.

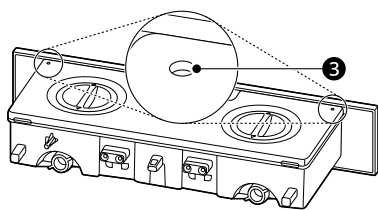

- 6 Clean the Auto Dispense tray and check valves with warm water.
- 7 Wipe off any moisture with a dry towel or cloth after cleaning.
- 8 Assemble the liquid detergent dispenser cap, liquid softener dispenser cap and check valves on the Auto Dispense tray and turn them clockwise until tight.
- 9 Insert the Auto Dispense tray until it clicks and close the lower cover.

### Cleaning the Door Seal

Clean the door seal **once a month** to prevent build-up of dirt.

#### **CAUTION**

- Cleaning the door seal with undiluted bleach may cause malfunction of the door seal and washer parts. You must add water to the bleach before using it.

- 1 Wear rubber gloves and protective goggles.
- 2 Dilute 3/4 cup (177 mL) of liquid chlorine bleach in 1 gallon (3.8 L) of water.
- 3 Wipe around the door seal.
  - Soak a sponge or a soft cloth in this diluted solution and wipe all around the door seal.
- 4 Wipe up any moisture with a dry towel or cloth after cleaning.

- 5 Leave the door open to allow the door seal to dry completely.

### Cleaning the Water Inlet Filters

If the washer does not fill properly, an error message will appear on the display. The inlet valve filter screens could be clogged by hard water scale, sediment in the water supply, or other debris.

#### **WARNING**

- The inlet screens protect the delicate parts of the inlet valve from being damaged by particles that could enter the valves with the water supply. Operating the washer with these filters removed could cause a valve to open continuously, resulting in flooding and/or property damage.

#### **CAUTION**

- Do not use the washer without the inlet filters. Doing so will cause leaks and malfunction.
- If you use the washer in an area with hard water, the inlet filter may clog due to lime buildup and require more frequent cleaning.

- 1 Turn off the washer, and unplug the power cord.
- 2 Turn off hot and cold water faucets.
- 3 Unscrew the hot and cold water hoses from the back of the washer.
- 4 Remove the filters from the water valves carefully.
  - Use pliers to pull out the filters from the water valves.

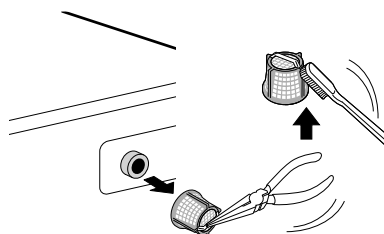

**5** Remove foreign objects and soak the filters in white vinegar or a lime scale remover.

- If using a lime scale remover, follow the manufacturer's instructions. Be careful not to damage the filters while cleaning them.

**6** Rinse filters thoroughly and press them back into place.

**7** Flush then reattach the water hoses.

- Before reattaching the water inlet hoses, flush them by running several gallons of water through them into a bucket or drain, preferably with the faucets wide open for maximum flow.

**NOTE**

- An I E error message may blink on the display when the water pressure is low or an inlet filter is clogged with dirt. Clean the inlet filter.

**Cleaning the Drain Pump Filter**

The washer fails to drain if the drain pump filter is clogged. Periodically clean the drain filter to prevent clogging with foreign objects.

**! WARNING**

- Opening the drain filter will result in water overflowing if there is water in the drum. Use a bucket if the drum is not completely drained before you open the drain filter.
- Using the washer without the drain filter or with an incorrectly assembled drain filter may cause leaks or malfunction of the washer.

**1** Turn off the washer, and unplug the power cord.

**2** Press on the circle to open the lower cover.

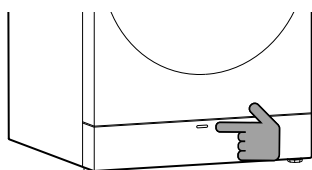

**3** Drain any remaining water.

- Unclip the drain hose and remove the plug from the drain hose to drain the remaining water.

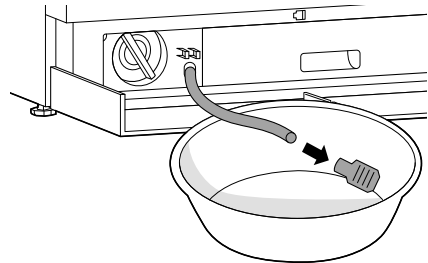

**4** Remove the pump filter.

- Twist the pump filter counterclockwise to remove.

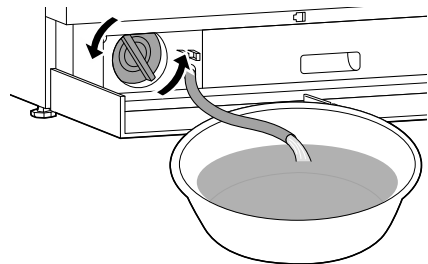

**5** Clean the pump filter and opening.

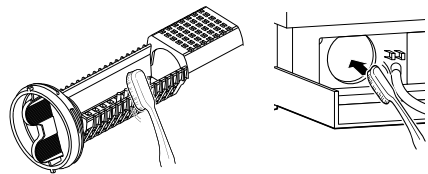

**6** Reassemble the plug onto the drain hose and reclip the drain hose.

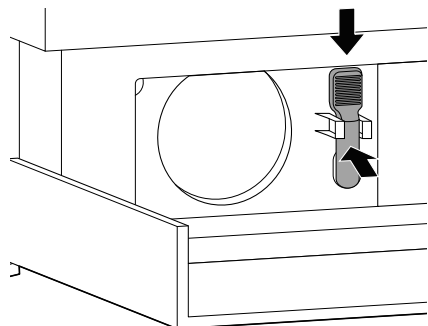

- 7 Insert the drain pump filter and twist it clockwise.

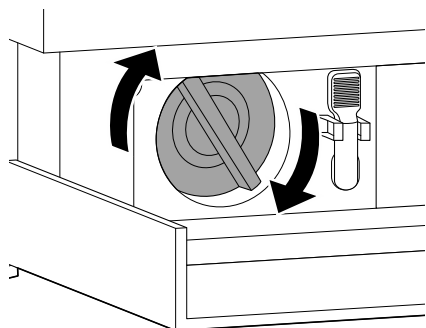

- 8 Close the lower cover.

**NOTE**

- An **UE** message blinks on the display when the drain pump filter is clogged with dirt. Clean the drain pump filter.

## Care in Cold Climates

### Storing the Washer

If the washer will not be used for an extended period of time and is in an area that could be exposed to freezing temperatures, follow these steps to protect the washer from damage.

**NOTE**

- Make sure the drum is empty before following these steps.

- 1 Turn off the washer, and unplug the power cord.
- 2 Turn off the water faucets.
- 3 Disconnect the water inlet hoses. Drain any water from the hoses.

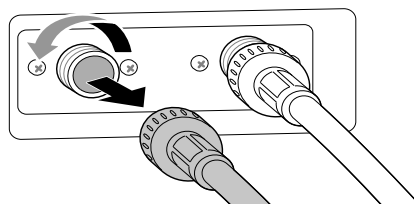

- 4 Plug the power cord into a properly grounded electrical outlet.
- 5 Add 1 gallon of nontoxic recreational vehicle (RV) antifreeze to the empty drum and close the door.
  - Never use automotive antifreeze.
- 6 Turn on the washer and select the **Spin** cycle.
- 7 Press the **Start/Pause** button to start the drain pump for **1 minute**.
  - This will expel some of the antifreeze, leaving enough to protect the washer from damage.
- 8 Turn off the washer and unplug the power cord.
- 9 Dry the drum interior with a soft cloth, and close the door.
- 10 Store the washer in an upright position.
- 11 Remove the inserts from the dispenser. Drain any water in the compartments and let them dry.
- 12 To remove the antifreeze from the washer after storage, run the **Quick Wash** cycle using detergent.
  - Do not add laundry to this cycle.

## When the Water Inlet Hoses are Frozen

- 1 Turn off the washer, and unplug the power cord.
- 2 Turn off the faucets connected to the water inlet hoses.
- 3 Pour hot water on the frozen faucets to thaw the water inlet hoses and remove the water inlet hoses.
- 4 Immerse the water inlet hoses in hot water to thaw them.
- 5 Reconnect the water inlet hoses to the water inlets of the washer and to the faucets.
  - See **Connecting the Water Inlet Hoses** for details.
- 6 Turn on the faucets.
- 7 Press the **Power** button to turn on the washer.
- 8 Select the **Spin** cycle to operate spin only cycle for draining and spinning.
- 9 Press the **Start/Pause** button.

5 Press the **Start/Pause** button to make sure the water drains.

## When the Drain Hose is Frozen

- 1 Pour hot water in the washer drum and close the door.
- 2 Wait for **1 - 2 hours**.
- 3 Press the **Power** button.
- 4 Select the **Spin** cycle to operate spin only cycle for draining and spinning.

# TROUBLESHOOTING

## Before Calling for Service

The washer is equipped with an automatic error-monitoring system to detect and diagnose problems at an early stage. If the washer does not function properly or does not function at all, check the following before you call for service.

For detailed information or videos, visit [www.lg.com](http://www.lg.com) for the troubleshooting page.

### FAQs

**Q: Why does my washer make loud banging noises while it is filling with water?**

**A:** This is actually a problem with the plumbing in your home. When the water valve in the washer shuts off, it can cause pipes in your home to move, resulting in a loud banging noise. This effect, called water hammer, can be reduced by installing an item called a water hammer arrestor. Add-on arrestors can be purchased through your local hardware or home improvement store.

**Q: Why is there so little water in my washer? How can it clean the clothes?**

**A:** HE (High-Efficiency) washers are designed to properly wash your laundry while using a minimum amount of water and energy. Because the water volume is low, the small amount of detergent used is more concentrated in the water, resulting in excellent cleaning performance.

**Q: When I press a button, why does my washer beep and then nothing happens?**

**A:** The **Control Lock** feature is turned on. To turn it off, press the **Settings** button, turn the knob to select **Control Lock**, and press the  $\checkmark$ (OK) button. Select **Off** and press the  $\checkmark$ (OK) button.

**Q: Where should I pour powdered laundry products when doing my laundry?**

**A:** If using a powder detergent, open the door and add it directly inside the drum. These products can be put in the empty drum before loading or on top of the laundry after loading the washer.

**Q: When should I change the default ezDispense amounts?**

**A:** If you simply want to use a bit more or less detergent for a single load, press the cycle in the main display and select **Auto Det.** or **Auto Soft.** to adjust the level for that load. If you are using a highly concentrated detergent or would just like to use more or less detergent or softener for every load, see the instructions in Using the ezDispense Function under Options and Extra Functions.

**Q: How do I calculate the correct default amount for my detergent?**

**A:** Use the information on the detergent packaging. Divide the total number of fluid ounces in the container by the estimated number of loads for a medium or normal wash load. For example, if the bottle contains 100 fl. oz. and the package states that it **washes 64 medium loads** then  $100/64 = 1.6$  fl oz per load. If you generally use about half the manufacturer's recommended amount, set the default to 0.8 fl oz. Do not set the **ezDispense** default for more than the maximum recommended amount (for full loads). For additional assistance calculating, use the **LG ThinQ** app.

**Q: How do I use a special detergent for sportswear or hand washables?**

**A:** Turn off the **ezDispense** function and use the manual dispenser.

**Q: Can I use powdered detergent in the ezDispense reservoirs?**

**A:** Use the manual dispenser for powdered detergents. Do not put powders in the **ezDispense** reservoirs.

## Error Messages

| Problem                  | Possible Cause & Solution   |
|--------------------------|---|
| <b>Door open</b>         | <p><b>The door is opened.</b></p> <ul style="list-style-type: none"> <li>• Open and close the door again. If the message keeps appearing, unplug the power cord and call for service.</li> </ul>  |
| <b>Door unlocked</b>     | <p><b>The door is not secured.</b></p> <ul style="list-style-type: none"> <li>• Check for objects around the door and door seal. If the message keeps appearing, unplug the power cord and call for service.</li> </ul>   |
| <b>Water supply</b>      | <p><b>Water supply faucets are not fully open.</b></p> <ul style="list-style-type: none"> <li>• Make sure that the water faucets are fully open.</li> </ul>   |
|                          | <p><b>Water inlet hoses are kinked, pinched, or crushed.</b></p> <ul style="list-style-type: none"> <li>• Make sure that the hoses are not kinked, pinched or crushed behind or under the washer. Be careful when moving the washer during cleaning or maintenance.</li> </ul>  |
|                          | <p><b>Water inlet filters are clogged.</b></p> <ul style="list-style-type: none"> <li>• Clean the inlet filters. See <b>MAINTENANCE</b>.</li> </ul>   |
|                          | <p><b>Water supply pressure to faucet or house is too low.</b></p> <ul style="list-style-type: none"> <li>• Check another faucet in the house to make sure that household water pressure is adequate and flow is not restricted.</li> <li>• Disconnect the water inlet hoses from the washer and run a few gallons of water through the hoses to flush out any dirt.</li> <li>• If flow is too low, contact a plumber to have the water supply lines repaired.</li> </ul> |
|                          | <p><b>Water supply connected with leak-limiting hoses.</b></p> <ul style="list-style-type: none"> <li>• The use of hoses designed to limit leaks is not recommended. Leak limiting hoses can trip falsely and prevent the washer from filling.</li> </ul>   |
| <b>Drainage</b>          | <p><b>Drain hose is kinked, pinched, or clogged.</b></p> <ul style="list-style-type: none"> <li>• Make sure that the drain hose is free of clogs or kinks and is not pinched behind or under the washer.</li> </ul>   |
|                          | <p><b>The end of the drain hose is more than 96 inches (2.4 m) above the bottom of the washer.</b></p> <ul style="list-style-type: none"> <li>• Move the end of the drain hose so that it is lower than <b>96 inches (2.4 m)</b>. For best performance, the end of the drain hose should be no higher than 66 inches (168 cm).</li> </ul>   |
| <b>Unbalance</b>         | <p><b>The load is too small.</b></p> <ul style="list-style-type: none"> <li>• Add additional items to allow the washer to balance the load.</li> </ul>  |
|                          | <p><b>Heavy articles are mixed with lighter items.</b></p> <ul style="list-style-type: none"> <li>• Always try to wash articles of somewhat similar weight to allow the washer to evenly distribute the weight of the load for spinning.</li> </ul>   |
|                          | <p><b>The load is out of balance.</b></p> <ul style="list-style-type: none"> <li>• Manually redistribute the load if articles have become tangled, preventing the automatic rebalancing from working properly.</li> </ul>   |
| <b>No water detected</b> | <p><b>The water level sensor is not working correctly.</b></p> <ul style="list-style-type: none"> <li>• Close the water faucets, unplug the washer, and call for service.</li> </ul>  |
| <b>Motor error</b>       | <p><b>A motor error has occurred.</b></p> <ul style="list-style-type: none"> <li>• Allow the washer to stand for 30 minutes and then restart the cycle.</li> <li>• If the error code is still displayed, call for service.</li> </ul>   |
| <b>Water too high</b>    | <p><b>Water level is too high due to a faulty water valve.</b></p> <ul style="list-style-type: none"> <li>• Close the water faucets, unplug the washer, and call for service.</li> </ul>  |

| Problem             | Possible Cause & Solution  |
|---------------------|--|
| Freeze error        | <b>Inlet hose, drain hose or drain pump is frozen.</b> <ul style="list-style-type: none"> <li>• See Care in Cold Climates.</li> </ul>  |
| No temp detected    | <b>Control error.</b> <ul style="list-style-type: none"> <li>• Unplug the washer and wait 60 minutes. Reconnect power and try again.</li> <li>• If the error code is still displayed, call for service.</li> </ul>           |
| Vibration sensor    | <b>Vibration sensor is malfunctioning.</b> <ul style="list-style-type: none"> <li>• Call for service.</li> </ul>   |
| Turbidity sensor    | <b>Turbidity sensor is malfunctioning.</b> <ul style="list-style-type: none"> <li>• Call for service.</li> </ul>   |
| Steam error         | <b>The steam function did not work properly.</b> <ul style="list-style-type: none"> <li>• Call for service.</li> </ul>   |
| Power failure       | <b>There was a power interruption or the power cord was not properly plugged in.</b> <ul style="list-style-type: none"> <li>• Plug in the power cord or press the <b>Start/Pause</b> button to restart the cycle.</li> </ul> |
| Voltage abnormality | <b>Abnormal voltage detected.</b> <ul style="list-style-type: none"> <li>• Unplug the power plug. If error recurs, call for service.</li> </ul>  |
| Temp sensor error   | <b>Thermistor is malfunctioning.</b> <ul style="list-style-type: none"> <li>• Unplug the product and call for service.</li> </ul>  |
| Inverter PCB Error  | <b>The Inverter PCB is not working properly.</b> <ul style="list-style-type: none"> <li>• Call for service.</li> </ul>   |

## ezDispense Error Messages

| Problem           | Possible Cause & Solution   |
|-------------------|---|
| Check det. Tank   | <b>The amount of liquid detergent in the detergent reservoir did not decrease.</b><br><b>After putting the detergent into the detergent reservoir, it was left for a long time and the detergent hardened.</b> <ul style="list-style-type: none"> <li>• Clean the detergent reservoir thoroughly, fill it with liquid detergent, install it in the drawer, and run a wash cycle. If the error is displayed continuously, call for service.</li> </ul>               |
| No detergent      | <b>The automatic detergent injection function does not work properly.</b> <ul style="list-style-type: none"> <li>• Call for service.</li> </ul>   |
| Check soft. Tank  | <b>The amount of fabric softener in the softener reservoir did not decrease.</b><br><b>After putting the fabric softener into the softener reservoir, it was left for a long time and the fabric softener hardened.</b> <ul style="list-style-type: none"> <li>• Clean the softener reservoir thoroughly, fill it with liquid fabric softener, install it in the drawer, and run a wash cycle. If the error is displayed continuously, call for service.</li> </ul> |
| No softener       | <b>The automatic softener injection function does not work properly.</b> <ul style="list-style-type: none"> <li>• Call for service.</li> </ul>  |
| ezDispense™ error | <b>The ezDispense did not work properly.</b> <ul style="list-style-type: none"> <li>• Call for service.</li> </ul>  |
| Drawer open       | <b>The washer was operated without completely closing the drawer.</b><br><b>The drawer was opened during the washer operation.</b> <ul style="list-style-type: none"> <li>• Push the drawer completely closed. If the error is displayed continuously, call for service.</li> </ul>   |

## Noises

| Problem  | Possible Cause & Solution  |
|--|--|
| <b>Clicking</b>  | <b>Door lock sounds when the door locks or unlocks.</b> <ul style="list-style-type: none"> <li>• Normal operation</li> </ul>   |
| <b>Spraying or hissing</b>   | <b>Water spraying or circulating during the cycle</b> <ul style="list-style-type: none"> <li>• Normal operation</li> </ul>   |
| <b>Humming or Gurgling</b>   | <b>Drain pump is pumping water from the washer at times during a cycle.</b> <ul style="list-style-type: none"> <li>• Normal operation</li> </ul>   |
| <b>Water sloshing</b>  | <b>A liquid in the balance ring around the pulsator helps the basket spin smoothly.</b> <ul style="list-style-type: none"> <li>• Normal operation</li> </ul>   |
| <b>Water being added after the washer has already begun to operate</b>     | <b>The washer adapts to the load size and type to add more water to the cycle as needed.</b> <ul style="list-style-type: none"> <li>• Normal operation</li> </ul>  |
|  | <b>The wash load may be unbalanced. If the washer senses that the load is unbalanced, it will stop and refill to redistribute the load.</b> <ul style="list-style-type: none"> <li>• Normal operation</li> </ul>   |
|  | <b>The washer may be diluting laundry additives to add to the wash load.</b> <ul style="list-style-type: none"> <li>• Normal operation</li> </ul>  |
| <b>Rattling and clanking noise</b>   | <b>Foreign objects, such as keys, coins, or safety pins may be in the drum or pump.</b> <ul style="list-style-type: none"> <li>• Stop the washer, check the drum and the drain filter for foreign objects.</li> <li>• If the noise continues after the washer is restarted, call for service.</li> </ul>   |
| <b>Thumping sound</b>  | <b>Heavy wash loads may produce a thumping sound.</b> <ul style="list-style-type: none"> <li>• This is normal, but if the sound continues, the washer is probably out of balance. Stop and redistribute wash load.</li> </ul>  |
|  | <b>Wash load may be out of balance.</b> <ul style="list-style-type: none"> <li>• Pause the cycle and redistribute the load after the door unlocks.</li> </ul>  |
| <b>Vibrating noise</b>   | <b>Packaging materials were not removed.</b> <ul style="list-style-type: none"> <li>• See <b>Unpacking and Removing Shipping Material</b> in <b>INSTALLATION</b>.</li> </ul>   |
|  | <b>Wash load may be unevenly distributed in the drum.</b> <ul style="list-style-type: none"> <li>• Pause the cycle and redistribute the load after the door unlocks.</li> </ul>  |
|  | <b>Not all leveling feet are resting firmly and evenly on the floor.</b> <ul style="list-style-type: none"> <li>• See <b>Leveling the Washer</b> in <b>INSTALLATION</b>.</li> </ul>  |
|  | <b>Floor is not rigid enough.</b> <ul style="list-style-type: none"> <li>• Make sure that the floor is solid and does not flex. See <b>Flooring</b> in <b>INSTALLATION</b>.</li> </ul>   |
| <b>Squeaking noise</b>   | <b>Packaging materials were not removed.</b> <ul style="list-style-type: none"> <li>• See <b>Unpacking and Removing Shipping Material</b> in <b>INSTALLATION</b>.</li> </ul>   |
| <b>Banging noise when the washer is filling with water. (Water hammer)</b> | <b>Plumbing in the home moves or flexes when the water valves in the washer shut off.</b> <ul style="list-style-type: none"> <li>• Water hammer is not caused by a defect in the washer. Install water hammer arrestors (purchased separately at hardware or home improvement store) between the fill hose and the washer for best results.</li> </ul> |
|  | <b>Household water supply pressure is very high.</b> <ul style="list-style-type: none"> <li>• Adjust household water supply regulator to a lower pressure or contact a plumber.</li> </ul>   |

## Operation

| Problem   | Possible Cause & Solution   |
|---|---|
| <b>Water Leaking</b>                            | <p><b>Hoses are not connected correctly.</b></p> <ul style="list-style-type: none"> <li>• Check hoses and connectors for leaks, cracks, and splits.</li> <li>• Check and tighten hose connections.</li> </ul>   |
|   | <p><b>House drain pipes are clogged.</b></p> <ul style="list-style-type: none"> <li>• The washer pumps out water very rapidly. Check for water backing up out of the drain pipe during drain. If water is seen coming out of the drain, check for proper drain hose installation and check for restrictions in the drain.</li> <li>• Contact a plumber to repair drain pipe.</li> </ul>   |
|   | <p><b>Drain hose has come out of the drain connector or is not inserted far enough.</b></p> <ul style="list-style-type: none"> <li>• Tie drain hose to inlet hose or standpipe to prevent it from coming out during drain.</li> <li>• For smaller drain pipes, insert the drain hose into the pipe as far as the drain hose flange. For larger drain pipes, insert the drain hose into the pipe 1 - 2 inches past the flange.</li> </ul>  |
|   | <p><b>Oversudsing of detergent</b></p> <ul style="list-style-type: none"> <li>• Oversudsing may create leaks, and may be caused by the type and amount of detergent used. HE (High-Efficiency) detergent is the only detergent recommended. The normal amount of detergent to use is 1/4 to 1/2 of the maximum amount recommended by the detergent manufacturer.</li> <li>• Always reduce the amount of detergent if the load is small or lightly soiled, or if the water is very soft.</li> <li>• Never use more than the maximum amount recommended by the detergent manufacturer.</li> </ul> |
| <b>Excessive sudsing</b>                        | <p><b>Too much detergent or incorrect detergent</b></p> <ul style="list-style-type: none"> <li>• If using the <b>ezDispense</b> function, change the dispense amount. See the <b>ezDispense</b> section for more information.</li> <li>• HE detergents are formulated specifically for HE (High-Efficiency) washers and contain suds reducing agents. Only use detergent with the HE (High-Efficiency) logo.</li> <li>• Do not put detergent in the manual dispenser while the <b>ezDispense</b> function is turned on.</li> </ul>  |
| <b>The appliance will not turn on.</b>          | <p><b>Power cord is not properly plugged in.</b></p> <ul style="list-style-type: none"> <li>• Make sure that the plug is plugged securely into a grounded, 3-prong, 120-VAC, 60 Hz outlet.</li> </ul>   |
|   | <p><b>House fuse is blown, circuit breaker has tripped, or power outage has occurred.</b></p> <ul style="list-style-type: none"> <li>• Reset circuit breaker or replace fuse. Do not increase fuse capacity. If the problem is a circuit overload, have it corrected by a qualified electrician.</li> </ul>   |
| <b>Wash cycle time is longer than usual.</b>    | <p><b>The washer automatically adjusts the wash time for the amount of laundry, water pressure and other operating conditions.</b></p> <ul style="list-style-type: none"> <li>• This is normal. The washer adjusts cycle time automatically to provide optimal results for the selected cycle. The time remaining shown in the display is only an estimate. Actual time may vary.</li> </ul>  |
| <b>Incomplete or no dispensing of detergent</b> | <p><b>Detergent compartments clogged from incorrect filling.</b></p> <ul style="list-style-type: none"> <li>• Make sure that detergent and additives are put into the correct <b>ezDispense</b> reservoirs.</li> <li>• For all detergent types, always make sure that the dispenser drawer is fully closed before the start of the cycle.</li> </ul>  |

| Problem  | Possible Cause & Solution   |
|--|---|
| <b>Incomplete or no dispensing of detergent</b>  | <p><b>Too much detergent used.</b></p> <ul style="list-style-type: none"> <li>Make sure that the suggested amount of detergent is used according to the manufacturer's recommendations. You may also dilute the detergent with water to the maximum fill line on the compartment to avoid clogging. Use only HE (High-Efficiency) detergent.</li> </ul> <hr/> <p><b>NOTE</b></p> <ul style="list-style-type: none"> <li>Always use as little detergent as possible. HE (High-Efficiency) washers need very little detergent to achieve optimum results. Using too much detergent will cause poor wash and rinse performance and may contribute to odors in the washer.</li> </ul> <hr/> |
|  | <p><b>Insufficient water supply</b></p> <ul style="list-style-type: none"> <li>Make sure that both hot and cold water faucets are turned on all the way.</li> </ul>   |
|  | <p><b>Normal residue</b></p> <ul style="list-style-type: none"> <li>It is normal for a small amount of detergent to remain in the dispenser. If this residue builds up, it can interfere with normal dispensing of detergents. Refer to the cleaning instructions.</li> </ul>   |
|  | <b>Washer will not operate.</b>   |
| <p><b>Washer is unplugged.</b></p> <ul style="list-style-type: none"> <li>Make sure that the power cord is plugged securely into an electrical outlet.</li> </ul>  |   |
| <p><b>Water supply is turned off.</b></p> <ul style="list-style-type: none"> <li>Turn both hot and cold faucets fully on.</li> </ul>   |   |
| <p><b>Controls are not set properly.</b></p> <ul style="list-style-type: none"> <li>Make sure that the cycle was set correctly, close the door and press the <b>Start/Pause</b> button to start the wash cycle.</li> </ul>   |   |
| <p><b>Door is open.</b></p> <ul style="list-style-type: none"> <li>Close the door and make sure that nothing is caught under the door preventing it from closing completely.</li> </ul>  |   |
| <p><b>Circuit breaker/fuse is tripped/blown.</b></p> <ul style="list-style-type: none"> <li>Check house circuit breakers/fuses. Replace fuses or reset breaker. The washer should be on a dedicated branch circuit.</li> </ul>   |   |
| <p><b>Start/Pause button was not pressed after the cycle was set.</b></p> <ul style="list-style-type: none"> <li>Press the <b>Power</b> button then reselect the desired cycle and press the <b>Start/Pause</b> button. If the <b>Start/Pause</b> button is not pressed within a certain time, the washer will be turned off. (The time varies by model, from 4 to 60 minutes.)</li> </ul> |   |
| <p><b>Extremely low water pressure.</b></p> <ul style="list-style-type: none"> <li>Check another faucet in the house to make sure that household water pressure is adequate.</li> </ul>  |   |
| <p><b>Washer is too cold.</b></p> <ul style="list-style-type: none"> <li>If the washer has been exposed to temperatures below freezing for an extended period of time, allow it to warm up before pressing the <b>Power</b> button. Otherwise, the display will not come on.</li> </ul>  |   |
| <b>Washer stops for a few minutes and then restarts.</b>   | <p><b>A motor protection device has been activated to prevent overheating of the motor.</b></p> <ul style="list-style-type: none"> <li>This is normal. If the motor protection device is activated, the washer will stop for a few minutes and then start again.</li> </ul>   |
| <b>Washer is not filling properly.</b>   | <p><b>Filter is clogged.</b></p> <ul style="list-style-type: none"> <li>Make sure that inlet filters on the fill valves are not clogged. Refer to <b>Cleaning the Water Inlet Filters</b> in <b>MAINTENANCE</b>.</li> </ul>   |

| Problem   | Possible Cause & Solution   |
|---|---|
| <b>Washer is not filling properly.</b>                      | <b>Inlet hoses may be kinked.</b> <ul style="list-style-type: none"> <li>Check that inlet hoses are not kinked or clogged.</li> </ul>   |
|   | <b>Energy efficiency</b> <ul style="list-style-type: none"> <li>This is a High-Efficiency (HE) washer. As a result, the water level settings for this washer may be different than for a conventional washer.</li> </ul>  |
|   | <b>Insufficient water supply</b> <ul style="list-style-type: none"> <li>Make sure that both hot and cold water faucets are turned on all the way.</li> </ul>  |
|   | <b>Washer door is open.</b> <ul style="list-style-type: none"> <li>Close the door and make sure that nothing is caught under the door preventing it from closing completely.</li> </ul>   |
|   | <b>Water level is too low.</b> <ul style="list-style-type: none"> <li>The water will not normally cover the clothes. The fill level is optimized for the wash motion to achieve the best wash performance.</li> </ul>   |
| <b>Water in the washer does not drain or drains slowly.</b> | <b>Drain hose is kinked, pinched, or clogged.</b> <ul style="list-style-type: none"> <li>Make sure that the drain hose is free of clogs or kinks and is not pinched behind or under the washer.</li> </ul>  |
|   | <b>The end of the drain hose is more than 96 inches (2.4 m) above the bottom of the washer.</b> <ul style="list-style-type: none"> <li>Move the end of the drain hose so that it is lower than 96 inches (2.4 m). For best performance, the end of the drain hose should be no higher than 66 inches (168 cm).</li> </ul> |

## Performance

| Problem          | Possible Cause & Solution  |
|------------------|--|
| <b>Wrinkling</b> | <b>Washer is not unloaded promptly.</b> <ul style="list-style-type: none"> <li>Always remove items from the washer as soon as the cycle is complete.</li> </ul>  |
|                  | <b>Washer is overloaded.</b> <ul style="list-style-type: none"> <li>The washer can be fully loaded, but the drum should not be tightly packed with items. The door of the washer should close easily.</li> </ul>   |
|                  | <b>Hot and cold water inlet hoses are reversed.</b> <ul style="list-style-type: none"> <li>Hot water rinse can set wrinkles in garments. Check the Inlet hose connectors.</li> </ul>   |
|                  | <b>Clothes dried too long (overdried).</b> <ul style="list-style-type: none"> <li>Overdrying a load of laundry can lead to wrinkled clothes. Try a shorter drying time or use a lower dry level setting and remove items while they still retain a slight amount of moisture.</li> </ul>   |
|                  | <b>Clothes left in appliance too long after cycle ends.</b> <ul style="list-style-type: none"> <li>Use the <b>Fresh Care</b> option. This option will tumble the clothes briefly every few minutes for up to 3 hours to help prevent wrinkling.</li> </ul>   |
| <b>Staining</b>  | <b>Bleach or softener was added directly to the wash load in the drum.</b> <ul style="list-style-type: none"> <li>Always use the dispensers to ensure that laundry products are properly dispensed at the right time in the cycle.</li> <li>On models without a bleach dispenser, use a chlorine bleach pack that can be placed directly in the drum. (Use only with warm or hot water temperatures and white clothes.)</li> </ul> |
|                  | <b>Washer was not unloaded promptly.</b> <ul style="list-style-type: none"> <li>Always remove items from the washer as soon as possible after the cycle is completed.</li> </ul>   |

| Problem                             | Possible Cause & Solution   |
|-------------------------------------|---|
| Staining                            | <b>Clothes were not properly sorted.</b> <ul style="list-style-type: none"> <li>Always wash dark colors separately from light colors and whites to prevent discoloration.</li> <li>Never wash heavily soiled items with lightly soiled items.</li> </ul>  |
|                                     | <b>Clean and dirty clothes are being dried together.</b> <ul style="list-style-type: none"> <li>Use your appliance to dry only clean items. Soil from dirty clothes can transfer to the clean clothes in the same or later loads.</li> </ul>  |
|                                     | <b>Clothes were not properly cleaned or rinsed before being placed in the appliance.</b> <ul style="list-style-type: none"> <li>Stains on dried clothes could be stains that were not removed during the washing process. Make sure that clothes are being completely cleaned or rinsed according to the instructions for your washer and detergent. Some difficult soils may require pre-treating prior to washing.</li> </ul> |
| Poor stain removal                  | <b>Proper options are not selected.</b> <ul style="list-style-type: none"> <li>Heavier soils and tougher stains may require extra cleaning power. Select the <b>Heavy</b> feature to boost the cleaning power of the selected cycle.</li> </ul>   |
|                                     | <b>Previously set stains.</b> <ul style="list-style-type: none"> <li>Articles that have previously been washed may have stains that have been set. These stains may be difficult to remove and may require hand washing or pre-treating to aid in stain removal.</li> </ul>   |
| Musty or mildewy odor in the washer | <b>Incorrect or too much detergent has been used.</b> <ul style="list-style-type: none"> <li>Use only HE (High-Efficiency) detergent in accordance with the manufacturer's instructions.</li> </ul>   |
|                                     | <b>Inside of the drum was not cleaned properly.</b> <ul style="list-style-type: none"> <li>Run the <b>Tub Clean</b> cycle regularly.</li> </ul>   |

## Odor

| Problem | Possible Cause & Solution  |
|---------|--|
| Odor    | <b>Some odor is caused by the rubber attached to the washing machine.</b> <ul style="list-style-type: none"> <li>This odor is normal for new rubber and will disappear after the machine has been run a few times.</li> </ul>  |
|         | <b>If the rubber door gasket and door seal area are not cleaned regularly, odors can occur from mold or foreign substances.</b> <ul style="list-style-type: none"> <li>Be sure to clean the gasket and door seal regularly and check under the door seal for small items when unloading the washer.</li> </ul> |
|         | <b>Odors can occur if foreign substances are left in the drainage pump filter.</b> <ul style="list-style-type: none"> <li>Be sure to clean the drainage pump filter regularly.</li> </ul>  |
|         | <b>Odors can occur if the drainage hose is not properly installed, causing siphoning (water flowing back inside the washing machine).</b> <ul style="list-style-type: none"> <li>When installing the drainage hose, be sure that it doesn't become kinked or blocked.</li> </ul>                               |

## ezDispense

| Problem  | Possible Cause & Solution  |
|--|--|
| <b>Refill Alarm continues to display when detergent/softener is added.</b> | <b>Detergent/softener has built up on the fluid level sensor.</b> <ul style="list-style-type: none"> <li>Open the reservoir covers and clean the insides of the <b>ezDispense</b> reservoirs with warm water. Use a soft brush to remove any residue. If the <b>Refill Alarm</b> is displayed continuously, call for service.</li> </ul> |

| Problem  | Possible Cause & Solution  |
|--|--|
| <b>Refill Alarm continues to display when detergent/softener is added.</b> | <p><b>The amount of detergent/softener is not enough for the sensor to detect.</b></p> <ul style="list-style-type: none"> <li>• Fill the detergent/softener up to the <b>MAX</b> line in the compartment.</li> </ul> |
| <b>Too much/too little detergent or softener dispensed.</b>                | <p><b>The default dispense amounts setting may need to be changed.</b></p> <ul style="list-style-type: none"> <li>• Check and change the default dispense amounts setting.</li> </ul>                                |
| <b>The ezDispense doesn't dispense detergent/softener.</b>                 | <p><b>The ezDispense function is off.</b></p> <ul style="list-style-type: none"> <li>• Turn on the Auto Det. and Auto Soft. settings.</li> </ul>   |
|  | <p><b>The ventilation holes are blocked.</b></p> <ul style="list-style-type: none"> <li>• Clean the ventilation holes for the lids on the reservoirs with warm water.</li> </ul>                                     |
|  | <p><b>The detergent or softener in the ezDispense reservoirs has hardened.</b></p> <ul style="list-style-type: none"> <li>• Clean the <b>ezDispense</b> reservoirs and change the detergent or softener.</li> </ul>  |

## Wi-Fi

| Problem   | Possible Cause & Solution   |
|---|---|
| <b>Trouble connecting appliance and smartphone to Wi-Fi network</b> | <p><b>The password for the Wi-Fi network was entered incorrectly.</b></p> <ul style="list-style-type: none"> <li>• Delete your home Wi-Fi network and begin the connection process again.</li> </ul>  |
|   | <p><b>Mobile data for your smartphone is turned on.</b></p> <ul style="list-style-type: none"> <li>• Turn off the <b>Mobile data</b> on your smartphone before connecting the appliance.</li> </ul>   |
|   | <p><b>The wireless network name (SSID) is set incorrectly.</b></p> <ul style="list-style-type: none"> <li>• The wireless network name (SSID) should be a combination of English letters and numbers. (Do not use special characters.)</li> </ul>  |
|   | <p><b>The router frequency is not 2.4 GHz.</b></p> <ul style="list-style-type: none"> <li>• Only a 2.4 GHz router frequency is supported. Set the wireless router to 2.4 GHz and connect the appliance to the wireless router. To check the router frequency, check with your Internet service provider or the router manufacturer.</li> </ul>  |
|   | <p><b>The appliance and the router are too far apart.</b></p> <ul style="list-style-type: none"> <li>• If the appliance is too far from the router, the signal may be weak and the connection may not be configured correctly. Move the router closer to the appliance or purchase and install a Wi-Fi repeater.</li> </ul>   |
|   | <p><b>LG ThinQ is asking for a password to connect to the product.</b></p> <ul style="list-style-type: none"> <li>• If you are asked to provide a password to connect to the <b>product</b> (not to your home network) during the Wi-Fi setup, enter the last 4 characters of the network name, repeated twice, with no spaces. For example, if the network name appears as LG_XXXX_8b92, then you would enter 8b928b92 as your password. The password is case sensitive and the last 4 characters are unique to your appliance.</li> </ul> |

# LIMITED WARRANTY

## USA

### TERMS AND CONDITIONS

**ARBITRATION NOTICE: THIS LIMITED WARRANTY CONTAINS AN ARBITRATION PROVISION THAT REQUIRES YOU AND LG ELECTRONICS (“LG”) TO RESOLVE DISPUTES BY BINDING ARBITRATION INSTEAD OF IN COURT, UNLESS YOU CHOOSE TO OPT OUT. IN ARBITRATION, CLASS ACTIONS AND JURY TRIALS ARE NOT PERMITTED. PLEASE SEE THE SECTION TITLED “PROCEDURE FOR RESOLVING DISPUTES” BELOW.**

Should your LG Washer (“Product”) fail due to a defect in materials or workmanship under normal and proper use, during the warranty period set forth below, LG will, at its option, repair or replace the Product. This limited warranty is valid only to the original retail purchaser of the Product (“You”) and applies only when purchased lawfully and used within the United States including U.S. Territories.

| WARRANTY PERIOD   |  |   |
|---|--|---|
| Washer  | Direct Drive Motor (Stator or Rotor)   | Stainless Steel Drum  |
| Parts (internal/ functional parts only) and Labor: One (1) year from the date of original retail purchase, or from the date of delivery as per applicable law | Parts Only: Ten (10) years from the date of original retail purchase, or from the date of delivery as per applicable law<br>You are responsible for any applicable labor cost. | Parts Only: Three (3) years from the date of original retail purchase, or from the date of delivery as per applicable law<br>You are responsible for any applicable labor cost. |

- Replacement Products and parts are warranted for the remaining portion of the original warranty period or ninety (90) days, whichever is greater.
- Replacement Products and parts may be new, reconditioned, refurbished, or otherwise factory remanufactured.
- Replaced Product or part(s) will be the property of LG.
- Proof of original retail purchase specifying the Product model and date of purchase is required to obtain warranty service under this limited warranty.

**EXCEPT TO THE EXTENT PROHIBITED BY APPLICABLE LAW, ANY IMPLIED WARRANTY OF MERCHANTABILITY OR FITNESS FOR A PARTICULAR PURPOSE ON THE PRODUCT IS LIMITED IN DURATION TO THE DURATION OF THE ABOVE LIMITED WARRANTY. UNDER NO CIRCUMSTANCES SHALL LG OR ITS U.S. DISTRIBUTORS/DEALERS BE LIABLE FOR ANY INDIRECT, INCIDENTAL, CONSEQUENTIAL, SPECIAL, OR PUNITIVE DAMAGES, INCLUDING, WITHOUT LIMITATION, LOST GOODWILL, LOST REVENUES OR PROFITS, WORK STOPPAGE, IMPAIRMENT OF OTHER GOODS, COST OF REMOVAL AND REINSTALLATION OF THE PRODUCT, LOSS OF USE, OR ANY OTHER DAMAGES WHETHER BASED IN CONTRACT, TORT, OR OTHERWISE. LG’S TOTAL LIABILITY, IF ANY, SHALL NOT EXCEED THE PURCHASE PRICE PAID BY YOU FOR THE PRODUCT.**

**SOME STATES DO NOT ALLOW THE EXCLUSION OR LIMITATION OF INCIDENTAL OR CONSEQUENTIAL DAMAGES OR LIMITATIONS ON HOW LONG AN IMPLIED WARRANTY LASTS, SO THE ABOVE EXCLUSIONS OR LIMITATIONS MAY NOT APPLY TO YOU. THIS LIMITED WARRANTY GIVES YOU SPECIFIC LEGAL RIGHTS AND YOU MAY ALSO HAVE OTHER RIGHTS THAT VARY FROM STATE TO STATE.**

### THIS LIMITED WARRANTY DOES NOT COVER:

- Service trips to deliver, pick up, or install, educate how to operate, correct wiring, or correct unauthorized repairs.
- Damage or failure of the Product to perform during power failures and interrupted or inadequate electrical service.

- Damage or failure of the Product caused by leaky or broken water pipes, frozen water pipes, restricted drain lines, inadequate or interrupted water supply or inadequate supply of air.
- Damage or failure of the Product resulting from operating the Product in a corrosive atmosphere or contrary to the Product owner's manual.
- Damage or failure of the Product caused by accidents, pests and vermin, lightning, wind, fire, floods, acts of nature, or any other causes beyond the control of LG.
- Damage or failure of the Product caused by unauthorized modification or alteration, or if the Product is used for other than the intended purpose, or any water leakage where the Product was not properly installed.
- Damage or failure of the Product caused by incorrect electrical current, voltage, or plumbing codes.
- Damage or failure of the Product caused by transportation, storage, and/or handling, including scratches, dents, chips, and/or other damage to the finish of the Product, unless such damage is reported within one (1) week of delivery.
- Damage or failure of the Product resulting from misuse, abuse, improper installation, repair, or maintenance. Improper repair includes the use of parts not authorized by LG. Improper installation or maintenance includes installation or maintenance contrary to the Product owner's manual.
- Damage or failure of the Product caused by the use of parts, components, accessories, consumable cleaning products, or any other products or services that were not authorized by LG.
- Damage or missing items to any display or open box Product.
- Refurbished Product or any Product sold "As Is", "Where Is", "With all Faults", or similar disclaimer.
- Products with original serial numbers that have been removed, altered, or cannot be readily determined.
- Increases in utility costs and additional utility expenses.
- Any noises associated with normal operation.
- Products used for other than normal and proper household use (e.g., commercial or industrial use) or contrary to the Product owner's manual.
- Costs associated with removal and reinstallation of the Product for repairs, or the removal and reinstallation of the Product if it is installed in an inaccessible location or not installed in accordance with the Product Owner's manual.
- Accessories, removable components, or consumable parts (e.g. Shelves, door bins, drawers, water/air filters, racks, light bulbs, batteries, etc., as applicable), except for internal/functional parts covered under this limited warranty.

**The cost of repair or replacement under these excluded circumstances shall be borne by You.**

TO OBTAIN WARRANTY SERVICE AND ADDITIONAL INFORMATION

Call 1-800-243-0000 and select the appropriate option from the menu.

Or visit our website at <http://www.lg.com>

Or by mail: LG Electronics Customer Service P.O. Box 240007 Huntsville, AL 35813 ATTN: CIC

## PROCEDURE FOR RESOLVING DISPUTES:

ALL DISPUTES BETWEEN YOU AND LG ARISING OUT OF OR RELATING IN ANY WAY TO THIS LIMITED WARRANTY OR THE PRODUCT SHALL BE RESOLVED EXCLUSIVELY THROUGH BINDING ARBITRATION, AND NOT IN A COURT OF GENERAL JURISDICTION. BINDING ARBITRATION MEANS THAT YOU AND LG ARE EACH WAIVING THE RIGHT TO A JURY TRIAL AND TO BRING OR PARTICIPATE IN A CLASS ACTION.

**Definitions.** For the purposes of this section, references to "LG" mean LG Electronics U.S.A., Inc., its parents, subsidiaries and affiliates, and each of their officers, directors, employees, agents, beneficiaries, predecessors in interest, successors, assigns and suppliers; references to "dispute" or "claim" shall include any dispute, claim or controversy of any kind whatsoever (whether based in contract, tort, statute, regulation, ordinance, fraud, misrepresentation or any other legal or equitable theory) arising out of or relating in any way to the sale, condition or performance of the product or this Limited Warranty.

**Notice of Dispute.** In the event you intend to commence an arbitration proceeding, you must first notify LG in writing at least 30 days in advance of initiating the arbitration by sending a letter to LG at LG

Electronics, USA, Inc. Attn: Legal Department- Arbitration 111 Sylvan Avenue, Englewood Cliffs, NJ 07632. You and LG agree to engage in good faith discussions in an attempt to amicably resolve your claim. The notice must provide your name, address, and telephone number; identify the product that is the subject of the claim; and describe the nature of the claim and the relief being sought. If you and LG are unable to resolve the dispute within 30 days, either party may proceed to file a claim for arbitration.

**Agreement to Binding Arbitration and Class Action Waiver.** Upon failure to resolve the dispute during the 30 day period after sending written notice to LG, you and LG agree to resolve any claims between us only by binding arbitration on an individual basis, unless you opt out as provided below. Any dispute between you and LG shall not be combined or consolidated with a dispute involving any other person's or entity's product or claim. More specifically, without limitation of the foregoing, any dispute between you and LG shall not under any circumstances proceed as part of a class or representative action. Instead of arbitration, either party may bring an individual action in small claims court, but that small claims court action may not be brought on a class or representative basis.

**Arbitration Rules and Procedures.** To begin arbitration of a claim, either you or LG must make a written demand for arbitration. The arbitration will be administered by the American Arbitration Association ("AAA") and will be conducted before a single arbitrator under the AAA's Consumer Arbitration Rules that are in effect at the time the arbitration is initiated (referred to as the "AAA Rules") and under the procedures set forth in this section. The AAA Rules are available online at [www.adr.org/consumer](http://www.adr.org/consumer). Send a copy of your written demand for arbitration, as well as a copy of this provision, to the AAA in the manner described in the AAA Rules. You must also send a copy of your written demand to LG at LG Electronics, USA, Inc. Attn: Legal Department- Arbitration 111 Sylvan Avenue, Englewood Cliffs, NJ 07632. If there is a conflict between the AAA Rules and the rules set forth in this section, the rules set forth in this section will govern. This arbitration provision is governed by the Federal Arbitration Act. Judgment may be entered on the arbitrator's award in any court of competent jurisdiction. All issues are for the arbitrator to decide, except that issues relating to the scope and enforceability of the arbitration provision and to the arbitrability of the dispute are for the court to decide. The arbitrator is bound by the terms of this provision.

**Governing Law.** The law of the state of your residence shall govern this Limited Warranty and any disputes between us except to the extent that such law is preempted by or inconsistent with applicable federal law.

**Fees/Costs.** You do not need to pay any fee to begin an arbitration. Upon receipt of your written demand for arbitration, LG will promptly pay all arbitration filing fees to the AAA unless you seek more than \$25,000 in damages, in which case the payment of these fees will be governed by the AAA Rules. Except as otherwise provided for herein, LG will pay all AAA filing, administration and arbitrator fees for any arbitration initiated in accordance with the AAA Rules and this arbitration provision. If you prevail in the arbitration, LG will pay your attorneys' fees and expenses as long as they are reasonable, by considering factors including, but not limited to, the purchase amount and claim amount. Notwithstanding the foregoing, if applicable law allows for an award of reasonable attorneys' fees and expenses, an arbitrator can award them to the same extent that a court would. If the arbitrator finds either the substance of your claim or the relief sought in the demand is frivolous or brought for an improper purpose (as measured by the standards set forth in Federal Rule of Civil Procedure 11(b)), then the payment of all arbitration fees will be governed by the AAA Rules. In such a situation, you agree to reimburse LG for all monies previously disbursed by it that are otherwise your obligation to pay under the AAA Rules. Except as otherwise provided for, LG waives any rights it may have to seek attorneys' fees and expenses from you if LG prevails in the arbitration.

**Hearings and Location.** If your claim is for \$25,000 or less, you may choose to have the arbitration conducted solely on the basis of (1) documents submitted to the arbitrator, (2) through a telephonic hearing, or (3) by an in-person hearing as established by the AAA Rules. If your claim exceeds \$25,000, the right to a hearing will be determined by the AAA Rules. Any in-person arbitration hearings will be held at a location within the federal judicial district in which you reside unless we both agree to another location or we agree to a telephonic arbitration.

**Opt Out.** You may opt out of this dispute resolution procedure. If you opt out, neither you nor LG can require the other to participate in an arbitration proceeding. To opt out, you must send notice to LG no later than 30 calendar days from the date of the first consumer purchaser's purchase of the product by either: (i) sending an e-mail to [optout@lge.com](mailto:optout@lge.com), with the subject line: "Arbitration Opt Out" or (ii) calling 1-800-980-2973. You must include in the opt out e-mail or provide by telephone: (a) your name and address; (b) the date on which the product was purchased; (c) the product model name or model number; and (d)

---

the serial number (the serial number can be found (i) on the product; or (ii) online by accessing <https://www.lg.com/us/support> and clicking on "How do I find my model number?").

You may only opt out of the dispute resolution procedure in the manner described above (that is, by e-mail or telephone); no other form of notice will be effective to opt out of this dispute resolution procedure. Opting out of this dispute resolution procedure will not affect the coverage of the Limited Warranty in any way, and you will continue to enjoy the full benefits of the Limited Warranty. If you keep this product and do not opt out, then you accept all terms and conditions of the arbitration provision described above.





# LG SIGNATURE

## Customer Information Center

For inquiries or comments, call;

1-800-984-6306 USA, Consumer User  
1-888-865-3026 USA, Commercial User  
1-888-542-2623 CANADA

## Centro de Información al Cliente

Para consultas o comentarios, llame por teléfono:

1-800-984-6306 EE.UU., Usuario Consumidor  
1-888-865-3026 EE.UU., Usuario Comercial  
1-888-542-2623 CANADÁ

## Centre de Service à la Clientèle

Pour des questions ou des commentaires, appelez :

1-800-984-6306 ÉTATS-UNIS, Consommateur  
1-888-865-3026 ÉTATS-UNIS, Utilisateur Commercial  
1-888-542-2623 CANADA