

## 30" Panel-Ready Column Freezer

# JBZFR30IGX (Right Swing)



## Features

### Daring Obsidian Interior

Inspired by volcanic glass, this dark finish erupts with reflective, high-contrast style. Let fine foods emerge like vibrant art, begging to be devoured.

### Ecliptic Lighting

Live beyond the shadow, live beyond puck lighting. Over 650 LEDs frame and fill your column, coming alive at a touch of the controls. Each item illuminates in dramatic glory.

### Divinity Freezing

One provocative air tower. Two precision sensors. Calibrated every second. Master temperatures to keep humidity controlled and spirits impeccably chilled.

### Remote Access

Open door. Power outages. Filter changes. Connect to WiFi for real-time notifications and control your columns from anywhere. Tap and swipe on both iOS and Android devices.

### Solid Glass and Metal

All-metal bins and shelf frames. Thick, naturally odor-resistant solid glass. A forcefield at the edge that prevents spillovers. To hell with cheap plastic in luxury designs.



## Accessories

Handle Kits	RISE™	W11220302
	NOIR™	W11220303

Panel Kits	RISE™	JKCPR301GL
	NOIR™	JKCPR301GM

Join Kits	LH to RH	JAJ31HSS
	LH to LH	JAJ12HSS
	RH to RH	JAJ11HSS

Toe Kicks <i>Key: JACxxyyHB/S</i> <i>xx = left unit width</i> <i>yy = right unit width</i> <i>B/S = black or stainless steel</i>	JAC1830H	JAC3024H
	JAC2430H	JAC3630H
	JAC3018H	JAC3036H
	JAC3030H	

Water Filter	EDR2RXD1
--------------	----------

## Product Details

Dimensions	29 ¾"W x 83 ½"H x 23 ⅞"D
------------	--------------------------

Cutout Dimensions	30"W x 84"H x 25" D
-------------------	---------------------

Capacity	17.0 Cu Ft
----------	------------

Icemaker	Automatic Prism Ice
----------	---------------------

Shelves	3 Adjustable, 1 Fixed
---------	-----------------------

Drawers	3 Temp Controlled
---------	-------------------

Door Bins	4 Adjustable Bins
-----------	-------------------

Energy Rating	588 kWh
---------------	---------

# 30" Panel-Ready Column Freezer, Right Swing

# JBZFR30IGX



## Water & Electrical

### WATER SUPPLY REQUIREMENTS

Water Pressure	30 – 120 psi (207 – 827 kPa)
Water Pressure to Reverse Osmosis System	Minimum 40 – 60 psi (276 – 414 kPa)
Excess Water Line for Connection	30" (76.2 cm)
Supply	1/4" OD copper, braided stainless steel or PEX tubing

### Recommended Grounding Method

A 115 V, 60 Hz, AC-only 15 A or 20 A fused, grounded electrical supply is required. Max amp draw for one column is 3.9 A. It is recommended that a separate circuit serving only your refrigerator and approved accessories be provided. Use an outlet that cannot be turned off by a switch. Do not use an extension cord.

## Custom Panel Dimensions

Thickness	3/4" (1.9 cm) max.
Weight	60 lbs. (27.2 kg) max.
Typical Height	80" (203.2 cm)

## CUSTOM PANEL WIDTH

### CAUTION

#### Pinch Hazard

Installation of door panels with less than a 3/8" (0.95 cm) gap between the door panel and the adjacent cabinet increases the risk of potential pinching.

MODEL	FLUSH WIDTH
18"	17-3/4" (45.1 cm)
24"	23-3/4" (60.3 cm)
30"	29-3/4" (75.6 cm)
36"	35-3/4" (90.8 cm)

## Cutout Dimensions

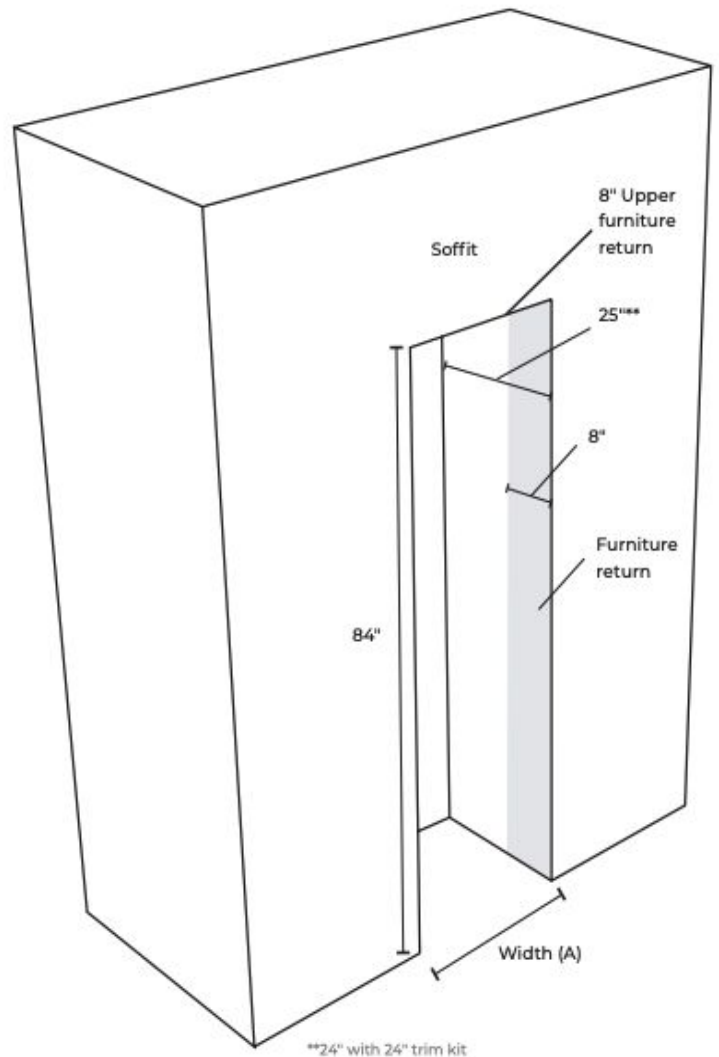

### Opening Width (A)

18"	18" (45.7 cm)
24"	24" (61 cm)
30"	30" (76.2 cm)
36"	36" (91.4 cm)