

# 24" Panel-Ready Column Refrigerator

## JBRFR24IGX (Right Swing)



### Features

#### Daring Obsidian Interior

Inspired by volcanic glass, this dark finish erupts with reflective, high-contrast style. Let fine foods emerge like vibrant art, begging to be devoured.

#### Ecliptic Lighting

Live beyond the shadow, live beyond puck lighting. Over 650 LEDs frame and fill your column, coming alive at a touch of the controls. Each item illuminates in dramatic glory.

#### Trinity Cooling

Three zones. Three precision sensors. Calibrated every second. Command temperatures and humidity in each zone with an exposed air tower for total control.

#### Remote Access

Open door. Power outages. Filter changes. Connect to WiFi for real-time notifications and control your columns from anywhere. Tap and swipe on both iOS and Android devices.

#### Solid Glass and Metal

All-metal bins and shelf frames. Thick, naturally odor-resistant solid glass. A forcefield at the edge that prevents spillovers. To hell with cheap plastic in luxury designs.



### Accessories

Handle Kits	RISE™ NOIR™	W11220302 W11220303
Panel Kits	RISE™ NOIR™	JKCPR24IGL JKCPR24IGM
Join Kits	LH to RH LH to LH RH to RH	JAJ31HSS JAJ12HSS JAJ11HSS
Toe Kicks <i>Key: JACxxyyHB/S</i> <i>xx = left unit width</i> <i>yy = right unit width</i> <i>B/S = black or stainless steel</i>	JAC1824H JAC2424H JAC2418H JAC243H(R unit 36")	JAC3024H JAC3624H JAC2430H
Water Filter	EDR2RXD1	

### Product Details

Dimensions	23 3/4"W x 83 1/2"H x 23 7/8"D
Cutout Dimensions	24"W x 84"H x 25" D
Capacity	13.0 Cu Ft
Water Dispenser	Filtered Internal Water
Shelves	3 Adjustable, 1 Fixed
Drawers	3 Temp Controlled
Door Bins	4 Adjustable Gallon
Energy Rating	300 kWh

# 24" Panel-Ready Column Refrigerator, Right Swing

# JBRFR24IGX



## Water & Electrical

### WATER SUPPLY REQUIREMENTS

Water Pressure	30 – 120 psi (207 – 827 kPa)
Water Pressure to Reverse Osmosis System	Minimum 40 – 60 psi (276 – 414 kPa)
Excess Water Line for Connection	30" (76.2 cm)
Supply	1/4" OD copper, braided stainless steel or PEX tubing

### Recommended Grounding Method

A 115 V, 60 Hz, AC-only 15 A or 20 A fused, grounded electrical supply is required. Max amp draw for one column is 3.9 A. It is recommended that a separate circuit serving only your refrigerator and approved accessories be provided. Use an outlet that cannot be turned off by a switch. Do not use an extension cord.

## Custom Panel Dimensions

Thickness	3/4" (1.9 cm) max.
Weight	60 lbs. (27.2 kg) max.
Typical Height	80" (203.2 cm)

## CUSTOM PANEL WIDTH

### CAUTION

#### Pinch Hazard

Installation of door panels with less than a 3/8" (0.95 cm) gap between the door panel and the adjacent cabinet increases the risk of potential pinching.

MODEL	FLUSH WIDTH
18"	17-3/4" (45.1 cm)
24"	23-3/4" (60.3 cm)
30"	29-3/4" (75.6 cm)
36"	35-3/4" (90.8 cm)

## Cutout Dimensions

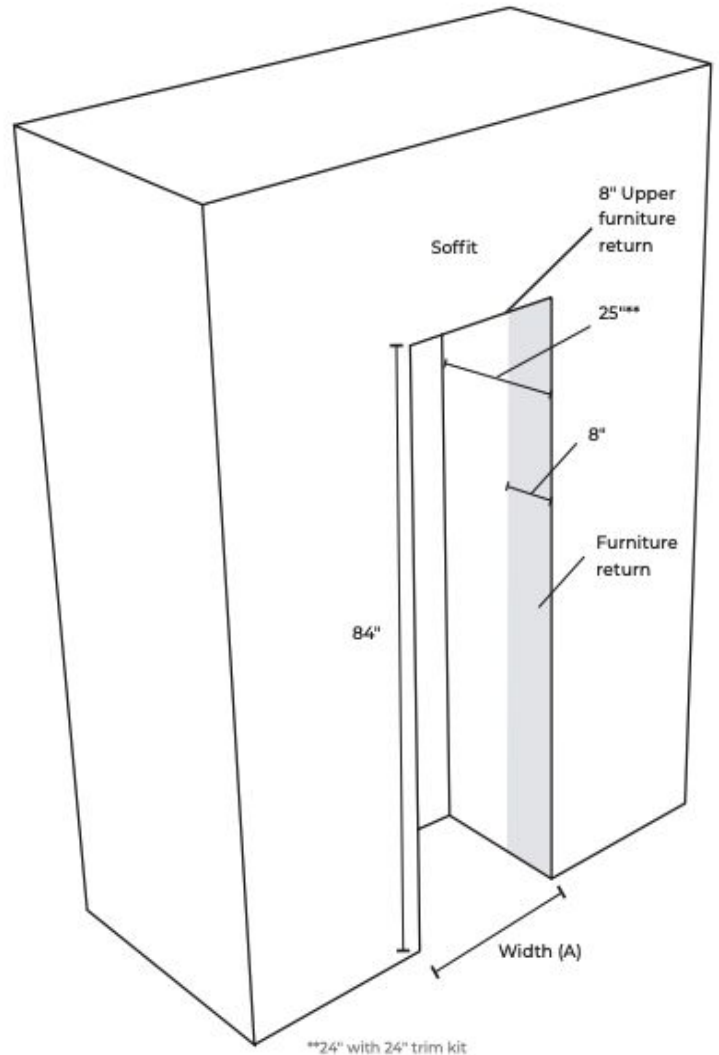

### Opening Width (A)

18"	18" (45.7 cm)
24"	24" (61 cm)
30"	30" (76.2 cm)
36"	36" (91.4 cm)