

36" Panel-Ready Column Refrigerator

JBRFL36IGX (Left Swing)



Features

Daring Obsidian Interior

Inspired by volcanic glass, this dark finish erupts with reflective, high-contrast style. Let fine foods emerge like vibrant art, begging to be devoured.

Ecliptic Lighting

Live beyond the shadow, live beyond puck lighting. Over 650 LEDs frame and fill your column, coming alive at a touch of the controls. Each item illuminates in dramatic glory.

Trinity Cooling

Three zones. Three precision sensors. Calibrated every second. Command temperatures and humidity in each zone with an exposed air tower for total control.

Remote Access

Open door. Power outages. Filter changes. Connect to WiFi for real-time notifications and control your columns from anywhere. Tap and swipe on both iOS and Android devices.

Solid Glass and Metal

All-metal bins and shelf frames. Thick, naturally odor-resistant solid glass. A forcefield at the edge that prevents spills. To hell with cheap plastic in luxury designs.



Accessories

Handle Kits	RISE™ NOIR™	W11220302 W11220303
Panel Kits	RISE™ NOIR™	JKCPL361GL JKCPL361GM
Join Kits	LH to RH LH to LH RH to RH	JAJ31HSS JAJ12HSS JAJ11HSS
Toe Kicks <i>Key: JACxxyyHB/S</i> <i>xx = left unit width</i> <i>yy = right unit width</i> <i>B/S = black or stainless steel</i>	JAC1836H JAC2436H JAC3618H JAC3636H	JAC3624H JAC3630H JAC3036H
Water Filter	EDR2RXD1	

Product Details

Dimensions	35 3/4"W x 83 1/2"H x 23 7/8"D
Cutout Dimensions	36"W x 84"H x 25" D
Capacity	20.0 Cu Ft
Water Dispenser	Filtered Internal Water
Shelves	3 Adjustable, 1 Fixed
Drawers	3 Temp Controlled
Door Bins	4 Adjustable Gallon
Energy Rating	516 kWh

36" Panel-Ready Column Refrigerator, Left Swing

JBRFL36IGX



Water & Electrical

WATER SUPPLY REQUIREMENTS

Water Pressure	30 – 120 psi (207 – 827 kPa)
Water Pressure to Reverse Osmosis System	Minimum 40 – 60 psi (276 – 414 kPa)
Excess Water Line for Connection	30" (76.2 cm)
Supply	1/4" OD copper, braided stainless steel or PEX tubing

Recommended Grounding Method

A 115 V, 60 Hz, AC-only 15 A or 20 A fused, grounded electrical supply is required. Max amp draw for one column is 3.9 A. It is recommended that a separate circuit serving only your refrigerator and approved accessories be provided. Use an outlet that cannot be turned off by a switch. Do not use an extension cord.

Custom Panel Dimensions

Thickness	3/4" (1.9 cm) max.
Weight	60 lbs. (27.2 kg) max.
Typical Height	80" (203.2 cm)

CUSTOM PANEL WIDTH

CAUTION

Pinch Hazard

Installation of door panels with less than a 3/8" (0.95 cm) gap between the door panel and the adjacent cabinet increases the risk of potential pinching.

MODEL	FLUSH WIDTH
18"	17-3/4" (45.1 cm)
24"	23-3/4" (60.3 cm)
30"	29-3/4" (75.6 cm)
36"	35-3/4" (90.8 cm)

Cutout Dimensions

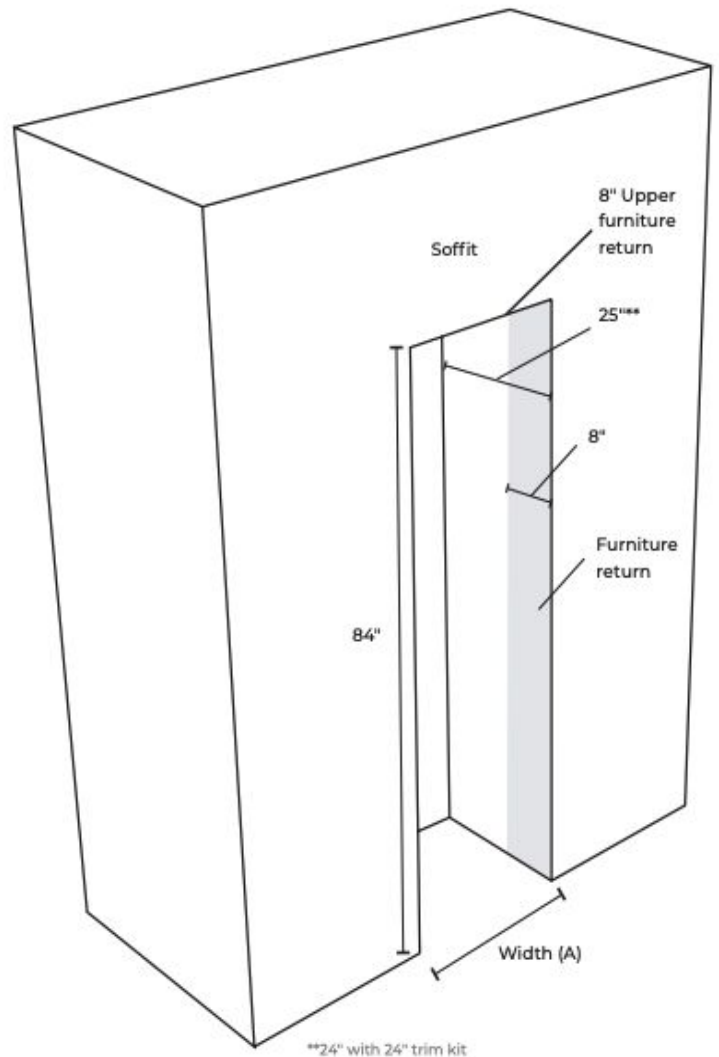

Opening Width (A)

18"	18" (45.7 cm)
24"	24" (61 cm)
30"	30" (76.2 cm)
36"	36" (91.4 cm)