

JennAir® 48" RISE™ Gas Professional Range with Chrome-Infused Griddle

JGRP548HL



Features

JennAir® Culinary Center

With step-by-step support, savor the full culinary experience backed by customized algorithms, featuring full-color food photography, doneness levels, pan types and menu-specific tips.

Remote Access

Preheat. Check cooking status. Personalize settings. Connect to WiFi for real-time notifications and control your appliance from anywhere. Tap and swipe on both iOS and Android devices.

20,000 BTU Dual-Stacked PowerBurner

This 20,000 BTU dual-stacked PowerBurner can handle high-powered cooking while still being gentle enough for delicate simmering with turndown of 1,650 BTU.

Dual-Fan True Convection

Steady heat, circulated by whirling metal blades, weaves around every flat tine. Beyond baking, wield your cooking prowess with the help of the culinary center through the app, from marbled meats to succulent roasts.

Halo-Effect Knobs

A halo of luminary LEDs glows softly when the burner is lit or the oven is on.

Chrome-Infused Griddle

Cast off porous, superficially plated options. Go deeper. Infused with chrome, our griddle cleans up well after heavy usage.



Product Details

Dimensions	47 7/8" W x 36" H x 27 11/16"D	
Cutout Dimensions	48" W x 36" H x 24"D (base cabinet)	
Finish	RISE™ Design Expression	
Capacity	6.3 Cu Ft	
Cooktop Specs	L Front	20,000 BTU
	L Rear	18,000 BTU
	C Front	20,000 BTU
	C Rear	9,000 BTU
	R Front	20,000 BTU
	R Rear	18,000 BTU

Accessories

30-48KITRC	Gas Range Connector Kit
W10285449	48" Range SS Backsplash
4396923	Premium Broiler Pan and Roasting Rack
4396096RB	Range Griddle

JennAir® 48" RISE™ Gas Professional Range with Chrome-Infused Griddle JGRP548HL



Gas

RECOMMENDED GAS ZONE

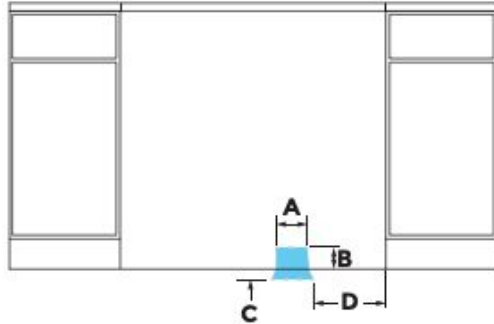

MODEL #		48" DUAL-FUEL RANGE	
		in	cm
A	Gas Opening Width	21	53.3
B	Gas Opening Height	3	7.6
C	Gas Opening Depth	5	12.7
D	Distance from Side Cabinet to Gas Opening	9	22.9
E	Width to Gas Inlet	12¼	32.4

Electrical

ELECTRIC REQUIREMENTS CHECKLIST

- A 120 V, 60 Hz, AC only 15 A, fused grounded circuit is required.
- A dedicated circuit is recommended.

RECOMMENDED ELECTRICAL ZONE

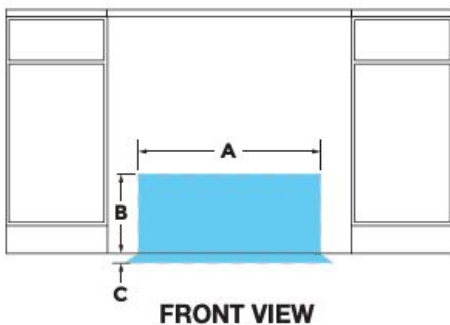

MODEL #		48" GAS RANGE	
		in	cm
A	Electrical Zone Width	40	101.6
B	Electrical Zone Height	15	38.1
C	Electrical Zone Depth	5	12.7

Cutout Dimensions

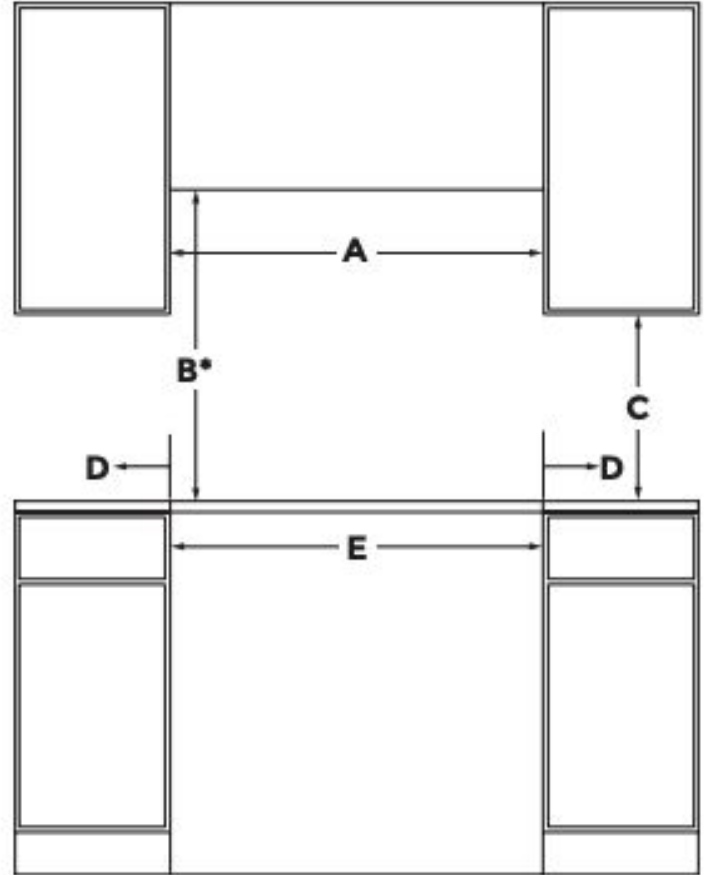

MODEL #		48" GAS RANGE	
		in (min.)	cm (min.)
A	Combustible Area Above Cooking Surface Width	48	121.9
B*	Bottom of Cabinet Height Above Cooking Surface	58	147.3
C	Bottom of Cabinet Height Above Countertop	18	45.7
D	Distance to Fixed Wall or Combustible Material	12	30.5
E	Opening Width	48	121.9
F	Upper Cabinet Depth	13 (max.)	33 (max.)
G*	Distance to Fixed Wall or Combustible Material	1½	3.8

Cabinet Requirements

Cabinet opening dimensions shown are for 25" (64.0 cm) countertop depth, 24" (61.0 cm) base cabinet depth, and 36" (91.4 cm) countertop height. Dimensions must be met in order to ensure a flush fit to back wall.