

JennAir® RISE™ 36" Gas Professional Range

JGRP436HL



Features

JennAir® Culinary Center

With step-by-step support, savor the full culinary experience backed by customized algorithms, featuring full-color food photography, doneness levels, pan types and menu-specific tips.

Remote Access

Preheat. Check cooking status. Personalize settings. Connect to WiFi for real-time notifications and control your appliance from anywhere. Tap and swipe on both iOS and Android devices.

20,000 BTU Dual-Stacked PowerBurner

This 20,000 BTU dual-stacked PowerBurner can handle high-powered cooking while still being gentle enough for delicate simmering with turndown of 1,650 BTU.

Dual-Fan True Convection

Steady heat, circulated by whirling metal blades, weaves around every flat tine. Beyond baking, wield your cooking prowess with the help of the culinary center through the app, from marbled meats to succulent roasts.

Halo-Effect Knobs

A halo of luminary LEDs glows softly when the burner is lit or the oven is on.

Connected Temperature Probe

Know when dinner is done without ever opening the door. Precision readings of food's internal temperature are sent directly to the app.



Product Details

Dimensions	35 7/8" W x 36" H x 27 11/16" D	
Cutout Dimensions	36" W x 36" H x 24" D (base cabinet)	
Finish	RISE™ Design Expression	
Capacity	5.1 Cu Ft	
Cooktop Specs	L Front	20,000 BTU
	L Rear	18,000 BTU
	C Front	20,000 BTU
	C Rear	9,000 BTU
	R Front	20,000 BTU
	R Rear	18,000 BTU

Accessories

30-48KITRC	Gas Range Connector Kit
W10115776	Range Backsplash
W10285448	36" Range SS Backsplash
4396923	Premium Broiler Pan and Roasting Rack
4396096RB	Range Griddle

Gas

RECOMMENDED GAS ZONE

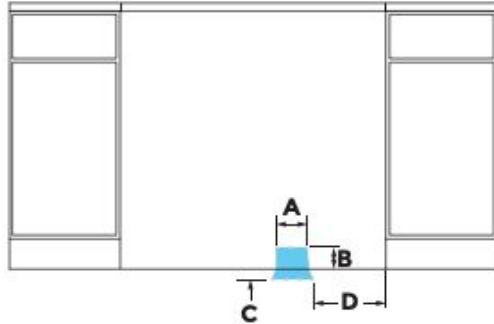

MODEL #		36" DUAL-FUEL RANGE	
		in	cm
A	Gas Opening Width	11	28
B	Gas Opening Height	3	7.6
C	Gas Opening Depth	5	12.7
D	Distance from Side Cabinet to Gas Opening	9	22.9
E	Width to Gas Inlet	12¼	32.4

Electrical

ELECTRIC REQUIREMENTS CHECKLIST

- A 120 V, 60 Hz, AC only 15 A, fused grounded circuit is required.
- A dedicated circuit is recommended.

RECOMMENDED ELECTRICAL ZONE

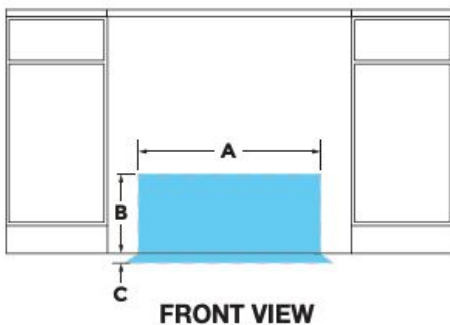

MODEL #		36" GAS RANGE	
		in	cm
A	Electrical Zone Width	28	71.1
B	Electrical Zone Height	15	38.1
C	Electrical Zone Depth	5	12.7

Cutout Dimensions

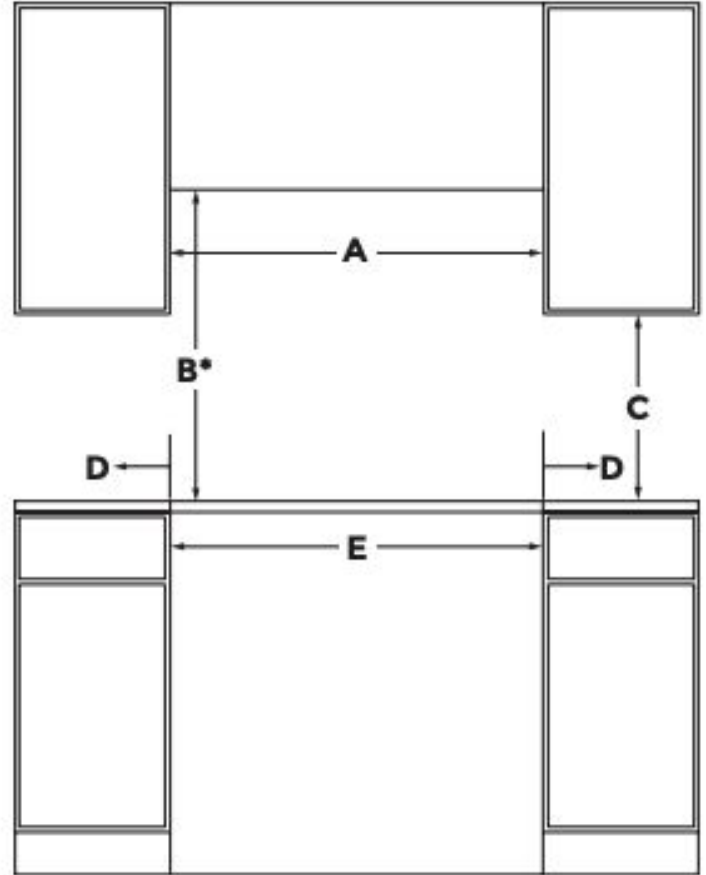

MODEL #		36" GAS RANGE	
		in (min.)	cm (min.)
A	Combustible Area Above Cooking Surface Width	36	91.4
B*	Bottom of Cabinet Height Above Cooking Surface	58	147.3
C	Bottom of Cabinet Height Above Countertop	18	45.7
D	Distance to Fixed Wall or Combustible Material	12	30.5
E	Opening Width	36	91.4
F	Upper Cabinet Depth	13 (max.)	33 (max.)
G*	Distance to Fixed Wall or Combustible Material	1½	3.8

Cabinet Requirements

Cabinet opening dimensions shown are for 25" (64.0 cm) countertop depth, 24" (61.0 cm) base cabinet depth, and 36" (91.4 cm) countertop height. Dimensions must be met in order to ensure a flush fit to back wall.