

# dji RC-N3

## User Manual

v1.0 2024.09

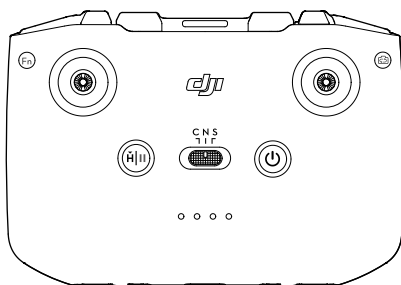



This document is copyrighted by DJI with all rights reserved. Unless otherwise authorized by DJI, you are not eligible to use or allow others to use the document or any part of the document by reproducing, transferring or selling the document. Only refer to this document and the content thereof as instructions to operate DJI UAVs. The document should not be used for other purposes.

### **Searching for Keywords**

Search for keywords such as “battery” and “install” to find a topic. If you are using Adobe Acrobat Reader to read this document, press Ctrl+F on Windows or Command+F on Mac to begin a search.

### **Navigating to a Topic**

View a complete list of topics in the table of contents. Click on a topic to navigate to that section.

### **Printing this Document**

This document supports high resolution printing.

# Using this Manual

## Legend

⚠ Important

💡 Hints and Tips

📖 Reference

## Downloading the DJI Fly App

Make sure to use DJI Fly with this product. Scan the QR code to download the latest version.



- 
- ⚠ • To check the Android and iOS operating system versions supported by DJI Fly, visit <https://www.dji.com/downloads/djiapp/dji-fly>.
  - The interface and functions of DJI Fly may vary as the software version is updated. Actual usage experience is based on the software version used.
- 

## Downloading DJI Assistant 2

Download DJI ASSISTANT™ 2 (Consumer Drones Series) at:

<https://www.dji.com/downloads/softwares/dji-assistant-2-consumer-drones-series>

- 
- ⚠ • The operating temperature of this product is -10° to 40° C. It does not meet the standard operating temperature for military-grade application (-55° to 125° C), which is required to endure greater environmental variability. Operate the product appropriately and only for applications that meet the operating temperature range requirements of that grade.
-

# Contents

<b>Using this Manual</b>	<b>3</b>
Legend	3
Downloading the DJI Fly App	3
Downloading DJI Assistant 2	3
<b>1 Preparing the Remote Controller</b>	<b>5</b>
<b>2 Linking the Remote Controller</b>	<b>6</b>
<b>3 Overview</b>	<b>7</b>
<b>4 Operations</b>	<b>8</b>
4.1 Powering On/Off	8
4.2 Charging the Battery	8
4.3 Controlling the Aircraft	8
4.4 Controlling the Gimbal and Camera	10
4.5 Flight Mode Switch	11
4.6 Flight Pause/RTH Button	11
4.7 Customizable Button	12
<b>5 Battery Level LEDs</b>	<b>13</b>
<b>6 Remote Controller Alert</b>	<b>14</b>
<b>7 Optimal Transmission Zone</b>	<b>15</b>
<b>8 Appendix</b>	<b>16</b>
8.1 Specifications	16
DJI RC-N3 Remote Controller	16
8.2 Firmware Update	16
8.3 Aftersales Information	17

# 1 Preparing the Remote Controller

1. Remove the control sticks from the storage slots and mount them on the remote controller.
2. Pull out the mobile device holder. Choose the appropriate remote controller cable based on the port type of your mobile device (the cable with a USB-C connector is connected by default). Place your mobile device in the holder, then connect the end of the cable without the remote controller logo to your mobile device. Make sure your mobile device is securely in place.

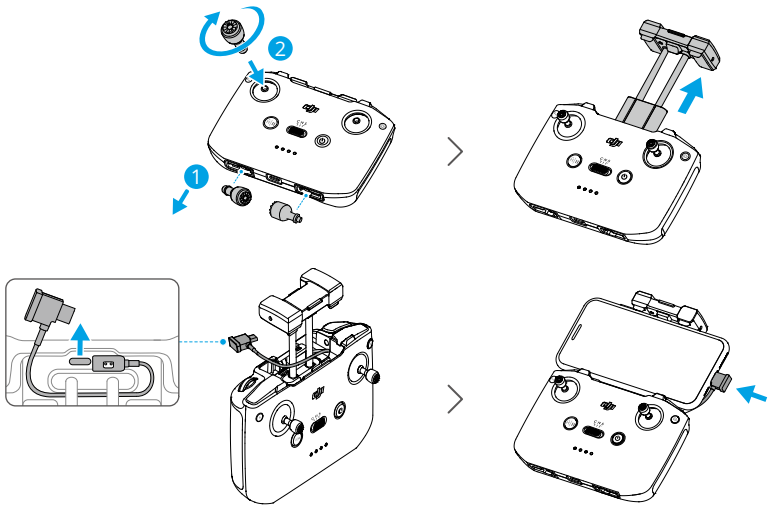

- 
-  • If a USB connection prompt appears when an Android mobile device is used, select the option to charge only. Other options may cause the connection to fail.
- Adjust the mobile device holder to make sure your mobile device is firmly secure.
-

## 2 Linking the Remote Controller

The remote controller is already linked to the aircraft when purchased together as a combo. Otherwise, follow the steps below to link the devices.

1. Power on the aircraft and the remote controller.
2. Launch DJI Fly.
3. In camera view, tap \*\*\* > **Control** > **Re-pair to Aircraft**. During linking, the remote controller beeps.
4. Press and hold the power button of the aircraft for more than four seconds. The aircraft beeps once, and its battery level LEDs blink in sequence to indicate it is ready to link. The remote controller will beep twice to indicate linking is successful.



- Make sure the remote controller is within 0.5 m of the aircraft during linking.
  - The remote controller will automatically unlink from an aircraft if a new remote controller is linked to the same aircraft.
  - You can also start linking by following the method below. In the home screen of DJI Fly, tap **Connection Guide**, select aircraft model, and then select **Connect with RC Only**.
-

### 3 Overview

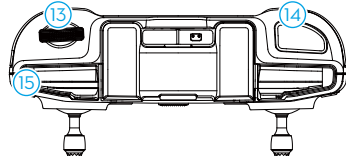
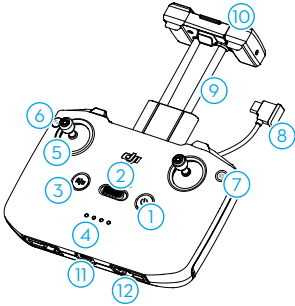

1. Power Button
2. Flight Mode Switch
3. Flight Pause/Return to Home (RTH) Button
4. Battery Level LEDs
5. Control Sticks
6. Customizable Button
7. Photo/Video Button
8. Remote Controller Cable
9. Mobile Device Holder
10. Antennas
11. USB-C Port
12. Control Stick Storage Slots
13. Gimbal Dial
14. Shutter/Record Button
15. Mobile Device Slot

## 4 Operations

### 4.1 Powering On/Off

Press the power button once to check the current battery level.

Press, then press and hold to power the remote controller on or off.

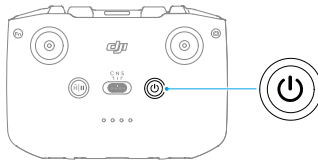

### 4.2 Charging the Battery

Connect the charger to the USB-C port on the remote controller.

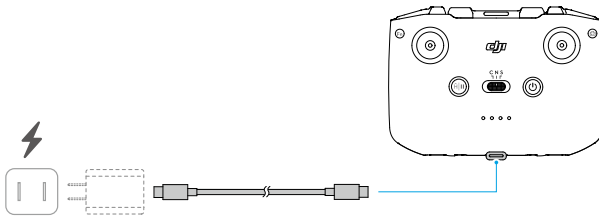

- 
- ⚠ Fully charge the remote controller before each flight. The remote controller sounds an alert when the battery level is low.
  - Fully charge the battery at least once every three months to maintain the battery's health.
- 

### 4.3 Controlling the Aircraft

The control sticks of the remote controller can be used to control the aircraft movements. The control sticks can be operated in Mode 1, Mode 2, or Mode 3, as shown below.

## Mode 1

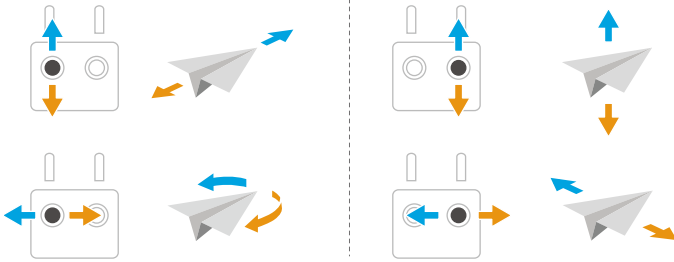



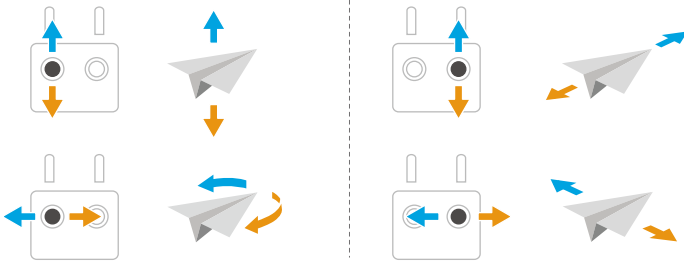



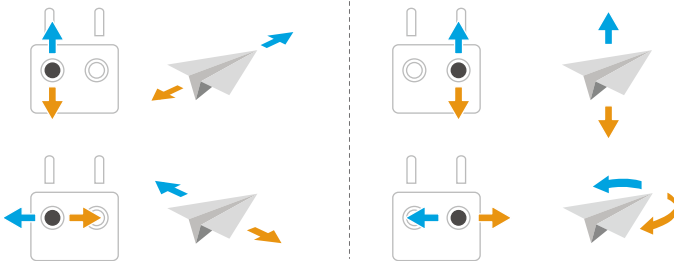

## Mode 2

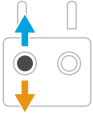

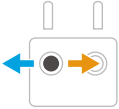
## Mode 3

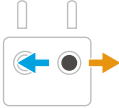

The default control mode of the remote controller is Mode 2. In this manual, Mode 2 is used as an example to illustrate how to use the control sticks.

Remote Controller (Mode 2)	Aircraft	Operation
		<p>Throttle Stick</p> <ul style="list-style-type: none"> <li>Push the stick up to ascend and down to descend.</li> <li>The more the stick is pushed away from the center, the faster the aircraft changes elevation.</li> </ul> <p>Make sure to gently push the stick up when taking off to prevent sudden and unexpected changes in altitude.</p>
		<p>Yaw Stick</p> <ul style="list-style-type: none"> <li>Push the stick left to rotate the aircraft counterclockwise and right to rotate the aircraft clockwise.</li> <li>The more the stick is pushed away from the center, the faster the aircraft rotates.</li> </ul>
		<p>Pitch Stick</p> <ul style="list-style-type: none"> <li>Push the stick up to fly forward and down to fly backward.</li> <li>The more the stick is pushed away from the center, the faster the aircraft moves.</li> </ul>
		<p>Roll Stick</p> <ul style="list-style-type: none"> <li>Push the stick left to fly left and right to fly right.</li> <li>The more the stick is pushed away from the center, the faster the aircraft moves.</li> </ul>

## 4.4 Controlling the Gimbal and Camera

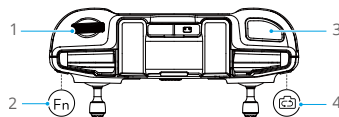

1. **Gimbal Dial:** Control the tilt of the gimbal.
2. **Customizable Button:** Press once to recenter the gimbal or point the gimbal downward by default.
3. **Shutter/Record Button:** Press once to take a photo or to start or stop recording.
4. **Photo/Video Button:** Press once to switch between photo and video mode.

## 4.5 Flight Mode Switch

Toggle the switch to select the desired flight mode.

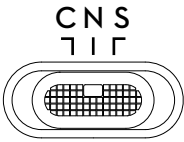

Position	Flight Mode
S	Sport Mode
N	Normal Mode
C	Cine Mode

## 4.6 Flight Pause/RTH Button

Press once to make the aircraft brake and hover in place.

Press and hold the button until the remote controller beeps and starts RTH. The aircraft will return to the last recorded Home Point. Press the button again to cancel RTH and regain control of the aircraft.

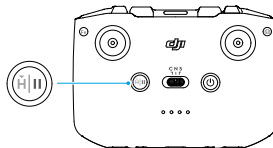



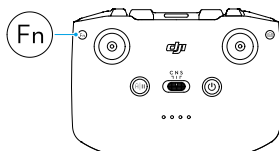

## 4.7 Customizable Button

Press the customizable button to recentre the gimbal or point the gimbal downward by default. To set the function, go to camera view in DJI Fly, and tap **\*\*\* > Control > Button Customization**.



## 5 Battery Level LEDs

Blinking Pattern	Battery Level
	76-100%
	51-75%
	26-50%
	0-25%

## 6 Remote Controller Alert

The remote controller sounds an alert during RTH, which cannot be cancelled. The remote controller sounds an alert when the battery level of the remote controller is low. A low battery level alert can be cancelled by pressing the power button. When the battery level is critically low, the alert cannot be cancelled.

There will be an alert if the remote controller is not used for a period while it is powered on but is not connected to the aircraft or the DJI Fly app on the mobile device. The remote controller will automatically power off after the alert stops. Move the control sticks or press any button to cancel the alert.

## 7 Optimal Transmission Zone

The signal between the aircraft and the remote controller is most reliable when the antennas are positioned in relation to the aircraft as illustrated below. If the signal is weak, adjust the remote controller orientation or antenna position, or fly the aircraft closer to the remote controller.

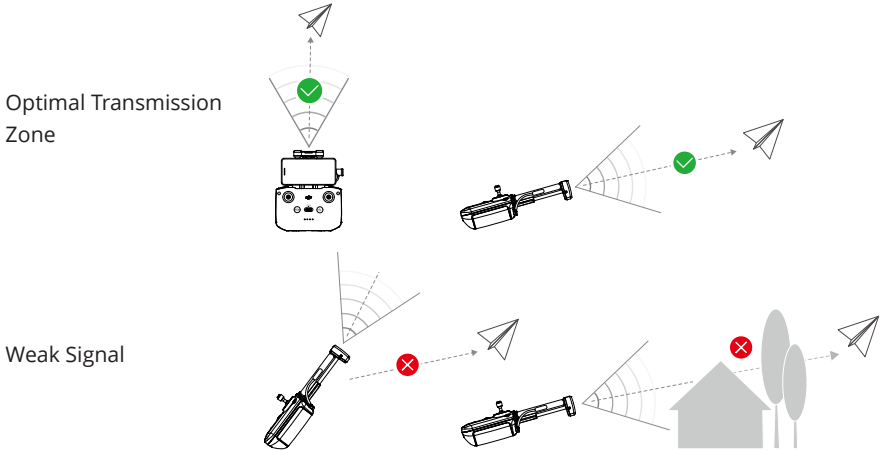

- 
-  • DO NOT use other wireless devices operating at the same frequency as the remote controller. Otherwise, the remote controller will experience interference.
- A prompt will be displayed in DJI Fly if the transmission signal is weak during flight. Adjust the remote controller orientation according to the attitude indicator display to make sure that the aircraft is in the optimal transmission range.
-

## 8 Appendix

### 8.1 Specifications

#### DJI RC-N3 Remote Controller

Max Operating Time	Without Charging Any Mobile Device: 3.5 hours When Charging a Mobile Device: 1.5 hours
Operating Temperature	-10° to 40° C (14° to 104° F)
Charging Temperature	5° to 40° C (14° to 104° F)
Charging Time	2 hours
Charging Type	5 V, 2 A
Battery Capacity	2600 mAh
Weight	Approx. 320 g
Dimensions	104.2×150×45.2 mm (L×W×H)
Operating Frequency <sup>[1]</sup>	2.400-2.4835 GHz 5.170-5.250 GHz 5.725-5.850 GHz
Transmitter Power (EIRP)	2.4 GHz: < 33 dBm (FCC) < 20 dBm (CE/SRRC/MIC) 5.1 GHz: < 23 dBm (CE) 5.8 GHz: < 33 dBm (FCC) < 14 dBm (CE) < 30 dBm (SRRC)

[1] Operating frequency allowed varies among countries and regions. Please refer to local laws and regulations for more information.

### 8.2 Firmware Update

Use DJI Fly or DJI Assistant 2 (Consumer Drones Series) to update the device.

#### Using DJI Fly

When using the remote controller, connect the aircraft and remote controller, and run DJI Fly. You will be notified if a new firmware update is available. Follow the on-screen instructions to start the update. Note that you cannot update the firmware if the remote

controller is not linked to the aircraft. An internet connection is required during the firmware update.

### Using DJI Assistant 2 (Consumer Drones Series)

Use DJI Assistant 2 (Consumer Drones Series) to update all your devices separately.

1. Power on the device. Connect the device to a computer with a USB-C cable.
2. Launch DJI Assistant 2 (Consumer Drones Series) and log in with your DJI account.
3. Select the device and click **Firmware Update** on the left side of the screen.
4. Select the firmware version.
5. Wait for the firmware to download. The firmware update will start automatically. Wait for the firmware update to complete.



- Make sure to follow all the steps to update the firmware, otherwise the update may fail.
  - Make sure the computer is connected to the internet during the update.
  - DO NOT unplug the USB-C cable during an update.
  - Before performing an update, make sure that the device is at least 20% charged.
- 

## 8.3 Aftersales Information

Visit <https://www.dji.com/support> to learn more about aftersales service policies, repair services, and support.

WE ARE HERE FOR YOU



Contact  
DJI SUPPORT

This content is subject to change without notice.  
Download the latest version from



<https://www.dji.com/downloads/products/rc-n3>

If you have any questions about this document, please contact DJI by sending a message to [DocSupport@dji.com](mailto:DocSupport@dji.com).

DJI is a trademark of DJI.  
Copyright © 2024 DJI All Rights Reserved.