

Stinger

10"
Infotainment
System

Wireless

Works with
Apple CarPlay

Works with
Android Auto

PN: IX210



HORIZON 10™

USER GUIDE

HD Radio®

SiriusXM
READY

Bluetooth®

HDMI®
HIGH DEFINITION MULTIMEDIA INTERFACE



Apple CarPlay is a trademark of Apple Inc. Use of the Apple CarPlay logo means that a vehicle user interface meets Apple performance standards. Apple is not responsible for the operation of this vehicle or its compliance with safety and regulatory standards. Please note that the use of this product with iPhone, iPod, or iPad may affect wireless performance.

SiriusXM and all related marks and logos are trademarks of Sirius XM Radio Inc. All rights reserved.

Android, Android Auto, Google Play and other marks are trademarks of Google LLC.

The Bluetooth word mark and logos are registered trademarks owned by Bluetooth SIG, INC. and any use of such marks by Stinger is under license.

Visit stingersolutions.com for updates and further information.

TECHNICAL SUPPORT:

800-477-2267
support@aampglobal.com

CUSTOMER SOLUTIONS:

800-477-2267
customersolutions@aampglobal.com

Stinger is a Power Brand of AAMP Global
15500 Lightwave Drive, Suite 202
Clearwater, Florida 33760

HDMI, the HDMI Logo, and High-Definition Multimedia Interface are trademarks or registered trademarks of HDMI Licensing LLC in the United States and other countries

HD Radio™ Technology manufactured under license from iBiquity Digital Corporation, a subsidiary of Xperi Inc., U.S. and Foreign Patents. For patents see <https://xperi.com/hd-rad-patents/>. Xperi, HD Radio, HD, 'ARC' logos and their respective logos are trademarks of Xperi Inc. and its subsidiaries in the United States and other countries.

© iBiquity Digital Corporation, a subsidiary of Xperi Inc. All Rights Reserved.

Stinger and the Stinger logo are trademarks or registered trademarks of Stinger in the United States and other countries.

USER AGREEMENT: End user agrees to use this product in compliance with the instructions and terms of use and with all State and Federal laws. STINGER provides instructions and safety warnings with respect to this product and disclaims all liability for any use not in conjunction with those instructions or other misuse of its product. If you do not agree, please discontinue use and contact STINGER. This product is intended for off-road use and passenger use only.

WELCOME TO YOUR NEW

HORIZON 10™

USER GUIDE CONTENTS

Basic Operation	4	System Settings	29
Getting Started	6	- Clock	29
Apple CarPlay	8	Display Settings	30
Android Auto	9	- Face Button Color	30
Media Sources	10	- Backgrounds	30
HD Radio™	10	Camera Settings	30
SiriusXM	12	User Settings	32
- SiriusXM Replay™	15	- Quick Access Menu	32
- SiriusXM Lock Code	15	Device Settings	32
Bluetooth Music	16	- Add a Device	32
USB Media	17	Installer Settings	34
HDMI / AV	19	- Installer Code	34
Applications	20	Audio Settings	37
Bluetooth Phone	20	Balance & Fade	38
- Pairing a Device	21	Equalizer	39
- Contacts / Call Log	23	Crossover	40
Cameras	24	Timing	41
Accessory Control	26	Factory EQ	42
ENLIGHTIO RGB Control	27	Advanced Audio Settings	42
DM Smart DSP	27	Reset Button	43
Navigation	28	Troubleshooting	44
Display Off	28	Specifications	48
Settings	29		

THE BASICS



Clock
Tap: Adjust Clock Settings

Home Menu
Tap: Launch selected app
You can press and hold a menu item to move it from this screen.

Internal Microphone

Reset Button

Home Menu Button
Tap: Access the Home Menu
Dimmed menu items are not selectable.

Navigation Button
Tap: Access Navigation
When iGo Navigation is installed, tap for iGo
Tap and Hold for Phone Navigation

Favorite Button
Tap : Launch your selected favorite application
Set your favorite app in **Settings**; learn more on Page 32

Voice Button
Launches voice control

Tune/Track Down Button
Media control: Previous, Back, Seek
Press & hold function in select sources

Multifunction Knob
Turn to adjust Volume Up/Down
Press to Mute/Unmute
Press & Hold to Sleep / Wake Unit

Tune/Track Up Button
Media control: Next, Forward, Seek
Press & hold function in select sources

GETTING STARTED

Clock Compass Source / Info Connected Devices



Swipe up to access Quick Tabs

POWER UP!

With vehicle ignition in the ON or ACC position, Press and Hold the knob for 2 seconds put your Horizon10 to sleep; press once to wake.

The source will automatically default to the last source used prior to putting your Horizon10 to sleep.

You can adjust the audio volume at start-up in **Audio Settings** on page 43.

The **Information Bar** is located at the top of the screen. Depending on the SOURCE, it will provide information or content sensitive controls. Also, displays time, phone info and may contain BACK ARROW and EXIT buttons.

To select a SOURCE, press the HOME button. Sources that are not currently available are grayed out.

Customizable **Quick Access Tabs** can be accessed by swiping up from the bottom of the screen. Tabs give direct access to sources, settings, and even head unit functions and can be customized in **Settings > Users > Quick Access Tabs** on page 32.

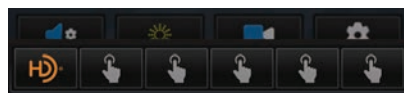

Tap a Quick Access Tab item to launch it immediately. Unavailable options are dimmed. Once opened, Tabs will auto close after 5 seconds

GET CONNECTED

1. Tap the Voice button and select "connect wirelessly" from the popup or plug your device in.



2. Make sure your device is in pairing mode and tap +Add a Device.

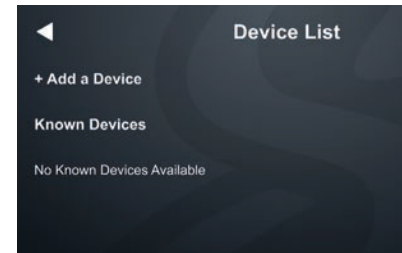

3. Select your device from the list.

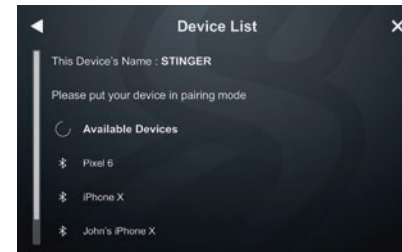

If your device does not appear in the

device list, confirm it is discoverable and tap Available Devices to rescan.

4. Confirm PIN Code on the head unit screen and the device.

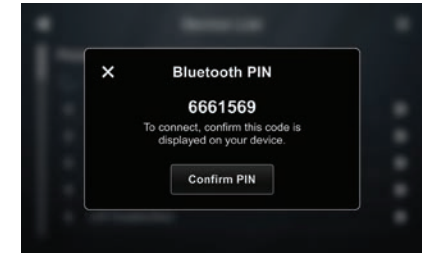

5. Select the connection type you want to use with your device (bluetooth / phone projection).

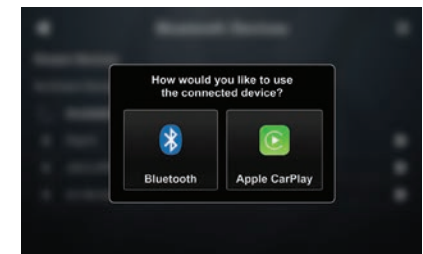
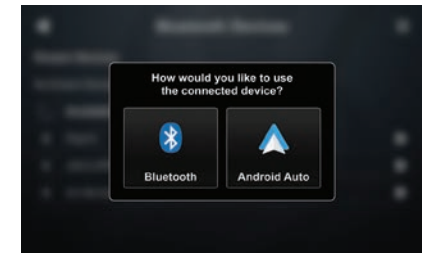

If you choose phone projection, your phone projection application will launch automatically.

APPLE CARPLAY™

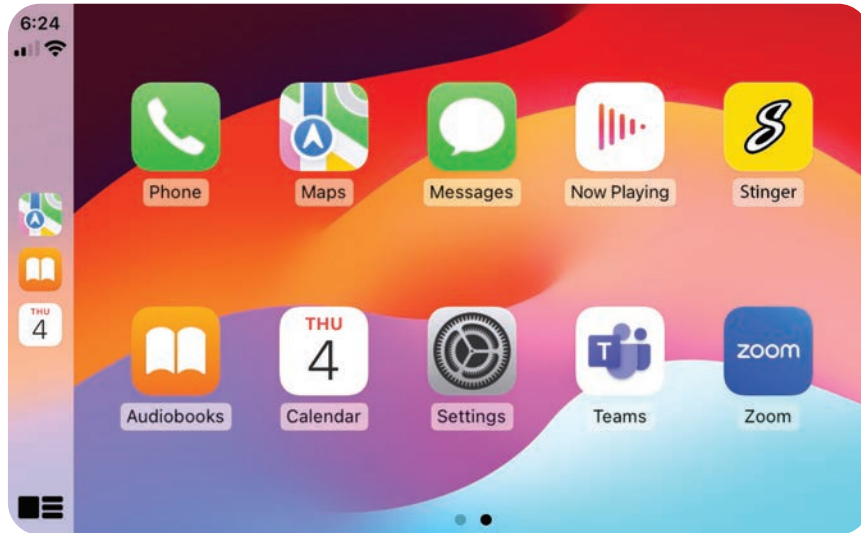

You can use Apple CarPlay to get directions, make calls, send and receive messages, and more.

You need an iPhone 5 or later to use Apple CarPlay. Also, make sure that you're in an area that supports Apple CarPlay and that Siri is on. To turn on Siri on your phone, go to Settings > Siri & Search.

Set up Apple CarPlay

With your vehicle running, plug your iPhone into the your head unit's USB-C port. Apple CarPlay will launch automatically.

You can also connect your iPhone wirelessly to enjoy Apple CarPlay. For detailed instructions see GET

CONNECTED on Page 7.

Using Apple CarPlay

If your iPhone is already connected, press **HOME BUTTON > Apple CarPlay** to launch Apple CarPlay.

The display will show available applications that are compatible with Apple CarPlay

To exit Apple CarPlay, press the Stinger Main Menu icon.

NOTE: If Apple CarPlay will not launch, see Troubleshooting.

More Info

For details about Apple CarPlay, visit <https://support.apple.com/en-us/HT205634>

ANDROID AUTO™

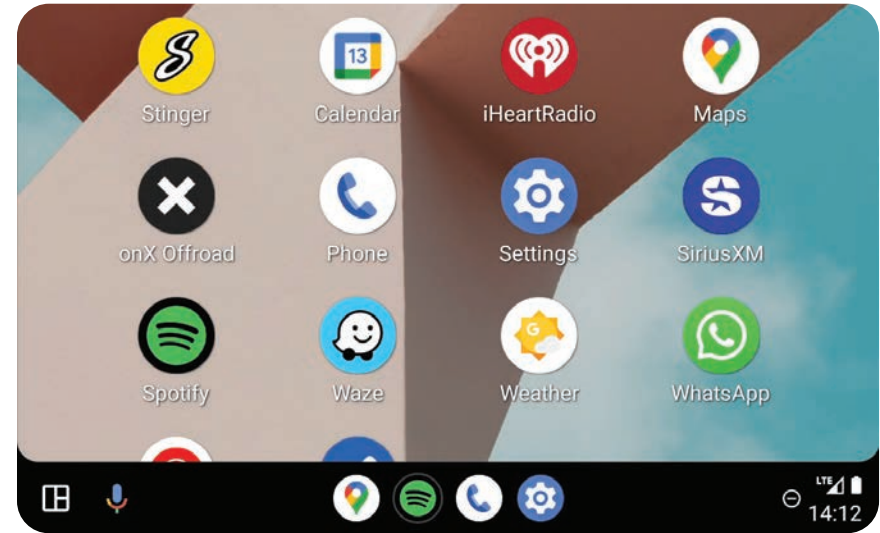

You can use Android Auto to get directions, make calls, send and receive messages, and more.

Make sure your phone is running Android 5.0 (Lollipop) or later. Download the Android Auto app from Google Play on your device. Once the app is installed, open the app and follow the setup steps.

Set up Android Auto

With your vehicle running, but parked, connect your USB-C Android Phone into your head unit's USB-C port.

You can also connect your Android device wirelessly to enjoy Android Auto. For detailed instructions see

GET CONNECTED on Page 7.

Using Android Auto

If your Android device is already connected, press **HOME BUTTON > Android Auto** to launch Android Auto.

The display will show available applications that are compatible with Android Auto

To exit Android Auto, press the Stinger Main Menu icon.

NOTE: If Android Auto will not launch, see Troubleshooting.

More Info

For details about Android Auto, visit <https://www.android.com/auto/>

HD RADIO™



Press the **HOME BUTTON > HD Radio** to select the HD Radio source.

1. Station Presets

To assign a preset, go to desired channel, press and hold a preset button for 2 seconds to store the station. A total of 15 FM & 10 AM stations can be stored in memory.

2. AM/FM

Press to cycle through AM/FM Presets.

3. Station Information Display

These two lines display Show /

Artist / Track Name for current station.

4. Tune / Seek Down

Tap to tune frequency down. If you are tuned to an HD Radio Station, press to tune to the next available SPS station. Press and hold to seek the next available radio station.

Note: When browsing SPS stations, hold to seek is disabled.

5. HD Station Identification

Displays currently tuned MPS & SPS

channel.

6. Station Frequency Display

Displays currently tuned frequency.

7. Station Identifier / Audio Info

Indicates Station Call Numbers & Current audio mode (Mono / Stereo)

8. Tune / Seek Up

Tap to tune frequency up. If you are tuned to an HD Radio Station, press to tune to the next available SPS station. Press and hold to seek the next available radio station.

9. Album Art

Displays album art for currently playing track.

10. DX/LOC

Changes radio tuner sensitivity. Touch to toggle between distant (DX) and Local (LOC).

11. Seek Type

Touch to toggle between auto & analog seek modes.

12. Direct Tune

Touch to tune directly in the current band (FM/AM). Once the desired frequency is entered, tap go to tune.

13. HD Radio™ Settings

Tap to access HD Radio application settings.



Scan By Genre

Tap to select a genre. The head unit will display the HD Radio screen and scan for the next available station whose PTY genre listing matches the selected option.

Auto Presets

Tap to automatically program channel presets. This will reprogram all existing presets.

Receiver Sensitivity Boost

Tap the desired level of sensitivity. Higher sensitivity levels may result in undesired noise.

HD Radio™ Features

Toggle on/off to enable/disable HD Radio features like SPS sub-stations, station metadata, artist experience, and more.

Artist Experience

Toggle on/off to enable/disable HD Radio Artist Experience.

SIRIUSXM® SATELLITE RADIO (optional)



Press the **HOME BUTTON** > **SiriusXM** to select the SiriusXM Radio Source

1. Channel Presets

To assign a preset, go to desired channel, press and hold a preset location until preset button highlights and channel name appears. Tap a preset to tune to the indicated station.

2. Channel Down/Up

Tap to advance through station presets. Long Press to advance to previous/next channel. Hold to rapidly browse channels.

3. SiriusXM Replay™ Time Bar

Shows time remaining in the Replay audio playback buffer.

4. Channel Info

Displays channel name, song/content info.

5. Signal Strength

Displays tuner signal strength, 0-3 bars.

6. SiriusXM Info

Displays current channel category,

channel number, and preset bank number.

7. Band

Tap to cycle through SXM Preset banks (1-3)

8. CH

Tap to display a list of available channels with channel information.

9. CAT

Tap to display a list of channel categories.

10. Direct Tune

Tap to tune by channel number directly.

11. Rewind/Track Down

Tap to browse to previous song. Hold to move backwards through stored audio. (Replay Only)

12. Pause/Play

Touch to pause live broadcast / play stored audio. (Replay Only)

13. Fast Forward / Track Up

Tap to advance to next song. Hold to move forward through stored audio. (Replay Only)

14. LIVE

Tap to return to live broadcast when listening to stored audio. (Replay Only)

SiriusXM Radio Overview

SiriusXM is where moments

happen. The widest, deepest variety of music, ad-free. More games, more sports, more coverage than anywhere. Listen in your car, on your phone, online and at home.

A SiriusXM Vehicle Tuner and subscription are required. For more information, visit www.siriusxm.com.

** SiriusXM Satellite Radio controls on this unit are only available when a SiriusXM Tuner is connected.*

Activating your SiriusXM Subscription

After installing your SiriusXM Connect Vehicle Tuner and antenna, wake your radio and select SiriusXM mode.

You should be able to hear the SiriusXM preview channel on Channel 1. If you cannot hear the preview channel, please check the installation instructions to make sure your SiriusXM Connect tuner is properly installed.

After you can hear the preview channel, tune to Channel 0 to find the Radio ID of your tuner. In addition, the Radio ID is located on the bottom of the SiriusXM Connect Vehicle Tuner and its packaging. You will need this number to activate your subscription. **The SiriusXM Radio ID does not include the letters I, O, S, or F.*

Activating in the US:

- Visit www.siriusxm.com/activatenow
- Call SiriusXM Listener Care at 1-866-635-2349

Activating in Canada:

- Visit www.siriusxm.ca/activatexm
- Call XM customer Care at 1-877-438-9677

As part of the activation process, the SiriusXM satellites will send an activation message to your tuner. When your radio detects that the tuner has received the activation message, your radio will display: Subscription Updated. Once subscribed, you can tune to channels in your subscription plan. Note, the activation process usually takes 10 to 15 minutes, but may take up to an hour. Your radio will need to be on and receiving the SiriusXM signal to receive the activation message.

Channels (CH)

Displays a list of available SiriusXM

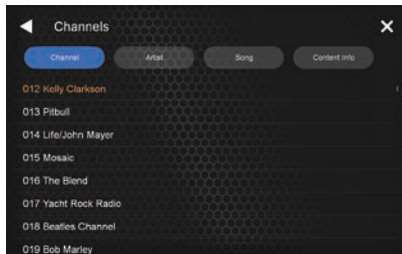

channels in numerical order. Scroll up or down to navigate, touch a channel listing to tune to the desired channel. Selecting Name, Artist, Song, or Station Info will toggle the information being displayed.

Categories (CAT)

Displays a list of channel categories. Selecting a category shows a filtered list of channels. Selecting All Channels will remove any filters on the Channel List.

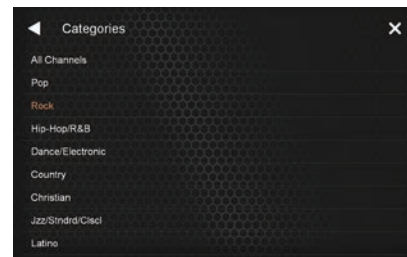

Direct Tuning

Touch the keypad icon to launch a keypad for direct channel number entry. See Page (15) for Parental Control function.

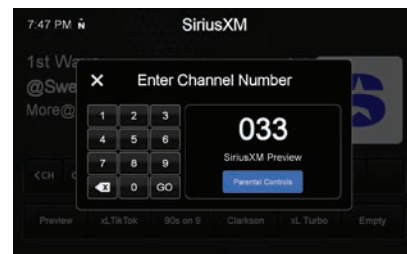

SiriusXM Replay™

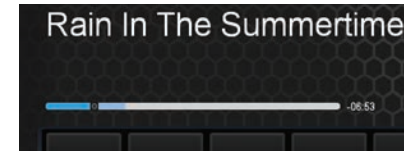

Replay allows you to pause, rewind, and replay up to 1 hour of live SiriusXM Satellite Radio.

Pressing Pause or Rewind while listening to a live broadcast will enable Replay mode.

The replay time bar will appear when replay is active.

When you reach the end of the stored audio buffer, you will return to live broadcast audio.

You can also touch the **[LIVE]** button to return to live broadcast of the current channel.

SiriusXM allows you to prevent access to inappropriate mature content. When enabled, Parental Control requires you to enter a passcode to access channels rated Mature.

Parental Controls

By default, all channels are unlocked and the lock code is **1234**

To access Parental Control Settings:

1. When direct tuning, tap the

parental controls button to enter the Parental Controls menu directly. You'll be asked to enter the lock code before you can change settings.

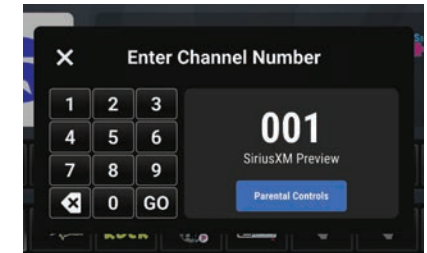

2. Once you've entered the parental controls code, you can lock or unlock mature channels, or change the lock code from the popup that appears.

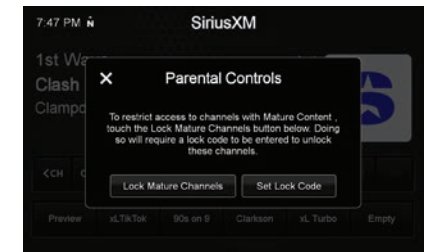

BLUETOOTH MUSIC



Press the **HOME BUTTON > BT Music** to select the Bluetooth Music source.

1. Playback Progress Indicator

Shows progress in current track.

2. Song / Program Information

Displays information for the current track.

3. Phone Selector Area

If multiple compatible devices are connected, you can switch between them by tapping the button with the desired device's name.

4. Album / Program Art

5. Previous Track/Program

Touch once to restart current track, touch twice for previous track.

6. Play/Pause

Touch to play or pause audio playback.

7. Next Track/Program

Touch to advance to the next track or program.

8. Toggle Replay Modes

9. Toggle Randomize Modes

USB MEDIA



Press the **HOME BUTTON > USB Media** to select the USB Media source.

1. Playback Progress Indicator

Shows progress in current file, touch anywhere on the bar to immediately navigate to that segment of the file.

2. File Quality Information

3. Song / Program Information

4. Album / Program Art

5. Previous File

Touch once to restart file, touch twice for previous file.

6. Play/Pause

Touch to play or pause playback

7. Next File

Touch to playback to the next file that is the same media type.

8. Toggle Randomize Modes

9. Toggle Replay Modes

10. File Browser

From the USB Root Menu you can browse Audio, Video, and Image files.

Touch to select a file to view/play.

10. Search for File

USB MEDIA

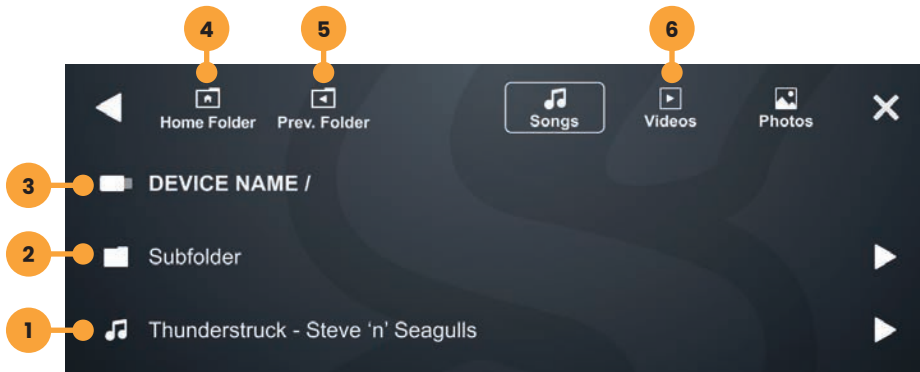

1. File

Tap to view / play content.

2. Folder

3. Breadcrumb / Path

4. Home Folder

5. Previous Folder

6. File Filters

Only one filter can be active at a time.

USB VIDEO PLAYBACK

When playing a USB video file, the application controls will auto-hide.

To access the application controls, touch anywhere on the screen.

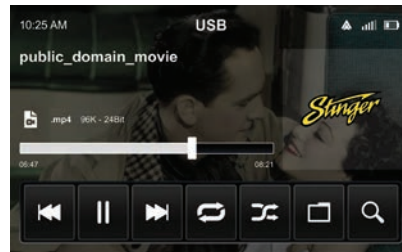

USB PHOTO VIEWING

When viewing USB images, the application controls will auto-hide.

To access the application controls, touch anywhere on the screen.

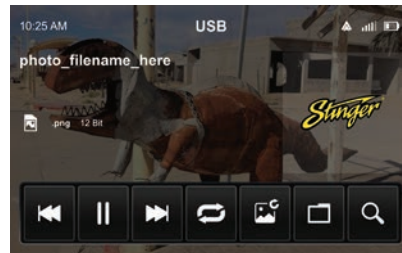

HDMI INPUT

Press the **HOME BUTTON > HDMI** to switch to the HDMI input.

The HDMI input can be used for an external DVD player, streaming sticks, media players, smartphone mirroring.

You can only view HDMI content with the vehicle in Park and the parking brake ON.

When viewing HDMI content, the Information Bar will auto-hide. To access the Information Bar, touch

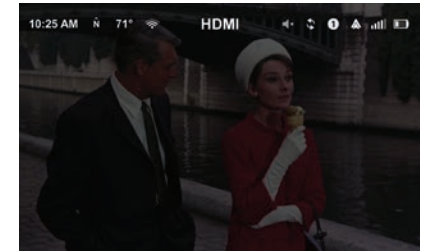

A/V INPUT

Press the **HOME BUTTON > AV IN** to switch to the AV input.

You can only view the AV input with the vehicle in Park and the parking brake ON.

When viewing the AV IN, the Information Bar will auto-hide. To access the Information Bar, touch anywhere on the screen.



WARNING!

Driver is prohibited by law from viewing a video signal on any in-dash monitor while the vehicle is in motion.

BLUETOOTH PHONE

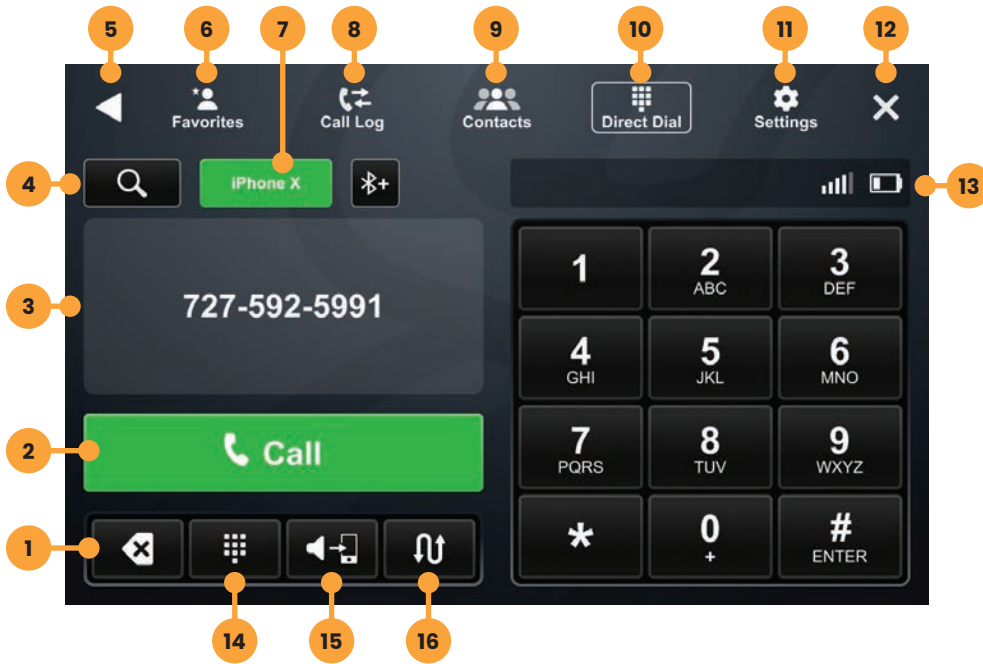

Press the **HOME BUTTON > Phone** to launch the Bluetooth Phone app.

1. Backspace / Clear

Tap to delete the last character entered. Hold to clear entire entry.

2. Call / Answer / End Call Button

Dial the number entered on the phone or number pad. Answer incoming calls. While connected, changes to End Call, when tapped in this mode, ends currently connected call.

3. Dialing Window

Displays currently dialed number.

4. Contact Search Button

Press to search contacts.

5. BACK Button

Tap to navigate to previous application.

6. Favorites

Customizable list of favorite contacts.

7. Phone Selector

When two compatible phones are connected, tap to choose active phone.

8. Call Log

Recent Dialed, Received, and Missed Calls

9. Contacts

List of contacts from paired phone. Not supported by all phones.

10. Direct Dial

Direct Dial is the default phone view. Make and receive calls here.

11. Phone Settings

Tap here to access phone settings.

12. EXIT Button

Close the phone app and return to your previously playing SOURCE.

13. Phone Info Area

Shows connected, active phone information.

14. Number Pad

Tap to show number pad for dialing phone numbers.

15. Speaker / Phone

Switches phone call audio between car speakers and phone handset.

16. Swap Call

Tap to switch between active and held call.

Pairing a Device

1. Select Settings from the phone menu and tap Device.

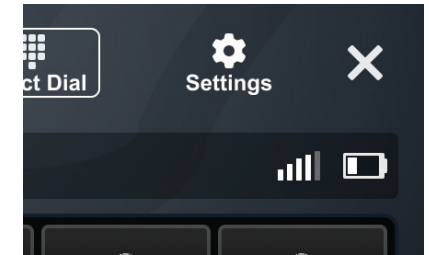

2. Make sure your device is in pairing mode and tap +Add a Device.

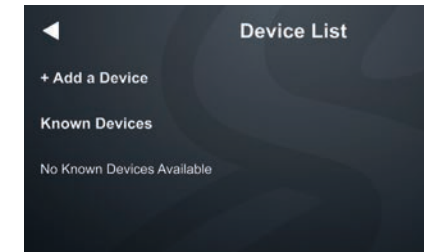

3. Select your device from the list.

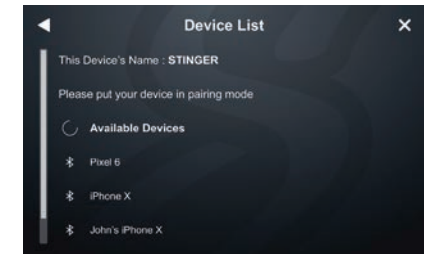

You can tap available devices to rescan

4. Confirm PIN Code on the head unit screen and the device.

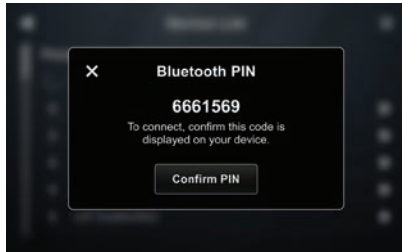

5. Select the connection type you want to use with your device (bluetooth / phone projection).

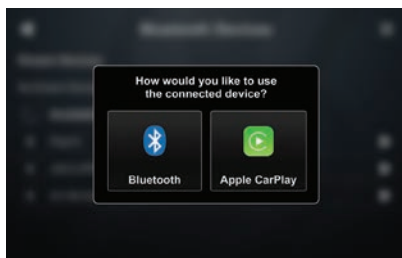
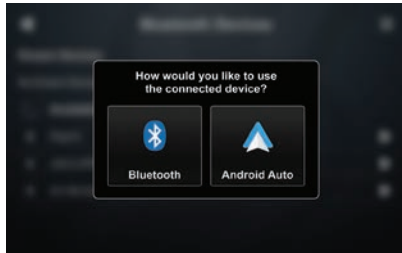

If you choose phone projection, your phone will be accessible through your phone projection application (Apple CarPlay / Android Auto).

Autoconnect

Once a device has been paired, it will automatically connect whenever the system is turned on and the device is within range. To manually connect or connect to a different device, go to Phone > Settings > Device

BT Device Settings

Once a device is paired and connected, you can adjust its settings from the Phone settings menu item.

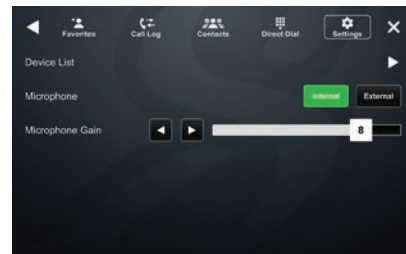

Device List

Access a list of all devices in memory, connect, add, and delete devices from this menu.

Microphone

Set control to external if an external microphone is installed. Set to Internal to use the microphone located on the front of the display.

Microphone Gain

Adjusts the volume (sensitivity) of the microphone when using hands-free phone.

Contacts

While a device is paired, Contacts can be accessed by selecting Contacts from the Phone main menu. It may take several minutes to load all contacts. When a contact is selected from the list, all associated numbers (Home/Work/Mobile, etc.) will be displayed on the right side of the screen. Touch the number you want to dial.

1. Favorites

The Favorites list can be accessed from the Phone main menu.

2. Setting Favorites

To add a contact number to the Favorites list, touch the STAR button to the right of the desired phone number.

3. Search Contacts

To Search your contact list, select the SEARCH icon on the Phone Selector area.

Call Log

The Call Log lists recently dialed, received, and missed calls.

1. Call Type Filter

You can select which type of call you want to browse by tapping Dialed, Received, or Missed Calls on the left.

2. Dialing a Number From Call Log

Tap the contact or phone number to dial a number.

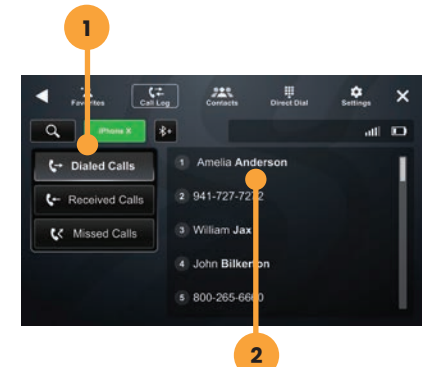
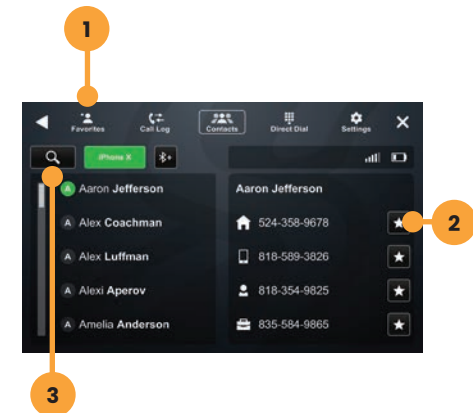

CAMERAS

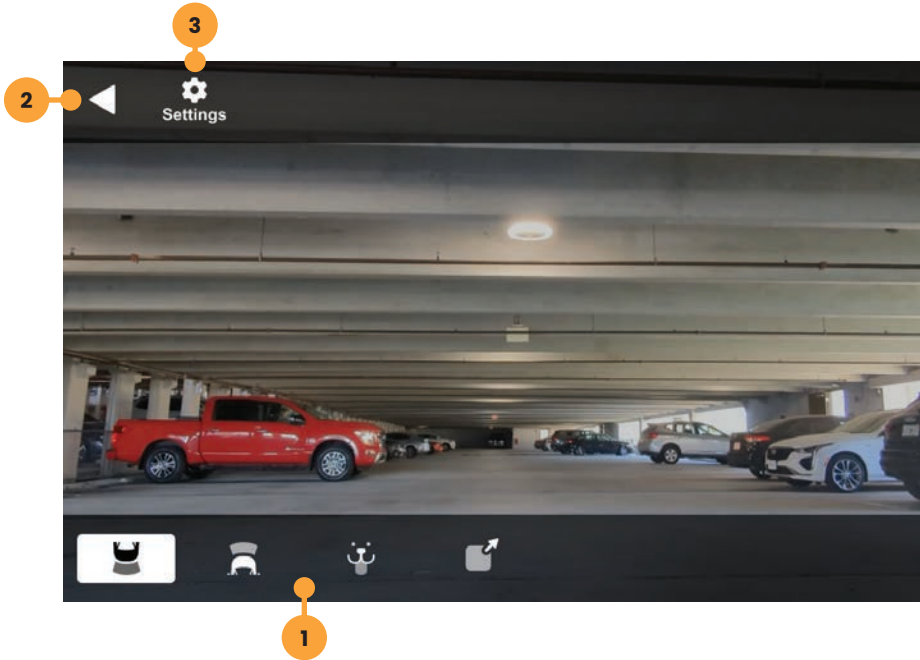

Press the **HOME BUTTON > Cameras** to select the Cameras app.

1. Camera Selection Bar

If there are optional cameras installed, you may view them at anytime using the camera selection bar at the bottom of the screen.

2. Back Arrow

Touch to exit camera view.

3. Settings

Touch to access Camera Settings.



Press the **HOME BUTTON > Settings > Cameras** to access camera settings.

Set Up a Custom Camera

1. Tap Camera Setup

2. Tap a Trigger's Label Button

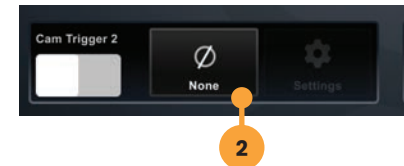

Once you tap the label button it will turn red and you'll have around 5 seconds to choose a label.

3. Assign a Label



Once you assign a label, that camera's trigger and settings will be active.

Your assigned Camera will now appear on the Camera Selection Bar.

Reverse Camera Audio

When set to ON and a microphone is connected, back up camera audio will be heard through the vehicle's speakers.

Mute Audio in Reverse

When set to ON the system will mute any audio playback while in reverse.

Switch to Forward Camera After Reverse

When set to ON the front camera will turn on after shifting from Reverse gear and remain On until the speed reaches above 5MPH or the display is touched

ACCESSORY CONTROL

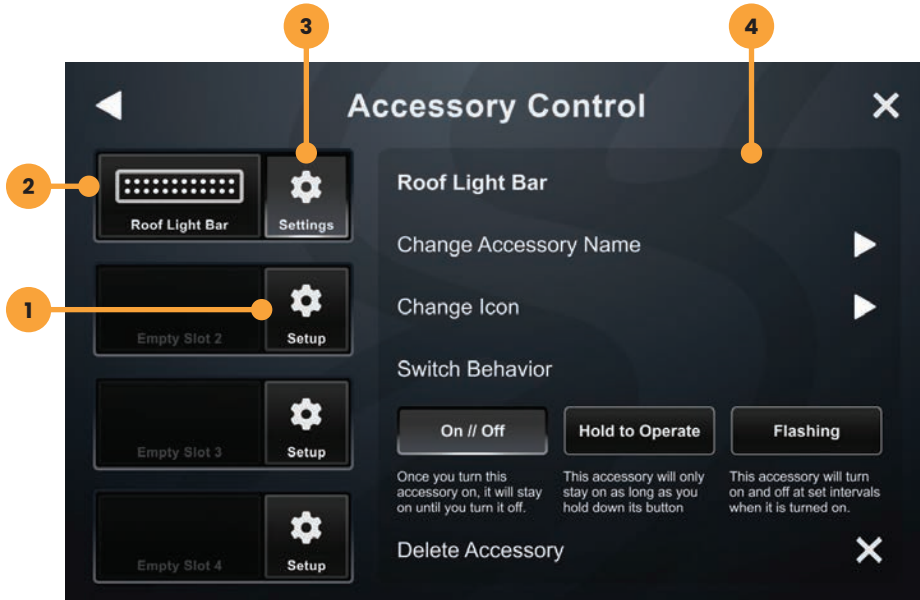

Press the **HOME BUTTON > Acc. Control** to launch the Accessory Control app.

Accessory Control allows you to assign buttons to control compatible hardware without installing physical controls. For instructions refer to your HORIZON10 installation guide.

*Recommended Hardware
<https://stingersolutions.com/products/switchhub-4-channel-100-amp-solid-state-relay>

Once your accessories are installed according to the HORIZON10 Installation guide, you're ready to set up your accessories.

1. Setup

Tap the setup button to begin setting up your new accessory. Assign a name and an icon to your accessory and confirm.

2. Accessory Control Button

Touch to turn accessory ON/OFF.

3. Accessory Settings Button

Touch to access accessory settings.

4. Accessory Settings

Change accessory name, icon, button behavior, and delete

ENLIGHT10 RGB LIGHTING



We know that the best time for adventure is after the sun goes down. That's why we've got a wide selection of Dynamic LED lighting to help you see and be seen when the ride gets dark.

Illuminate your ride and benefit from superior visibility with enLIGHT10.

Learn more at <https://stingersolutions.com/pages/enlight10>

DM SMART DSP



Your HORIZON10 has a fully integrated version of AudioControl's award winning DSP Software already installed.

Download the manual at <https://tinyurl.com/SmartDSP>
 Learn about DSP Tuning at <https://tinyurl.com/DSPTuning>

iGO NAVIGATION

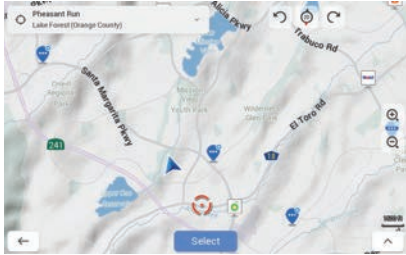

To access the optional iGO Navigation app, press Navigation from the Home menu or press the **[NAVIGATION]** button on your HORIZON10's face.

To add navigation, ask your dealer about Stinger's pre-loaded iGO Navigation SD Card (Part Number: SE-P24)

DISPLAY OFF



Press **HOME BUTTON > Display Off** to turn off your HORIZON10 display.

This is useful at night to prevent eye fatigue.

Tap anywhere on the screen to turn the display back on.

SETTINGS

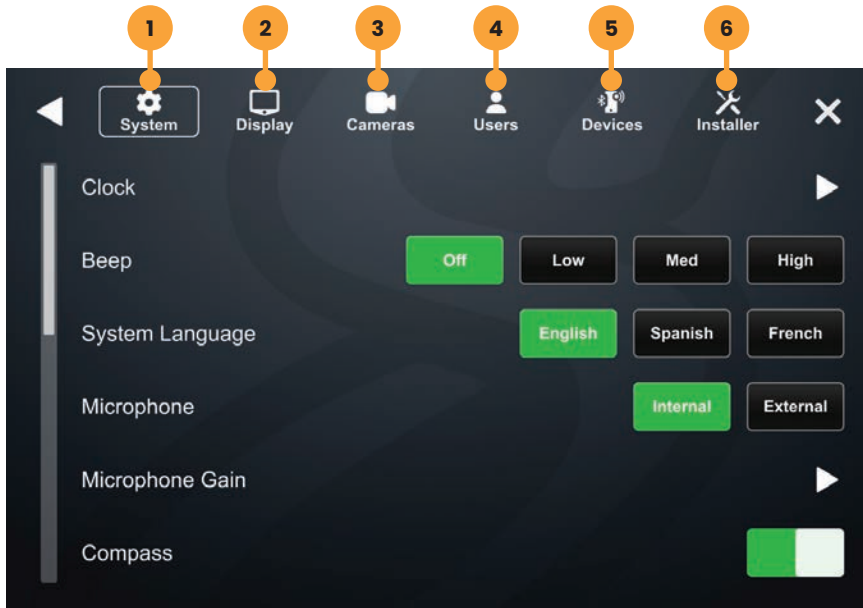

Press the **HOME BUTTON** > **Settings** to access the IX210 Head Unit Settings.

1. SYSTEM OPTIONS

Clock

Change GPS Time Zone and Time Display Format (12/24 HR).

Beep

Your IX210 Head Unit plays a feedback sound when you touch the unit. This controls feedback sound volume.

System Language

Change display language (English/Spanish/French).

Microphone

Set control to external if an external microphone is installed. Set to Internal to use the microphone located on the front of the display.

Microphone Gain

Adjusts the volume (sensitivity) of the microphone when using hands-free phone.

Compass

Toggle Compass display on/off.

Manage Apps

You can toggle applications on and off from this menu.

User Settings Import

Your IX210 can load settings from a USB drive. Insert a drive with a valid settings file into an available USB port and touch User Settings Import.

User Settings Export

Your IX210 can save its settings for later import. Insert a thumb drive into an available USB port and touch User Settings Export. Your IX210 will automatically add a date to your settings file name.

Load Defaults

All presets and user settings are reset to factory defaults.

System Information

Touch System Information to access application build numbers for support.

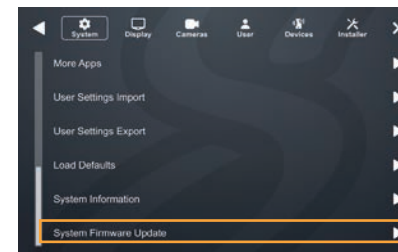

System Firmware Update

Checking and updating the System

Firmware and PAC Integration APK is an important step for proper operation. This should be done first before setting any system and vehicle settings as those settings may be lost after an update.

Make sure a thumb drive containing your firmware update is inserted into an available USB port and tap System Firmware Update.

You can find firmware updates on the Horizon10 Product Page

<https://tinyurl.com/stinger-h10>

2. DISPLAY OPTIONS



Auto Brightness

Your IX210 unit can adjust brightness to suit external conditions. Toggle on/off. Only works if illumination wire is connected.

Display Brightness

Adjust overall display brightness with arrows or the slider control.



Face Button Color

Select the face button color you like and hold "Favorite" to save that color.

Face Button Brightness

Adjust face button brightness with arrows or the slider control.

System Highlights

Change the highlight colors for active buttons & system controls.

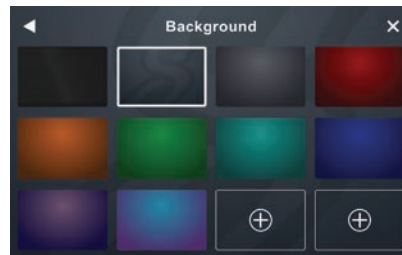

Background

You can select from one of ten available backgrounds or upload one of your own.

Make sure a thumb drive with a compatible image (1280 x 800 Jpg/Png) is inserted into an available USB port.

Tap one of the available **+ Buttons** and a pop up menu showing available images will appear. Select the desired background and tap **ADD**

3. CAMERAS

Camera Setup

Your IX210 Head Unit supports up to four cameras, each with their own trigger.

Your Head Unit comes with a preset reverse camera slot, and three more customizable slots

that are activated in the Cameras application once they are labeled and their video format set up.



1. Tap Camera Setup

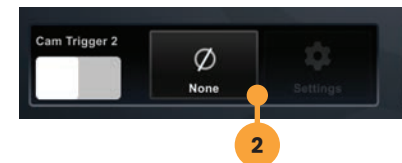

2. Tap a Trigger's Label Button

Once you tap the label button it will turn red and you'll have around 5 seconds to choose a label.



3. Assign Label

Once you assign a label, that camera's trigger and settings will be active.

Reverse Camera Audio

When set to ON and a microphone is connected, back up camera audio will be heard through the vehicle's speakers.

Mute Audio In Reverse

When set to ON the system will mute source audio playback while in reverse: camera audio still plays.

Switch to Front Camera after Reverse

When set to ON the front camera will turn on after shifting from Reverse gear and remain On until the speed reaches above 5MPH or the display is touched.

4. USER

Quick Access Tab

The Quick Access Tab is customizable and can be configured to include favorite sources, settings, or functions.

1. Select a tab position from the bottom row.



2. Select the desired source or

setting from the options on the top rows.

Favorite Key

You can program your favorite key with a variety of Sources, Settings, and Functions.

1. Select the desired source or function.

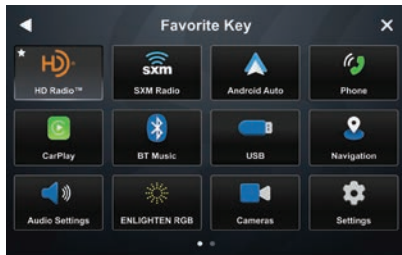

2. Tap BACK or EXIT to save your selection.

5. DEVICES

Device List

Your IX210 can store multiple phones and even connect to multiple bluetooth devices at once.

Add a New Device

1. Tap Device List

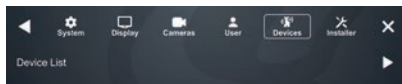

2. Make sure your device is in pairing mode and tap +Add a Device.

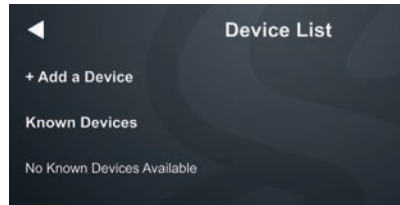

3. Select your device from the list.

If your device does not appear in the device list, confirm it is discoverable and tap Available Devices to rescan.

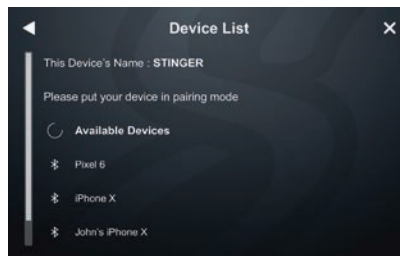

4. Confirm PIN Code on the head unit screen and the device.

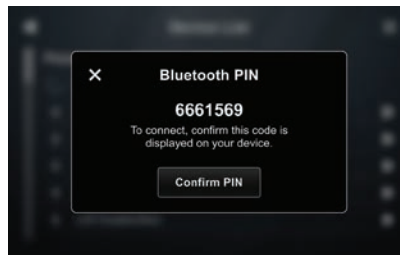

5. Select the connection type you want to use (bluetooth / phone projection).

If you choose phone projection,

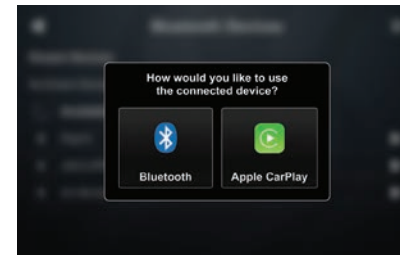
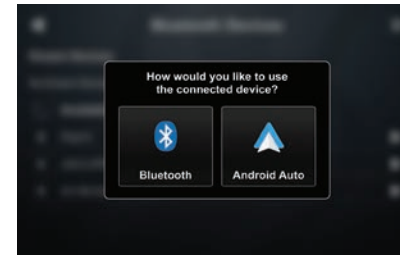

your phone projection application (Apple CarPlay/Android Auto) will launch automatically.

Connect to a Saved Device

A list of previously connected devices is available under Known Devices.

1. Make sure bluetooth is enabled on your mobile device.

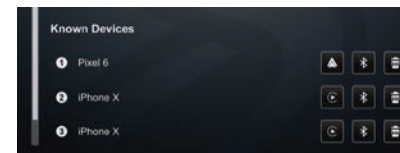

2. Press the phone projection or bluetooth button to connect to your device.

Disconnect a Device

Tap the DISCONNECT button to disconnect a connected device.



Delete a Device

Tap the DELETE button to delete a known device.



Apple CarPlay Options

You can change the orientation of Apple CarPlay's interface by toggling the Steering Wheel control left or right.

Bluetooth Auto Connect

Enable or disable automatic bluetooth device connection by tapping the toggle.

USB-C Settings

You can set your head unit's USB-C connection to charge only or enable Apple CarPlay / Android Auto through the USB-C port.

6. INSTALLER

Installer Menu Code

When you attempt to access the installer menu your HORIZON10 will ask for a passcode.

The installer passcode is 0052

Master Reset

Touch the Master Reset item to restore your head unit to factory settings. This action will reset installer settings, user settings, and PAC Integrations.

Steering Wheel Control

Your IX210 can reassign any of your steering wheel buttons to any available head unit from this menu.

Assign a Function to Steering Wheel Column Button

1. Touch the function you want to assign to a steering wheel column button.



The button will turn red for ~10 seconds. This indicates it is ready

to be programmed.

2. Touch the button on the steering wheel that you want to assign to the chosen function.

When your function is programmed successfully, its short press button will have a small green programmed indicator.

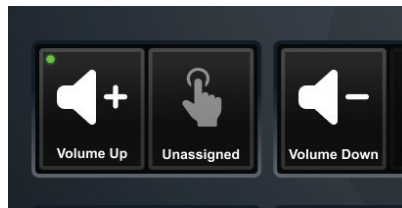

Assign a Function to Long Press on a Steering Wheel Column Button

You can assign a long press behavior to any programmed steering wheel button.

1. Touch the long press button for the steering wheel button you want to create a long press action for.

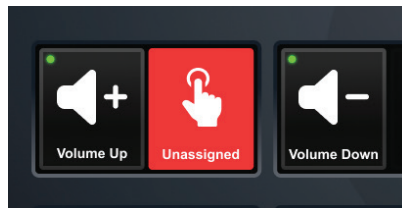

In this case, the function you assign the long press to will use the button you assigned Volume Up to.

2. Touch the function you want to assign to your long press action.



In this example, we are going to assign the favorite function to long press on our assigned volume up button.

When successfully programmed, your long press function will be highlighted and active.

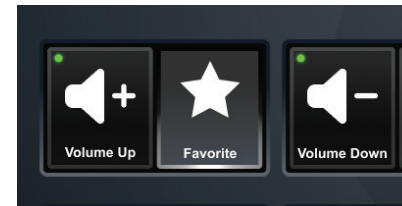

At this point, if you long press the Steering Wheel button you assigned the volume up function to, it will execute the favorite function and launch your favorited application.

Note: You can only assign a long press function for a button you've already programmed. Any function with a green light is available for long press programming.

NOTE: Some buttons already have long press functions by default. Volume Up and Down, and Next / Last Preset have unique long press behaviors in some apps.

Amp Remote Out

There are two options for automatically turning on external amplifiers. ACC turns on the external amp when Ignition ACC is on. The Power Off option will turn off your external amplifier whenever the head unit is asleep or off.

Wake Countdown

Your Horizon10 can wake when the doors of your car are unlocked and turn off after a set period if you don't turn the car on. This control sets the amount of time your radio will be on after door lock, but before the ignition is started.

iGO Navigation APK Update

See SE-P24 instruction guide.

DM Smart DSP APK Update

Make sure a thumb drive containing your update is inserted into an available USB port and tap System Firmware Update.

DM Control APK Update

Make sure a thumb drive containing your update is inserted into an available USB port and tap System Firmware Update.

AUDIO SETTINGS

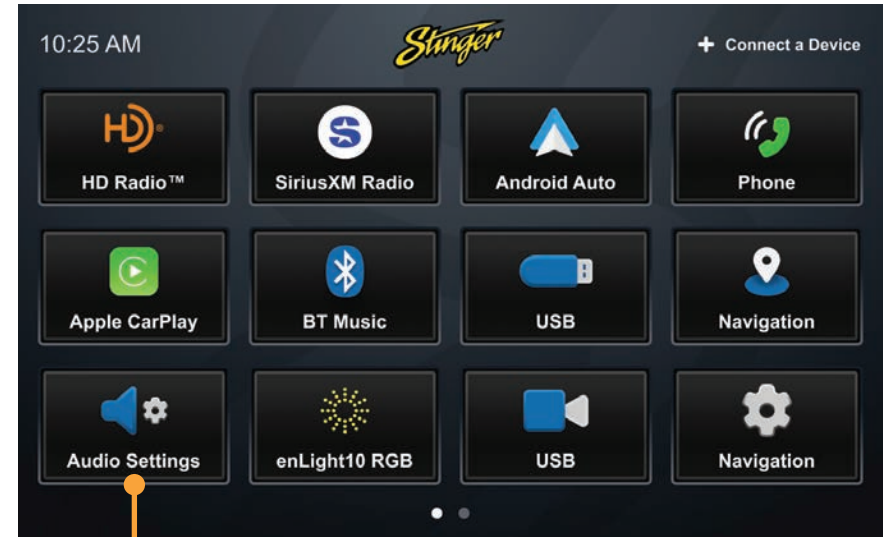

Press the **HOME BUTTON** > **Audio Settings** to access IX210 Audio Settings.



1. Balance & General Settings

Adjust Fade, Balance, Loudness, and Subwoofer settings quickly from this menu.

2. Equalizer

15 band graphic equalizer with multiple customizable preset slots.

3. Crossover

Internal electronic variable crossover with 6 customizable preset slots.

4. Time Correction

Compensate for uneven distances between speakers and listener.

5. Factory EQ

Quickly set popular equalizer settings for a variety of Genres.

6. Advanced Audio Settings

Defeat, ToSLink, Source Volume and Source Gain Settings

BALANCE / GENERAL AUDIO SETTINGS



Press the **HOME BUTTON** > **Audio Settings** > **Balance** to select the Balance/General Audio Settings

1. Reset

Press to set balance and fade to zero.

2. Balance

Using left/right arrows, adjust speaker balance left/right. You can also drag the set point to the desired fade & balance.

3. Fader

Using up/down arrows, adjust speaker fade front/rear

4. Battery Voltage

Shows current battery voltage.

5. Loudness

When ON, boosts +3db for frequencies between 100Hz & 2000Hz

6. Subwoofer

Turns subwoofer output ON/OFF.

7. Phase

Changes phase of subwoofer signal.

8. Subwoofer Level

Use left/right arrows or drag slider to adjust volume level of subwoofer.

EQUALIZER AUDIO SETTINGS



Press the **HOME BUTTON** > **Audio Settings** > **Balance** to select the Equalizer Audio Settings

1. Programmable Presets

There are 6 user Presets that can be used to save EQ settings. This is useful for having EQ settings for different types of music, volume levels or for different sources.

When you are done adjusting the EQ, touch and hold a Preset location to save the settings. The Preset will highlight.

2. Up/Down Volume Arrows

Adjust frequency volume by tapping the up/down arrows.

3. Frequency Volume Slider

Drag slider to adjust frequency Volume.

CROSSOVER AUDIO SETTINGS



Press the **HOME BUTTON** > **Audio Settings** > **Crossover** to select the Crossover Audio Settings

1. Audio Channel Selection

Select Front 1 (White), Front 2 (Teal), Rear (Red), or Subwoofer (Amber) channels to set crossover setting.

2. High/Low Pass Switch

Select which frequencies you want to modify settings for with this control.

2. Slope

Adjust the slope of the crossover for selected audio channel.

3. Frequency

Adjust crossover frequency for selected audio channel and pass.

5. Level

Adjusts signal level for selected audio channel.

6. Programmable Presets

Touch and hold a Preset location to save your settings. The Preset will highlight.

TIMING AUDIO SETTINGS



Press the **HOME BUTTON** > **Audio Settings** > **Timing** to select the Timing Audio Settings

1. Programmable Presets

2. +/- Distance Controls

Time Correction Instructions

Time Correction compensates for the uneven distances between the speakers and a listeners ears.

Time Correction delays signals from the closest speaker(s), so that all the sound arrives at the listening position at the same time,

giving the listener a more accurate, lifelike stereo image.

To set Time Correction, select a listening position, for example the drivers seat headrest.

Measure from each speaker to the listening position (be sure to mark those measurements down!).

Set Units to Inches and input recorded distances for each speaker using the +/- buttons.

FACTORY EQ AUDIO SETTINGS

Press the **HOME BUTTON** > **Audio Settings** > **Factory EQ** to select Factory EQ Audio Settings.



Selecting Factory EQ from the Audio Menu Bar will access factory equalizer presets for different music types.

When a Factory EQ preset is selected, it can be fine-tuned using the Equalizer and then re-saved as a User Preset.

ADVANCED AUDIO SETTINGS

Press the **HOME BUTTON** > **Audio Settings** > **Factory EQ** to select Advanced Audio Settings.

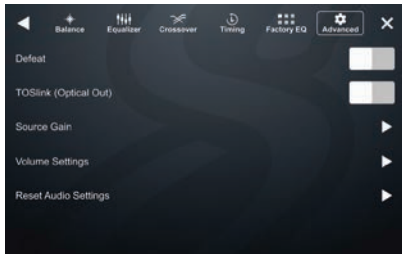

Defeat [ON/OFF]

When set to ON, will defeat/disable all equalizer, crossover, and speaker settings. This is useful when connecting to a Digital Signal Processor (DSP) When defeat is on, other audio settings will be

TOSlink (Optical Out) [ON/OFF]

Turns variable digital output ON/OFF

Source Gain Settings

Make gain/volume adjustments for individual sources. For example, if AM/FM is much louder than BT Music, lower AM/FM and/or raise

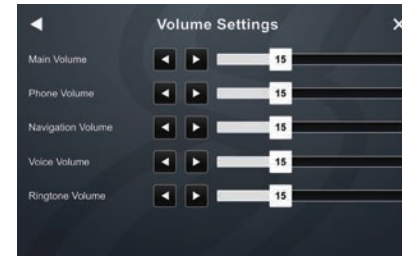
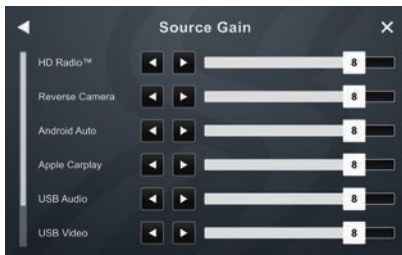

Volume Settings

Selecting Volume Settings from the Advanced Audio Settings will access the following Volume settings:

Start Volume, Bluetooth, Navigation and Siri Voice

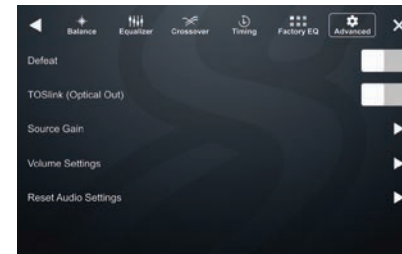

Reset Audio Settings

Selecting this will reset all of your audio settings after you confirm your selection. This action cannot be undone.

RESET BUTTON



Reset Button

The Reset Button is located on the lower right hand corner of the display.

To reset the unit, make sure it's on, use a paper clip or similar to push the reset button for 2 seconds and release.

The reset will take a few minutes, do not disconnect power during this time.

TROUBLESHOOTING

General

Black Screen w. Audio

Touch the screen anywhere as it may have been turned off, see page 28.

Ensure the cables on the back of the screen are fully locked into place and also properly connected at the back of the radio module.

Check for damaged/kinked cables.

Bluetooth

Device will not Pair

Ensure Bluetooth is turned ON in your device settings. Delete all unused devices. Delete any "Stinger" device. Restart/Reboot device and try pairing again. (Page: 10).

Music Volume is low

- Turn up volume on device
- Turn up volume on head unit.
- Turn up Phone Volume (Page: 43).

Phone Volume is low

- Turn up volume on device.
- Turn up volume on head unit.
- Turn up BT Volume Gain (Page: 43).
- Turn up Microphone Gain (Page: 22).

Cameras

Rear Camera not displaying in

reverse

- Make sure rear camera trigger is ON (Page: 31)
- If display is showing NO SIGNAL in reverse, ensure camera RCA is plugged into the correct RCA input (CAMERA IN).
- Confirm camera has power and ground.
- Confirm camera trigger is receiving positive 12V.

Installed Camera not showing Video

- Make sure the correct video format (NTSC, PAL, etc.) is selected.

User Note: Backgrounds

Your HORIZON10 head unit utilizes a Liquid Crystal Display (LCD) panel to display clear, crisp images in a variety of lighting conditions.

Your HORIZON10 unit is optimized to provide the highest quality image in a variety of use cases, but you should be aware that certain contrast ratios and backgrounds can cause temporary image retention.

When customizing your background, avoid images that include high contrast static patterns; these images can cause temporary image retention in LCD panels through repeated use.

Retained images should vanish within 10-40 minutes of normal operation. If

you see from your custom background, we strongly suggest you choose another option, or use one of the included HORIZON10 background options to ensure uninterrupted enjoyment. :)

SiriusXM Satellite Radio

Check Antenna

The radio has detected a fault with the SiriusXM antenna. The antenna cable may be either disconnected or damaged.

- Verify that the antenna cable is connected to the SiriusXM Connect Vehicle Tuner.
- Inspect the antenna cable for damage and kinks.

Replace the antenna if the cable is damaged. SiriusXM products are available at your local car audio retailer or online at www.shop.siriusxm.com.

Check Tuner

The radio is having difficulty communicating with the SiriusXM Connect Vehicle Tuner. The tuner may be disconnected or damaged.

Verify that the SiriusXM Connect Vehicle Tuner cable is securely connected to the radio.

No Signal

The SiriusXM Connect Vehicle Tuner

is having difficulty receiving the SiriusXM satellite signal.

- Verify that your vehicle is outdoors with a clear view of the sky.
- Verify that the SiriusXM magnetic mount antenna is mounted on a metal surface on the outside of the vehicle.
- Move the SiriusXM antenna away from any obstructions. Inspect the antenna cable for damage and kinks.
- Consult the SiriusXM Connect Vehicle tuner installation manual for more information on antenna installation.

Replace the antenna if the cable is damaged. SiriusXM products are available at your local car audio retailer or online at www.shop.siriusxm.com.

Channel Locked

The channel that you have requested is Locked by the radio Parental Control feature. See the Parental Control section on Page 18 for more information on the Parental Control feature and how to access locked channels. Default lock code is **1234**

Subscription Updated

The radio has detected a change in your SiriusXM subscription status.

Press anywhere on the screen to

clear the message.

Channel Unavailable

The channel that you have requested is not a valid SiriusXM channel or the channel that you were listening to is no longer available. You may also see this message briefly when first connecting a new SiriusXM Connect Vehicle tuner.

Visit www.siriusxm.com for more information about the SiriusXM channel lineup.

Memory End

This message will display when the beginning of stored audio has been reached. You cannot rewind any further.

Memory Full

The stored audio memory has become full while audio was paused.

Channel Unsubscribed

The channel that you have requested is not included in your SiriusXM subscription package or the channel that you were listening to is no longer included in your SiriusXM subscription package.

In the U.S.A., visit www.siriusxm.com or call 1-866-635-2349 if you have questions about your subscription. In Canada, visit www.siriusxm.ca or call 1-877-438-9677 if you have questions about your subscription.

Apple CarPlay

Restart your Phone

A common first step to take when you're having connection issues is to restart your device.

1. Turn your phone off.
2. Wait 30 seconds.
3. Turn your phone back on

Make sure your operating system is up to date

Apple often releases updates to your phone's operating system, known as iOS®, to keep it secure and working at its best. These software updates are important. Not updating your iPhone can lead to software issues and glitches, like CarPlay not working.

For step by step instructions, visit <https://support.apple.com/en-us/118575>

Make sure CarPlay is turned on

If your iPhone isn't connecting to Apple CarPlay, the feature may not be enabled on your device or you may have turned it off and need to turn it back on. Here's how:

Go to Settings > General > CarPlay > My Cars, then select your car to reconnect it to the app. Make sure to turn on the Allow CarPlay When Locked option, too, so that CarPlay works when your phone is locked.

If your car is already connected,

tap your car, then tap Forget This Car. Then connect it again.

If you've turned off CarPlay in Screen Time, go to Settings > Screen Time > Content & Privacy Restrictions. If you've turned on Content & Privacy Restrictions, tap Allowed Apps and confirm that CarPlay is enabled. (Tap the button until it's green.)

Confirm Siri is turned on

CarPlay won't work unless Siri® is turned on. To turn it on, go to Settings > Siri & Search on your iPhone, then confirm that Listen for "Hey Siri" is on.

Make sure to include the Allow Siri When Locked option, too, so that CarPlay works when your iPhone is locked.

Make sure Bluetooth is connected

If you're using a wireless CarPlay connection, go to Settings > Bluetooth to confirm that Bluetooth® is turned on. Then go to Settings > Wi-Fi to check that Wi-Fi is also turned on. Finally, go to Settings > General > CarPlay and check that Auto-Join is turned on.

Check your USB cable

Make sure the wire isn't frayed or broken. Try using it with another device—if it doesn't work, you probably have a faulty USB cable and need to replace it. Also, make sure you're plugged into the correct

USB-C port for phone projection. Apple CarPlay

Android Auto

Restart your Phone

A common first step to take when you're having connection issues is to restart your device.

1. Turn your phone off.
2. Wait 30 seconds.
3. Turn your phone back on

Make sure your operating system is up to date

You can find your device's Android version number, security update level, and Google Play system level in your Settings app. You'll get notifications when updates are available for you. You can also check for updates there as well

For step by step instructions, visit <https://support.google.com/android/answer/7680439>

Make sure Bluetooth is connected

If you're using a wireless Android Auto connection, go to Settings > Bluetooth to confirm that Bluetooth® is turned on.

Check your USB cable

Not all USB cables will work with all cars. For the best quality and reliability when you connect to Android Auto try a high-quality USB cable.

SPECIFICATIONS

General

Operating Voltage: 10.5VDC to 16VDC
 Grounding system; Negative Ground
 Max current consumption: 15A fused

Dimensions

Radio Module:
 177.7 mm x 112.96 mm x 50 mm
 (W x H x D)
 Display:
 247.2 mm x 180.56 mm x 36.19 mm
 (W x H x D)

Display

10.1-inch Diagonal
 16:10 aspect ratio
 1280 x 800
 Pixels: 1,024,000
 Active area 216.96 (W) x 135.6 (H) mm
 Operating Temperature (C) -20° to 70°

Audio

Load impedance: 4Ω nominal / 2Ω allowable
 Continuous power output:
 18W x 4ch/4Ω 20Hz to 20KHz, 1%THD at 14.4V
 Speaker level adjustment: 0-40 steps
 Audio Preamp Output level: 4.5Vrms typical, 7vrms maximum without distortion.
 Audio Preamp 8 Channels: Front 1 Left, Front1 Right, Front 2 Left, Front 2 Right, Rear Left, Rear Right, Subwoofer Left, Subwoofer Right.
 Equalizer: (15-band)
 25Hz/40Hz/63Hz/100Hz/160Hz/250Hz/400

Hz/630Hz/1KHz/1.6KHz/2.5KHz/4KHz/6.3KHz/10KHz/16KHz
 Gain: ±6dB (0.5dB/step)
 Crossover level: 10 steps
 Front1 and Rear output:
 HPF: 25Hz/40Hz/63Hz/80Hz/100Hz/160Hz/250Hz/500Hz/1kHz/3.5kHz/5kHz/bypass
 Slope: 6dB, 12dB, 18dB
 Level: 0-15,1db/step
 Front2 output:
 HPF: 25Hz/40Hz/63Hz/80Hz/100Hz/160Hz/250Hz/500Hz/1kHz/3.5kHz/5kHz/bypass
 LPF: 25Hz/40Hz/63Hz/80Hz/100Hz/160Hz/250Hz/500Hz/1kHz/3.5kHz/5kHz/bypass
 Slope: 6dB, 12dB, 18dB
 level: 0-15,1db/step
 Subwoofer Pre-lineout: 4.5Vrms typical, 7vrms maximum without distortion
 LPF: 25Hz/40Hz/63Hz/80Hz/100Hz/160Hz/250Hz
 Slope: 6dB, 12dB, 18dB
 Gain: 0db to 15dB (1dB/step)
 Subwoofer level: 0-15, 1db/Step
 Phase: 0 or 180
 Time Alignment for 8 channels: 0 to 133 steps for inches and 0-99 steps for 9.9ms
 User Preset EQ: Rock, Hip-Hop, Electronics, Jazz, Pop, Flat.
 Source Gain: default 0db, -10 to 10 adjustable, 0.35db/Step.
 Volume Settings: Main Volume, Phone Volume, Navigation Volume, Voice Volume, Ringtone Volume adjustable separately.
 Supports Internal & External Smart DSP

USB

USB 2.0 (two)
 Max current supply 1.5A
 Max storage size: 128GB
 USB Class: A
 Supports: Video/Audio/Image Media Playback, Charging, and Firmware Update
 USB 3.0 (one)
 Max current supply 3A
 Max storage size: 128GB
 USB Class: C
 MSC (Mass Storage Class),
 MTP (Media Transfer Protocol)
 File system: FAT32, NTFS
 Supports: Apple CarPlay, Android Auto, Video/Audio/Image Media Playback, Charging, and Firmware Update

Bluetooth

V5.1 dual
 4dBm Class2
 2.4GHz to 2.48GHz

Wifi

Support IEEE 802.11a/b/g/n/ac
 Support 802.11ac 1x1, Wave-2 compliant with MU-MIMO STA mode
 Complete 802.11n MIMO solution for 2.4GHz and 5Ghz band

HD Radio™ FM Tuner

87.9MHz to 107.9MHz
 Usable sensitive 3dBuV (mono S/N: 30dB)
 SNR: 65dB

AM Tuner

530KHz to 1710KHz
 Usable sensitive 25dBuV (mono S/N: 20dB)
 SNR: 58dB

4 Camera Video Inputs

NTSC, PAL, AHD 25 & 30 mhz
 Mirror Camera Image

Accessory Control

4x Accessory Control w. custom icon, name, & switch behavior

HDMI Input

Supported HDMI Resolutions:
 640*480p, 720*480p, 1280*720p, 1920*1080i, 1920*1080p

TOSLink

Output: 48khz Variable

Audio

MPEG-1 Audio Layer-3 (.mp3)
 FLAC (.flac)
 MPEG-2 Advanced Audio (.aac)
 MPEG-4 Audio (.m4a)
 Windows Audio (.wav)
 OGG Audio (.ogg)
 MP1
 MP2
 AAC
 AMR-NB
 AMR-WB
 APE
 PCM / ADPCM
 VORBIS

