



GM LOC (Line Output Converter) AXLOC-GM31 2019-Up

Visit AxxessInterfaces.com for more detailed information about the product and up-to-date vehicle specific applications

- Designed to provide (2) channels of low-level audio output from the factory system.
- Allows for the installation of an amplifier for speakers or subwoofers.
- Gain Controller included to adjust the overall output.
- 12v-500mA remote wire activated with signal sense.
- 55-watts per channel

Note: A single pole double throw (SPDT) relay is recommended when installing multiple amplifiers.

APPLICATIONS

Chevy			GMC		
Camaro (RPO IOR)	2019-Up	Malibu (RPO IOR)	2019-Up	Canyon (RPO IOR)	2019-Up
Cheyenne (RPO IOR)	2019-Up	Silverado (RPO IOR)	2019-Up	Sierra (RPO IOR)	2019-Up
Colorado (RPO IOR)	2019-Up	Sonic	2019-Up	Terrain (RPO IOR)	2019-Up
Cruze	2019	Spark (RPO IOR)	2019-Up		
Equinox (RPO IOR)	2019-Up				

For dash disassembly instructions, refer to metraonline.com. Enter the year, make, and model of the vehicle in the **Vehicle Fit Guide** for **Radio Install Kits**.

TABLE OF CONTENTS

Applications.....	1
Installation	2
Diagram.....	3

TOOLS REQUIRED

- Crimping tool and connectors, or solder gun, solder, and heat shrink
- Tape • Wire cutter • Zip-ties

KIT COMPONENTS

- AXLOC-GM31 Wiring Harness
- Gain Controller
- 12v-500mA Remote Wire
- Auxiliary Cable

ATTENTION: With the key out of the ignition, disconnect the negative battery terminal before installing this product. Ensure that all installation connections, especially the air bag indicator lights, are plugged in before reconnecting the battery or cycling the ignition to test this product.

NOTE: Refer also to the instructions included with the aftermarket accessory before installing this device.

INSTALLATION

1. Disconnect the harness from the factory tuner and install the **AXLOC-GM31 harness** provided with this kit.
2. Mount the gain controller in a suitable location, and connect the auxiliary cable to the **BASS KNOB**, then to the Gain Connector of the **AXLOC harness**.
3. Install the aftermarket amplifier and run an RCA pair (sold separately) to the line converter.
4. Connect the remote wire, plug in the device and secure all connections prior to testing.

NOTE: *If the vehicle is equipped with active noise cancellation microphones (ANC), it is recommended that they are disabled to prevent potential noise when installing subwoofers.*

DIAGRAM

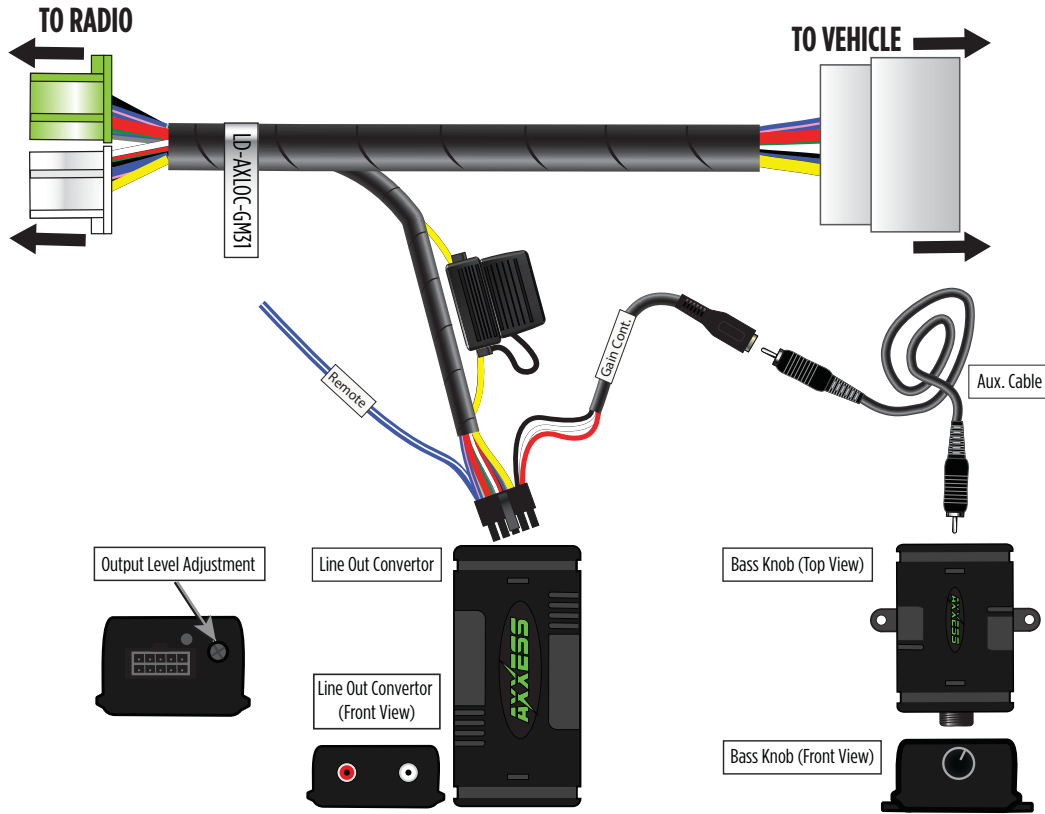



AXLOC-GM31

INSTALLATION INSTRUCTIONS



Having difficulties? We're here to help.



Contact our Tech Support line at:

386-257-1187



Or via email at:

techsupport@metra-autosound.com

Tech Support Hours (Eastern Standard Time)

Monday - Friday: 9:00 AM - 7:00 PM

Saturday: 10:00 AM - 7:00 PM

Sunday: 10:00 AM - 4:00 PM



KNOWLEDGE IS POWER

Enhance your installation and fabrication skills by enrolling in the most recognized and respected mobile electronics school in our industry. Log onto www.installerinstitute.edu or call 386-672-5771 for more information and take steps toward a better tomorrow.



**Metra recommends MECP
certified technicians**