

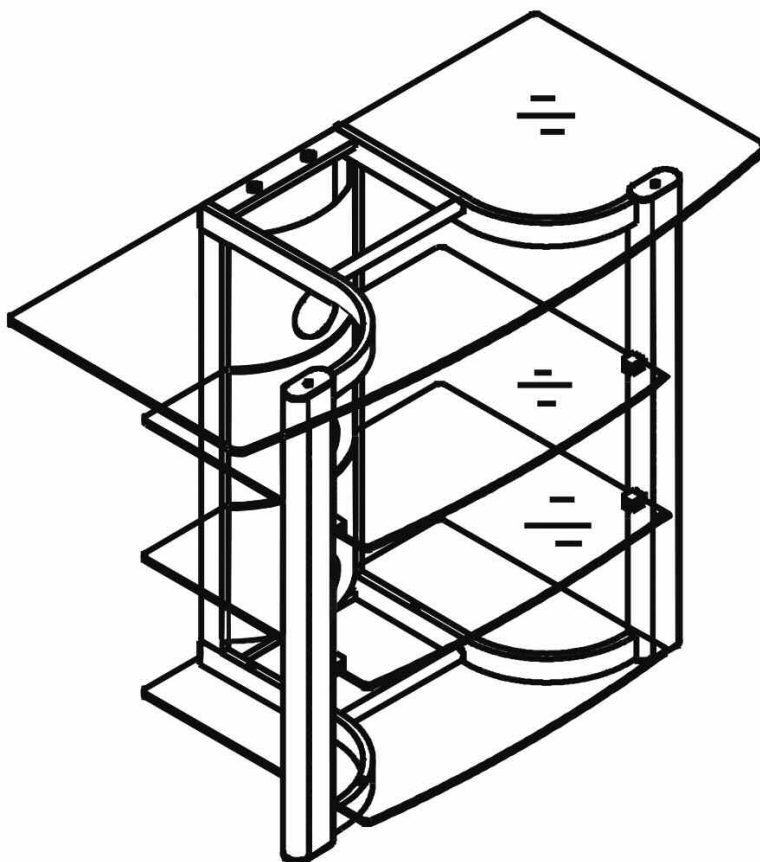

AVSC-2123 Audio Video System  
**ASSEMBLY INSTRUCTIONS**



PATENT PENDING

***FOR YOUR SAFETY, PLEASE FOLLOW THESE PRECAUTIONS:***



- ! ALWAYS REMOVE THE TV AND OTHER EQUIPMENT FROM THE FURNITURE PRIOR TO MOVING THE ASSEMBLED UNIT.
- ! BE CAREFUL WHEN MOVING THE ASSEMBLED FURNITURE AFTER THE SHELVES AND DOORS HAVE BEEN INSTALLED, AND/OR WHEN THERE IS EQUIPMENT LOCATED ON OR IN THE FURNITURE AS THIS MAY CAUSE THE SHELVES AND OTHER ITEMS TO BECOME UNSECURED AND FALL.
- ! WHEN IN USE, THIS FURNITURE MUST BE PLACED ON A FLAT, SOLID AND LEVEL SURFACE.
- ! DO NOT LEAN ON THE TV WHEN IT IS ON THE TV STAND.
- ! DO NOT CLIMB OR STEP ON THE STAND.
- ! DO NOT BANG OR PLACE YOUR OWN WEIGHT ON THE DOORS.
- ! DO NOT PLACE ITEMS ON THE SHELVES WHICH EXCEED THE MAXIMUM WEIGHT LIMITS OF 100 LBS. FOR TOP SHELF AND 50 LBS. FOR EACH LOWER SHELF

## PARTS LIST

### PART DESCRIPTION

### QUANTITY

A. TOP SHELF SUPPORT

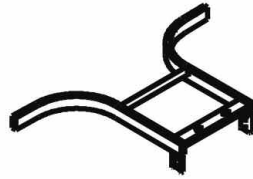

1 PC

B. BOTTOM SHELF SUPPORT

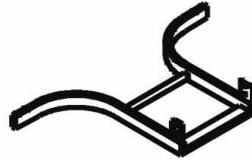

1 PC

C. LEFT FRONT FRAME SUPPORT



1 PC

D. RIGHT FRONT FRAME SUPPORT



1 PC

E. CABLE MANAGEMENT SYSTEM®



1 PC

F. TOP GLASS SHELF

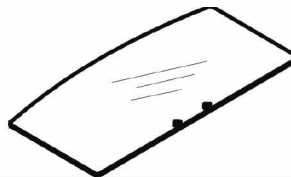

1 PC

G. LOWER GLASS SHELVES

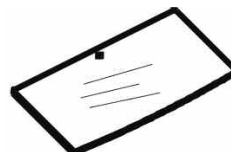

3 PCS

## HARDWARE LIST

### PART DESCRIPTION

### QUANTITY

1. 50mm BOLT



8 PCS

2. 10mm FRAME SCREW



8 PCS

3. PLASTIC END CAP

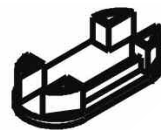

4 PCS

4. GLASS PAD



6 PCS

5. SHELF LOCK PIN



3 PCS

6. PLASTIC SHELF SCREW



4 PCS

7. 13mm TOP SHELF SCREW



2 PCS

8. SCREWDRIVER TOOL



1 PC

9. ALLEN WRENCH TOOL



1 PC

# ASSEMBLY INSTRUCTIONS

**NOTE:** 2 PEOPLE ARE RECOMMENDED TO ASSEMBLE THIS FURNITURE. TO AVOID DAMAGE DURING ASSEMBLY, IT SHOULD BE ASSEMBLED ON A SOFT SURFACE.

Fig. 1

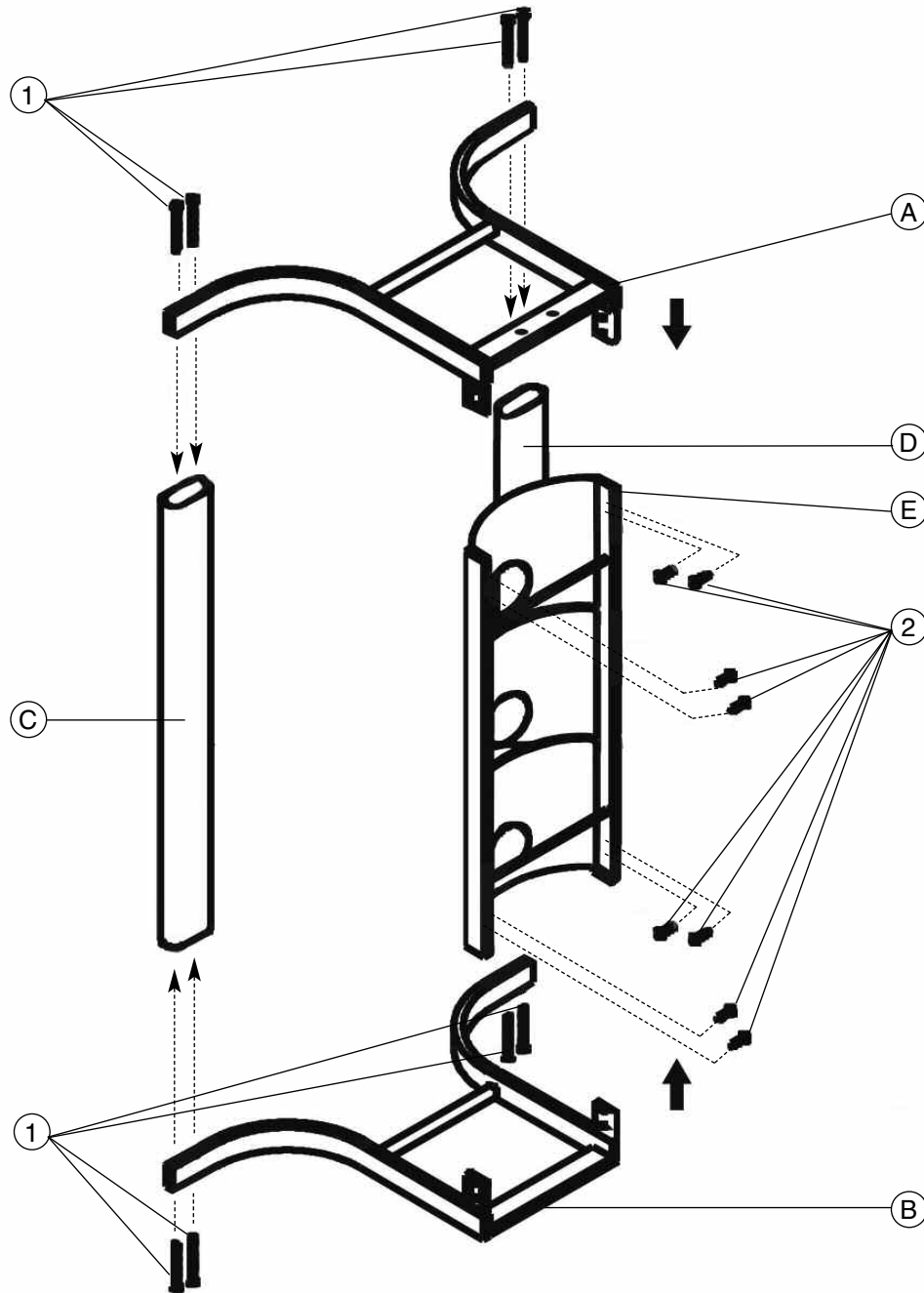

1. **PLACE** the Bottom Shelf Support (B) right side up on a soft, flat surface. **PLACE** the Cable Management System® (E) onto the Bottom Shelf Support as shown in Fig. 1 and **SECURE** using four 10mm Frame Screws (2) and tighten slightly with supplied Allen Wrench (9). At this point, **DO NOT TIGHTEN FULLY**.
2. **TILT** the unit onto its back so that the Cable Management System® is laying flat on the floor. **ATTACH** both Left and Right Front Frame Supports (C & D) to the Bottom Shelf Support, making sure the wood panels are facing forward, and **SECURE** from underneath the Bottom Shelf Support using two 50mm Bolts (1) for each Front Frame Support and tighten slightly with the supplied Allen Wrench. At this point, **DO NOT TIGHTEN FULLY**.
3. **TILT** the unit back up into an upright position, and **ATTACH** the Top Shelf Support (A) as shown. **SECURE** the Top Shelf Support to the Left and Right Front Frame Supports using two 50mm Bolts for each support. **SECURE** to the Cable Management System® with four 10mm Frame Screws using the Allen Wrench.
4. Once all parts are correctly fastened together, go back and **TIGHTEN** all screws completely.

**Fig. 2**

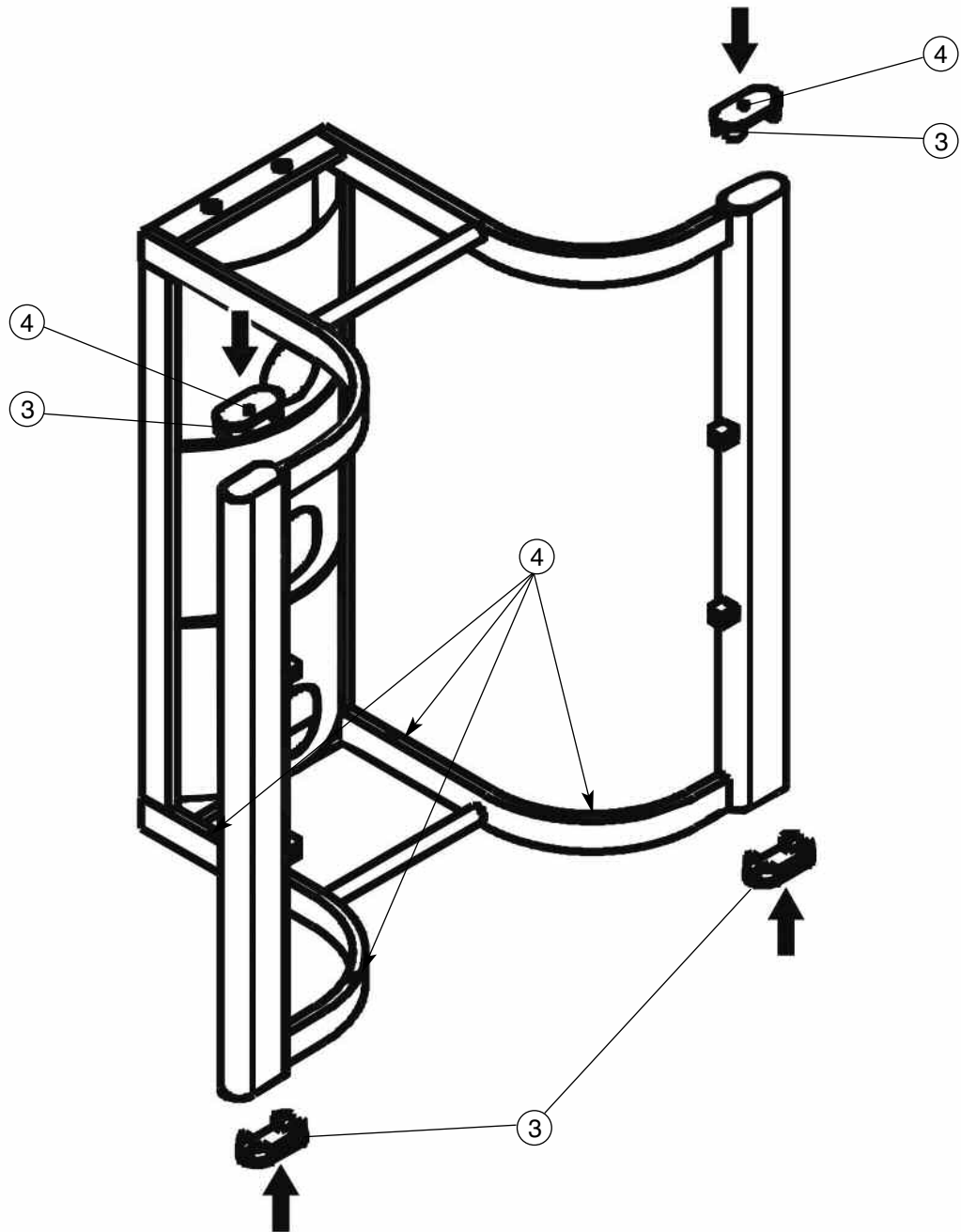

4. **TILT** frame assembly onto its back and **APPLY** the four Plastic End Caps (3) to the ends of each Left and Right Front Frame Supports (C & D).
5. **TILT** the frame assembly back up into an upright position. **APPLY** four Glass Pads (4) (where indicated in Fig. 2) to the Bottom Shelf Support (B). **APPLY** two Glass Pads onto the Plastic End Caps located at the tops of the Left and Right Front Frame Supports as indicated in illustration above.
6. With the help of a second person, **MOVE** assembled frame to the location of its intended use.

**Fig. 3**

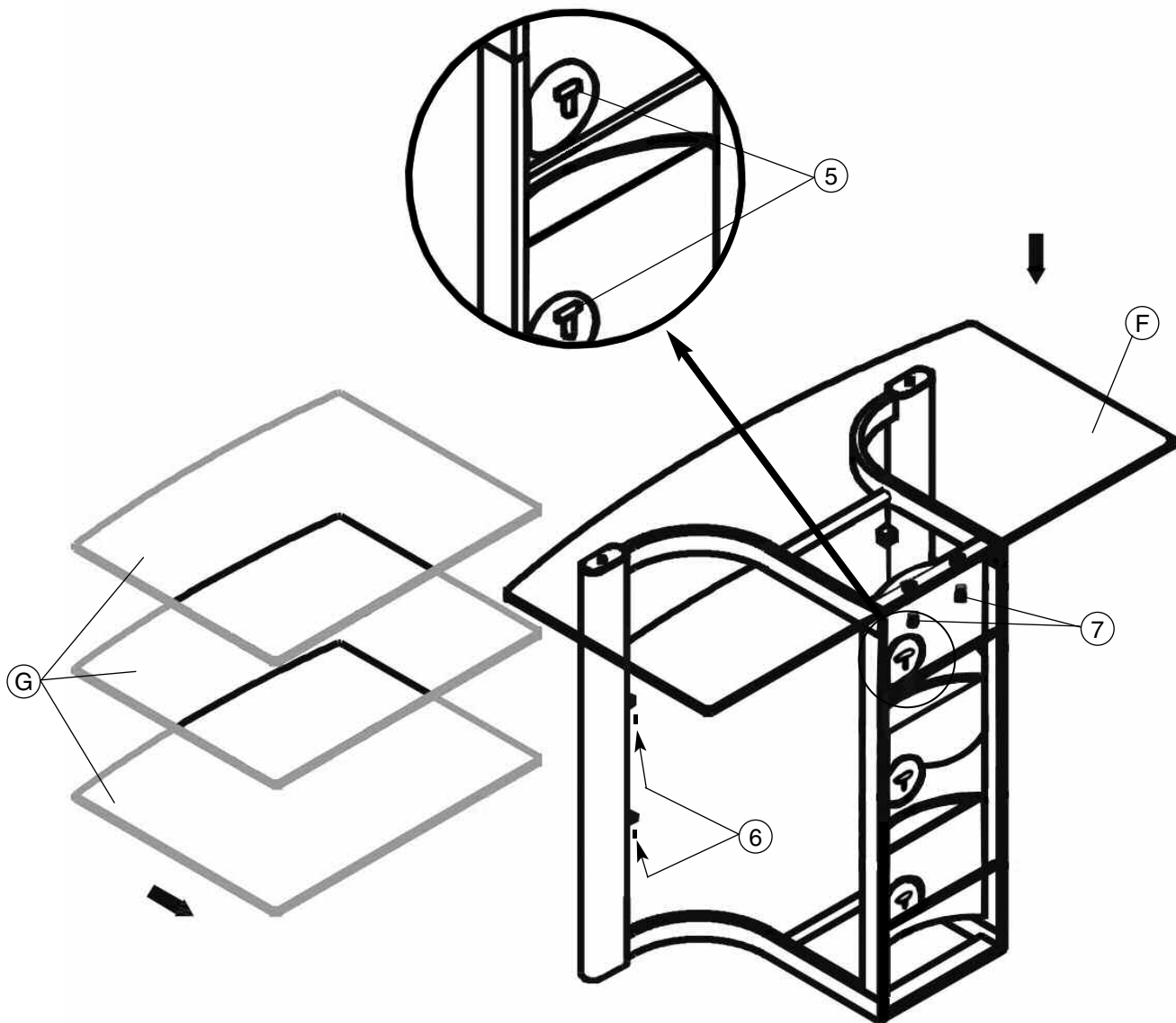

7. **PLACE** the Top Glass Shelf (F) onto the assembled frame, making sure the curved edge of the Glass Shelf faces the front of the unit, and that the two silver disks used to secure the shelf fit into the holes at the top of the Cable Management System® (E). **SECURE** the Top Glass Shelf to the unit using two 13mm Top Shelf Screws (7), with the supplied Allen Wrench (9), as indicated in Fig. 3. **DO NOT OVERTIGHTEN.**
8. **PLACE** the three Lower Glass Shelves (G) into the frame assembly, making sure each fits securely into the shelf slots on the Left and Right Front Frame Supports, and into the slots in the Cable Management System®.
9. **SECURE** each Lower Glass Shelf into place by applying four Plastic Shelf Screws (6) from the underside of each slot on the Left and Right Front Frame Supports, and **TIGHTEN** using the supplied Screwdriver Tool (8). **DO NOT OVERTIGHTEN.**
10. From the rear of the Cable Management System®, **APPLY** the three Shelf Lock Pins (5) to back of the the Lower Glass Shelves to further secure the shelves.



## Warranty

### One (1) Year Limited Warranty

All Bell'O International products are warranted, with the exception of glass, to the original purchaser at the time of purchase and for a period of one (1) year thereafter. Glass is warranted to the original purchaser at the time of purchase and for a period of thirty (30) days thereafter. Warranty is only valid in the United States of America.

In order to provide you with timely assistance, please thoroughly inspect your furniture for missing or defective parts immediately after opening the carton. To receive replacement or missing part(s) under this warranty, go to our website at [www.bello.com](http://www.bello.com) or call our **Customer Service Department at 1-888-235-7646**. Please have the model number and part number(s) for reference. You will also need your sales receipt or other proof of purchase. Replacement part(s) will be shipped to you at no charge with Bell'O International assuming all shipping and handling expense.

We warrant to you, the original purchaser, that our furniture and all of its parts and components are free of defects in material or workmanship. "Defects", as used in this warranty, is defined as any imperfections that impair the use of the furniture or product.

Our warranty is expressly limited to the replacement of furniture parts and components. For one (1) year after the date of purchase, Bell'O International will replace any part described on the enclosed furniture parts list that is defective in material or workmanship.

This warranty applies under conditions of normal use. Our furniture products are not intended for outdoor use. The warranty does not cover: 1) defects caused by improper assembly or disassembly; 2) defects caused by shipping, claims for damage during transit to you should be placed immediately by you to the transportation company; 3) defects occurring after purchase due to product modification, intentional damage, accident, misuse, abuse, negligence or exposure to the elements; 4) cosmetic damage and 5) labor or assembly costs.

There are no warranties, express or implied, including without limitation merchantability or fitness for particular use, except as (i) contained herein or (ii) required by applicable law in the state whose law governs (which shall be New Jersey absent controlling law imposing the law of another state in lieu thereof as governing law). All warranties of whatsoever derivation shall be limited to the term set forth above, unless otherwise required by applicable law.

Manufacturer's employees or representatives' ... ORAL OR OTHER WRITTEN STATEMENTS DO NOT CONSTITUTE WARRANTIES, shall not be relied upon by Buyer, and are not a part of the contract for sale or this limited warranty.

Except as provided herein, Bell'O International shall have no liability or responsibility to the purchaser or any other person or entity with respect to any liability, loss or damage caused directly or indirectly by use of the product, including, but not limited to, any incidental or consequential damages. Some states do not allow limitation on how long an implied warranty can last or the exclusion of limitation of incidental or consequential damages, so the above limitation and exclusion may not apply to you.

This warranty gives you specific legal rights. You may also have other rights, which vary from state to state.

**BELL'O INTERNATIONAL CORPORATION, 711 Ginesi Drive, Morganville, NJ 07751-1235**  
**Phone: (732) 972-1333 Fax: (732) 536-6482 Web: [www.bello.com](http://www.bello.com) E-mail: [sales@bello.com](mailto:sales@bello.com)**