

Use, Care, and Installation Guide

SAVONA

ZSA-M90S

ZSA-E30S

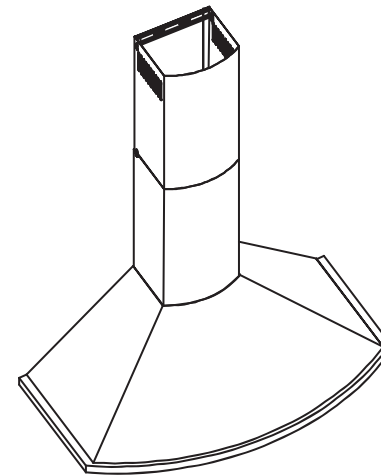

Voltage 120V 60Hz
Power consumption
Total: 400W
Lamp: Max50Wx2
Fan: 300W

Model number: _____
Serial number: _____
Dealer Name: _____
Date of Purchase: _____

JAN06.0101 © Zephyr Corporation



Read all Instructions before Installing and operating this appliance

Important Safety Notice

READ AND SAVE THESE INSTRUCTIONS

WARNING—

TO REDUCE THE RISK OF FIRE, ELECTRIC SHOCK, OR INJURY TO PERSONS, OBSERVE THE FOLLOWING:

- a) Use this unit only in the manner intended by the manufacturer. If you have questions, contact the manufacturer.
- b) Before servicing or cleaning unit, switch power off at service panel and lock the service disconnecting means to prevent power from being switched on accidentally. When the service disconnecting means cannot be locked, securely fasten a prominent warning device, such as a tag, to the service panel.

" CAUTION "

"For General Ventilating Use Only. Do Not Use To Exhaust Hazardous Or Explosive Materials And Vapors."

WARNING—

TO REDUCE THE RISK OF FIRE, ELECTRIC SHOCK, OR INJURY TO PERSONS, OBSERVE THE FOLLOWING:

- a) Installation work and electrical wiring must be done by qualified person(s) in accordance with all applicable codes and standards, including fire-rated construction.
- b) Sufficient air is needed for proper combustion and exhausting of gases through the flue (chimney) of fuel burning equipment to prevent back drafting. Follow the heating equipment manufacturer's guideline and safety standards such as those published by the National Fire Protection Association (NFPA). And the American Society for Heating, Refrigeration and Air Conditioning Engineers (ASHRAE), and the local code authorities.
- c) When cutting or drilling into wall or ceiling, do not damage electrical wiring and other hidden utilities.
- d) Ducted fans must always be vented to the outdoors.
- e) If this unit is to be installed over a tub or shower, it must be marked as appropriate for the application and be connected to a GFCI (Ground Fault Circuit Interrupter)-protected branch circuit.

" WARNING "

" TO REDUCE THE RISK OF FIRE, USE ONLY METAL DUCTWORK. "

WARNING—

TO REDUCE THE RISK OF A RANGE TOP GREASE FIRE:

- a) Never leave surface units unattended at high settings. Boilovers cause smoking and greasy spillovers that may ignite. Heat oils slowly on low or medium settings.
- b) Always turn hood ON when cooking at high heat or when flambeing food (i.e. Crepes Suzette, Cherries Jubilee, Peppercorn Beef Flambe'),

Read all Instructions before Installing and operating this appliance

- c) Clean ventilating fans frequently. Grease should not be allowed to accumulate on fan or filter.
- d) Use proper pan size. Always use cookware appropriate for the size of the surface element.

WARNING—

TO REDUCE THE RISK OF INJURY TO PERSONS IN THE EVENT OF A RANGE TOP GREASE FIRE, OBSERVE THE FOLLOWING^a:

- a) SMOTHER FLAMES with a close-fitting lid, cookie sheet, or metal tray, then turn off the burner. BE CAREFUL TO PREVENT BURNS. If the flames do not go out immediately, EVACUATE AND CALL THE FIRE DEPARTMENT.
- b) NEVER PICK UP A FLAMING PAN – You may be burned.
- c) DO NOT USE WATER, including wet dishcloths or towels – a violent steam explosion will result.
- d) Use an extinguisher ONLY if:
 - 1) You know you have a Class ABC extinguisher, and you already know how to operate it.
 - 2) The fire is small and contained in the area where it started.
 - 3) The fire department is being called.
 - 4) You can fight the fire with your back to an exit

^aBased on "Kitchen Firesafety Tips" published by NFPA.

"CAUTION"

To reduce risk of fire and to properly exhaust air, be sure to duct air outside-Do not vent exhaust air into spaces within walls or ceilings or into attics, crawl spaces, or garages.

WARNING—

TO REDUCE THE RISK OF FIRE OR ELECTRIC SHOCK, DO NOT USE THIS FAN WITH ANY SOLID-STATE CONTROL DEVICE.

OPERATION—

Always leave safety grills and filters in place. Without these components, operating blowers could catch onto hair, fingers and loose clothing.

***NOTE:** Please check www.zephyronline.com for revisions before doing any custom work.

MOUNT HEIGHTS & CLEARANCE

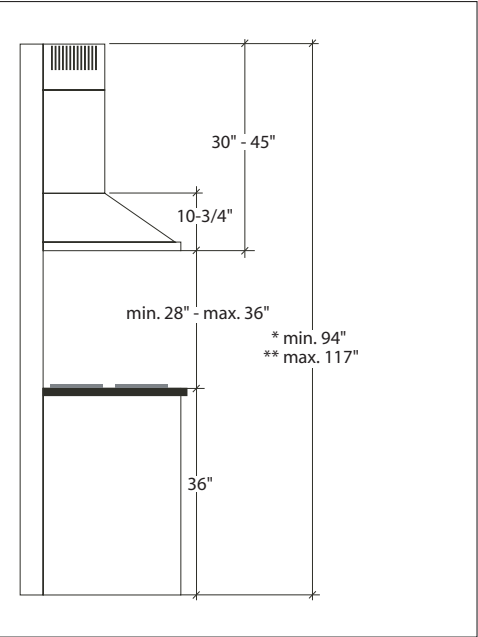

Minimum mount height between range top to hood bottom should be no less than 28".

Maximum mount height should be no higher than 36".

It is important to install the hood at the proper mounting height. Hoods mounted too low could result in heat damage and fire hazard; while hoods mounted too high will be hard to reach and will lose its performance and efficiency.

If available, also refer range manufacturer's height clearance requirements and recommended hood mounting height above range.

- *Minimum ceiling clearance 94" at 28" hood mounting height.
- **Maximum ceiling clearance 117" at 36" hood mounting height.

DUCTING

A minimum of 6" round or 3-1/4 x 10" rectangular duct must be used to maintain maximum air flow efficiency.

Always use rigid type metal ducts only. Flexible ducts could restrict air flow by up to 50%.

Also use calculation (on right) to compute total available duct run when using elbows, transitions and caps.

ALWAYS, when possible, reduce the number or transitions and turns. If long duct run is required, increase duct size from 6" to 7 or 8". If a reducer is used, install a long reducer instead of a pan-cake reducer. Reduce duct size as far away from opening as possible.

If turns or transitions are required: Install as far away from opening and as far apart, between 2, as possible.

- Minimum Duct Size:
Round- 6" minimum
Rectangular- 3-1/4 x 10" minimum (requires a 6" to 3-1/4 x 10" adapter not supplied)

Duct Run Calculation:

| | |
|-------------------------|--------|
| Maximum run | |
| 6" or 3-1/4 x 10" duct | 100 FT |
| Deduct: | |
| each 90 Elbow used | 15 FT |
| each 45 elbow used | 9 FT |
| each 6" to 3/14 x 10" | |
| transition used | 1 FT |
| each 3/14 x 10" to 6" | |
| each 3/14 x 10" to 6" | |
| transition used | 5 FT |
| Side Wall Cap w/ damper | 30 FT |
| Roof Cap | 30 FT |

e.g.- 1 roof cap, 2x90 elbows, 1 45 elbow used:
=30' + 30' + 9' =69' used, 31' available for straight duct runs.

INSTALLATION

DUCTING

WARNING FIRE HAZARD

NEVER exhaust air or terminate duct work into spaces between walls, crawl spaces, ceilings, attics or garages. All exhaust must be ducted to the outside.

Use metal ductwork only.

Fasten all connections with sheet metal screws and tape all joints with certified silver tape or duct tape.

Some Ducting Options:

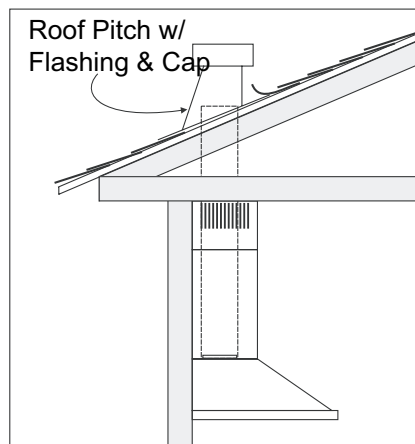
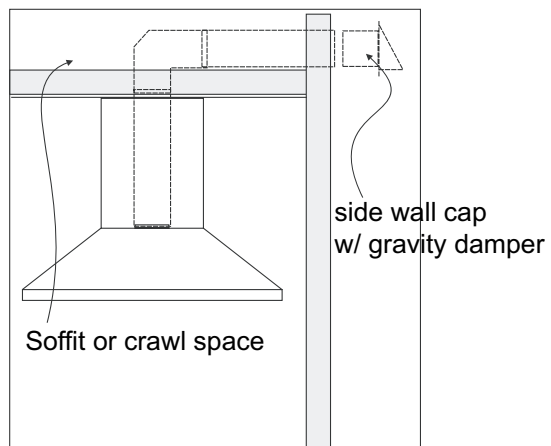
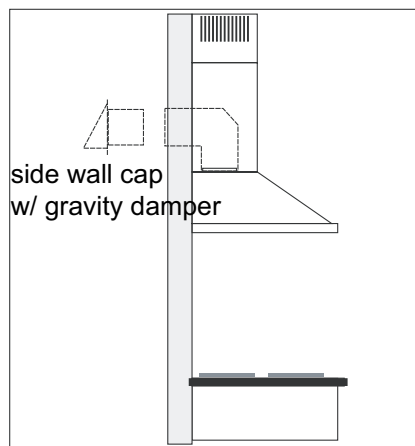

INSTALLATION

SPECIFICATIONS

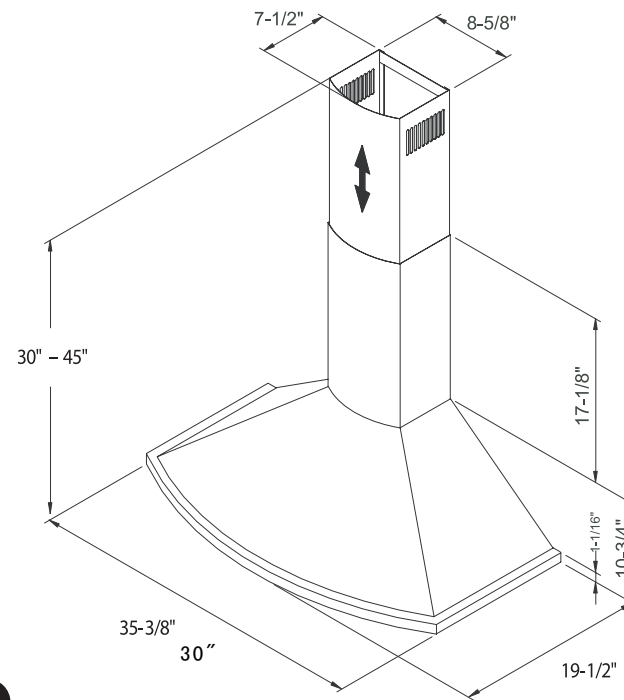

ELECTRICAL

WARNING

All electrical work must be performed by a qualified electrician or person with similar technical know how and background.

For personal safety, remove house fuse or open circuit breaker before beginning installation. Do not use extension cord or adapter plug with this appliance.

Follow national electrical codes or prevailing local codes and ordinances.

Electrical Supply:

This appliance requires a 120V 60Hz electrical supply and connected to an individual, properly grounded branch circuit, protected by a 15 or 20 ampere circuit breaker or time delay fuse. Wiring must be 2 wire with ground. Please also refer to electrical diagram labeled on product.

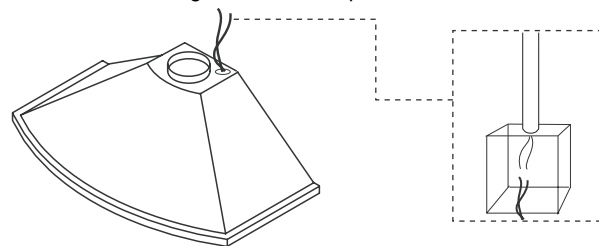

INSTALLATION

INSTALLATION

Mounting the Range Hood

1. Measure from range top to hood bottom (28" min) Level and mark line A.
2. Plum and mark center line.
3. Mark mounting height line B. (9-9/16 from line A)
4. Mark mounting spread from C/L (9-27/32)
5. Fasten E-Z anchors to wall (see below) as marked.
6. Fasten screws provided onto EZ anchors, do not fasten screws all the way.
7. Hang hood onto screws and hand tighten (fig A).

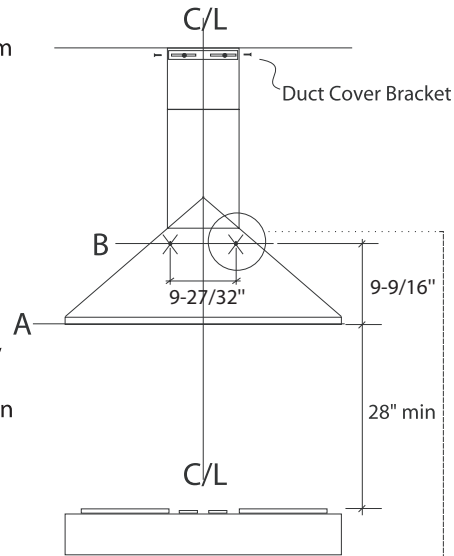

Mounting the Duct Cover

1. Center and attach duct cover mount bracket on wall below ceiling or soffit.
2. Fasten telescopic duct covers onto hood and bracket.

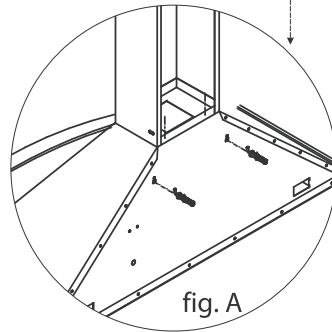

EZ ANCHORS

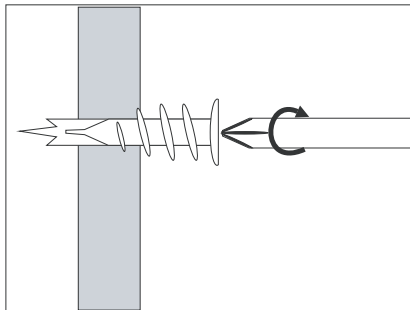

Tap EZ anchor tip into marked drywall locations, turn with screwdriver until seated flush.

Note: Whenever possible, the hood should be secured to wall studs. Use EZ anchors provided only on hollow drywall applications (minimum drywall thickness 1/2"). If a stud or wood surface is present, fasten the hood with screws directly into stud or plywood. For all other wall types (concrete, brick, tiles etc.), use appropriate anchors for mounting.

INSTALLATION

DUCTLESS CONVERSION

Ductless conversion is intended for applications where an exhaust duct work is not possible to be installed. When converted, the hood functions as a "purifying" hood rather than an exhaust hood. Fumes and exhaust from cooking is drawn and filtered by a set of optional Carbon Filters. The air is then purified and re-circulated back within the home.

We recommend to ALWAYS exhaust air outside of the home by employing existing or installing new duct work, if possible. The hood is most effective and efficient as an Exhaust unit. Only when the exhaust option is not possible should you recourse to converting the hood into a "purifying" unit.

When converted to be a "purifying" unit, a set of Carbon Filters are required on top of its standard Metal Filter set. Order according to its Part number below. The standard Metal Filters are intended to capture residue from cooking and the optional Carbon Filters help to purify fumes exhausted from cooking for re-circulation.

Carbon Filters (Required)

1. Purchase ductless Carbon Filters as follows:

| Hood Model: | Part No. | Filters in pkg. |
|-------------|----------|-----------------|
| ZSA-M90S | Z0F-C022 | 2 |
| ZSA-E30S | Z0F-C022 | 2 |

2. Install adaptor brackets and metal filters.
3. Install carbon filters onto brackets.
4. Re-install metal filters.
5. Turn on filter change indicator on control panel.
6. Carbon Filters must be replaced after every 120 hours of use (or approximately every 2 to 3 months based on the average of 1-2 hrs. of daily cooking time). The microprocessor in the controls when set, will count usage time and indicate when carbon filter replacement is required.

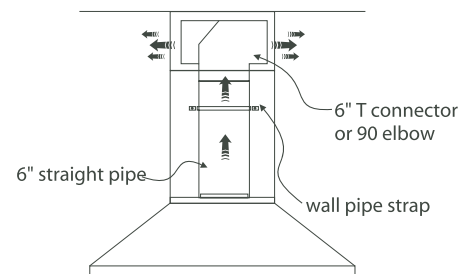
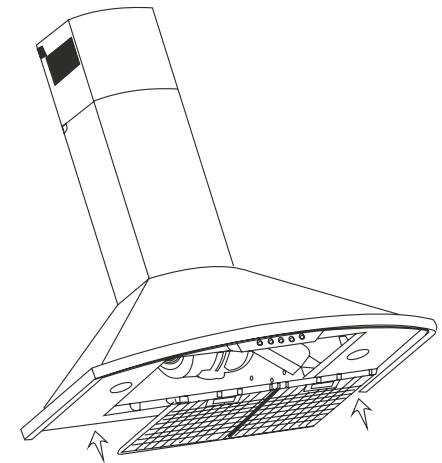

Ducting

1. Install a 6" straight pipe and a "T" connector/ or a 90 elbow to divert air through louvers on duct cover.

CONTROLS & FEATURES

CONTROLS & FEATURES

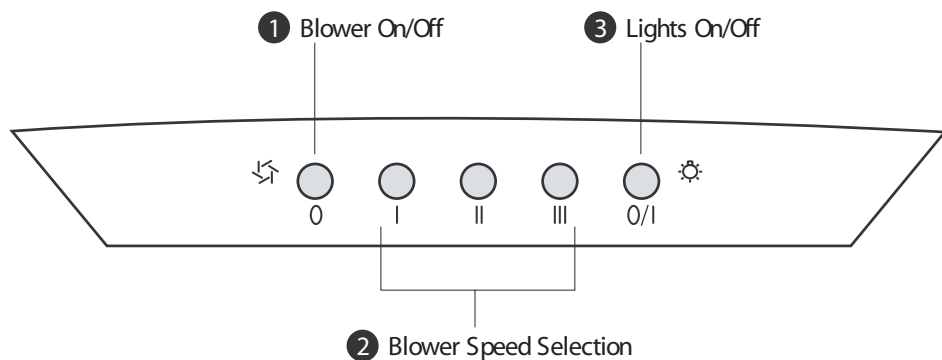

1 Blower On/Off

The blower will be switched on or off by pressing:



2 Blower Speed Selection

Select one of three speed levels by pressing:

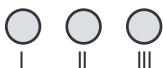

3 Lights On/Off

Switch lights on and off by pressing:



MAINTENANCE

CLEANING

Surface Maintenance:

Clean periodically with hot soapy water and clean cotton cloth. Do not use corrosive or abrasive detergent (e.g. comet powder scrub, EZ-Off oven cleaner), or steel wool/scoring pads which will scratch and damage surface.

For heavier soil use liquid degreaser such as 'Formula 409' or 'Fantastic' brand cleaner.

After cleaning, you may use non abrasive stainless steel polish/ cleaners such as 3M or ZEP, to polish and buff out the stainless luster and grain. Always scrub lightly, with clean cotton cloth, and with the grain.

Metal Filters

The Metal Filters fitted by the factory are intended to filter out residue and grease from cooking. It need not be replaced on a regular basis but are required to be kept clean. Filters should be cleaned after every 30 hours of use.

Remove and clean by hand or in dishwasher. Spray 'Formula 409' or equivalent degreasing detergent and leave to soak if heavily soiled.

Dry filters and re-install before using hood.

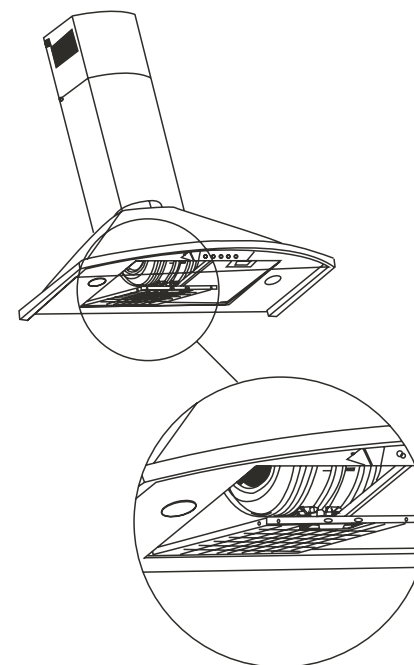

Replacing Metal Filters

Should filters wear out due to age and prolonged use, replace with following part number:

| Hood Model: | Part No. | Filters in pkg. |
|-------------|----------|-----------------|
| ZSA-M90S | Z0F-MO22 | 2 |
| ZSA-E30S | Z0F-MO22 | 2 |

Also replace damaged filter that has punctured or broken mesh, bent or broken frame.

Exploded View Diagram

Savona
ZSA-M90S
ZSA-E30S

10-Hardware Packet

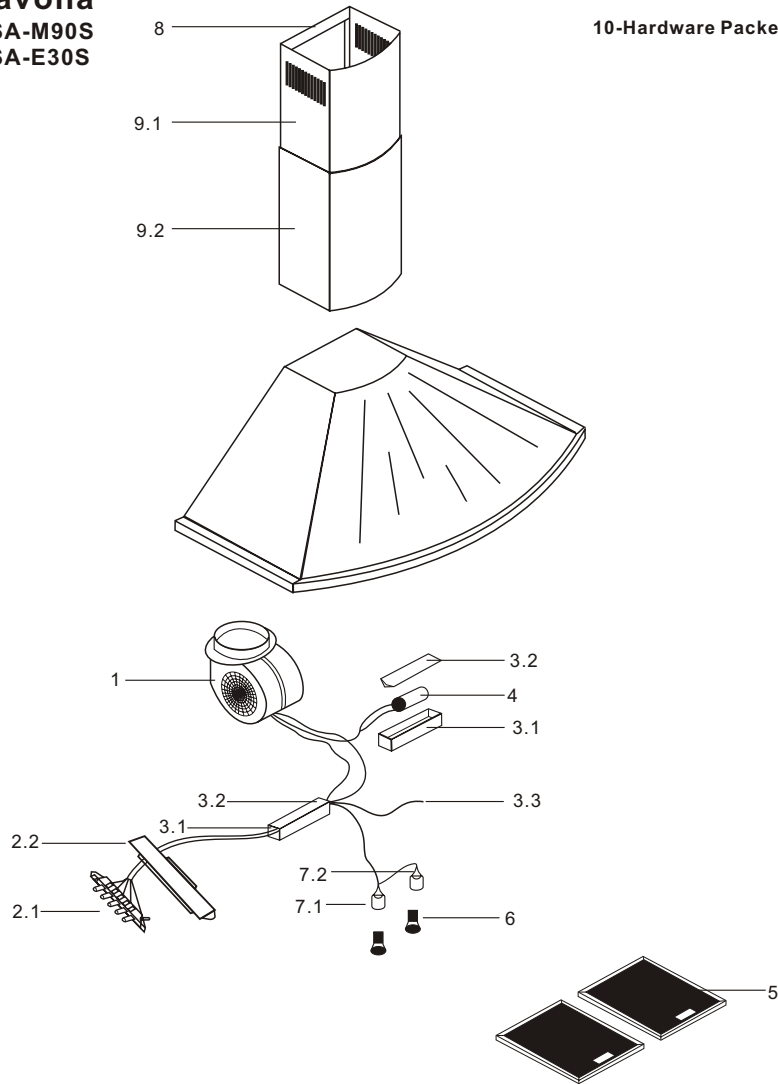

Exploded View Diagram



Savona

ZSA-M90S, ZSA-E30S

| Ref # | Part # | Description | Qty. | \$ ea. |
|-------|--------------|------------------------------------|------|--------|
| 1 | CCE006-00000 | Motor w/Wires | 1 | |
| 2.1 | LAA003-00000 | Switch assembly | 1 | |
| 2.2 | KCC133-20000 | Switch Housing | 1 | |
| 3.1 | KCC131-20000 | Protective Box Cover | 2 | |
| 3.2 | KCC132-20000 | Protective Box | 2 | |
| 3.3 | KCC187-00000 | Strain Relief Bushing | 1 | |
| 4 | LDB005-00000 | Capacitor | 1 | |
| 5 | RCC003-00000 | Metallic Filter | 2 | |
| 6 | KED015-00000 | Halogen Light Bulb, GU-10 50W 120V | 2 | |
| 7.1 | GFF003-00000 | Light Socket, GU-10, Left | 1 | |
| 7.2 | GFF005-00000 | Light Socket, GU-10, Right | 1 | |
| 8 | EEC356-P000 | Wall Bracket | 1 | |
| 9.1 | EEB387-P000 | Duct Cover, Top | 1 | |
| 9.2 | EEB386-P000 | Duct Cover, Bottom | 1 | |
| 10 | CCE008-00000 | Hardware Packet | 1 | |