

**Step 3: Mounting the Wall Plate:** Wood Stud, Brick, Solid Concrete, and Concrete Block mounting options are provided.

**Wood Stud mounting:**

The Wall Plate (a) **must be mounted to two wood studs at least 12" apart.** Use a high quality stud sensor to locate two adjacent studs. It is a good idea to verify where the studs are located with an awl or thin nail shown in Diagram 3a. Pre-drill a 2.5" deep hole at the desired height in each stud using a 3/16" drill bit. Make sure these holes are in the center area of the studs and level with each other. Use the Wall Plate as a template to mark the location of the second hole in each stud. Drill 2.5" deep holes using the 3/16" drill bit in the marked location. Attach the Wall Plate to the wall using the four Lag Bolts (t) and four Lag Bolt Washers (u). Make sure the Wall Plate is oriented so the flat surface in the center of the plate is against the wall and that a set of Lag Bolts is on each side of the center of the Wall Plate as shown in Diagram 3b.

**Brick, Solid Concrete and Concrete Block mounting:**

Use the Wall Plate (a) as a template to mark 6 hole locations on the wall. Locate the outer holes as far to the outer edges of the wall plate as possible. Three in the top row of slots and three more in the bottom row. Make sure these holes are level and there is at least 6" between any two holes. Pre-Drill these holes with a 1/2" masonry bit to at least 2.5" in depth. Insert a Concrete Anchor (v) into each of these holes. Make sure the anchor is seated completely flush with the concrete surface even if there is a layer of drywall or other material in front. Attach the Wall Plate to the wall using six Lag Bolts (t) and six Lag Bolt Washers (u).

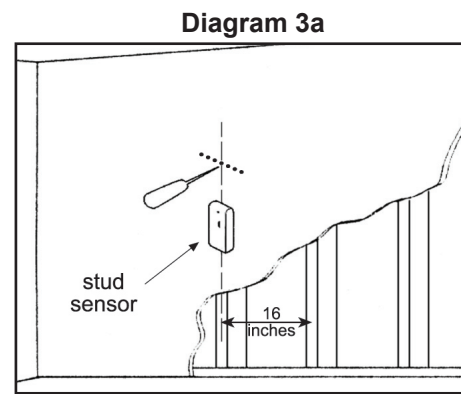

Diagram 3a

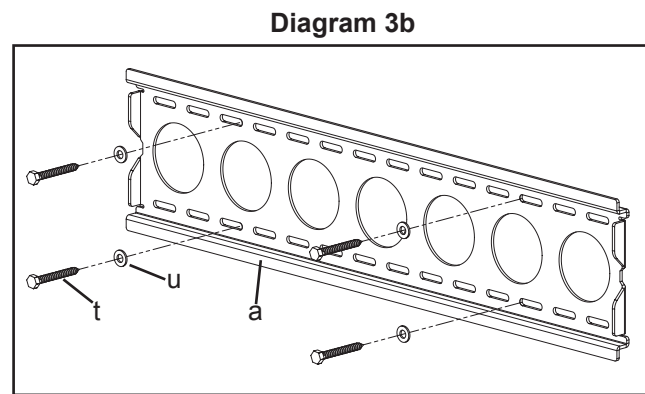

Diagram 3b

**Step 4: Attaching Monitor to Wall Plate and adding Safety Bolts**

**Warning: Some televisions may require 2 people to lift! Sanus is not responsible for personal injury or product damage.**

Hang the TV onto the Wall Plate: First hook the Monitor Brackets (b,c) over the top of the Wall Plate (a), then let the bottom of the Monitor Brackets rotate in under the bottom of the Wall Plate as shown in diagram 4a. Insert the Safety Bolts (w) into the threaded holes in the bottom of the Monitor Brackets and tighten them with the Allen Key (x) so that they sit behind the bottom tab on the Wall Plate as shown in diagram 4b. Finally set the tension of the knobs on the Monitor Brackets and you are free to adjust your new flat panel TV.

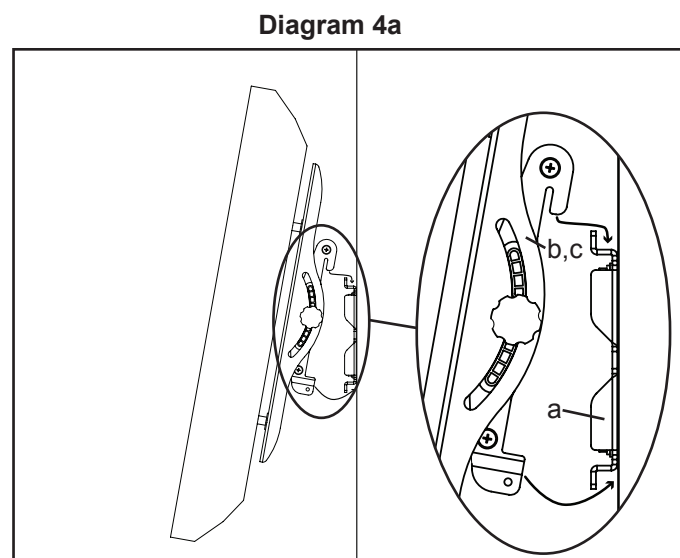

Diagram 4a

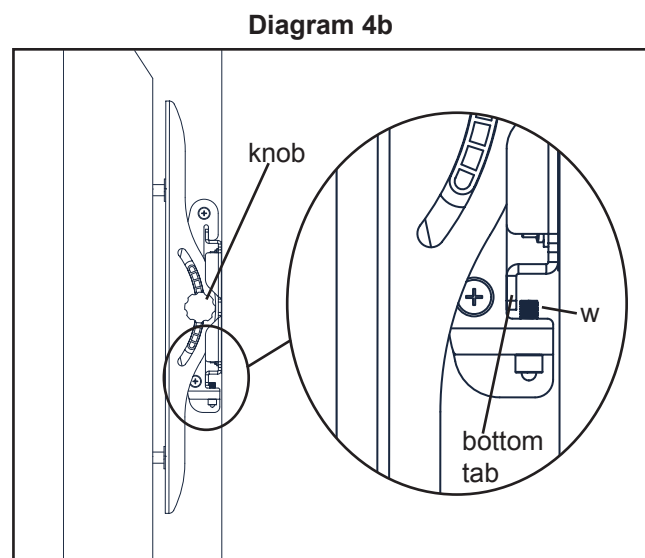

Diagram 4b

Thank you for choosing a VisionMount™ wall mount. This product is designed to mount flat panel televisions weighing up to 130 lb. to a vertical wall. It allows you to tilt your new television up to 12° without the use of tools.

**Safety Warning:** If you do not understand these directions, or have any doubts about the safety of the installation, please call a qualified contractor or contact Sanus at 800.359.5520 or www.sanus.com. We can quickly assist you with installation questions and missing or damaged parts. Replacement parts for Sanus products purchased through authorized dealers will be shipped directly to you. Check carefully to make sure there are no missing or defective parts. Never use defective parts. Improper installation may cause damage or serious injury. Do not use this product for any purpose that is not explicitly specified by Sanus Systems. Sanus Systems can not be liable for damage or injury caused by incorrect mounting, incorrect assembly, or incorrect use. **Note:** The supplied hardware is not for steel stud walls or old cinder block walls. If you are uncertain about the nature of your wall, consult an installation contractor.

**Required Tools:** 3/16" drill bit, 1/2" Masonry Bit for brick concrete or concrete block installations, 1/2" wrench or socket, Phillips screw driver.

**Supplied Parts: \*Not shown as actual size.**

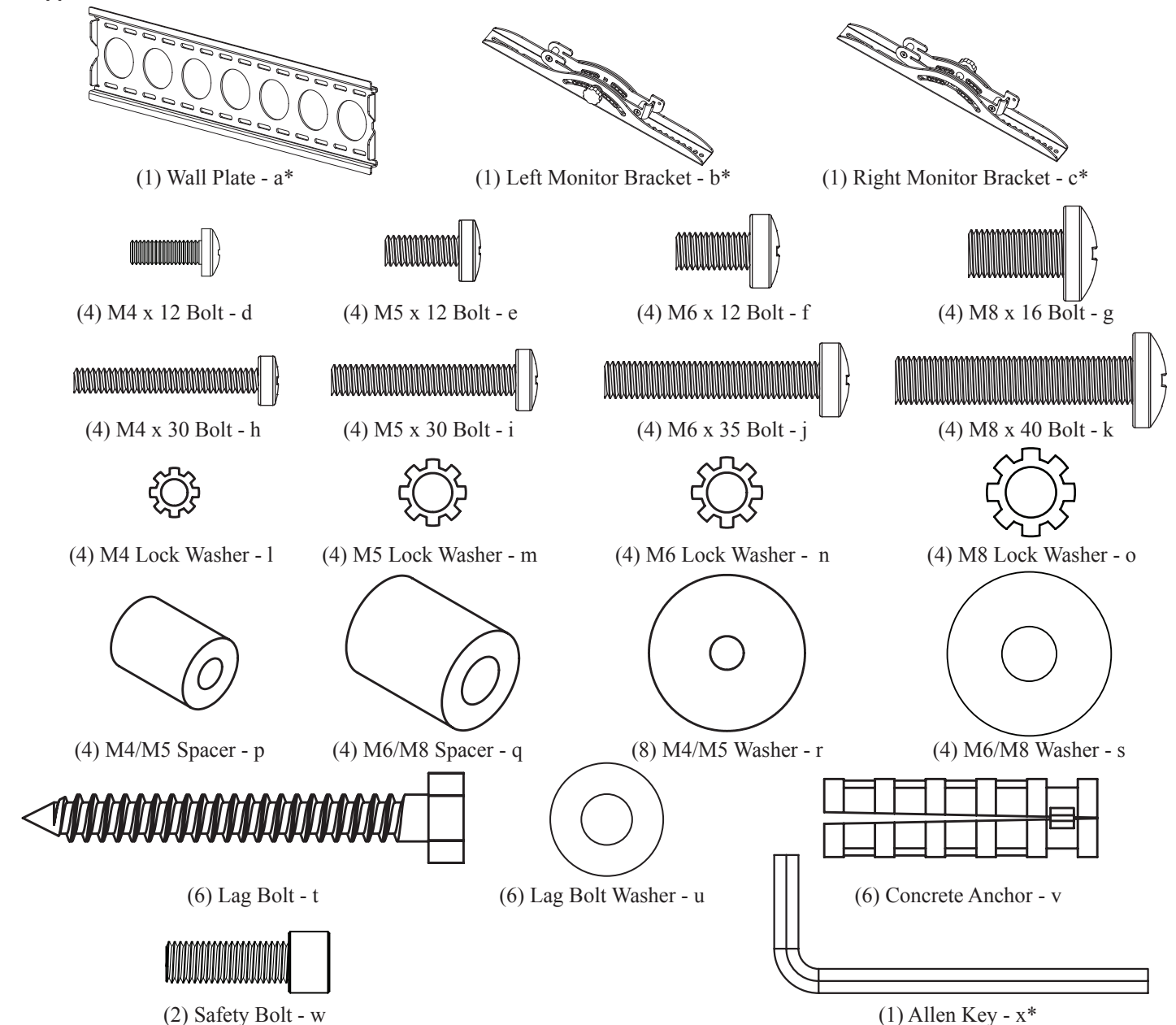

### Step 1: Mount Monitor Brackets to a television with a flat back

First, determine the diameter of the Bolt (d,e,f,g) your TV requires by hand threading them into the threaded insert on the back of the TV. If you encounter any resistance stop immediately! Once you have determined the correct diameter, see the appropriate Diagram below. You will thread the Bolt through the appropriate Lock Washer (l,m,n,o), the corresponding Washer (r,s), the Monitor Bracket (b,c), and finally into the TV. Make sure the Monitor Brackets are vertically centered and level with each other. See the appropriate Diagram below.

**Note: For televisions with a curved back, or an obstruction near the threaded insert see Step 2.**

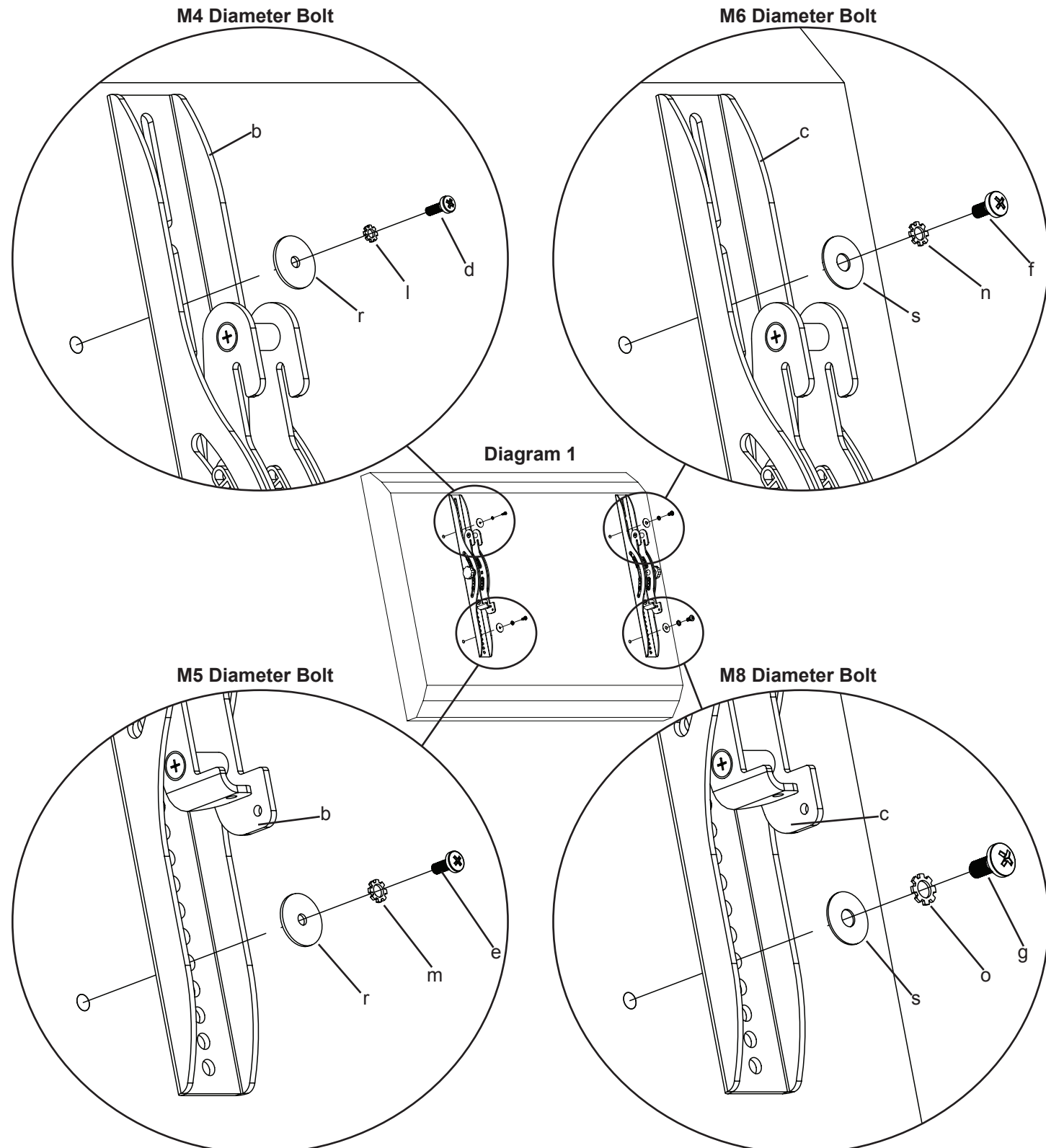

**Note: After completing Step 1, proceed to Step 3.**

### Step 2: Mount Monitor Brackets to a television with a curved back or an obstruction near the threaded insert

First, determine the diameter of the Bolt (h,i,j,k) your TV requires by hand threading them into the threaded insert on the back of the TV. If you encounter any resistance stop immediately! Once you have determined the correct diameter, see the appropriate Diagram below. You will thread the Bolt through the appropriate Lock Washer (l,m,n,o), the corresponding Washer (r,s), the Monitor Bracket (b,c), a Spacer (p,q), a second Washer (r - M4/M5 diameter only) and finally into the TV. Make sure the Monitor Brackets are vertically centered and level with each other. See the appropriate Diagram below.

