

Impressa F9 Quick Reference Guide

This Guide does not replace the Operating Instructions. For details and cautions you must read all instructions.

Traces of Coffee Grounds in New Machine?

This is normal! Grinder was tested during assembly with beans. Despite cleaning, traces of ground coffee may be found.

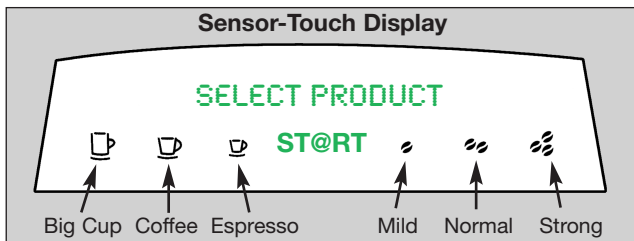

Left Control Buttons

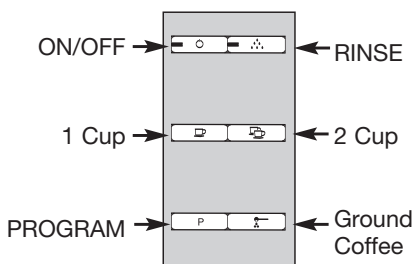

Right Control Buttons

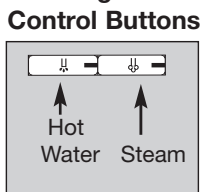

GREEN TEXT represents information in the display.

A) First Time Ever Preparation

1. Fill water in tank and beans in bean container.
2. DO NOT install the Claris Filter Cartridge now!
3. Push **ON/OFF** button. When the display reads **FILL SYSTEM / WATER PORTION** place a cup underneath the frother and push the **HOT WATER** button. When the F9 stops pumping: **YOUR MACHINE IS HEATING**.
4. Then **PRESS MAINT**. Place a cup under the coffee spouts and press the **RINSE** button. Display reads **SELECT PRODUCT** and the complete touch screen is illuminated.
5. Place a cup underneath the coffee spout, touch the **ESPRESSO** symbol, then touch the **3-BEAN** symbol, **ESPRESSO STRONG**. Touch and hold the **ST@RT** symbol until machine starts grinding. Repeat once. Discard the first two cups of coffee.

B) Daily Preparation

- Fill fresh water in tank and check bean container.
- Push **ON/OFF** button. **HELLO YOUR MACHINE IS HEATING. PRESS MAINT**. Place a cup under the coffee spout and press the **RINSE** button. **SELECT PRODUCT**.

C) Factory Settings

Filter	No
Hardness Level ...	2
Aroma.....	Strong
Temperature	High
Time	Not set
Unit (auto) On	Not set
Auto Off	2 hours

BIG CUP	240 ml (8 oz)
COFFEE.....	150 ml (5 oz)
ESPRESSO.....	60 ml (2 oz)
1-CUP.....	120 ml (4 oz)
2-CUP.....	240 ml (8 oz)
WATER PORTION...	5 oz
LANGUAGE.....	English

D) Grinding and Brewing Coffee

Nine coffee options in the Sensor Touch Display: **BIG CUP, COFFEE, ESPRESSO** each in **MILD, NORMAL, STRONG**.

- Select a coffee option and gently touch and hold **ST@RT** for two seconds until grinding starts.

Two coffee options with the **1-Cup** and **2-Cup** buttons.

Push either button. Grinding and brewing starts immediately.

E) Changing the Grinder Fineness

Important: You can only adjust the fineness during the actual grinding process.

- Open the bean container lid and turn the dial while grinding.
Thicker bars: coarser; thinner bars: finer.
 - For darker, oily beans, grind somewhat coarser.
 - For lighter beans, grind somewhat finer.

F) Using Hot Water

Place a cup underneath the steam nozzle. Push the **HOT WATER** button. **WATER PORTION**. Push button again to stop.

G) Using Steam (Frothing and Steaming)

Important: Frother parts must be tightly connected and clean.

- Cappuccino: One shot espresso plus ~4 oz. of steamed and frothed milk. Metal frother sleeve DOWN.
 - Latte: One shot espresso plus 4 to 5 oz. of steamed milk. Metal frother sleeve UP.
1. Push the **STEAM** button. The button's red light starts blinking. **YOUR MACHINE IS HEATING**. After 20 sec.: **SELECT PRODUCT**.
 2. Immerse the frother into a pitcher with milk and push the **STEAM** button again. **STEAM PORTION**. Steam pushes into the milk.
 3. Push the **STEAM** button again to stop. **SELECT PRODUCT**. To continue steaming push the **STEAM** button again.
 4. After steaming you can immediately brew coffee.
Knocking Noise during Frothing: The F9 pumps water droplets for steam. This is normal. **Please note:** Skim and 1% milk will produce more froth than 2% or regular milk.

Regulating Milk Temperature

To increase the milk temperature use the steaming position.

H) Cleaning the Frother

Should be done right after use, takes less than 15 sec. !

Place a cup underneath the frother. Push the **HOT WATER** button. After 5 sec. push the button again to stop.

I) Programming

Push and hold the **P** button until two **Red Arrows** show in the display. First message: **FILTER NO.** Repeatedly pushing the right arrow accesses different factory settings. Push the **P** button again to return to **SELECT PRODUCT.** Here is how to change some of the settings (for all other settings refer to the Operating Instructions).

a) Programming Cup Size for Sensor Touch Symbols

BIG CUP, COFFEE and **ESPRESSO** symbols can be programmed between 1 and 8 oz. each (30 to 240 ml).

1. Press and hold the **P** button until **FILTER NO.** Press the **Right Arrow** 4 times: **WATER QUANTITY**
2. Touch **ST@RT** and touch the cup symbol for which you want to change the cup size, e.g. **COFFEE 5 OZ (120ml)**
3. Press either arrow repeatedly to change the cup size. Touch **ST@RT** to confirm. **WATER QUANTITY.**
4. You can touch another cup symbol and proceed as above.
5. Press **P** button to return to **SELECT PRODUCT.**

b) Programming 1-CUP Button

The **1-CUP** button can be programmed between 1 and 8 oz. The **2-CUP** button delivers always twice as much coffee.

1. Press and hold the **P** button until **FILTER NO.** Press the **Right Arrow** 5 times: **1-CUP 4 OZ (120 ML)**
2. Press either arrow repeatedly to change. Touch **ST@RT** to confirm. **1-CUP STRONG.** Touch one of the bean symbols to select **MILD, NORMAL** or **STRONG**, e.g. **1-CUP NORMAL.** Touch **ST@RT** to confirm. **1-CUP NORMAL.**
3. Press **P** to return to **SELECT PRODUCT.**

c) Programming Hot Water Portion

Hot water portion can be programmed between 1 and 16 oz.

1. Press and hold the **P** button until **FILTER NO.** Press the **Right Arrow** 7 times: **WATER PORTION**
2. Touch **ST@RT. PRESS KEY.** Place a cup under the frother and press the **HOT WATER** button. Hot water will be released. **ENOUGH WATER? PRESS KEY.** When the desired amount of hot water is in your cup press the **HOT WATER** button to stop. **WATER PORTION.** This amount of hot water is now programmed.
3. Press **P** to return to **SELECT PRODUCT.**

d) Setting Time and Programming Auto-On

1. Press and hold the **P** button until **FILTER NO.** Press the **Right Arrow** 8 times: **TIME ---**
2. Touch **ST@RT.** Repeatedly touch the arrows to set the hours (military time!). Touch **ST@RT** to confirm.
3. Repeatedly touch the arrows to set the minutes. Touch **ST@RT** to confirm.
4. Press the **Right Arrow** once **UNIT ON ---**. Touch **ST@RT.**
5. Set the Auto-On time like the time (arrows for hours, **ST@RT** to confirm, arrows for minutes, **ST@RT** to confirm).
6. Press **P** to return to **SELECT PRODUCT.**

The F9 will turn on automatically at the preset time.

J) Installing the Claris Cartridge (F9 is on)

1. Rinse cartridge under running water and insert into water tank reception. Close cartridge holder.
2. Fill tank with cold water. Push and hold the **P** button: **FILTER NO**. Touch **ST@RT**. **NO** starts blinking.
3. Touch red arrow once: **FILTER YES**. Touch **ST@RT** to confirm.
4. **INSERT FILTER / WATER PORTION**. Place a large container (30 oz.) under the frother and push the **HOT WATER** button. **FILTER RINSING**. After ~90 sec.: **YOUR MACHINE IS HEATING** then **SELECT PRODUCT**.

The F9 automatically reminds you when it's time to replace the cartridge. **Please note:** When the Claris program is activated, the decalcifying monitor is turned off .

K) Replacing the Cartridge

The display shows **REPLACE FILTER / SELECT PRODUCT**

- Remove old filter, rinse new filter under running water and insert (see above). Place a large container (30 oz.) under the frother. Turn the machine off. Now, push and hold the **RINSE** button.
- **WATER PORTION / INSERT FILTER**. Push the **HOT WATER** button.

Important: If message **REPLACE FILTER** does not appear after 6 weeks, you must still replace the filter.

L) Cleaning with Special Tablet

This cleaning cycle removes coffee oils inside the machine. This message will appear after 200 cups of coffee: **CLEAN MACHINE / SELECT PRODUCT**. Takes less than 10 minutes!

Important: Only use special round cleaning tablets!

Important: Once started, do not interrupt the program!

1. Fill water tank. Push and hold the **RINSE** button. **EMPTY TRAY**. **Please note:** You must remove the tray for 20 seconds, even if it is empty. Replace tray.
2. **PRESS MAINT**. Push the **RINSE** button. **MACHINE CLEANING**. After a moment the display shows **TABLET / PRESS MAINT**.
3. Drop one white tablet into the "ground coffee funnel." Push the **RINSE** button. **MACHINE CLEANING**. After a few minutes: **EMPTY TRAY**. Carefully lift, remove and empty tray and replace. The F9 returns to its standard message **SELECT PRODUCT** and resets itself.

M) Decalcifying

If a water hardness level is selected (see Operating Instructions), the decalcifying monitor is active. The F9 needs to be de-calcified when the message **MACHINE SCALED SELECT PRODUCT** appears.

Important: If you use the Claris filter and the above message appears then the Claris activation was not performed. Repeat all steps of Chapter J. This will turn off the decalcifying monitor.

Important: Never interrupt the decalcifying program.

- Use only the special decalcifying tablets (not the cleaning tablets!). For supplies see below.
1. Turn the F9 off and let cool down for one hour. Push and hold the **RINSE** button until display shows **EMPTY TRAY**.
 2. Remove and empty tray. You must remove the tray for 20 seconds even if it is empty. Replace tray.

Decalcifying Session:

3. **AGENT IN TANK / PRESS MAINT**. Dissolve three large square tablets in 16 oz. of water and pour mixture into water tank. Place a container (at least 16 oz.) under frother.
4. Push the **RINSE** button. **MACHINE DESCALED**. After a few minutes: **EMPTY TRAY**. Carefully remove cup and tray, empty and replace.

Cleaning Session:

5. **FILL WATER**. Rinse water tank and fill with cold water (16 oz.) and replace. Place a container under the frother.
6. **PRESS MAINT. FILL WATER**. Push the **RINSE** button. **MACHINE DESCALED**. After a few minutes: **EMPTY TRAY**. Carefully remove cup and tray, empty and replace.
7. **PRESS MAINT**. Push the **RINSE** button. The F9 returns to **SELECT PRODUCT** and resets itself.
8. Clean the chrome front and grid with a moist, soft cloth.

CAPRESSO CUSTOMER SERVICE

1-800-220-5701

M-F 9AM - 9PM; Sat. 9AM - 5PM EST

FAX: 201-767-9684

contact@capresso.com

N) Supplies

Order through Customer Service or Mail Order Form or www.capresso.com:

- Claris Water Filter Cartridge: #7520
- Special Cleaning Tablets: #1151 or #62205 or #62535
- Decalcifying Tablets: #61848
- Grand Aroma Coffee Beans: #921

O) Using the frothXpress PLUS system

The frothXpress PLUS is separately available for the F9. This system siphons milk and automatically produces preprogrammed amounts of hot frothed or hot steamed milk right into your cups, never wasting any milk!

1. Disconnect the Dual-Frother PLUS from the steam nozzle (turn to loosen and pull down to remove).

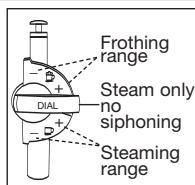
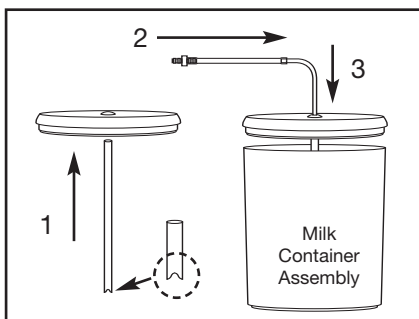

2. Fill milk container with milk and assemble milk container (see above). Attach the frothXpress to the steam nozzle. Attach the milk container to the frothXpress (see above). **Important:** Make sure all parts are connected tightly, otherwise siphoning does not work.
3. Set the dial to the (-) minus sign (12 o'clock) of the frothing range for cappuccino or to the (-) minus sign (6 o'clock) of the steaming range for latte.
4. Place cup underneath the frother.
5. Push the **STEAM** button. The button's red light starts blinking. **YOUR MACHINE IS HEATING.** After ~ 20 sec.: **SELECT PRODUCT.**
6. Push the **STEAM** button again. **STEAM PORTION.** The F9 will create hot frothed or steamed milk right in your cup .
When you have enough milk in your cup push the **STEAM** button to stop.
7. If you like more frothed milk push the **STEAM** button again.
8. For hotter milk in either position move the dial more towards the (+) plus symbols.

(The extra long hose lets you siphon milk from any carton without using the special milk container.)

Tip: Use Chocolate milk to make great Hot Chocolate!

P) Cleaning the frothXpress PLUS system

Should be done right after use, takes less than 30 seconds.

- Store the milk container in the refrigerator and remove the frothXpress from the steam nozzle.
- Drop the hose and the frothXpress in a cup of hot water. This will push out any milk residue and prevents milk from hardening inside the system.
- Place a cup underneath the steam nozzle and push the **HOT WATER** button for three seconds.
- Replace frothXpress system.