

# FM/AM Clock Radio

## ICF-C180

### Operating Instructions

## DREAM MACHINE

Dream Machine is a trademark of Sony Corporation.



No Power No problem is a trademark of Sony Corporation.



Printed on 100% recycled paper using VOC (Volatile Organic Compound)-free vegetable oil based ink.

© 2006 Sony Corporation Printed in China

<http://www.sony.net/>

For customers who purchased this product in the USA

Please register this product on line at <http://www.sony.com/productregistration>. Proper registration will enable us to send you periodic mailings about new products, services, and other important announcements. Registering your product will also allow us to contact you in the unlikely event that the product needs adjustment or modification. Thank you.

### WARNING

To reduce the risk of fire or electric shock, do not expose this apparatus to rain or moisture.

You are cautioned that any changes or modifications not expressly approved in this manual could void your authority to operate this equipment.

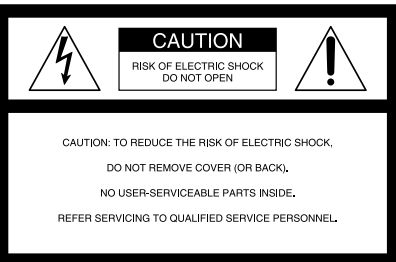

This symbol is intended to alert the user to the presence of uninsulated “dangerous voltage” within the product’s enclosure that may be of sufficient magnitude to constitute a risk of electric shock to persons.

This symbol is intended to alert the user to the presence of important operating and maintenance (servicing) instructions in the literature accompanying the appliance.

\* The graphical symbols are at the bottom of the unit.

### INFORMATION

This equipment has been tested and found to comply with the limits for a Class B digital device, pursuant to Part 15 of the FCC Rules. These limits are designed to provide reasonable protection against harmful interference in a residential installation. This equipment generates, uses, and can radiate radio frequency energy and, if not installed and used in accordance with the instructions, may cause harmful interference to radio communications. However, there is no guarantee that interference will not occur in a particular installation. If this equipment does cause harmful interference to radio or television reception, which can be determined by turning the equipment off and on, the user is encouraged to try to correct the interference by one or more of the following measures:

- Reorient or relocate the receiving antenna.
- Increase the separation between the equipment and receiver.
- Connect the equipment into an outlet on a circuit different from that to which the receiver is connected.
- Consult the dealer or an experienced radio/TV technician for help.

### WARNING

Battery may explode if mistreated. Do not recharge, disassemble or dispose of in fire.

## Features

- Dual alarm FM/AM Clock radio.
- Various types of alarms-radio, buzzer and 2 melodies.
- Weekend alarm mode — one touch switches alarm setting for weekends.
- Brightness control. (High/Low)
- Automatic time set — When you plug the clock in for the first time, the current EST will be shown on the display.
- Two-color triple time display — main display in green for the clock, and two sub-displays in amber for the alarms. (Liv: amber for the clock, green for the alarms)
- No Power No Problem™ alarm system to keep the clock and the alarm operating during a power interruption with a CR2032 battery installed.
- Nap Timer allows you to take a short nap and wake to buzzer without changing your alarm settings.
- DST (Daylight Saving Time) -Summer time adjustment.
- Extendable snooze - snooze time can be extended from 10 to 60 minutes in maximum every time you use.

## Troubleshooting

Should any problem occur with the unit, make the following simple checks to determine whether or not servicing is required. If the problem persists, consult your nearest Sony dealer.

**The clock flashes “AM 12:00” due to a power interruption.**

- The battery is low. Replace the battery. Remove the old battery and install a new one.

**The radio, buzzer or melody alarm does not sound at the preset alarm time.**

- Has the desired radio, buzzer or melody alarm been activated? (i.e., Is the set alarm time of Alarm A or B displayed? )

**The radio alarm is activated but no sound comes on at the preset alarm time.**

- Has VOLUME been adjusted ?

## Precautions

- Operate the unit on the power sources specified in “Specifications” .
- To disconnect the power cord (mains lead), pull it out by the plug, not the cord.
- Do not leave the unit in a location near a heat source, such as a radiator or airduct, or in a place subject to direct sunlight, excessive dust, mechanical vibration, or shock.
- Allow adequate air circulation to prevent internal heat build-up. Do not place the unit on a surface (a rug, blanket, etc.) or near materials (a curtain) that might block the ventilation holes.
- Should any solid object or liquid fall into the unit, unplug the unit and have it checked by a qualified personnel before operating it any further.
- To clean the casing, use a soft cloth dampened with a mild detergent solution.

If you have any questions or problems concerning your unit, please consult your nearest Sony dealer.

## Specifications

<b>Time display</b>	12-hour system
<b>Frequency range</b>	FM: 87.5–108 MHz AM: 530–1 710 kHz
<b>Speaker</b>	Approx. 6.6 cm (2 5/8 inches) dia., 8 Ω
<b>Power output</b>	150 mW (at 10% harmonic distortion)
<b>Power requirements</b>	120 V AC, 60 Hz For power backup: 3 V DC, one CR2032 battery
<b>Dimensions</b>	Approx. 112.3 × 104.5 × 126.5 mm (w/h/d) (4 1/2 × 4 1/8 × 5 inches) incl. projecting parts and controls
<b>Mass</b>	Approx. 572 g (1 lb 4.2 oz) incl. CR2032 battery

Design and specifications are subject to change without notice.

## IMPORTANT SAFEGUARDS

For your protection, please read these safety instructions completely before operating the appliance, and keep this manual for future reference. Carefully observe all warnings, precautions and instructions on the appliance and in the operating instructions, and adhere to them.

### INSTALLATION

#### Water and Moisture

Do not use powerline operated appliances near water - for example, near a bathtub, washbowl, kitchen sink, or laundry tub, in a wet basement, or near a swimming pool, etc.

#### Heat

Do not place the appliance near or over a radiator or heat register, or where it is exposed to direct sunlight.

#### Ventilation

The slots and openings in the cabinet are provided for necessary ventilation. To ensure reliable operation of the appliance, and to protect it from overheating, these slots and openings must never be blocked or covered.

-Never cover the slots and openings with a cloth or other materials.

-Never block the slots and openings by placing the appliance on a bed, sofa, rug or other similar surface.

-Never place the appliance in a confined space, such as a bookcase, or built-in cabinet, unless proper ventilation is provided.

#### Accessories

Do not place the appliance on an unstable cart, stand, tripod, bracket, or table. The appliance may fall, causing serious injury to a child or an adult, and serious damage to the appliance. Use only a cart, stand, tripod, bracket, or table recommended by Sony.

-An appliance and cart combination should be moved with care. Quick stops, excessive force, and uneven surfaces may cause the appliance and cart combination to overturn.

#### Wall or Ceiling Mounting

If your appliance can be mounted to a wall or ceiling, mount it only as recommended by Sony.

### USE

#### Power Source

This appliance should be operated only from the type of power source indicated on the marking label. If you are not sure of the type of electrical power supplied to your home, consult your dealer or local power company. For those appliances designed to operate from battery power, or other sources, refer to the operating instructions.

#### Grounding or Polarization

This appliance is equipped with a polarized AC power cord plug (a plug having one blade wider than the other), or with a three-wire grounding type plug (a plug having a third pin for grounding). Follow the instructions below:

#### -For the appliance with a polarized AC power cord plug:

This plug will fit into the power outlet only one way. This is a safety feature. If you are unable to insert the plug fully into the outlet, try reversing the plug. If the plug should still fail to fit, contact your electrician to have a suitable outlet installed. Do not defeat the safety purpose of the polarized plug by forcing it in.

#### -For the appliance with a three-wire grounding type AC plug:

This plug will only fit into a grounding-type power outlet. This is a safety feature. If you are unable to insert the plug into the outlet, contact your electrician to have a suitable outlet installed. Do not defeat the safety purpose of the grounding plug.

#### Overloading

Do not overload wall outlets, extension cords or convenience receptacles beyond their capacity, since this can result in fire or electric shock.

#### When not in use

Unplug the power cord of the appliance from the outlet when left unused for a long period of time. To disconnect the cord, pull it out by grasping the plug. Never pull the plug out by the cord.

#### Power-Cord Protection

Route the power cord so that it is not likely to be walked on or pinched by items placed upon or against them, paying particular attention to the plugs, receptacles, and the point where the cord exits from the appliance.

#### Lightning

For added protection for this appliance during a lightning storm, or when it is left unattended and unused for long periods of time, unplug it from the wall outlet and disconnect the antenna or cable system. This will prevent damage to the appliance due to lightning and powerline surges.

#### Object and Liquid Entry

Never push objects of any kind into the appliance through openings as they may touch dangerous voltage points or short out parts that could result in a fire or electric shock. Never spill liquid of any kind on the appliance.

#### Cleaning

Unplug the appliance from the wall outlet before cleaning or polishing it. Do not use liquid cleaners or aerosol cleaners. Use a cloth lightly dampened with water for cleaning the exterior of the appliance. Clean the appliance only as recommended by Sony.

#### Attachments

Do not use attachments not recommended by Sony, as they may cause hazards.

## ANTENNAS

### Outdoor Antenna Grounding

If an outdoor antenna or cable system is installed, follow the precautions below.

An outdoor antenna system should not be located in the vicinity of overhead power lines or other electric light or power circuits, or where it can come in contact with such power lines or circuits. WHEN INSTALLING AN OUTDOOR ANTENNA SYSTEM, EXTREME CARE SHOULD BE TAKEN TO KEEP FROM CONTACTING SUCH POWER LINES OR CIRCUITS AS CONTACT WITH THEM IS ALMOST INVARIABLY FATAL.

Be sure the antenna system is grounded so as to provide some protection against voltage surges and built-up static charges. Section 810 of the National Electrical Code provides information with respect to proper grounding of the mast and supporting structure, grounding of the lead-in wire to an antenna discharge unit, size of grounding conductors, location of antenna-discharge unit, connection to grounding electrodes, and requirements for the grounding electrode.

## Antenna Grounding According to the National Electrical Code

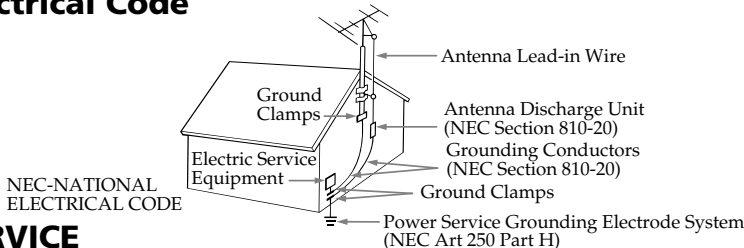

## SERVICE

### Damage Requiring Service

Unplug the appliance from the wall outlet and refer servicing to qualified service personnel under the following conditions:

- When the power cord or plug is damage or frayed.
- If liquid has been spilled or objects have fallen into the appliance.
- If the appliance has been exposed to rain or water.
- The appliance does not appear to operate normally or exhibits a marked change in performance.
- This indicates a need for service.
- If the appliance does not operate normally when following the operating instructions, adjust only those controls that are specified in the operating instructions. Improper adjustment of other controls may result in damage and will often require extensive work by a qualified technician to restore the appliance to normal operation.
- If the appliance has been subject to excessive shock by being dropped, or the cabinet has been damaged.

#### Servicing

Do not attempt to service the appliance yourself as opening or removing covers may expose you to dangerous voltage or other hazards.

Refer all servicing to qualified service personnel.

#### Replacement parts

When replacement parts are required, be sure the service technician has used replacement parts specified by Sony that have the same characteristics as the original parts. Unauthorized substitutions may result in fire, electric shock, or other hazards.

#### Safety Check

Upon completion of any service or repairs to the appliance, ask the service technician to perform routine safety checks (as specified by Sony) to determine that the appliance is in safe operating condition.

SONY®

Tape Cassette Player/Recorder/CD Player/Mini Disc  
DAT/Radio/Head Phone/Speaker/MIC/Personals

Portable Audio

## LIMITED WARRANTY

Sony Electronics Inc. (“Sony”) warrants this Product (including any accessories) against defects in material or workmanship as follows:

1. For a period of one (1) year from the date of purchase if this Product is determined to be defective, Sony will repair or replace the Product, at its option, at no charge. After this one (1) year period, you must pay for the replacement unit. This warranty does not cover costs incurred in connection with the removal and re-installation of radios, speakers or accessories, nor does it cover any other contingent expenses.
2. To obtain warranty service, you must take the Product, or deliver the Product freight prepaid, in either its original packaging or packaging affording an equal degree of protection, to any Factory Sony Service facility or to the Laredo Fulfillment Center. See below for additional information.

This warranty does not cover customer instruction, installation, set up adjustments or signal reception problems.

This warranty does not cover cosmetic damage or damage due to acts of God, accident, misuse, abuse, negligence, commercial use, or modification of, or to any part of the Product, including the antenna. This warranty does not cover damage due to improper operation or maintenance, connection to improper voltage supply, or attempted repair by anyone other than a facility authorized by Sony to service the Product. This warranty does not cover Products sold AS IS or WITH ALL FAULTS, or consumables (such as fuses or batteries). This warranty is valid only in the United States.

Proof of purchase in the form of a bill of sale or receipted invoice which is evidence that the unit is within the Warranty period must be presented to obtain warranty service.

This warranty is invalid if the factory applied serial number has been altered or removed from the Product.

REPAIR OR REPLACEMENT AS PROVIDED UNDER THIS WARRANTY IS THE EXCLUSIVE REMEDY OF THE CONSUMER. SONY SHALL NOT BE LIABLE FOR ANY INCIDENTAL OR CONSEQUENTIAL DAMAGES FOR BREACH OF ANY EXPRESS OR IMPLIED WARRANTY ON THIS PRODUCT. EXCEPT TO THE EXTENT PROHIBITED BY APPLICABLE LAW, ANY IMPLIED WARRANTY OF MERCHANTABILITY OR FITNESS FOR A PARTICULAR PURPOSE ON THIS PRODUCT IS LIMITED IN DURATION TO THE DURATION OF THIS WARRANTY.

Some states do not allow the exclusion or limitation of incidental or consequential damages, or allow limitations on how long an implied warranty lasts, so the above limitations or exclusions may not apply to you. In addition, if you enter into a service contract with the Sony Partnership within 90 days of the date of sale, the limitation on how long an implied warranty lasts does not apply to you. This warranty gives you specific legal rights, and you may have other rights which vary from state to state.

The Address of the Laredo Fulfillment Center is:

**Laredo Fulfillment Center**  
10227 Crossroads Loop Suite B  
Laredo, TX 78045

For your convenience, Sony Electronics Inc. has established telephone numbers for frequently asked questions:

To locate the servicer or dealer nearest you, or for service assistance or resolution of a service problem, or for product information or operation, call:

**Sony Customer Information Services Center**  
1-800-222-7669  
or visit the Sony Web Site:  
[www.sony.com](http://www.sony.com)

For an accessory or part not available from your authorized dealer, call:

1-800-488-SONY (7669)

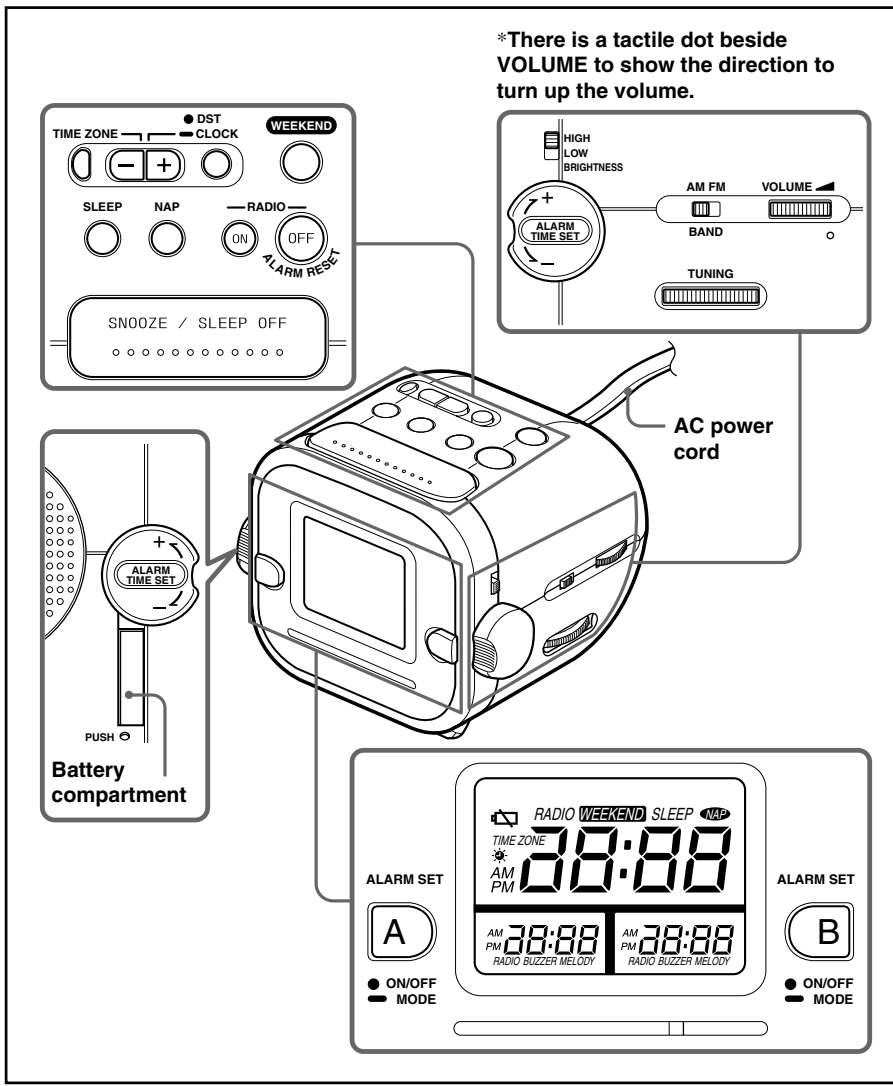

\*There is a tactile dot beside **VOLUME** to show the direction to turn up the volume.

**A**

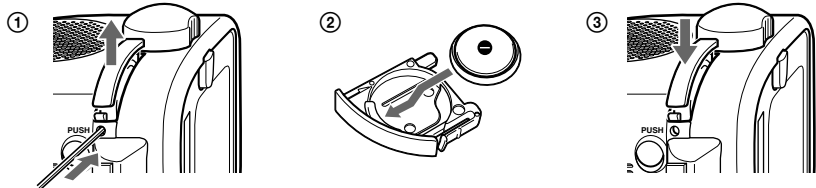

## About the backup battery

To keep good time, as backup power source, this unit contains one CR2032 battery inside of the unit, in addition to the house current. The battery keeps the clock operating in the event of a power interruption.

### Knowing when to replace the battery

When the battery becomes weak, “ $\text{CL}$ ” appears on the display. In the event of a power interruption when the battery is weak, current time, alarm functions, and NAP timer will be initialized.

Replace the battery with a Sony CR2032 lithium battery. Use of another battery may present a risk of fire or explosion.

#### Note

If the “AM 12:00” flashes on the display when the unit is connected to AC outlet for the first time, the battery may be weak. In this case, consult a Sony dealer.

### Replacing the battery with new one

- 1 Keep AC plug connected to the AC outlet, insert a pointed object into the hole beside the battery compartment to eject the tray and then pull out. (See Fig. **A-1**)
- 2 Install a new battery in the tray with the  $\ominus$  side facing forward. (See Fig. **A-2**)
- 3 Push the tray back into the unit. (See Fig. **A-3**)
- 4 Press **RADIO ON** to turn “ $\text{CL}$ ” off on the display

#### Note

If you replace the battery, do not disconnect AC plug from AC outlet. Otherwise, current time, alarm and NAP timer will be initialized.

#### Battery Warning

When the unit will be left unplugged for a long time, remove the battery to avoid undue battery discharge and damage to the unit from battery leakage.

#### NOTES ON LITHIUM BATTERY

- Dispose of used battery promptly. Keep the lithium battery out of the reach of children. Should the battery be swallowed, immediately consult a doctor.
- Wipe the battery with a dry cloth to assure a good contact.
- Be sure to observe the correct polarity when installing the battery.
- Do not hold the battery with metallic tweezers, otherwise a short-circuit may occur.

#### CAUTION

Danger of explosion if battery is incorrectly replaced. Replace only with the same or equivalent type recommended by the equipment manufacturer.

## Setting the Clock for the first time

This unit is preset to the current EST (Eastern Standard Time) at the factory, and is powered by the back up battery. All you need to do the first time is just plug it in, select your time zone, and activate the DST/Summer time if necessary.

- 1 Plug in the unit. The current EST (Eastern Standard Time) appears on the display.
- 2 Press and hold **TIME ZONE**. “TIME ZONE” and area number “2” appear on the display. If you live in the Eastern Time Zone, you don’t need to adjust the area setting.

Area number	Time zone
1	Atlantic Standard Time
2	Eastern Standard Time (default)
3	Central Standard Time
4	Mountain Standard Time
5	Pacific Standard Time
6	Yukon Standard Time
7	Hawaiian Standard Time

- 3 Press **+** or **-** repeatedly until the desired number appears.
- 4 Release **TIME ZONE** to confirm.

#### Note

- Configured time at the factory is not daylight saving time (summer time). If you are on daylight saving time, refer to “To change the display to the daylight saving time (summer time) indication” to activate the summer time function.
- During the shipment and your first use, a clock error may occur. In this case, refer to “Setting the Clock” to set the correct time.

## Setting the Clock

Set the clock according to the following steps.

- 1 Press **DST/CLOCK** for a few seconds until a beep sounds. The hour starts to flash on the display.
- 2 Press **+** or **-** until the correct hour appears. To set the current time rapidly, hold down **+** or **-**.
- 3 Press **DST/CLOCK** once.
- 4 Repeat steps **2** and **3** to set the minute. Two short beeps sound, “.” starts flashing, and the clock starts from 0 seconds.

- While setting the clock, you must perform each step within 65 seconds, or the clock setting mode will be cancelled.
- To set the current time from zero seconds, press **DST/CLOCK** at the correct second in step **4**.

### To change the display to the daylight saving time (summer time) indication

Press **DST/CLOCK**.

“ $\text{S}$ ” appears and the time indication changes to summer time.

To deactivate the summer time function, press **DST/CLOCK** again.

## Setting the brightness of the backlight

Select **BRIGHTNESS** to **HIGH** or **LOW** for the display, according to your preference.

## Playing the Radio

- 1 Press **RADIO ON** to turn on the radio.
- 2 Adjust volume using **VOLUME**.
- 3 Select **BAND**.
- 4 Tune in to a station using **TUNING**.

### To turn off the radio

Press **RADIO OFF / ALARM RESET**.

## Improving the reception

**FM:** The AC power cord functions as an FM antenna. Extend the AC power cord fully to increase reception sensitivity.

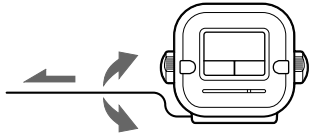

**AM:** Rotate the unit horizontally for optimum reception. A ferrite bar AM antenna is built-in to the unit.

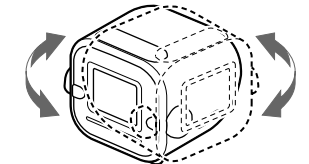

Do not operate the unit over a steel desk or metal surface, as this may lead to interference of reception.

## Setting the Alarm

This unit is equipped with a dual alarm function, so you can set the alarm time for two different occasions — ALARM A and ALARM B. Furthermore, you can also set an additional two times for weekends.

When you select Weekend mode, the set alarms for weekend are activated automatically, and the display color of the alarm window turns green. (Liv: amber) This unit is also equipped with 3 alarm sounds—radio, buzzer, and melody\*.

#### \* Melody:

Weekday mode— “Morning” from “Peer Gynt,” by Griegsuite No.1, Op.46  
Weekend mode— “Four seasons: Spring” by Antonio Lucio Vivaldi

#### Notes

- Before setting the alarm, make sure to set the clock (see “Setting the Clock”).
- The factory setting alarm time is “PM 12:00”.
- To set the radio alarm, first tune in to a station and adjust the volume (see “Playing the Radio”).
- The volume of the buzzer and melody cannot be adjusted.

### To set the alarm mode (weekday/weekend)

You can select the alarm mode to either weekday or weekend. Press **WEEKEND** repeatedly until the desired alarm mode is selected.

If you select the Weekend mode, “ $\text{WEEKEND}$ ” appears on the display.

### To set the alarm time

- 1 Press **WEEKEND** to select the desired alarm mode.
- 2 Press **ALARM SET A** or **ALARM SET B**. Alarm time appears on the desired display. Example: Display window when you set weekend and alarm A.



- 3 Turn **ALARM TIME SET +** or **-** to set the desired time. Each turn of **ALARM TIME SET +** or **-** changes the indication by 1 minute. If you turn and hold **ALARM TIME SET +** or **-**, the alarm time goes forward (or backward) by 1 minute up to 10 minutes, and then by 10 minutes increments.

- To change the alarm time when the alarm is already set, perform step **3** only.
- If the same alarm time is set for both alarm (alarm A and B), the alarm A takes priority.

### To set the alarm sound

- 1 Keep pressing **ALARM SET A** or **ALARM SET B** for a few seconds until a beep sounds. The alarm time appears and alarm icon flashes on the display.
- 2 Each turn of **ALARM TIME SET +** or **-** changes the indication on the display as follows:
- 3 Press **ALARM SET A** or **ALARM SET B** again. Two beeps sound to confirm the setting.

#### Note

While setting the alarm sound, you must perform each step within 65 seconds, or the alarm setting mode will be cancelled.

### To doze for a few more minutes

Press **SNOOZE/SLEEP OFF**. The sound turns off but will automatically come on again after about 10 minutes. Each time you press **SNOOZE/SLEEP OFF**, the snooze time changes as follows:

10 → 20 → 30 → 40 → 50 → 60

The maximum length of the snooze time is 60 minutes.

The display shows the snooze time for about 4 seconds and returns to show the current time. When you press **SNOOZE/SLEEP OFF** after the current time appears, the snooze time starts from 10 minutes again.

### To stop the alarm

Press **RADIO OFF/ALARM RESET** to turn off the alarm. The alarm will come on again at the same time the next day.

If **RADIO OFF/ALARM RESET** is not pressed, the alarm sounds continuously for about 60 minutes, and then it will be stop automatically.

### To deactivate the alarm

Press **ALARM SET A** or **ALARM SET B**. Alarm time display disappears.

### Note on alarm in the event of a power interruption

In the event of a power interruption, alarm functions work until the battery is empty. But following functions are different:

- Backlight will not light up.
- When the alarm sound is set as RADIO, it will change to BUZZER automatically.
- If the power source returns while the alarm sounds, the alarm sounds continuously for about 60 minutes when the power source returns.
- If **RADIO OFF/ALARM RESET** is not pressed, the alarm sounds for about 1 minute. If the power interruption continues, the alarm sounds for about 1 minute and stops for 5 minutes and repeats at 5 times.

If the power source returns within 60 minutes of the set alarm time, the alarm sounds. (If the alarm repeats 5 times, the alarm sounds up to 30 minutes.)

- If “ $\text{CL}$ ” appears on the display, the alarm will not work in the event of power interruption. Replace the battery if “ $\text{CL}$ ” appears.

## Using the NAP timer (count down timer)

The NAP timer sounds the buzzer after a preset time duration. Press **NAP** repeatedly until the desired minute appears.

Each press changes the display as follows:

OFF → 10 → 20 → 30  
← 120 ← 90 ← 60 ←

Two short beeps sound when the display returns to “10”.

“ $\text{NAP}$ ” and the NAP time appear for about 4 seconds.

NAP timer starts counting down the NAP time.

When the selected NAP time occurs, the buzzer comes on, and “ $\text{NAP}$ ” on the display flashes.

The buzzer is turned off automatically after about 60 minutes.

### To stop the NAP timer

Press **NAP** or **RADIO OFF/ALARM RESET** to turn off the buzzer.

### To deactivate the NAP timer

Press **NAP**.

“ $\text{NAP}$ ” disappears from the display.

### Note on NAP time in the event of a power interruption

When in the event of a power interruption, NAP time work until the battery is empty. But the following functions are different:

- BUZZER will stop automatically after 1 minute.
- If the event of a power interruption happens when the BUZZER sounds, it will stop automatically.
- If “ $\text{CL}$ ” appears on the display, BUZZER will not work in the event of power interruption. Replace the battery if “ $\text{CL}$ ” appears.

## Setting the Sleep timer

You can fall asleep to the radio using the built-in sleep timer that turns off the radio automatically after a preset duration.

Press **SLEEP**.

The radio turns on. You can set the sleep timer to durations of 90, 60, 30, or 15 minutes. Each press changes the display as follows:

OFF → 90 → 60  
← 15 ← 30 ←

Two short beeps sound when the display returns to “90”.

“SLEEP” will appear in the display when the durations time are set.

The radio will play for the duration you set, then shut off.

### To turn off the radio before the preset time

Press **RADIO OFF/ALARM RESET** or **SNOOZE/SLEEP OFF**.

### To use both Sleep timer and alarm

You can fall asleep to the radio and also be awakened by the radio, buzzer or melody alarm at the preset time.

- 1 Set the alarm. (See “Setting the Alarm”.)
- 2 Set the sleep timer. (See “Setting the Sleep timer”.)